

STATE OF KANSAS
STATE CORPORATION COMMISSION

WELL PLUGGING RECORD

Give All Information Completely
Make Required Affidavit
Mail or Deliver Report to
Conservation Division
State Corporation Comm.
245 North Water
Wichita, KS 67202

Logan County, Sec. 22 Twp. 12S Rge. 33WE/W
Location as "NE/CNW $\frac{1}{4}$ SW $\frac{1}{4}$ " or footage from lines
C SE NW

Lease Owner Abercrombie Drilling, Inc & Moble Hoover
Lease Name MILLER Well No. 1
Office Address 801 Union Center, Wichita, Kansas 67202
Character of Well (Completed as Oil, Gas or Dry Hole)
Dry Hole

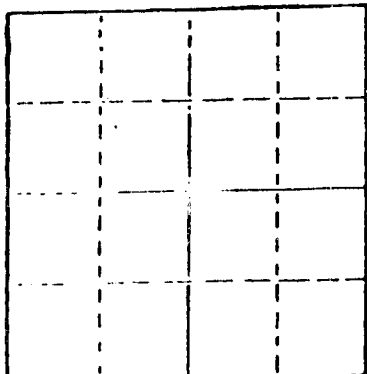

Locate well correctly on above
Section Plat

Date Well completed Aug. 8 19 79
Application for plugging filed (verbally) Aug. 8 19 79
Application for plugging approved (verbally) Aug. 8 19 79
Plugging commenced Aug. 8 19 79
Plugging completed Aug. 8 19 79

Reason for abandonment of well or producing formation
No commercial quantity of oil or gas encountered
If a producing well is abandoned, date of last production
19

Was permission obtained from the Conservation Division or
its agents before plugging was commenced? Yes

Name of Conservation Agent who supervised plugging of this well Gilbert Balthazor
Producing formation _____ Depth to top _____ Bottom _____ Total Depth of Well 4720'
Show depth and thickness of all water, oil and gas formations.

OIL, GAS OR WATER RECORDS

CASING RECORD

FORMATION	CONTENT	FROM	TO	SIZE	PUT IN	PULLED OUT

Describe in detail the manner in which the well was plugged, indicating where the mud fluid was placed and the method or methods used in introducing it into the hold. If cement or other plugs were used, state the character of same and depth placed, from _____ feet to _____ feet for each plug set.

T.D. 4720'
Set 1st plug at 1650' with 70 sacks
2nd plug at 240' with 20 sacks
3rd plug at 40' with 10 sacks
rathole with 3 sacks.
Cemented with 50/50 posmix, 6% gel.
Plug was down at 9:00 a.m., 8-08-79.

08-23-1979

(If additional description is necessary, use BACK of this sheet)

Name of Plugging Contractor Abercrombie Drilling, Inc.

STATE OF Kansas COUNTY OF Sedgwick, ss.
JERRY A. LANGREHR, Executive Vice-President (employee of owner) or (owner or operator)
of the above-described well, being first duly sworn on oath, says: That I have knowledge of
the facts, statements, and matters herein contained and the log of the above described well
as filed and that the same are true and correct. So help me God.

(Signature) Jerry A. Langreh
801 Union Center, Wichita, Kansas 67202
(Address)

SUBSCRIBED AND SWORN TO before me this 21st day of August, 19 79

My commission expires 8-21-82

Sherrie L. Brooks
Sherrie L. Brooks Notary Public.

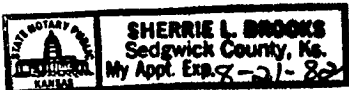

JUL 23 1979

IMPORTANT
 Kans. Geo. Survey request
 samples on this well.

KANSAS DRILLERS LOG

S. 22 T. 12 R. 33 ^{NE}/_W

Loc. C SE NW

County Logan

API No. 15 — 109 — 20,135-00-00
County Number

Operator
Abercrombie Drilling, Inc. and Moble C. Hoover

Address
801 Union Center Wichita, Kansas 67202

Well No. #1 Lease Name Miller

Footage Location
1980' feet from (N) (S) line 1980' feet from (E) (W) line

Principal Contractor Abercrombie Drilling, Inc. Geologist Orlin Phelps

Spud Date July 26, 1979 Total Depth 4720' P.B.T.D.

Date Completed August 8, 1979 Oil Purchaser

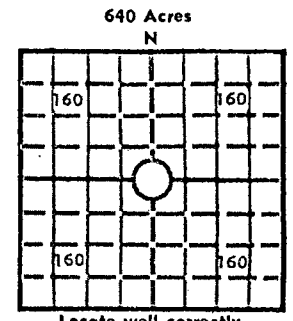

Locate well correctly
 Elev.: Gr. 3083'

DF 3086' KB 3088'

CASING RECORD

Report of all strings set— surface, intermediate, production, etc.

Purpose of string	Size hole drilled	Size casing set (in O.D.)	Weight lbs./ft.	Setting depth	Type cement	Sacks	Type and percent additives
Surface	12 1/4"	8-5/8"	20#	320'	60/40 posmix	225	3% Ca.Cl., 2% gel.

LINER RECORD

PERFORATION RECORD

Top, ft.	Bottom, ft.	Sacks cement	Shots per ft.	Size & type	Depth interval

TUBING RECORD

Size	Setting depth	Packer set at			

ACID, FRACTURE, SHOT, CEMENT SQUEEZE RECORD

Amount and kind of material used	Depth interval treated

08-23-1979

INITIAL PRODUCTION

Date of first production	Producing method (flowing, pumping, gas lift, etc.)			
RATE OF PRODUCTION PER 24 HOURS	Oil bbls.	Gas MCF	Water bbls.	Gas-oil ratio CFPB
Disposition of gas (vented, used on lease or sold)			Producing interval (s)	

INSTRUCTIONS: As provided in KCC Rule 82-2-125, within 90 days after completion of a well, one completed copy of this Drillers Log shall be transmitted to the State Geological Survey of Kansas, 4150 Monroe Street, Wichita, Kansas 67209. Copies of this form are available from the Conservation Division, State Corporation Commission, 3830 So. Meridian (P.O. Box 17027), Wichita, Kansas 66217. Phone AC 316-522-2206. If confidential custody is desired, please note Rule 82-2-125. Drillers Logs will be on open file in the Oil and Gas Division, State Geological Survey of Kansas, Lawrence, Kansas 66044.

Operator: Abercrombie Drilling, Inc. & Moble C. Hoover
 Well No.: 1 Lease Name: Miller
 DESIGNATE TYPE OF COMP.: OIL, GAS, DRY HOLE, SWDW, ETC.: Dry Hole

S 22 T12S R 33W^E_W

WELL LOG

Show all important zones of porosity and contents thereof; cored intervals, and all drill-stem tests, including depth interval tested, cushion used, time tool open, flowing and shut-in pressures, and recoveries.

SHOW GEOLOGICAL MARKERS, LOGS RUN, OR OTHER DESCRIPTIVE INFORMATION.

FORMATION DESCRIPTION, CONTENTS, ETC.	TOP	BOTTOM	NAME	DEPTH
Clay and sand	0	320	<u>SAMPLE TOPS:</u>	
Shale and sand	320	2002		
Shale	2002	2035	Anhydrite	2574' (+ 514)
Shale and sand	2035	2574	B/Anhydrite	2598' (+ 490)
Anhydrite	2574	2598	Howard	3716' (- 628)
Shale	2598	2785	Topeka	3769' (- 681)
Shale and lime	2785	2905	Heebner	3996' (- 908)
Lime and shale	2905	3923	Toronto	4019' (- 931)
Lime	3923	4720	Lansing	4048' (- 960)
Rotary Total Depth		4720	B/KC	4351' (-1263)
			Pawnee	4466' (-1378)
			Ft. Scott	4525' (-1437)
			Cherokee	4558' (-1470)
			Johnson Zone	4600' (-1512)
			Miss.	4682' (-1594)
DST #1 (3969-3990') 30", 45", 60", 45" Rec. 650' msw. IFP 43-129, IBHP 1194, FFP 161-312, FBHP 1172. Temp. 119°			<u>ELECTRIC LOG TOPS:</u>	
DST #2 (4003-4032') 30", 45", 60", 45" Rec. 30' mdy oil, 40' socm trace of water, 30' socw, 60' wtr trace of oil, 180' sw. IFP 43-64, IBHP 1225, FFP 96-172, FBHP 1215. Temp. 119°			Anhydrite	2567' (+ 521)
DST #3 (4032-4048') 30", 45", 30", 45" Rec. 15' mud. IFP 21-21, IBHP 1151, FFP 21-32, FBHP 1151. Temp. 116°			B/Anhydrite	2590' (+ 498)
DST #4 (4183-4220') 30", 45", 60", 45" Rec. 20' oil, 41', 75' ocm with trace of water (20% oil, 10% water), 105' ocw (95% water, trace of oil). IFP 43-53, IBHP 1289, FFP 75-107, FBHP 1267.			Heebner	3986' (- 898)
DST #5 (4218-4243') 30", 45", 60", 45" Rec. 2' clean oil, 60' ocmw (7% oil, 60% water), 60' socmw (8% oil, 85% water), 540' sw with a trace of oil. IFP 43-150, IBHP 1257, FFP 183-323, FBHP 1215. Temperature 124°			Toronto	4012' (- 924)
			Lansing	4034' (- 946)
			B/KC	4344' (-1256)
			Pawnee	4458' (-1370)
			Ft. Scott	4520' (-1432)
			Cherokee Sh.	4547' (-1459)
			Miss.	4659' (-1571)
			ELTD	4712'
			DTD	4720'

USE ADDITIONAL SHEETS, IF NECESSARY, TO COMPLETE WELL RECORD.

Date Received: _____
 Signature: Jerry A. Langrehr
 Title: Jerry A. Langrehr, Executive Vice-President
 Date: August 21, 1979

15-109 - 20135-00-00

DST's continued

DST #6 (4245-4270') 30", 45", 30", 45"
Rec. 10' socm
IFP 21-21, IBHP 32, FFP 21-21, FBHP 21

DST #7 (4267-4295') 30", 45", 60", 45"
Rec. 2' cl. oil, 62' ocm, 180' sw.
IFP 32-53, IBHP 1278, FFP 75-118, FBHP 1236.
Temp. 120°

DST #8 (4496-4550') 30", 45", 60", 45"
Rec. 425' of fluid, 60' mdy oil (25% oil, 60% mud),
60' hocm (10% oil, 78% mud), 60' oc mdy wtr. (5% oil
60% mud), 60' soc mdy wtr. (2% oil, 42% mud), 180'
sw, trace of oil, 120' gip and 5' cl oil.
IFP 64-107, IBHP 1056, FFP 150-237, FBHP 972.
Temp. 123° Gravity 34°

DST #9 (4564-4625') 30", 45", 30", 45"
Rec. 30' socm, 30' mud.
IFP 53-53, IBHP 1099, FFP 53-64, FBHP 1046.
Temp. 124°

DST #10 (4682-4703') 30", 45", 30", 45"
Weak blow 28"
Rec. 20' mdy oil.
IFP 21-21, IBHP 118, FFP 43-43, FBHP 140.
Temp. 125°