

15-109-20488-00-00

FAX

operator must call district prior to spudding of well

FORM MUST BE TYPED
FORM C-1 4/90

4/29/90 State of Kansas

EFFECTIVE DATE: NOTICE OF INTENTION TO DRILL

FORM MUST BE SIGNED
ALL BLANKS MUST BE FILLED

Must be approved by the K.C.C. five (5) days prior to commencing well

Expected Spud Date 4 27 90
month day year

SE SE SE Sec 18 Twp 12 S, Rg 33 East West

OPERATOR: License # 5886
Name: Chief Drilling Co., Inc.
Address: 224 E. Douglas #530
City/State/Zip: Wichita, Ks. 67202
Contact Person: Douglas W. Thimesch
Phone: 316 262-3791

330 feet from South line of Section
330 feet from East line of Section
(Note: Locate well on Section Plat on Reverse Side)

CONTRACTOR: License #: 5883
Name: Warrior Drilling Co.

County: Logan
Lease Name: Bouziden Well #: 1-18
Field Name: Janice South Wildcat

Well Drilled For: Well Class: Type Equipment:

Is this a Prorated Field? yes X no
Target Formation(s): Lansing, Cherokee
Nearest lease or unit boundary: 330 ft.
Ground Surface Elevation: 3170 feet MSL

X Oil ... Inj ... Infield X Mud Rotary
... Gas ... Storage X Pool Ext. ... Air Rotary
... OWWO ... Disposal ... Wildcat ... Cable
... Seismic; ... # of Holes

Domestic well within 330 feet: yes X no
Municipal well within one mile: yes X no
Depth to bottom of fresh water: 150
Depth to bottom of usable water: 1700 1750

If OWWO: old well information as follows:

Operator: _____
Well Name: _____
Comp. Date: _____ Old Total Depth _____

Surface Pipe by Alternate: 1 X 2
Length of Surface Pipe Planned to be set: 365
Length of Conductor pipe required: N/A
Projected Total Depth: 4775
Formation at Total Depth: Mississippi

Directional, Deviated or Horizontal wellbore? yes X no
If yes, total depth location: N/A

Water Source for Drilling Operations:
X well ... farm pond ... other
DWR Permit #: 38167

Will Cores Be Taken?: yes X no
If yes, proposed zone: _____

AFFIDAVIT

The undersigned hereby affirms that the drilling, completion and eventual plugging of this well will comply with K.S.A. 55-101, et. seq.

It is agreed that the following minimum requirements will be met:

1. The appropriate district office shall be notified before setting surface pipe;
2. The minimum amount of surface pipe as specified above shall be set by circulating cement to the top; in all cases surface pipe shall be set through all unconsolidated materials plus a minimum of 20 feet into the underlying formation;
3. If the well is dry, a plugging proposal shall be submitted to the district office. An agreement between the operator and the district office on plug length and placement is necessary prior to plugging;
4. The appropriate district office will be notified before well is either plugged or production casing is cemented in;
5. If an Alternate II completion, production pipe shall be cemented from bottom any usable water to surface within 120 days of spud date. In all cases, notify district office prior to any cementing.

I hereby certify that the statements made herein are true and to the best of my knowledge and belief.

Date: 4/23/90 Signature of Operator or Agent: [Signature] Title: [Signature]

FOR KCC USE:

API # 15- 109 - 20,488-00-00

Conductor pipe required NONE feet

Minimum surface pipe required 250 feet per Alt. X(2)

Approved by: BGF 4/24/90

EFFECTIVE DATE: 4/29/90

This authorization expires: 10/24/90

(This authorization void if drilling not started within 6 months of effective date.)

Spud date: _____ Agent: _____

RECEIVED
STATE REFORMATION COMMISSION
WICHITA, KANSAS
APR 24 1990
04-24-1990
CONSERVATION DIVISION

18 125 33W

REMEMBER TO:

- File Drill Pit Application (form CDP-1) with Intent to Drill;
- File Completion Form ACO-1 within 120 days of spud date;
- File acreage attribution plat according to field proration orders;
- Notify appropriate district office 48 hours prior to workover or re-entry;
- Submit plugging report (CP-4) after plugging is completed;
- Obtain written approval before disposing or injecting salt water.

PLAT OF ACREAGE ATTRIBUTABLE TO A WELL

State Corporation Commission, Conservation Division
200 Colorado Derby Bldg. Wichita, Kansas 67202

OPERATOR Chief Drilling Co., Inc. LOCATION OF WELL:
 LEASE Bouziden 330 feet north of SE corner
 WELL NUMBER #1-18 330 feet west of SE corner
 FIELD _____ SE Sec. 18 T 12S R 33 E/W
 COUNTY Logan
 NO. OF ACRES ATTRIBUTABLE TO WELL 10 IS SECTION X REGULAR _____ IRREGULAR?
 DESCRIPTION OF ACREAGE SE/4 IF IRREGULAR, LOCATE WELL FROM NEAREST
 CORNER BOUNDARY.

NOTE: If plat depicted is insufficient for your circumstances, you may attach your own scaled or surveyed plat.

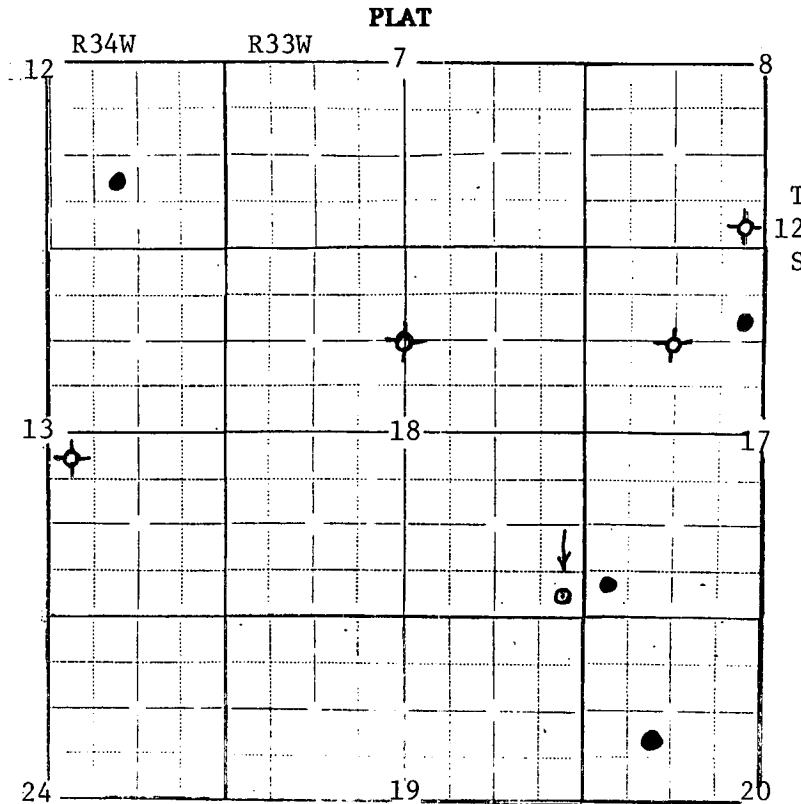

In plotting the proposed location of the well, you must show:

- 1) The manner in which you are using the depicted plat by identifying section lines, i.e. 1 section, 1 section with 8 surrounding partial sections, 4 sections, 16 sections, etc.;
- 2) the well's location relative to the location of other wells producing from the same common source of supply in adjoining drilling units, pursuant to K.A.R. 82-3-108, 82-3-207, 82-3-312, or special orders of the Commission;
- 3) the distance of the proposed drilling location from the section's east and south lines; and
- 4) the distance to the nearest lease or unit boundary line.

I hereby certify that the statements made herein are true and to the best of my knowledge and belief.

Signature of Operator or Agent _____

Date 4/23/90 Title Chief Drilling Co., Inc.