

15-193-20148-0000

STATE OF KANSAS
STATE CORPORATION COMMISSION

WELL PLUGGING RECORD

Give All Information Completely
Make Required Affidavit
Mail or Deliver Report to
Conservation Division
State Corporation Comm.
245 North Water
Wichita, KS 67202

THOMAS County. Sec. 31 Twp. 10S Rge. 32 E/W
Location as "NE/CNW $\frac{1}{4}$ SW $\frac{1}{4}$ " or footage from lines
NW SE

Lease Owner DANE G HANSEN TRUST
Lease Name HECKER Well No. 4
Office Address P O BOX 187, LOGAN, KS 67646
Character of Well (Completed as Oil, Gas or Dry Hole) DRY HOLE

Date Well completed 8/25/77 19
Application for plugging filed 8/25/77 19
Application for plugging approved 8/25/77 19
Plugging commenced 8/25/77 19
Plugging completed 8/25/77 19

Reason for abandonment of well or producing formation TOO LOW STRUCTURALLY

If a producing well is abandoned, date of last production 19

Was permission obtained from the Conservation Division or its agents before plugging was commenced? ES

Name of Conservation Agent who supervised plugging of this well GILBERT BALTHAZOR, PALCO, K
Producing formation _____ Depth to top _____ Bottom _____ Total Depth of Well 4610'
Show depth and thickness of all water, oil and gas formations.

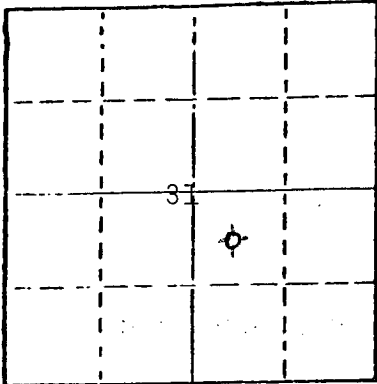

Locate well correctly on above Section Plot

OIL, GAS OR WATER RECORDS

CASING RECORD

FORMATION	CONTENT	FROM	TO	SIZE	PUT IN	PULLED OUT
				8 5/8"	303.56'	NONE

Describe in detail the manner in which the well was plugged, indicating where the mud fluid was placed and the method or methods used in introducing it into the hold. If cement or other plugs were used, state the character of same and depth placed, from _____ feet to _____ feet for each plug set.

FILLED WITH HEAVY MUD TO 1550'. 9-13-77
SET PLUG, PUT IN 70 SACKS CEMENT.
FILLED WITH HEAVY MUD TO 240'. SET
PLUG. PUT IN 20 SACKS CEMENT. FILLED
WITH HEAVY MUD TO 40'. SET PLUG. FILLED
TO TOP WITH 10 SACKS CEMENT.

(If additional description is necessary, use BACK of this sheet)

Name of Plugging Contractor C-G DRILLING CO
1107 DOUGLAS BLDG, WICHITA, KS 67202

STATE OF KANSAS COUNTY OF SEDGWICK ss.
JAY H GALLOWAY (employee of owner) or (owner or operator) of the above-described

well, being first duly sworn on oath, says: That I have knowledge of the facts, statements, and matters herein contained and the log of the above-described well as filed and that the same are true and correct. So help me God.

(Signature) Jay H Galloway
1107 DOUGLAS BLDG, WICHITA, KS 67202 (Address)

SUBSCRIBED AND SWORN TO before me this 30TH day of AUGUST, 1977

My commission expires MARCH 3, 1980

Debra L Heersche
DEBRA L HEERSCHKE Notary Public.

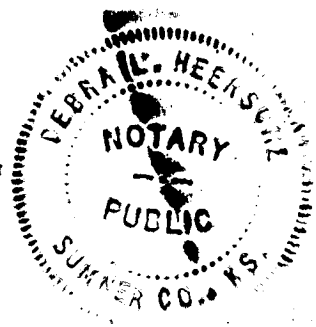

15-193-20148-0000

KANSAS DRILLERS LOG

S. 31 T. 10S R. 32 ^{NE}W

API No. 15 _____
 County _____ Number _____

Loc. NW SE

County THOMAS

Operator
 DANE G HANSEN TRUST

Address
 P O BOX 187, LOGAN, KS 67646

Well No. 4 Lease Name HECKER

Footage Location
 1980 feet from (N) (S) line 1980 feet from (E) (W) line

Principal Contractor C-G DRILLING CO Geologist J. JESPERSEN

Spud Date 8/16/77 Total Depth 610' P.B.T.D.

Date Completed 8/25/77 Oil Purchaser

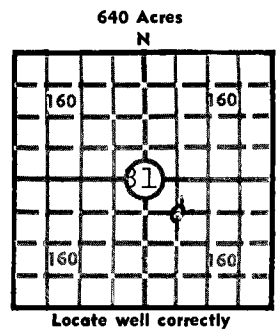

Elev.: Gr. _____

DF _____ KB 3085'

CASING RECORD

Report of all strings set — surface, intermediate, production, etc.

Purpose of string	Size hole drilled	Size casing set (in O.D.)	Weight lbs/ft.	Setting depth	Type cement	Sacks	Type and percent additives
SURFACE	12 1/4"	8 5/8"	28#	303.56	COMMON	180	2% Gel 3% CC

LINER RECORD

PERFORATION RECORD

Top, ft.	Bottom, ft.	Sacks cement	Shots per ft.	Size & type	Depth interval

TUBING RECORD

Size	Setting depth	Packer set at

ACID, FRACTURE, SHOT, CEMENT SQUEEZE RECORD

Amount and kind of material used	Depth interval treated

INITIAL PRODUCTION

Date of first production		Producing method (flowing, pumping, gas lift, etc.)			
RATE OF PRODUCTION PER 24 HOURS	Oil	Gas	Water	Gas-oil ratio	
	bbls.	MCF	bbls.	CFPB	
Disposition of gas (vented, used on lease or sold)			Producing interval(s)		

INSTRUCTIONS: As provided in KCC Rule 82-2-125, within 90 days after completion of a well, one completed copy of this Drillers Log shall be transmitted to the State Geological Survey of Kansas, 4150 Monroe Street, Wichita, Kansas 67209. Copies of this form are available from the Conservation Division, State Corporation Commission, 3830 So. Meridian (P.O. Box 17027), Wichita, Kansas 66217. Phone AC 316-522-2206. If confidential custody is desired, please note Rule 82-2-125. Drillers Logs will be on open file in the Oil and Gas Division, State Geological Survey of Kansas, Lawrence, Kansas 66044.

Operator **DANE G HANSEN TRUST** DESIGNATE TYPE OF COMP.: OIL, GAS, DRY HOLE, SWDW, ETC.: **DRY HOLE**

Well No. **4** Lease Name **HECKER**

S 21 T 10 ~~S~~ 32 ^{EX} W

WELL LOG
 Show all important zones of porosity and contents thereof; cored intervals, and all drill-stem tests, including depth interval tested, cushion used, time tool open, flowing and shut-in pressures, and recoveries. **SHOW GEOLOGICAL MARKERS, LOGS RUN, OR OTHER DESCRIPTIVE INFORMATION.**

FORMATION DESCRIPTION, CONTENTS, ETC.	TOP	BOTTOM	NAME	DEPTH
SHALE & SAND	0	1300		
SHALE	1300	1880		
SHALE & SAND	1880	2260		
SHALE & SAND & RED BED	2260	2684		
ANHYDRITE	2684	2629		
RED BED & SHALE	2629	2700		
SHALE & SHELLS	2700	2922		
SHALE & LIME	2922	3105		
LIME & SHALE	3105	3915		
LIME & RTD	3915	4610		
DST #1: 4179-4210' 30-30-30-30. WEAK BLOW FOR 10 MIN. REC 10' MUD. IBHP 48#, FBHP 36#, IFP 12#, FFP 12#.				
DST #2: 4218-4258' 30-30-30-30. WEAK BLOW FOR 20 MIN. REC 15' MUD. IBHP 329#, FBHP 170#, IFP 68#, FFP 79#.				
DST #3: 4295-4317' 30-30-30-30. REC 5' MUD. IBHP 114#, FBHP 102#, IFP 68#, FFP 68#.				
DST #4: 4575-4610' 30-30-30-30. WEAK BLOW FOR 11 MIN. REC 5' MUD. IBHP 44#, FBHP 44#, IFP 34#, FFP 34#.				

USE ADDITIONAL SHEETS, IF NECESSARY, TO COMPLETE WELL RECORD.

Date Received	<i>Debra L Heersche</i> Signature
	DEBRA L HEERSCHE, OFFICE MANAGER Title
	9/2/77 Date