

FOR KCC USE:

FORM C-1 7/91

15-167-23228-00-00

FORM MUST BE TYPED

EFFECTIVE DATE: 1-11-03

State of Kansas

FORM MUST BE SIGNED

DISTRICT # 4

NOTICE OF INTENTION TO DRILL

ALL BLANKS MUST BE FILLED

SGA? Yes No

Must be approved by the K.C.C. five (5) days prior to commencing well.

Expected Spud Date 1 8 2003 month day year

Spot 90'S & 90'W N/2 NE SW Sec 22 Twp 11 S, Rg 15 West

RECEIVED 2220 3390

OPERATOR: License # 6194 ESP Development, Inc. Address: 17746 177th. Boulevard Paradise, Kansas 67658 Contact Person: Bud Eulert Phone: 785-998-4413

CONTRACTOR: License # 9431 Vonfeldt Drilling, Inc.

Well Drilled For: Oil Gas OAWO Seismic; Other Well Class: Enh Rec Storage Disposal # of Holes Infield Pool Ext. Wildcat Other Type Equipment: Mud Rotary Air Rotary Cable

If OAWO: old well information as follows: Operator: Well Name: Comp. Date: Old Total Depth

Directional, Deviated or Horizontal wellbore? yes no If yes, true vertical depth: Bottom Hole Location:

feet from South/West line of Section IS SECTION X REGULAR IRREGULAR? (NOTE: Locate well on the Section Plat on Reverse Side) County: Russell Lease Name: Eulert Ranch C Well #: 4 Field Name: HAGAMAN NORTH Is this a Prorated/Spaced Field? yes no Target Formation(s): Arbuckle Nearest lease or unit boundary: 420 Ground Surface Elevation: 1809 feet MSL Water well within one-quarter mile: yes no Public water supply well within one mile: yes no Depth to bottom of fresh water: 180 Depth to bottom of usable water: 460 Surface Pipe by Alternate: 1 200 Length of Surface Pipe Planned to be set: Length of Conductor pipe required: -0- NONE Projected Total Depth: 3400 Formation at Total Depth: Arbuckle Water Source for Drilling Operations: well farm pond other Will Cores Be Taken?: yes no If yes, proposed zone:

AFFIDAVIT

The undersigned hereby affirms that the drilling, completion and eventual plugging of this well will comply with K.S.A. 55-101, et. seq.

It is agreed that the following minimum requirements will be met:

- 1. Notify the appropriate district office prior to spudding of well;
2. A copy of the approved notice of intent to drill shall be posted on each drilling rig;
3. The minimum amount of surface pipe as specified below shall be set by circulating cement to the top; in all cases surface pipe shall be set through all unconsolidated materials plus a minimum of 20 feet into the underlying formation;
4. If the well is dry hole, an agreement between the operator and the district office on plug length and placement is necessary prior to plugging;
5. The appropriate district office will be notified before well is either plugged or production casing is cemented in;
6. IF AN ALTERNATE II COMPLETION, PRODUCTION PIPE SHALL BE CEMENTED FROM BELOW ANY USABLE WATER TO SURFACE WITHIN 120 DAYS OF SPUD DATE. IN ALL CASES, NOTIFY DISTRICT OFFICE PRIOR TO ANY CEMENTING.

I hereby certify that the statements made herein are true and to the best of my knowledge and belief. Date: 1-3-03 Signature of Operator or Agent: Mary Payne Title: Agent

FOR KCC USE: API # 15-167-23228-00-00 Conductor pipe required NONE feet Minimum surface pipe required 200 feet per Alt. #2 Approved by: BSP 1-6-03 This authorization expires: 7-6-03 (This authorization void if drilling not started within 6 months of effective date.) Spud date: Agent:

REMEMBER TO:

- File Drill Pit Application (form CDP-1) with Intent to Drill;
- File Completion Form ACO-1 within 120 days of spud date;
- File acreage attribution plat according to field proration orders;
- Notify appropriate district office 48 hours prior to workover or re-entry;
- Submit plugging report (CP-4) after plugging is completed;
- Obtain written approval before disposing or injecting salt water.

Mail to: KCC - Conservation Division, 130 S. Market - Room 207B, Wichita, Kansas 67202.

22 11 15 W

IN ALL CASES PLOT THE INTENDED WELL ON THE PLAT BELOW

PLAT OF ACREAGE ATTRIBUTABLE TO A WELL IN A PRORATED OR SPACED FIELD

If the intended well is in a prorated or spaced field, please fully complete this side of the form. If the intended well is in a prorated or spaced field complete the plat below showing that the well will be properly located in relationship to other wells producing from the common source of supply. Please show all the wells within 1 mile of the boundaries of the proposed acreage attribution unit for gas wells and within 1/2 mile of the boundaries of the proposed acreage attribution unit for oil wells.

API NO. 15- _____
 OPERATOR _____ LOCATION OF WELL: COUNTY _____
 LEASE _____ feet from south/north line of section
 WELL NUMBER _____ feet from east/west line of section
 FIELD _____ SECTION _____ TWP _____ RG _____

NUMBER OF ACRES ATTRIBUTABLE TO WELL _____ IS SECTION _____ REGULAR or _____ IRREGULAR
 QTR/QTR/QTR OF ACREAGE _____ IF SECTION IS IRREGULAR, LOCATE WELL FROM NEAREST CORNER BOUNDARY.

Section corner used: _____ NE _____ NW _____ SE _____ SW

PLAT

(Show location of the well and shade attributable acreage for prorated or spaced wells.)
 (Show footage to the nearest lease or unit boundary line.)

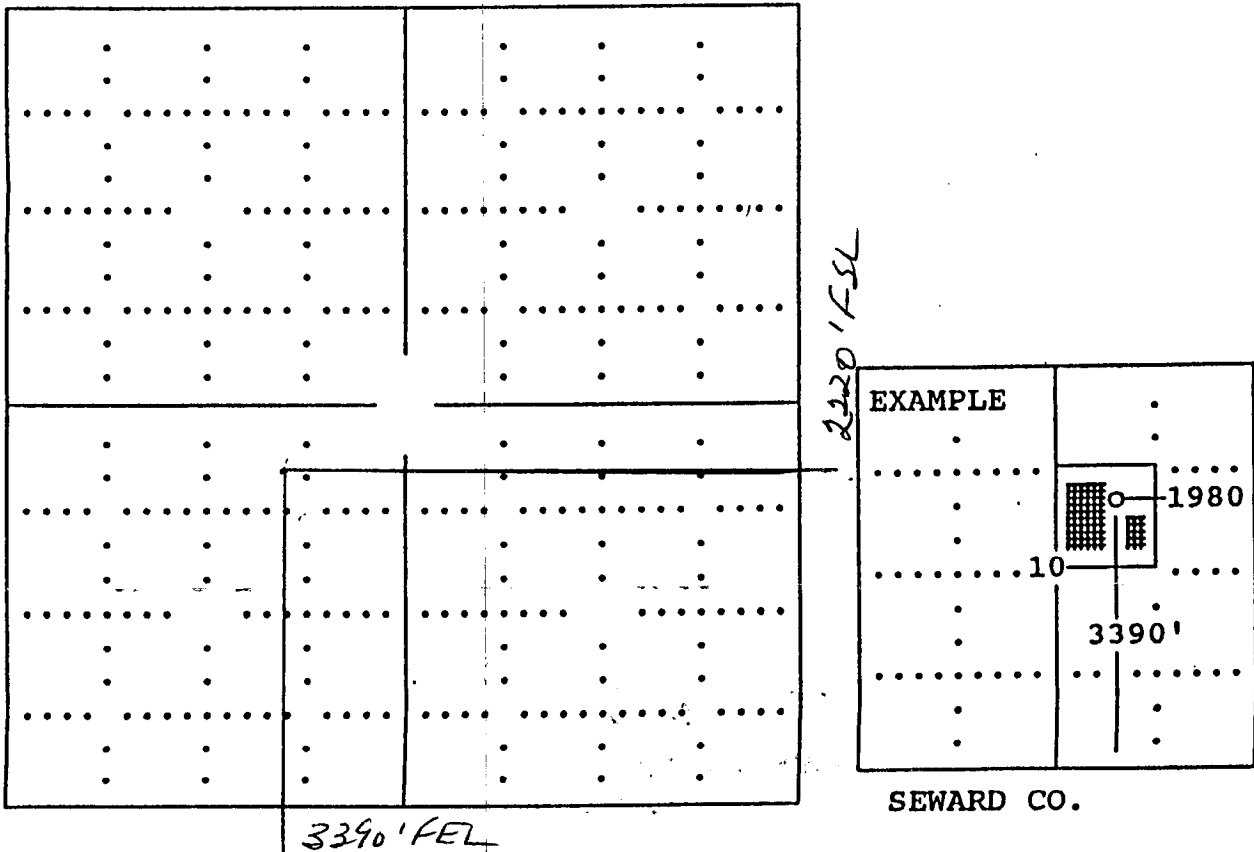

In plotting the proposed location of the well, you must show:

- 1) The manner in which you are using the depicted plat by identifying section lines, i.e. 1 section, 1 section with 8 surrounding sections, 4 sections, etc.;
- 2) the distance of the proposed drilling location from the section's south/north and east/west; and
- 3) the distance to the nearest lease or unit boundary line.