

FOR KCC USE:

FORM MUST BE TYPED  
FORM MUST BE SIGNED  
ALL BLANKS MUST BE FILLED

EFFECTIVE DATE: 4-26-94

State of Kansas

DISTRICT # 1  
SEAT, Yes No

NOTICE OF INTENTION TO DRILL

Must be approved by the K.C.C. five (5) days prior to commencing well

Expected Spud Date 4 4 1994  
month day year

Spud NW NW  
N/2 N/2 NW Sec 15 Twp 34 S, Rg 20 X East West

OPERATOR: License # 31232  
Name: Cody Energy, Inc.  
Address: 7555 E. Hampden Ave. Ste. 600  
City/State/Zip: Denver, CO 80231  
Contact Person: Rock Petty  
Phone: (915) 686 0181

330 feet from South / North line of Section  
1320-330 feet from East / West line of Section  
IS SECTION X REGULAR IRREGULAR?

CONTRACTOR: License # 30692  
Name: H-40 Drilling, Inc.

(NOTE: Locate well on the Section Plat on Reverse Side)  
County: Comanche  
Lease Name: Bobwhite Well #: 15-1  
Field Name: Wildcat

Well Drilled For: Well Class: Type Equipment:  
X. Oil ... Enh Rec ... Infield X. Mud Rotary  
... Gas ... Storage ... Pool Ext. ... Air Rotary  
... OWWO ... Disposal X. Wildcat ... Cable  
... Seismic; ... # of Holes ... Other  
... Other

Is this a Prorated/Spaced Field? ... yes X no  
Target Formation(s): Arbuckle Viola  
Nearest lease or unit boundary: 330  
Ground Surface Elevation: 1745-1755 feet MSL

If OWWO: old well information as follows:  
Operator:  
Well Name:  
Comp. Date: Old Total Depth

Water well within one-quarter mile: X yes ... no  
Public water supply well within one mile: X yes ... no  
Depth to bottom of fresh water: 100  
Depth to bottom of usable water: 180  
Surface Pipe by Alternate: X 1 2  
Length of Surface Pipe Planned to be set: 600  
Length of Conductor pipe required: None

Directional, Deviated or Horizontal wellbore? ... yes X no  
If yes, true vertical depth:  
Bottom Hole Location:

Projected Total Depth: 6800  
Formation at Total Depth: Arbuckle  
Water Source for Drilling Operations:  
... well ... farm pond X other  
DWR Permit #: NA  
Will Cores Be Taken? ... yes X no

AFFIDAVIT

RECEIVED

KANSAS CORPORATION COMMISSION

The undersigned hereby affirms that the drilling, completion and eventual plugging of this well will comply with K.S.A. 55-101, et. seq.  
It is agreed that the following minimum requirements will be met:

MAR 21 1994

- 1. Notify the appropriate district office prior to spudding of well;
- 2. A copy of the approved notice of intent to drill shall be posted on each drilling rig; CONSERVATION DIVISION WICHITA, KS
- 3. The minimum amount of surface pipe as specified below shall be set by circulating cement to the top; in all cases surface pipe shall be set through all unconsolidated materials plus a minimum of 20 feet into the underlying formation;
- 4. If the well is dry hole, an agreement between the operator and the district office on plug length and placement is necessary prior to plugging;
- 5. The appropriate district office will be notified before well is either plugged or production casing is cemented in;
- 6. IF AN ALTERNATE II COMPLETION, PRODUCTION PIPE SHALL BE CEMENTED FROM BELOW ANY USABLE WATER TO SURFACE WITHIN 120 DAYS OF SPUD DATE. IN ALL CASES, NOTIFY DISTRICT OFFICE PRIOR TO ANY CEMENTING.

I hereby certify that the statements made herein are true and to the best of my knowledge and belief.  
Date: 3/18/94 Signature of Operator or Agent: Rock Petty Rock Petty Title: District Engineer

FOR KCC USE:  
API # 15- 033-20885  
Conductor pipe required NONE feet  
Minimum surface pipe required 200' feet per Alt. ① X  
Approved by: 03 4-21-94  
This authorization expires: 10-21-94  
(This authorization void if drilling not started within 6 months of effective date.)  
Spud date: Agent:

REMEMBER TO:

- File Drill Pit Application (form CDP-1) with Intent to Drill;
- File Completion Form ACO-1 within 120 days of spud date;
- File acreage attribution plat according to field prorations orders;
- Notify appropriate district office 48 hours prior to workover or re-entry;
- Submit plugging report (CP-4) after plugging is completed;
- Obtain written approval before disposing or injecting salt water.

15  
34  
20

IN ALL CASES PLOT THE INTENDED WELL ON THE PLAT BELOW

**PLAT OF ACREAGE ATTRIBUTABLE TO A WELL IN A PRORATED OR SPACED FIELD**

If the intended well is in a prorated or spaced field, please fully complete this side of the form. If the intended well is in a prorated or spaced field complete the plat by showing that the well will be properly located in relationship to other wells producing from the common source of supply. Please show all the wells within 1 mile of the boundaries of the proposed acreage attribution unit for gas wells and within 1/2 mile of the boundary of the proposed acreage attribution unit for oil wells.

API NO. 15- \_\_\_\_\_  
 OPERATOR Cody Energy, Inc.  
 LEASE Bobwhite  
 WELL NUMBER 15-1  
 FIELD Wildcat

LOCATION OF WELL: COUNTY Comanche  
330 feet from south/north line of section  
1320 feet from east/west line of section  
 SECTION 15 TWP 34S RG 20W

NUMBER OF ACRES ATTRIBUTABLE TO WELL NA  
 QTR/QTR/QTR OF ACREAGE N/2 - N/2 - NW

IS SECTION X REGULAR or IRREGULAR  
IF SECTION IS IRREGULAR, LOCATE WELL FROM NEAREST CORNER BOUNDARY.

Section corner used: NE NW SE SW  
**PLAT**

(Show location of the well and shade attributable acreage for prorated or spaced wells.  
 (Show footage to the nearest lease or unit boundary line.)

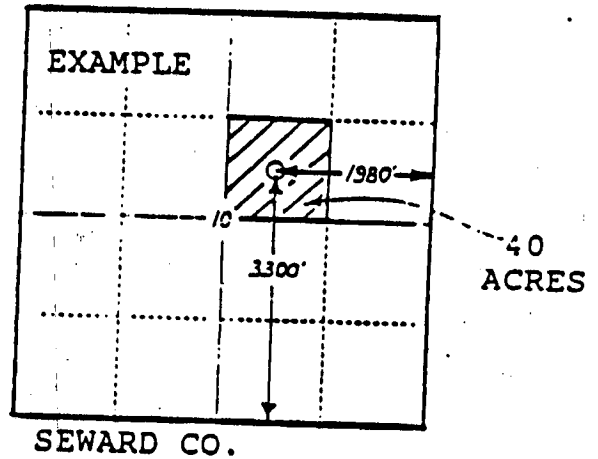
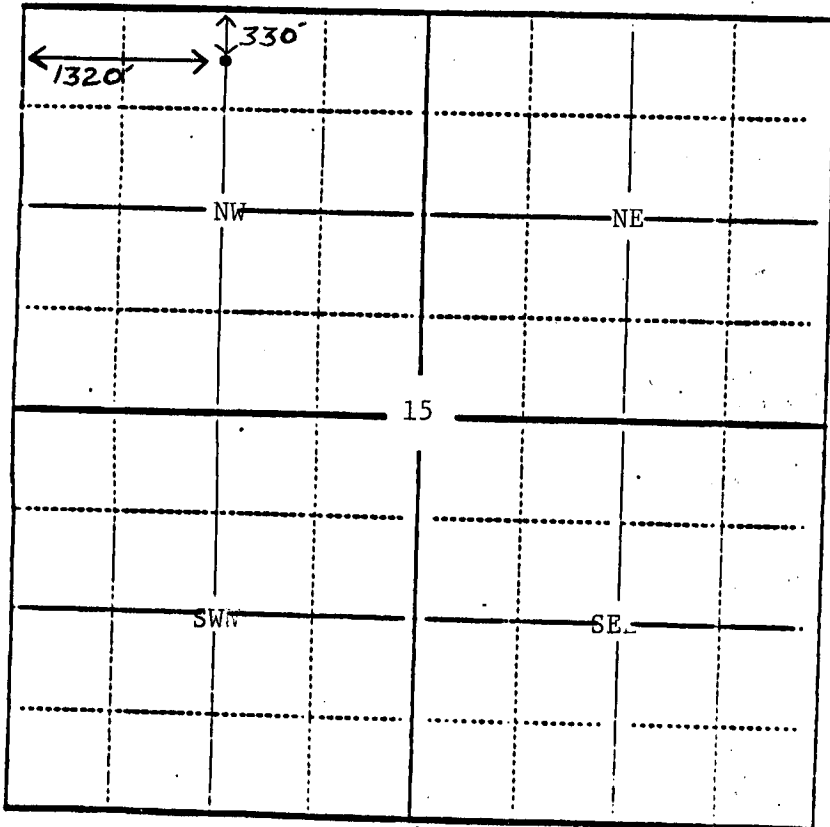

In plotting the proposed location of the well, you must show:

- 1) The manner in which you are using the depicted plat by identifying section lines, i.e. 1 section, 1 section with 8 surrounding sections, 4 sections, etc.;
- 2) the distance of the proposed drilling location from the section's south/north and east/west lines; and
- 3) the distance to the nearest lease or unit boundary line.