

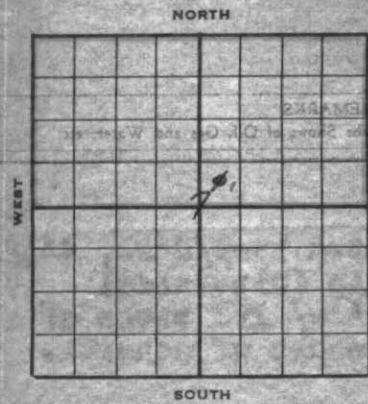

15-051-19301-0000

# SKELLY OIL COMPANY



Well Record  
34105

Lease Name and No. Cora R. Hedine Well No. 1 Elev. 1827'  
 Lease Description 1/2 Section 7-11-16N,  
Ellis County, Kansas  
 Location made September 13, 1948 by C. A. Richter  
 feet from North line \_\_\_\_\_ feet from East line 80/4  
300 feet from South line 220 feet from West line of 300.7

Work com'd 9/18 1948 Rig comp'd 9/25 1948 Drlg. com'd 9/25 1948 Drlg. comp'd 10/14 1948  
 Rig Contractor Charles Malone Drilling Company  
 Drilling Contractor Charles Malone Drilling Company, Great Bend, Kansas  
 Rotary Drilling from Top to 3425' Cable Tool Drilling from \_\_\_\_\_ to \_\_\_\_\_  
 Commenced Producing DRY HOLE 19\_\_\_\_ Initial Prod. before shot or acid \_\_\_\_\_ Bbls.  
 Initial Prod. after shot or acid \_\_\_\_\_ Bbls.  
 Dry Gas Well Press \_\_\_\_\_ Volume \_\_\_\_\_ Cu. ft.  
 Casing Head Gas Pressure \_\_\_\_\_ Volume \_\_\_\_\_ Cu. ft.  
 Braden Head (3-3/8 Size 20-5/8) Gas Pressure \_\_\_\_\_ Volume \_\_\_\_\_ Cu. ft.  
 Braden Head ( \_\_\_\_\_ Size \_\_\_\_\_ ) Gas Pressure \_\_\_\_\_ Volume \_\_\_\_\_ Cu. ft.

PRODUCING FORMATION DRY HOLE (Name) Top \_\_\_\_\_ Bottom \_\_\_\_\_ TOTAL DEPTH 3425'

### CASING RECORD

OD	Size	Wt.	Thds.	Where Set	PULLED OUT			LEFT IN			KIND	Cond'n	CEMENTING		
					Jts.	Feet	In.	Jts.	Feet	In.			Sacks Used	Method Employed	
	13-3/8	44	BT	196'				5	191	10	30	A	200	Halliburton	
	8-5/8	28	BR	1035'	635	7	13	403	11	40	32	RBW	A	75	Halliburton
(13-3/8" casing set 6' in collar and 8-5/8" set 4' in collar)															
Used 1 - 8-1/8" Baker Combination Plug & Float Shoe															

Liner Set at \_\_\_\_\_ Length \_\_\_\_\_ Perforated at \_\_\_\_\_  
 Liner Set at \_\_\_\_\_ Length \_\_\_\_\_ Perforated at \_\_\_\_\_  
 Packer Set at \_\_\_\_\_ Size and Kind \_\_\_\_\_  
 Packer Set at \_\_\_\_\_ Size and Kind \_\_\_\_\_

### SHOT OR ACID TREATMENT RECORD

	FIRST		SECOND		THIRD		FOURTH	
Date								
Acid Used	Gals. Qts.		Gals. Qts.		Gals. Qts.		Gals. Qts.	
Size Shot	Ft. and Ft.		Ft. and Ft.		Ft. and Ft.		Ft. and Ft.	
Shot Between								
Size of Shell								
Put in by (Co.)								
Length anchor								
Distance below Cas'g								
Damage to Casing or Casing Shoulder								

### SIGNIFICANT GEOLOGICAL FORMATIONS

NAME	Top	Bottom	GAS		OIL		REMARKS
			From	To	From	To	
anhydrite	1025'						
Hessner shale	2985'						
Lansing Linc	3031'						
Conglomerate	3284'						
Simpson Shale	3392'						
Shuckle Line	3410'						

### CLEANING OUT RECORDS

	DATE COMMENCED	DATE COMPLETED	PROD. BEFORE	PROD. AFTER	REMARKS
1st					See Reverse for other details.
2nd					" " " " "
3rd					" " " " "
4th					" " " " "

### PLUGGING BACK AND DEEPENING RECORDS

	Date Commenced	Date Completed	No. Feet Plugged Back or Deepened	Prod. Before	Prod. After	REMARKS
1st						See Reverse for other details.
2nd						" " " " "
3rd						" " " " "
4th						" " " " "

(See Reverse for Record of Formation)

RECORD OF FORMATIONS

FORMATION	TOP	BOTTOM	REMARKS
Surface soil and clay	0	40	
Clay, sand and gravel	40	165	
Clay, sand and gravel	165	196	
Shale and rock	196	290	
Shale, shells and red bed	290	310	
Shale, shells and red bed	310	775	
Shale, red bed and iron	775	905	
Shale, shells and anhydrite	905	1035	TOP ANHYDRITE 1025'
Anhydrite and shale	1035	1135	Set and cemented 8-5/8" OD, 28' length, N-40, R-2, A.M.W. steel casing at 1035' w/ 75 sacks.
Shale and shells	1135	1718	
Line and shale	1718	2025	
Line	2025	2130	
Line and shale	2130	2630	
Shale	2630	2745	
Line and shale	2745	2968	
Shale	2968	2979	
Line and shale	2979	3025	
Line	3025	3175	TOP MEMBER SHALE 2985'
Cherty lime	3175	3240	TOP LIMESTONE LINE 3031'
Line and shale	3240	3300	
Cherty lime and shale	3300	3345	TOP CONGLOMERATE 3284'
Line and shale	3345	3367	TOP SIMPSON SHALE 3392'
Cherty lime and shale	3367	3410	TOP ANHYDRITE LINE 3410'
Dolomite	3410	3425	Good porosity, no shows, probable water
<b>TOTAL DEPTH</b>		<b>3425'</b>	

Since no commercial production of oil or gas was encountered in drilling in limestone to 3425', regular authority was granted to plug and abandon the well.

On October 15, 1948, the well was plugged as follows:

20 sacks of cement  
Mud laden fluid

Shot 8-5/8" casing off at 635' with 3 quarts of nitroglycerin and pulled 635' of casing above that point.

DATE	DEPTH	DESCRIPTION	REMARKS
10/15/48	1035' to 981'	20 sacks of cement	
	981' to 200'	Mud laden fluid	
	200' to 176'	20 sacks of cement	
	176' to 20'	Mud laden fluid	
	20' to 0'	15 sacks of cement	
	0' to 0'	Surface soil	

Finished plugging 8:00 AM October 16, 1948.

**PLUGGING**  
FILE SEC 7-T-11-R-160  
BOOK PAGE 62-UNR-16

LOGS TEST DATA  
Log tests were taken at 250' intervals from 20' to 3425'. Deviation from vertical noted.

NAME	TOP	BOTTOM	OIL		GAS		REMARKS
			TO	FROM	TO	FROM	

DATE COMPLETED	DATE COMPLETED	PROD. BEGINS	PROD. BEGINS	REMARKS

DATE COMPLETED	DATE COMPLETED	PROD. BEGINS	PROD. BEGINS	REMARKS

(See Reverse for Record of Formations)