

FOR KCC USE:

15-051-24964-00-80

FORM C-1 7/91

FORM MUST BE TYPED

FORM MUST BE SIGNED

ALL BLANKS MUST BE FILLED

EFFECTIVE DATE: 4-28-97

State of Kansas

DISTRICT # 4

NOTICE OF INTENTION TO DRILL

SGA? Yes No

Must be approved by the K.C.C. five (5) days prior to commencing well

Expected Spud Date 5-15-97 month day year

Spot SW SE SW Sec 10 Twp 13 S Rg 17W East West

OPERATOR: License # 7064 Name: Cattleman's Oil Operations Address: 2260 Catherine Rd. City/State/Zip: Hays, Kansas 67601 Contact Person: Leo Darzweiler Phone: 913-625-5394

330 feet from South North line of Section 1650 feet from East West line of Section IS SECTION X REGULAR IRREGULAR?

(NOTE: Locate well on the Section Plat on Reverse Side)

County: Ellis Lease Name: Darzweiler G. Well #: 11 Field Name: Catherine North

CONTRACTOR: License #: 9431 Name: VonFeldt Drilling

Is this a Prorated/Spaced Field? yes X no Target Formation(s): Arbuckle

Nearest lease or unit boundary: 330 Ground Surface Elevation: 1990 feet MSL

Well Drilled For: Well Class: Type Equipment:

- X Oil Enh Rec X Infield X Mud Rotary Gas Storage Pool Ext Air Rotary OWD Disposal Wildcat Cable Seismic # of Holes Other

Water well within one-quarter mile: X yes no Public water supply well within one mile: X yes no

Depth to bottom of fresh water: 460 180 Depth to bottom of usable water: 700

Surface Pipe by Alternate: 1 X 2 Length of Surface Pipe Planned to be set: 160 200

Length of Conductor pipe required: NA MIN Projected Total Depth: 3500

If OWD: old well information as follows:

Operator: Well Name: Comp. Date: Old Total Depth

Formation at Total Depth: Arbuckle

Water Source for Drilling Operations: well X farm pond other

Directional, Deviated or Horizontal wellbore? yes X no

DWR Permit #: Will Cores Be Taken? yes X no

If yes, true vertical depth: Bottom Hole Location:

If yes, proposed zone:

AFFIDAVIT

The undersigned hereby affirms that the drilling, completion and eventual plugging of this well will comply with K.S.A. 55-101, et. seq.

It is agreed that the following minimum requirements will be met:

- 1. Notify the appropriate district office prior to spudding of well; 2. A copy of the approved notice of intent to drill shall be posted on each drilling rig; 3. The minimum amount of surface pipe as specified below shall be set by circulating cement to the top; in all cases surface pipe shall be set through all unconsolidated materials plus a minimum of 20 feet into the underlying formation; 4. If the well is dry hole, an agreement between the operator and the district office on plug length and placement is necessary prior to plugging; 5. The appropriate district office will be notified before well is either plugged or production casing is cemented in; 6. IF AN ALTERNATE IS COMPLETED, PRODUCTION PIPE SHALL BE CEMENTED FROM BELOW ANY USABLE WATER TO SURFACE WITHIN 120 DAYS OF SPUD DATE. IN ALL CASES, NOTIFY DISTRICT OFFICE PRIOR TO ANY CEMENTING.

I hereby certify that the statements made herein are true and to the best of my knowledge and belief.

Date: 4-20-97 Signature of Operator or Agent: Leo Darzweiler Title: owner

FOR KCC USE: API # 15- 051-249640000 Conductor pipe required NONE feet Minimum surface pipe required 200 feet per Alt. X(2) Approved by: JK 4-23-97 This authorization expires: 10-23-97 (This authorization void if drilling not started within 6 months of effective date.) Spud date: Agent:

4-23-97 M.M. 23 A.M. 12

REMEMBER TO:

- File Drill Pit Application (form CDP-1) with Intent to Drill; - File Completion Form ACO-1 within 120 days of spud date; - File acreage attribution plat according to field proration orders; - Notify appropriate district office 48 hours prior to workover or re-entry; - Submit plugging report (CP-4) after plugging is completed; - Obtain written approval before disposing or injecting salt water.

Mail to: Conservation Division, 200 Colorado Derby Building, 202 W. First St., Wichita, Kansas 67202-1286.

10 18 17W

IN ALL CASES PLOT THE INTENDED WELL ON THE PLAT BELOW

PLAT OF ACREAGE ATTRIBUTABLE TO A WELL IN A PRORATED OR SPACED FIELD

If the intended well is in a prorated or spaced field, please fully complete this side of the form. If the intended well is in a prorated or spaced field complete the plat below showing that the well will be properly located in relationship to other wells producing from the common source of supply. Please show all the wells within 1 mile of the boundaries of the proposed acreage attribution unit for gas wells and within 1/2 mile of the boundaries of the proposed acreage attribution unit for oil wells.

API NO. 15- _____
 OPERATOR C ttlemans Oil Operations
 LEASE Dorzweiler G
 WELL NUMBER 11
 FIELD Catherine North

LOCATION OF WELL: COUNTY Ellis
330 feet from south/north line of section
1650 feet from east/west line of section
 SECTION _____ TWP _____ RG _____

NUMBER OF ACRES ATTRIBUTABLE TO WELL 10
 QTR/QTR/QTR OF ACREAGE SW - SE - SW

IS SECTION x REGULAR or _____ IRREGULAR
IF SECTION IS IRREGULAR, LOCATE WELL FROM NEAREST CORNER BOUNDARY.

Section corner used: _____ NE _____ NW _____ SE _____ SW

PLAT

(Show location of the well and shade attributable acreage for prorated or spaced wells.)
 (Show footage to the nearest lease or unit boundary line.)

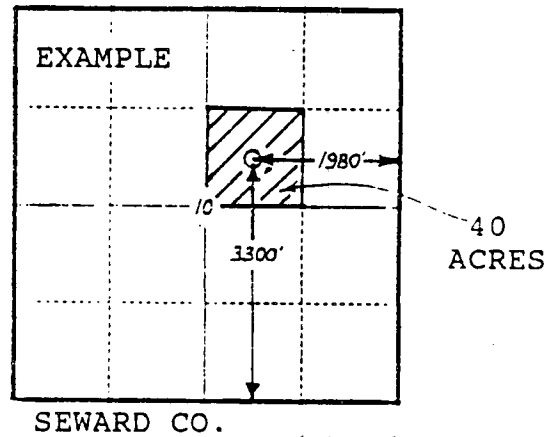
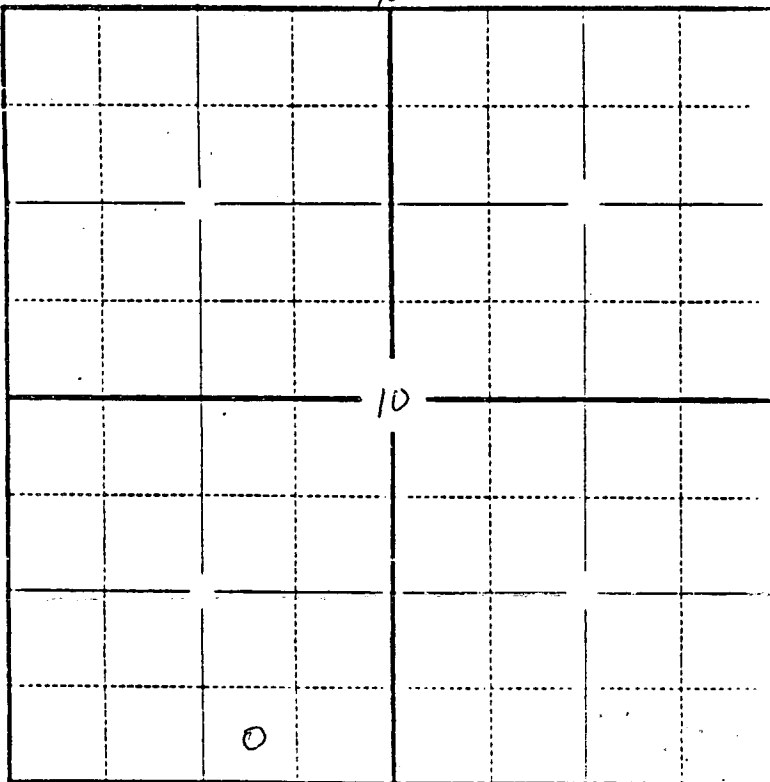

In plotting the proposed location of the well, you must show:

- 1) The manner in which you are using the depicted plat by identifying section lines, i.e. 1 section, 1 section with 8 surrounding sections, 4 sections, etc.;
- 2) the distance of the proposed drilling location from the section's south/north and east/west lines; and
- 3) the distance to the nearest lease or unit boundary line.