

EFFECTIVE DATE: 12-11-93

DISTRICT # 4

SEA7... Yes... No

State of Kansas

NOTICE OF INTENTION TO DRILL

FORM MUST BE SIGNED ALL BLANKS MUST BE FILLED

Must be approved by the K.C.C. five (5) days prior to commencing well

Expected Spud Date 12-18-93 50' N. SE. SW. SW. Sec 10. Twp 13. S. Rg 17 West

OPERATOR: License # 7064 Name: Cattlemans Oil Operations Address: 2260 Catherine Rd City/State/Zip: Hays, Kansas 67601 Contact Person: Leo Dorzweiler Phone: 913-625-5394

CONTRACTOR: License #: 9431 Name: Vonfeldt Drlg

Well Drilled For: Oil, Gas, DWVO, Seismic, Other Well Class: Enh Rec, Storage, Disposal, # of Holes, Other Well Type Equipment: Mud Rotary, Pool Ext, Cable

If DWVO: old well information as follows: Operator, Well Name, Comp. Date, Old Total Depth

Directional, Deviated or Horizontal wellbore? yes X no If yes, true vertical depth: Bottom Hole Location:

380 feet from South / North line of Section 990 feet from East / West line of Section IS SECTION REGULAR X IRREGULAR?

(NOTE: Locate well on the Section Plat on Reverse Side) County: Ellis Lease Name: Dorzweiler G. Well #: 10 Field Name: Catherine North Is this a Prorated/Spaced Field? yes X no Target Formation(s): Arbuckle Nearest lease or unit boundary: 380 Ground Surface Elevation: 1993 feet MSL Water well within one-quarter mile: X yes no Public water supply well within one mile: X yes no Depth to bottom of fresh water: 400 460 Depth to bottom of usable water: 700 Surface Pipe by Alternate: 1 X 2 Length of Surface Pipe Planned to be set: 250 Length of Conductor pipe required: na Projected Total Depth: 3550 Formation at Total Depth: Arbuckle Water Source for Drilling Operations: well X farm pond other DVR Permit #: Will Cores Be Taken?: yes X no If yes, proposed zone:

AFFIDAVIT

The undersigned hereby affirms that the drilling, completion and eventual plugging of this well shall comply with U.S.A. 55-101, et. seq. It is agreed that the following minimum requirements will be met:

- 1. Notify the appropriate district office prior to spudding of well; 2. A copy of the approved notice of intent to drill shall be posted on each drilling rig; 3. The minimum amount of surface pipe as specified below shall be set by circulating cement to the underlying formation; 4. If the well is dry hole, an agreement between the operator and the district office on plug length and placement is necessary prior to plugging; 5. The appropriate district office will be notified before well is either plugged or production casing is cemented in; 6. IF AN ALTERNATE II COMPLETION, PRODUCTION PIPE SHALL BE CEMENTED FROM BELOW ANY USABLE WATER TO SURFACE WITHIN 120 DAYS OF SPUD DATE. IN ALL CASES, NOTIFY DISTRICT OFFICE PRIOR TO ANY CEMENTING.

I hereby certify that the statements made herein are true and to the best of my knowledge and belief.

Date: 12-3-93 Signature of Operator or Agent: Leo Dorzweiler Title: owner

FOR KCC USE: API # 15- 051-24870-0000 Conductor pipe required None feet Minimum surface pipe required 250' feet per Alt. X (3) Approved by: CB 12-6-93 This authorization expires: 6-6-94 (This authorization void if drilling not started within 6 months of effective date.) Spud date: Agent:

REMEMBER TO:

- File Drill Pit Application (form CDP-1) with Intent to Drill; - File Completion Form ACO-1 within 120 days of spud date; - File acreage attribution plat according to field proration orders; - Notify appropriate district office 48 hours prior to workover or re-entry; - Submit plugging report (CP-4) after plugging is completed; - Obtain written approval before disposing or injecting salt water.

Mail to: Conservation Division, 200 Colorado Derby Building, 202 W. First St., Wichita, Kansas 67202-1286.

RECEIVED STATE COMPLETION COMMISSION

DEC 06 1993

CONSERVATION DIVISION WICHITA, KANSAS

10 13 17

IN ALL CASES PLOT THE INTENDED WELL ON THE PLAT BELOW

PLAT OF ACREAGE ATTRIBUTABLE TO A WELL IN A PRORATED OR SPACED FIELD

If the intended well is in a prorated or spaced field, please fully complete this side of the form. If the intended well is in a prorated or spaced field complete the plat below showing that the well will be properly located in relationship to other wells producing from the common source of supply. Please show all the wells within 1 mile of the boundaries of the proposed acreage attribution unit for gas wells and within 1/2 mile of the boundaries of the proposed acreage attribution unit for oil wells.

API NO. 15- _____
OPERATOR Cattlemans Oil Operations
LEASE Dorzweiler G
WELL NUMBER 10
FIELD Catherine North

LOCATION OF WELL: COUNTY Ellis
380 feet from south/north line of section
990' feet from east/west line of section
SECTION 10 TWP 17 RG 17w

NUMBER OF ACRES ATTRIBUTABLE TO WELL 10
QTR/QTR/QTR OF ACREAGE SE - SW - SW

IS SECTION x REGULAR or _____ IRREGULAR
IF SECTION IS IRREGULAR, LOCATE WELL FROM NEAREST CORNER BOUNDARY.

Section corner used: _____ NE _____ NW _____ SE _____ SW

PLAT

(Show location of the well and shade attributable acreage for prorated or spaced wells.)
(Show footage to the nearest lease or unit boundary line.)

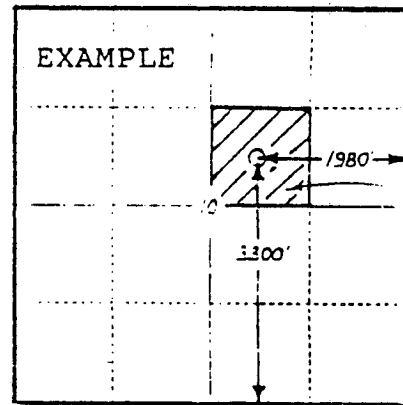
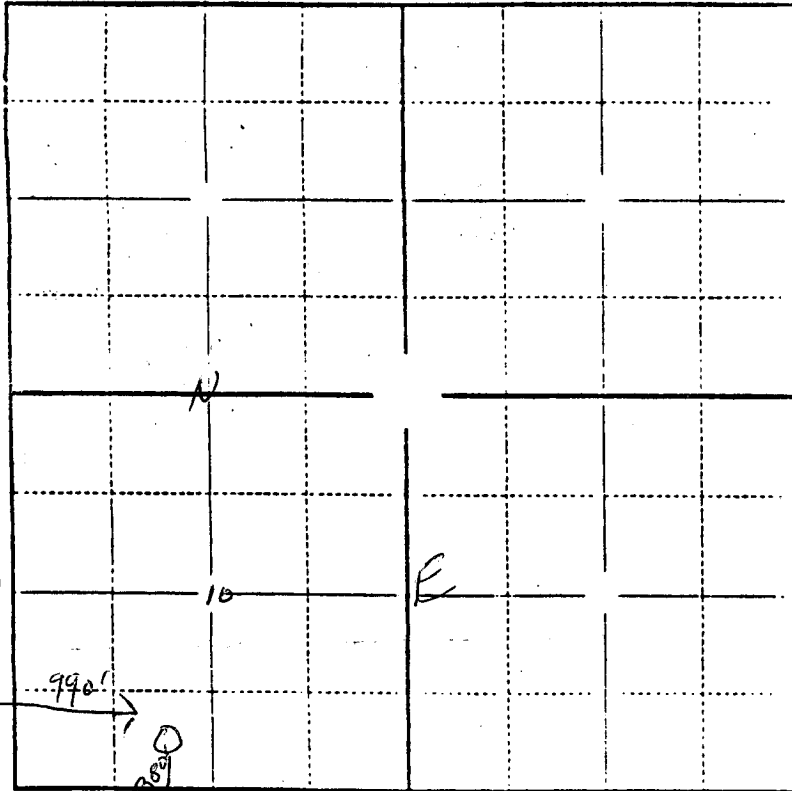

40
ACRES

SEWARD CO.

In plotting the proposed location of the well, you must show:

- 1) The manner in which you are using the depicted plat by identifying section lines, i.e. 1 section, 1 section with 8 surrounding sections, 4 sections, etc.;
- 2) the distance of the proposed drilling location from the section's south/north and east/west lines; and
- 3) the distance to the nearest lease or unit boundary line.