

FOR KCC USE:

EFFECTIVE DATE: 12-8-91

DISTRICT # 10

SGA7... Yes No

"OWWD"

FORM C-1 7/91

FORM MUST BE TYPED

FORM MUST BE SIGNED

ALL BLANKS MUST BE FILLED

State of Kansas 15-051-01085-00-01

NOTICE OF INTENTION TO DRILL

Must be approved by the K.C.C. five (5) days prior to commencing well

Expected Spud Date 12-15-1991
month day year

Spot
se ne se Sec 10 Twp 13 S. Rg 17W East

OPERATOR: License # 7061
Name: Cattlemans Oil Operations
Address: 2260 Catherine Rd
City/State/Zip: Hays, Kansas 67601
Contact Person: Leo R. Dorweiler
Phone: 913-625-5394

1650 feet from South / North line of Section
330 feet from East / West line of Section

IS SECTION REGULAR IRREGULAR?

(NOTE: Locate well on the Section Plat on Reverse Side)

County: Ellis

Lease Name: Catherine Unit Well #: 3-7

Field Name: Catherine North

Is this a Prorated/Spaced Field? yes no

Target Formation(s): Arbuckle

Nearest lease or unit boundary: 330

Ground Surface Elevation: 2000 feet MSL

Water well within one-quarter mile: yes no

Public water supply well within one mile: yes no

Depth to bottom of fresh water: 400

Depth to bottom of usable water: 750

Surface Pipe by Alternate: 1

Length of Surface Pipe ~~to be set~~: 344

Length of Conductor pipe required: 0

Projected Total Depth: 3510

Formation at Total Depth: Arbuckle

Water Source for Drilling Operations:

well farm pond other

DWR Permit #: _____

Will Cores Be Taken?: yes no

If yes, proposed zone: _____

Well Drilled For: Well Class: Type Equipment:

Oil Enh Rec Infield Mud Rotary
 Gas Storage Pool Ext. Air Rotary
 OWWO Disposal Wildcat Cable
 Seismic: # of Holes Other

If OWWO: old well information as follows:

Operator: J.F. Darby
Well Name: Giebler B. #7
Comp. Date: 9-19-57 Old Total Depth 3510

Directional, Deviated or Horizontal wellbore? yes no

If yes, true vertical depth: _____

Bottom Hole Location: _____

AFFIDAVIT

Alternate 2 completion

The undersigned hereby affirms that the drilling, completion and eventual plugging of this well will comply with K.S.A. 55-101, et. seq.

It is agreed that the following minimum requirements will be met:

1. Notify the appropriate district office prior to spudding of well;
2. A copy of the approved notice of intent to drill shall be posted on each drilling rig;
3. The minimum amount of surface pipe as specified below shall be set by circulating cement to the top; in all cases surface pipe shall be set through all unconsolidated materials plus a minimum of 20 feet into the underlying formation;
4. If the well is dry hole, an agreement between the operator and the district office on plug length and placement is necessary prior to plugging;
5. The appropriate district office will be notified before well is either plugged or production casing is cemented in;
6. IF AN ALTERNATE IS COMPLETION, PRODUCTION PIPE SHALL BE CEMENTED FROM BELOW ANY USABLE WATER TO SURFACE WITHIN 120 DAYS OF SPUD DATE. IN ALL CASES, NOTIFY DISTRICT OFFICE PRIOR TO ANY CEMENTING.

I hereby certify that the statements made herein are true and to the best of my knowledge and belief.

Date: 11-25-91 Signature of Operator or Agent Leo R. Dorweiler Title owner

RECEIVED
STATE OF KANSAS COMMISSION

DEC 03 1991

CONSERVATION DIVISION
Wichita, Kansas

FOR KCC USE:
 API # 15- 051-01,085-0001
 Conductor pipe required None feet
 Minimum surface pipe required 200 feet per Alt.
 Approved by: MLW 12-3-91
 This authorization expires: 6-3-92
 (This authorization void if drilling not started within 6 months of effective date.)
 Spud date: _____ Agent: _____

REMEMBER TO:

- File Drill Pit Application (form CDP-1) with Intent to Drill;
- File Completion Form ACO-1 within 120 days of spud date;
- File acreage attribution plat according to field prorations orders;
- Notify appropriate district office 48 hours prior to workover or re-entry;
- Submit plugging report (CP-4) after plugging is completed;
- Obtain written approval before disposing or injecting salt water.

Mail to: Conservation Division, 200 Colorado Derby Building, 202 W. First St., Wichita, Kansas 67202-1286.

10
13
1700

IN ALL CASES PLOT THE INTENDED WELL ON THE PLAT BELOW

PLAT OF ACREAGE ATTRIBUTABLE TO A WELL IN A PRORATED OR SPACED FIELD

If the intended well is in a prorated or spaced field, please fully complete this side of the form. If the intended well is in a prorated or spaced field complete the plat below showing that the well will be properly located in relationship to other wells producing from the common source of supply. Please show all the wells within 1 mile of the boundaries of the proposed acreage attribution unit for gas wells and within 1/2 mile of the boundaries of the proposed acreage attribution unit for oil wells.

API NO. 15- _____
OPERATOR Cattlemans Oil Operations
LEASE Catherine Unit
WELL NUMBER 3-7
FIELD Catherine North

LOCATION OF WELL: COUNTY Ellis
1650 feet from south/north line of section
330 feet from east/west line of section
SECTION 10 TWP 13 RG 17W

NUMBER OF ACRES ATTRIBUTABLE TO WELL 10
QTR/QTR/QTR OF ACREAGE _____

IS SECTION x REGULAR or _____ IRREGULAR
IF SECTION IS IRREGULAR, LOCATE WELL FROM NEAREST CORNER BOUNDARY.

Section corner used: _____ NE _____ NW _____ SE _____ SW

PLAT

(Show location of the well and shade attributable acreage for prorated or spaced wells.)
(Show footage to the nearest lease or unit boundary line.)

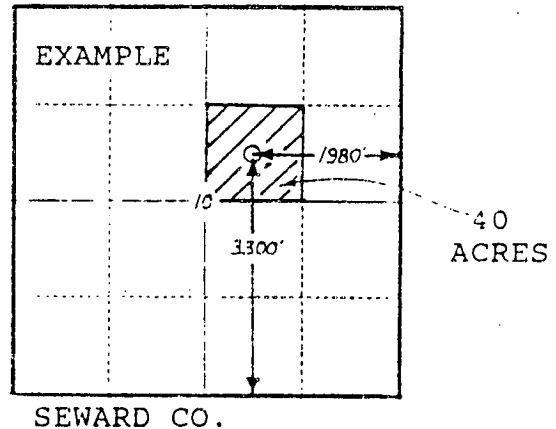
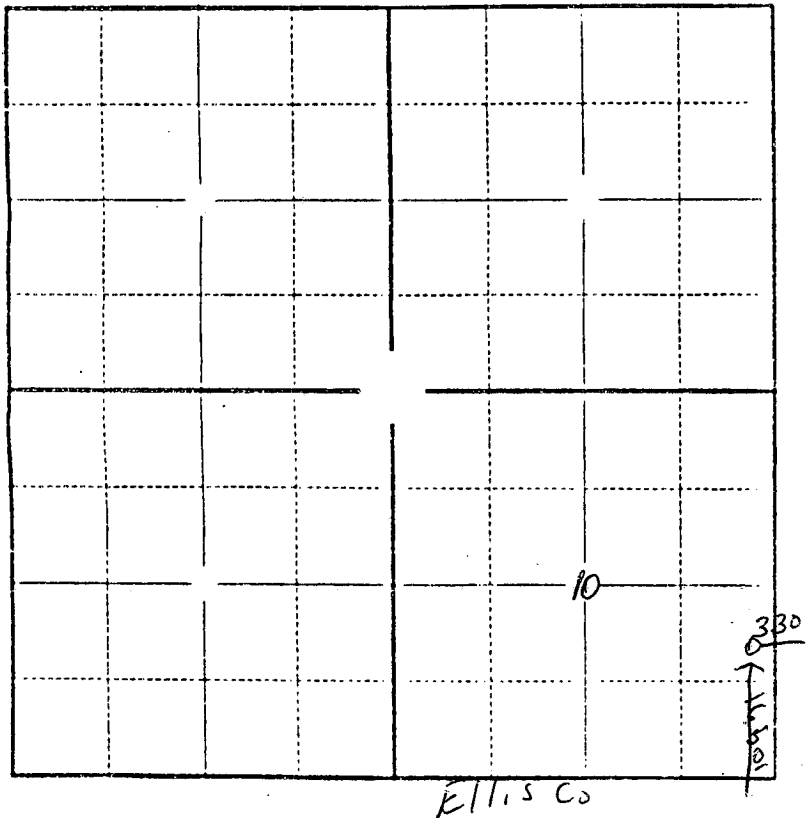

In plotting the proposed location of the well, you must show:

- 1) The manner in which you are using the depicted plat by identifying section lines, i.e. 1 section, 1 section with 8 surrounding sections, 4 sections, etc.;
- 2) the distance of the proposed drilling location from the section's south/north and east/west lines; and
- 3) the distance to the nearest lease or unit boundary line.