

15-035-22301-00-00 LEASE NAME Chrisler D

*PCWD KCC  
 05-19-99*

TYPE OR PRINT  
 NOTICE: Fill out completely  
 and return to Cons. Div.  
 office within 30 days.

WELL NUMBER 1  
3630 Ft. from S Section Line  
2770 Ft. from E Section Line

LEASE OPERATOR Range Oil Company, Inc.

SEC. 31 TWP. 32 RGE. 6 (E) or (XXX)

ADDRESS 125 N. Market, Suite 1120 Wichita, Ks. 67202 COUNTY Cowley

PHONE (316) 265-6231 OPERATORS LICENSE NO. 5120

Date Well Completed 11-29-79

Character of Well Oil

Plugging Commenced 4-29-99

(Oil, Gas, O&A, SWD, Input, Water Supply Well)

Plugging Completed 4-30-99

The plugging proposal was approved on \_\_\_\_\_ (date)

BY \_\_\_\_\_ (KCC District Agent's Name).

Is ACO-1 filed? No If not, is well log attached? Yes

Producing Formation Misc Depth to Top 3052 Bottom \_\_\_\_\_ T.O. 3100

Show depth and thickness of all water, oil and gas formations.

OIL, GAS OR WATER RECORDS | CASING RECORD

| Formation | Content | From | To | Size  | Put In | Pulled out |
|-----------|---------|------|----|-------|--------|------------|
|           |         |      |    | 8 5/8 | 191    | none       |
|           |         |      |    | 4 1/2 | 3099   | 1342'      |
|           |         |      |    |       |        |            |
|           |         |      |    |       |        |            |

Describe in detail the manner in which the well was plugged, indicating where the mud fluid was placed and the method or methods used in introducing it into the hole. If cement or other plug were used, state the character of same and depth placed, from feet to feet each section. Sanded to 2949'. Bailed 4 sks cement. Shot 1342'. Pulled to 300'. Circulated cement to surface with 122 sks. Pulled the rest of the pipe. Hole stayed full.

Name of Plugging Contractor Quality Well Service, Inc. License No. 31925

Address 249 Beth Drive Sterling, Ks. 67579-9048

NAME OF PARTY RESPONSIBLE FOR PLUGGING FEES: Range Oil Company, Inc.

STATE OF Kansas COUNTY OF Sedgwick, ss.

John M. Washburn (Employee of Operator) or (Operator) of

above-described well, being first duly sworn on oath, says: That I have knowledge of the facts and statements, and matters herein contained and the log of the above-described well as filed and the same are true and correct, so help me God.

(Signature) John M Washburn

(Address) 125 N. Market Wichita, KS 67202

SUBSCRIBED AND SWORN TO before me this 18 day of May, 19 99



Vickie Larison  
 Notary Public

9-21-2002

USE ONLY ONE SIDE OF EACH FORM

WELL COMPLETION REPORT ID  
DRILLER'S LOG

S. 31 T. 32S R. 6 E

Loc. 200' E/NE SE NW

API No. 15 — 035 — 22301 - 6000  
County Number

County Cowley

Operator  
Range Oil Company, Inc.

Address  
240 Page Court, 220 W. Douglas, Wichita, Kansas 67202

Well No. 1 Lease Name  
Chrisler "D"

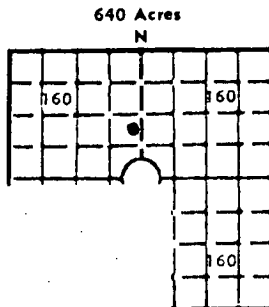

Footage Lt

Principal C

Spud Date

Directional

|       |                                 |            |         |       |                |      |
|-------|---------------------------------|------------|---------|-------|----------------|------|
| STATE | KANSAS                          | 3-3-88     | MAP NO. | S-T-R | 31-32S-6E      | D    |
| PER   | RANGE OIL CO                    |            |         | SPOT  | 200'E/NE SE NW | INIT |
| Rep   | 240 PAGE COURT                  | WICHITA KS |         | CO    | COWLEY         | DO   |
| Purp  | 1 CHRISLER "D"                  |            |         | ELEV  | 1289 KB        | FIN  |
| OWNTR | OWN                             |            |         |       |                |      |
| FIELD | WILSON (MULTIPAY)               |            |         |       |                |      |
|       | IPP 15 BOPD + WTR, MISS 3055-75 |            |         |       |                |      |
|       | API 15-035-22301                | FR 8-13-79 |         |       |                |      |

SPUD 9-13-79, 8 5/8" @ 191 w/150, Geol Bob Olsen  
 DST 1 (NEVA/ADM) 579-86, op30, si30, op30, si30,  
 Rec 5' Fluid, ISIP 20, FP 20-20/20-20, FSIP 20,  
 BHT 80  
 DST 2 (STAL) 1853-61, op30, si30, op60, si60, Rec  
 150' MCW, ISIP 500, FP 38-62/70-100, FSIP 515,  
 BHT 97  
 DST 3 (LAY) 2282-95, op30, si30, op30, si30, 70'  
 GIP, Rec 70' VSOCM, ISIP 320, FP 15-30/40-40,  
 FSIP 310, BHT 105  
 RTD 3100, log: DNS, 4 1/2" @ 3099 w/75  
 Perf (MISS) 3055-61, 3066-75, 2100 Gal A (15%)  
 IPP 15 BOPD + WTR, MISS 3055-75  
 COMPLETED 2-20-80

KB SPL TOPS:  
 COUNCIL GROVE 316 + 973  
 NEVA 361 + 928  
 HOWARD 994 + 295  
 TOPEKA 1156 + 133  
 PEACOCK 1342 - 53  
 HOOVER SD 1542 - 253  
 HOOVER LM 1621 - 332  
 KB LOG TOPS:  
 ADMIRE SD 589 + 700  
 IATAN 1828 - 539  
 STALNAKER 1852 - 563

(P) Petroleum Information Corporation  
 A Subsidiary of A C Narten Company  
 ©Copyrighted 1980 Reproduction Prohibited

Correction: Spot was NE SE NW

LANSING 2048 - 954759  
 HOGSHOOTER 2243 - 954  
 LAYTON "A" 2282 - 993  
 KANSAS CITY 2405 - 1116  
 KANSAS CITY SD 2439 - 1150  
 B/KANSAS CITY 2585 - 1296  
 OSWEGO 2661 - 1372  
 CHEROKEE 2790 - 1501  
 CATTLEMAN PORO 2893 - 1604  
 MISS CH 3052 - 1763  
 MISS LMPORO 3055 - 1766  
 LTD 3099 - 1810  
 RTD 3100 - 1811  
 TD IN MISS

COMP ISSUED 3-18-80

Incorrectly  
 Type and percent additives  
 Depth interval  
 Val treated  
 CFPB  
 Log shall be trans-  
 the Conservation  
 esired, please note  
 14.

C-10-1972

RECEIVED  
STATE CORPORATION COMMISSION

MAY 19 1980

CONSERVATION DIVISION  
Wichita, Kansas

Date of fir

RATE OF  
PER 24 H

Disposition

INSTRU  
mitted  
Division  
Rule 82

3-3-88