

COPY ORIGINAL

SIDE ONE

STATE CORPORATION COMMISSION OF KANSAS  
OIL & GAS CONSERVATION DIVISION  
WELL COMPLETION FORM  
ACO-1 WELL HISTORY  
DESCRIPTION OF WELL AND LEASE

API NO. 15- 167-22,919-0000

County Russell

SW NE NE Sec. 28 Twp. 11 1/2 Rge. 15  East West

4290 Ft. North from Southeast Corner of Section

990 Ft. West from Southeast Corner of Section  
(NOTE: Locate well in section plat below.)

Lease Name Strecker Well # 2

Field Name Fairport

Producing Formation Arbuckle

Elevation: Ground 1873' KB 1878'

Total Depth 3358' PBDT \_\_\_\_\_

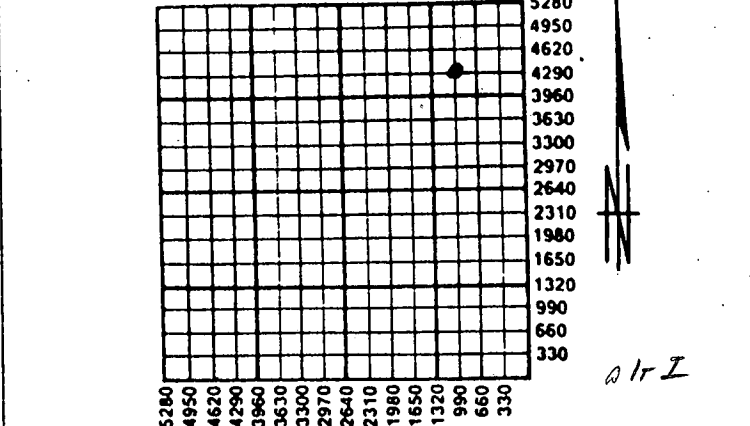

Amount of Surface Pipe Set and Cemented at 960' Feet

Multiple Stage Cementing Collar Used?  Yes  No

If yes, show depth set \_\_\_\_\_ Feet

If Alternate II completion, cement circulated from \_\_\_\_\_

feet depth to \_\_\_\_\_ w/ \_\_\_\_\_ sx cmt.

Operator: License # 30401

Name: Russ-Bar Operating, Inc.

Address P.O. Box 293

Russell, Kansas 67665

City/State/Zip \_\_\_\_\_

Purchaser: \_\_\_\_\_

Operator Contact Person: Don J. Revell

Phone 813, 483-4022

Contractor: Name: Woodman-Dannitti Dalg. Co.

License: 5122

Wellsite Geologist: James C. Musgrove

Designate Type of Completion

New Well  Re-Entry  Workover

Oil  SWD  Temp. Abd.

Gas  Inj  Delayed Comp.

Dry  Other (Core, Water Supply, etc.)

If OWMO: old well info as follows:  
Operator: \_\_\_\_\_

Well Name: \_\_\_\_\_

Comp. Date \_\_\_\_\_ Old Total Depth \_\_\_\_\_

Drilling Method:  
 Mud Rotary  Air Rotary  Cable

8/16/90 8/23/90 9/4/90  
Spud Date Date Reached TD Completion Date

**INSTRUCTIONS:** This form shall be completed in triplicate and filed with the Kansas Corporation Commission, 200 Colorado Derby Building, Wichita, Kansas 67202, within 120 days of the spud date of any well. Rule 82-3-130, 82-3-107 and 82-3-106 apply. Information on side two of this form will be held confidential for a period of 12 months if requested in writing and submitted with the form. See rule 82-3-107 for confidentiality in excess of 12 months. One copy of all wireline logs and drillers time log shall be attached with this form. ALL CEMENTING TICKETS MUST BE ATTACHED. Submit CP-4 form with all plugged wells. Submit CP-111 form with all temporarily abandoned wells. Any recompletion, workover or conversion of a well requires filing of ACO-2 within 120 days from commencement date of such work.

All requirements of the statutes, rules and regulations promulgated to regulate the oil and gas industry have been fully complied with and the statements herein are complete and correct to the best of my knowledge.

Signature Don J. Revell

Title President Date 9/20/90

Subscribed and sworn to before me this 20 day of September, 1990.

Notary Public Lauraine Weathers

**K.C.C. OFFICE USE ONLY**

F  Letter of Confidentiality Attached

C  Wireline Log Received

C  Drillers Timelog Received

**Distribution**

KCC  SWD/Rep  NGPA

KGS  Plug  Other (Specify)

**LAURINE WEATHERS**  
State of Kansas  
My Appt. Exp. Jan 29, 1993

SEP 24 1990

SIDE TWO

Operator Name Russ-Bar Operating, Inc. Lease Name Strecker Well # 2  
 Sec. 28 Twp. 112 Rge. 15  East  West  
 County Russell

INSTRUCTIONS: Show important tops and base of formations penetrated. Detail all cores. Report all drill stem tests giving interval tested, time tool open and closed, flowing and shut-in pressures, whether shut-in pressure reached static level, hydrostatic pressures, bottom hole temperature, fluid recovery, and flow rates if gas to surface during test. Attach extra sheet if more space is needed. Attach copy of log.

Drill Stem Tests Taken  Yes  No  
 (Attach Additional Sheets.)  
 Samples Sent to Geological Survey  Yes  No  
 Cores Taken  Yes  No  
 Electric Log Run  Yes  No  
 (Submit Copy.)  
 DST See attached

Formation Description

Log  Sample

Name	Top	Bottom
Topeka Section	2748'	2756'
Toronto Section	2997'	3006'
Lancing Section	3028'	3034'
Arbuckle Section	3343'	3348'

CASING RECORD  New  Used  
 Report all strings set-conductor, surface, intermediate, production, etc.

Purpose of String	Size Hole Drilled	Size Casing Set (In O.D.)	Weight Lbs./Ft.	Setting Depth	Type of Cement	# Sacks Used	Type and Percent Additives
Surface	12 1/4"	8 5/8"	23#	960	60-40 Poz	375	3% (+2% gel)
Production	7 7/8"	4 1/2"	9 1/2#	3348'	Common	200	10% salt

Shots Per Foot	PERFORATION RECORD Specify Footage of Each Interval Perforated	Acid, Fracture, Shot, Cement Squeeze Record (Amount and Kind of Material Used)	Depth
- 0 -	No Perforation Done	3000 Gal. 15% Non E Acid 1500 Gal. 20% Non E Acid	3358' 3358'

TUBING RECORD Size 2" Set At 3358 Packer At None Liner Run  Yes  No

Date of First Production 8-4-90 Producing Method  Flowing  Pumping  Gas Lift  Other (Explain)

Estimated Production Per 24 Hours	Oil Bbls.	Gas Mcf	Water Bbls.	Gas-Oil Ratio	Gravity
	20 BB.	- 0 -	10	50/50	34

Disposition of Gas:  Vented  Sold  Used on Lease (If vented, submit ACO-18.) (No Gas)  
 METHOD OF COMPLETION  Open Hole  Perforation  Dually Completed  Commingled  
 Other (Specify) \_\_\_\_\_

JAMES C. MUSGROVE

*Petroleum Geologist*

2021 Forest

P. O. BOX 1162

GREAT BEND, KANSAS 67530

COPY

15-167-22919-0000

OFFICE PHONE 792-7716

REG. CLAFLIN 507-3444

Russ-Bar Operating, Inc.  
Strecker #2  
SW-NE-NE; Section 28-11S-15W  
Russell County, Kansas

4 1/2" PRODUCTION CASING SET

CONTRACTOR: Woodman-Iannitti Drilling Company  
(Rig #1)

COMMENCED: 8-16-90

COMPLETED: 8-23-90

ELEVATIONS: 1878' K.B., 1876' D.F., 1873' G.L.

MEASUREMENTS: All depths measured from the Kelly  
Bushing.

CASING PROGRAMS: Surface: 8 5/8" @ 960'  
Production: 4 1/2" @ 3357'

SAMPLES: Samples saved and examined 2600' to  
the R.T.D.

DRILLING TIME: One (1') foot drilling time recorded  
and kept 2600' to the R.T.D.

FORMATION TESTING: There were six (6) drill stem tests  
run by Diamond Testing.

ELECTRIC LOG: None

<u>FORMATION</u>	<u>SAMPLE DEPTH</u>	<u>SUB-SEA DATUM</u>
Severy	2712	- 834
Topeka	2721	- 843
Heebner	2972	-1094
Toronto	2994	-1116
Lansing	3023	-1145
Base Kansas City	3279	-1401
Arbuckle	3343	-1465
Rotary Total Depth	3358	-1480

(All tops and zone determinations were made from a correlation  
of drilling time log and sample analysis)

SAMPLE ANALYSIS, SHOWS OF OIL, TESTING DATA, ETC.

TOPEKA SECTION

2748-2756

Limestone; gray to brown, highly dolomitic,  
sucrosic in part, fair intercrystalline to  
pin point porosity, trace spotty stain;  
show of free oil and fair odor in fresh  
samples.

SEP 24 1990

DRILL STEM TEST #1 - 2738-2755

Open: I.F. 30"  
F.F. 30"

Blow: Weak, died in 20 minutes.

Recovery: 10' slightly oil specked mud  
(free oil top of tool)

Pressures: ISIP - 751 psi (30")  
FSIP - 143 psi (30")  
IFP - 22-33 psi  
FFP - 33-33 psi  
HSH - 1320-1298 psi

2791-2796 Limestone; gray, finely crystalline, dolomitic, scattered pin point porosity, trace light brown stain; no show of free oil or odor in fresh samples.

2858-2866 Limestone; cream, oocastic, fair oocastic porosity, light spotty stain; no show of free oil or odor in fresh samples.

2880-2896 Limestone; cream, fossiliferous, fair porosity; no shows.

2911-2922 Limestone; gray to white, slightly fossiliferous, chalky, spotty rare stain; no show of free oil or odor in fresh samples.

2931-2950 Limestone; gray to cream, oolitic, fossiliferous, fair porosity, spotty dull gray to black stain. Trace free oil (dead) and no odor in fresh samples.

2950-2960 Limestone, as above; chalky, trace stain; trace free oil and questionable odor in fresh samples.

TORONTO SECTION

2997-3006 Limestone; gray to buff, finely crystalline, fair pin point to crystalline porosity, spotty even light brown to golden brown stain; show of free oil and fair odor in fresh samples.

LANSING SECTION

3028-3034 Limestone; gray to cream, finely crystalline, chalky, few fossiliferous, scattered vugular to pin point porosity, trace golden brown stain; weak show of free oil.

3051-3055 Limestone; gray to beige, sub-oocastic, fossiliferous in part, brown to golden brown stain; show of free oil and faint

Russ-Bar Operating, Inc.  
Strecker #2  
SW-NE-NE; Section 28-11S-15W  
Russell County, Kansas

Page Three

odor in fresh samples.

3072-3077

Limestone; tan to gray, fossiliferous, sub-oocastic, fair porosity, fair to good light brown to golden brown stain; show of free oil and faint odor in fresh samples.

DRILL STEM TEST #2 - 3028-3080

Open: I.F. 45"  
F.F. 45"  
Blow: Weak to strong  
Recovery: 740' water  
Pressures: ISIP - 647 psi (45")  
FSIP - 647 psi (45")  
IFP - 99-275 psi  
FFP - 297-385 psi  
HSH - 1504-1493 psi

3098-3102

Limestone; cream to gray, fossiliferous, chalky, trace brown dull gray stain; no show of free oil or odor in fresh samples.

3113-3116

Limestone; cream to white, fine to medium crystalline, fair vuggy inter-crystalline porosity, spotty to even stain and saturation; show of free oil and no odor in fresh samples.

3121-3128

Limestone; white to cream, oocastic, good oocastic porosity, chalky in part, spotty stain; fair show of free oil, fair odor in fresh samples.

DRILL STEM TEST #3 - 3118-3133

Open: I.F. 30"  
F.F. 45"  
Blow: Weak to fair  
Recovery: 180' water (oil scum on top)  
Pressures: ISIP - 385 psi (30")  
FSIP - 385 psi (45")  
IFP - 44-55 psi  
FFP - 66-99 psi  
HSH - 1549-1538 psi

3166-3170

Limestone; white, fossiliferous, chalky, trace poor light brown stain; no show

SEP 24 1990

Russ-Bar Operating, Inc.  
Strecker #2  
SW-NE-NE; Section 28-11S-15W  
Russell County, Kansas

Page Four

- of free oil or odor in fresh samples.
- 3172-3176 Limestone, as above; increasingly tan, fossiliferous, dense, questionable stain; no show of oil or odor.
- 3184-3188 Limestone; cream to gray, fossiliferous, few chalky, fair vuggy porosity, fair golden brown stain; trace free oil and no odor in fresh samples.
- 3209-3216 Limestone; gray, fossiliferous, chalky in part, spotty brown stain; trace free oil and faint odor in fresh samples.

DRILL STEM TEST #4 - 3171-3220

Open: I.F. 30"  
F.F. 30"

Blow: Weak, died in 10 minutes.

Recovery: 5' mud (free oil on top of tool)

Pressures: ISIP - 517 psi (30")  
FSIP - 463 psi (30")  
IFP - 33-33 psi  
FFP - 44-44 psi  
HSH - 1582-1560 psi

- 3240-3245 Limestone; gray to white, fossiliferous, chalky, poor visible porosity, trace brown to light brown stain; trace free oil and questionable odor in fresh samples.
- 3268-3274 Limestone; white to cream, chalky, dense, scattered pyrite inclusions.

ARBUCKLE SECTION

- 3343-3348 Dolomite; tan to cream to gray, fine to medium crystalline, sucrosic, fair pin point to vugular-type porosity, fair to good brown stain and saturation; fair show of free oil and fair odor in fresh samples.

DRILL STEM TEST #5 - 3346-3351

Open: I.F. 30"  
F.F. 30"

Blow: Weak, died in 8 minutes.

Recovery: 1' clean oil  
4' heavy oil cut mud

SEP 24 1990

Drill Stem Test #5 - Continued

Pressures: ISIP - 1048 psi  
FSIP - 1015 psi  
IFP - 22-22 psi  
FFP - 33-33 psi  
HSH - 1659-1648 psi

3351-3358

Dolomite, as above; fair to good show  
of free oil; trace white-gray boney  
chert.

DRILL STEM TEST #6 - 3350-3358

Open: I.F. 45"  
F.F. 45"

Blow: Initial: Weak, building to 2" at end.  
Final: No blow.

Recovery: 30' clean oil  
30' heavy oil cut mud

Pressures: ISIP - 922 psi (45")  
FSIP - 907 psi (45")  
IFP - 22-26 psi  
FFP - 33-33 psi  
HSH - 1681-1670 psi

ROTARY TOTAL DEPTH: 3358 (-1480)

RECOMMENDATIONS

On the basis of the favorable structural position and the positive results of Drill Stem Test #2, it was recommended that 4 1/2" production casing be set and cemented at 3349 feet (nine feet off bottom) and the Strecker #2 be completed in the Arbuckle dolomite by open hole completion methods.

Respectfully submitted,

  
James C. Musgrove  
Petroleum Geologist

JCM:ac

SEP 24 1990

33-2627, Russell, Kansas  
 16-793-5861, Great Bend, Kansas

Phone Plainville 913-434-2812  
 Phone Ness City 913-798-3843

*NEW*

ORIGINAL

# ALLIED CEMENTING CO., INC. No. 9824

Home Office P. O. Box 31

Russell, Kansas 67665

Date	8-17-90	Sec.	28	Twp.	11	Range	15	Called Out		On Location	11:30 AM	Job Start		Finish	3:45 AM
Lease	Strecker	Well No.	2	Location			Gorham 1E-9N-6E			County	Russell	State	Kan		
Contractor	Woodman-Tannitti Digs														
Type Job	Long Surface														
Hole Size	12 1/4	T.D.	960'												
Csg.	8 5/8	Depth	960'												
Tbg. Size		Depth													
Drill Pipe		Depth													
Tool		Depth													
Cement Left in Csg.	15'	Shoe Joint													
Press Max.		Minimum													
Mens Line	✓	Displace													
Perf.															

Owner  
 To Allied Cementing Co., Inc.  
 You are hereby requested to rent cementing equipment and furnish cementer and helper to assist owner or contractor to do work as listed.

Charge To: Russ-Bar Operation, Inc.  
 Street: Box 293  
 City: Russell State: Kansas

The above was done to satisfaction and supervision of owner agent or contractor.

Purchase Order No.  
 X Rich Wheeler

**CEMENT**

Amount Ordered: 375 sks 6% pox, 3% Ch-2% bel

Consisting of

Common	225 @ 5 <sup>00</sup>	1125 <sup>00</sup>
Poz. Mix	150 @ 2 <sup>25</sup>	337 <sup>50</sup>
Gel.	6 @ N/C	N/C
Chloride	10 @ 20 <sup>00</sup>	200 <sup>00</sup>
Quickset		

**EQUIPMENT**

Pumptrk	No.	Cementer	Walt
	153	Helper	
Pumptrk	No.	Cementer	Mark
		Helper	
Bulktrk	156	Driver	
		Driver	

Handling	90¢	337 <sup>50</sup>
Mileage	3¢	202 <sup>50</sup>
Sub Total		
Total		2802 <sup>50</sup>

**DEPTH of Job**

Reference:	Pumptruck	360 <sup>00</sup>
	1-8 5/8 Rubber Plug	71 <sup>00</sup>
	1.00 per mile	18 <sup>00</sup>
	Sub Total	
	Tax	
	Total	449 <sup>00</sup>

**Remarks:**

Cement Did Circ

*That Year*

SEP 24 1990



