

SIDE ONE

STATE CORPORATION COMMISSION OF KANSAS  
OIL & GAS CONSERVATION DIVISION  
WELL COMPLETION FORM  
ACO-1 WELL HISTORY  
DESCRIPTION OF WELL AND LEASE

Operator: License # 5184

Name: Shields Oil Producers, Inc.

Address Shields Bldg.

City/State/Zip Russell, KS 67665

Purchaser: None

Operator Contact Person: M. L. Ratts

Phone ( 913 ) 483-3141

Contractor: Name: Shields Drlg., Co., Inc.

License: 5655

Wellsite Geologist: Francis Whisler

Designate Type of Completion

New Well  Re-Entry  Workover

Oil  SWD  Temp. Abd.

Gas  Inj  Delayed Comp.

Dry  Other (Core, Water Supply, etc.)

If OWD: old well info as follows:

Operator: \_\_\_\_\_

Well Name: \_\_\_\_\_

Comp. Date \_\_\_\_\_ Old Total Depth \_\_\_\_\_

Drilling Method:

Mud Rotary  Air Rotary  Cable

11-7-90 11-15-90

Spud Date Date Reached TD Completion Date

API NO. 15- 167-22,935 -0000

County Russell

NE NW NE Sec. 34 Twp. 11 Rge. 15  East West

4950 Ft. North from Southeast Corner of Section

1650 Ft. West from Southeast Corner of Section

(NOTE: Locate well in section plat below.)

Lease Name Eulert "A" Well # 5

Field Name Eulert West

Producing Formation None

Elevation: Ground 1769 KB 1774

Total Depth 3290 PBTD \_\_\_\_\_

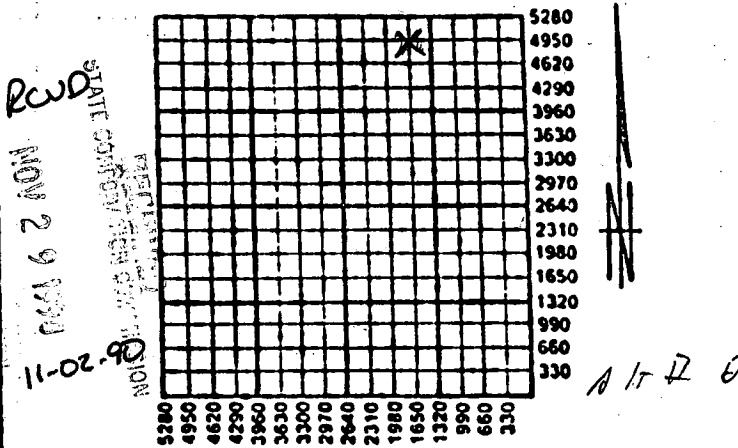

Amount of Surface Pipe Set and Cemented at 218 Feet

Multiple Stage Cementing Collar Used?  Yes  No

If yes, show depth set \_\_\_\_\_ Feet

If Alternate II completion, cement circulated from \_\_\_\_\_

feet depth to \_\_\_\_\_ w/ \_\_\_\_\_ sx cmt.

INSTRUCTIONS: This form shall be completed in triplicate and filed with the Kansas Corporation Commission, 200 Colorado Derby Building, Wichita, Kansas 67202, within 120 days of the spud date of any well. Rule 82-3-130, 82-3-107 and 82-3-106 apply. Information on side two of this form will be held confidential for a period of 12 months if requested in writing and submitted with the form. See rule 82-3-107 for confidentiality in excess of 12 months. One copy of all wireline logs and drillers time log shall be attached with this form. ALL CEMENTING TICKETS MUST BE ATTACHED. Submit CP-4 form with all plugged wells. Submit CP-111 form with all temporarily abandoned wells. Any recompletion, workover or conversion of a well requires filing of ACO-2 within 120 days from commencement date of such work.

All requirements of the statutes, rules and regulations promulgated to regulate the oil and gas industry have been fully complied with and the statements herein are complete and correct to the best of my knowledge.

Signature M L Ratts

Title Production Supt Date 11-20-90

Subscribed and sworn to before me this 20th day of November, 19 90.

Notary Public Ruth Phillips NOV 29 1990

Date Commission Expires \_\_\_\_\_



K.C.C. OFFICE USE ONLY

F  Letter of Confidentiality Attached

C  Wireline Log Received

C  Drillers TimeLog Received

Distribution

KCC  SWD/Rep  NGPA

KGS  Plug  Other (Specify)

SIDE TWO

Operator Name Shields Oil Producers, Inc. Lease Name Eulert "A" Well # 5  
 Sec. 34 Twp. 11 Rge. 15  East  West  
 County Russell

INSTRUCTIONS: Show important tops and base of formations penetrated. Detail all cores. Report all drill stem tests giving interval tested, time tool open and closed, flowing and shut-in pressures, whether shut-in pressure reached static level, hydrostatic pressures, bottom hole temperature, fluid recovery, and flow rates if gas to surface during test. Attach extra sheet if more space is needed. Attach copy of log.

Drill Stem Tests Taken  Yes  No  
 (Attach Additional Sheets.)

Samples Sent to Geological Survey  Yes  No

Cores Taken  Yes  No

Electric Log Run  Yes  No  
 (Submit Copy.)

See Attached Sheets

Formation Description

Log  Sample

Name	Top	Bottom
Anhydrite	851	884
Topeka Lm	2615	2871
Heebner Sh	2871	2875
Toronto Lm	2892	2910
L-KC Lm	2922	3183
Conglomerate	3233	3266
Weathered Arb.	3266	RTD

**CASING RECORD**  New  Used

Report all strings set-conductor, surface, intermediate, production, etc.

Purpose of String	Size Hole Drilled	Size Casing Set (In O.D.)	Weight Lbs./Ft.	Setting Depth	Type of Cement	# Sacks Used	Type and Percent Additives
Surface	12 1/4	8 5/8	20	218	Quickset	140	

Shots Per Foot	Specify Footage of Each Interval Perforated	Acid, Fracture, Shot, Cement Squeeze Record	
		(Amount and Kind of Material Used)	Depth

**TUBING RECORD**

Size	Set At	Packer At	Liner Run
			<input type="checkbox"/> Yes <input type="checkbox"/> No

Date of First Production	Producing Method <input type="checkbox"/> Flowing <input type="checkbox"/> Pumping <input type="checkbox"/> Gas Lift <input type="checkbox"/> Other (Explain)							
Estimated Production Per 24 Hours	Oil	Bbls.	Gas	Mcf	Water	Bbls.	Gas-Oil Ratio	Gravity

Disposition of Gas:  Vented  Sold  Used on Lease (If vented, submit ACO-18.)

METHOD OF COMPLETION:  Open Hole  Perforation  Dually Completed  Commingled  Other (Specify) \_\_\_\_\_

Production Interval \_\_\_\_\_

ORIGINAL

15-167-22935-0000

Shields

OIL PRODUCERS, INC.

R. L. SHIELDS, President

Russell, Kansas

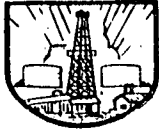

FORM ACO-1 DRILL STEM TESTS

SHIELDS OIL PRODUCERS, INC. LEASE Eulert "A" #5

D.S.T. #1 2634-2660 Times: 30-45-30-45

I.H.P. 1386 I.F.P. 42-50 I.S.I.P. 782

F.F.P. 58-67 F.S.I.P. 813 F.H.P. 1370

Recovery: 495' Gas and 105' Mdy Gsy Oil

D.S.T. #2 2940-2960 Times: 15-45-45-45

I.H.P. 1630 I.F.P. 84-109 I.S.I.P. 815

F.F.P. 168-286 F.S.I.P. 798 F.H.P. 1614

Recovery: 45' Gas and 555' VSO&GCW

D.S.T. #3 2959-2980 Times: 15-45-45-45

I.H.P. 1562 I.F.P. 66-74 I.S.I.P. 790

F.F.P. 101-126 F.S.I.P. 739 F.H.P. 1550

Recovery: 540' Gas; 90' O&GCM and 90' SOCW

D.S.T. #4 3003-3020 Times: 5-45-30-45

I.H.P. 1637 I.F.P. 210-370 I.S.I.P. 815

F.F.P. 479-689 F.S.I.P. 815 F.H.P. 1620

Recovery: 60' Gas and 1440' VSO&GCW

D.S.T. #5 3086-3120 Times: 15-45-30-45

I.H.P. 1654 I.F.P. 109-235 I.S.I.P. 782

F.F.P. 294-394 F.S.I.P. 756 F.H.P. 1025

Recovery: 1170' Wtr.

D.S.T. #6 Times:

I.H.P. I.F.P. I.S.I.P.

F.F.P. F.S.I.P. F.H.P.

Recovery:

RECEIVED  
STATE OF KANSAS COMMISSION

NOV 29 1990

NOV 29 1990

CONSERVATION DIVISION  
Wichita, Kansas BOX 709

Phone 913-483-2627, Russell, Kansas  
 Phone 316-793-5861, Great Bend, Kansas

ORIGINAL

Phone Plainville 913-434-2812  
 Phone Ness City 913-798-3843

NEW

**ALLIED CEMENTING CO., INC.** N<sup>o</sup> 8948

Home Office P. O. Box 31

Russell, Kansas 67665

Date	11.8.90	Sec.	34	Twp.	11	Range	15	Called Out	11:00 A.M.	On Location	1:00 P.M.	Job Start	2:00 P.M.	Finish	2:30 P.M.	
Case	Fulent A	Well No.	5	Location				Russell 10N	County	Russell	State	Kansas				
Contractor	SHIELDS												Owner	SAME		
Type Job	SURFACE												To Allied Cementing Co., Inc. You are hereby requested to rent cementing equipment and furnish cement and helper to assist owner or contractor to do work as listed.			
Hole Size	12 1/4		T.D.	222												
Log	8 5/8		Depth	218												
Log. Size			Depth													
Drill Pipe			Depth													
Tool			Depth													
Cement Left in Csg.	15		Shoe Joint													
Press Max.			Minimum													
Leas Line	x		Displace	x												
Perf.																

**EQUIPMENT**

Pumptrk	No.	Cementer	R. DAVIS
	83	Helper	
Pumptrk	No.	Cementer	
		Helper	
Bulktrk	213	Driver	PAUL
		Driver	

**DEPTH of Job**

Reference: #		380.00
	8 5/8 Rubber Plug	72.00
	2" PER M.I.E	38.00
	Sub Total	
	Tax	
	Total	490.00

Remarks:

Cement @ 10

NOV 29 1990

CONSERVATION DIVISION  
 Wichita, Kansas

Charge To	SHIELDS O.I. Prod	
Street	SHIELDS BLDG	
City	Russell	State Kansas
The above was done to satisfaction and supervision of owner agent or contractor.		
Purchase Order No.	X Burton Beery	
	CEMENT	
Amount Ordered	140 SKS 60/40	
Consisting of	3% CC 2% GEL	
Common	84 SKS @ 5.25	441.00
Poz. Mix	56 SKS @ 2.25	126.00
Gel.	2 SKS N/C	N/C
Chloride	4 SKS @ 21.00	84.00
Quickset		
	Sales Tax	
Handling	@ 1.00	140.00
Mileage	34/SK/M.I.E	79.00
	Sub Total	
	Total	870.00
Floating Equipment		

Thanks You

*Surface*

NOV 29 1990

Phone 913-483-2627, Russell, Kansas  
 Phone 316-793-5861, Great Bend, Kansas

ORIGINAL

Phone Plainville 913-434-2812  
 Phone Ness City 913-798-3843

**ALLIED CEMENTING CO., INC. No. 8833**

Home Office P. O. Box 31

Russell, Kansas 67665

*NEW*

Date	11-16-90	Sec.	Twp.	Range	Called Out	On Location	Job Start	Finish
Case	Entert	Well No.	A-5	Location	Russell 1N 1W 12N 2W	County	Russell	State
Contractor	Shields Doly							
Type Job	plug							
Cole Size	T.D.		3290					
sg.	Depth							
lg. Size	Depth							
Drill Pipe	Depth							
ool	Depth							
Cement Left in Csg.	Shoe Joint							
ress Max.	Minimum							
Meas Line	Displace							
Perf.								

**Owner**  
 To Allied Cementing Co., Inc.  
 You are hereby requested to rent cementing equipment and furnish cementer and helper to assist owner or contractor to do work as listed.

**Charge To** Shields Oil Producers

**Street**

**City** **State**

The above was done to satisfaction and supervision of owner agent or contractor.

**Purchase Order No.**  
 X *Burton Beery*

**CEMENT**

**Amount Ordered** 185<sup>00</sup> 6% gel 1/4 lb Flour seal

**Consisting of**

Common
Poz. Mix
Gel.
Chloride
Quickset

**Sales Tax**

**Handling**

**Mileage**

**Sub Total**

**Total**

**Floating Equipment**

**EQUIPMENT**

Pumptrk	No.	Cementer	<i>Dave</i>
	177	Helper	
Pumptrk	No.	Cementer	<i>Mark</i>
		Helper	
Bulktrk		Driver	
	913	Driver	

**DEPTH of Job**

Reference:	<i>Pump tik ch</i>	
	<i>2 1/2 Per. units</i>	
	<i>plug</i>	
	<b>Sub Total</b>	
	<b>Tax</b>	
	<b>Total</b>	

**Remarks:**

25 @ arb

25 @ 870

100 @ 500

10 @ 40 wt plug

10 mouse house 15 Rat hole

*P109*

NOV 29 1990

CCREEMAN DIVISION  
 Wichita, Kansas

NOV 29 1990

# ORIGINAL

COMPANY Shields Oil Prod. FARM Euler WELL NO. A-5  
 SEC. TWP. RGE. LOC. COUNTY Russell STATE Ks  
 CONTRACTOR Shields Drilling Co. SIZE HOLE 7 7/8 DRILL PIPE 4 1/2  
 REMARKS: SIZE PUMP LINERS 6 LENGTH STROKE 14

DATE 11-11-90

DEPTH	TIME O'CLOCK	MIN.	REMARKS
<del>2500</del>	<del>10:35</del>		
1	37	2	
2	39	2	
3	41	2	
4	42	1	
5	44	2	mix mud
6	46	2	
7	49	3	
8	52	3	
9	55	3	
2510	58	3	
1	11:02	4	
2	05	3	
3	07	2	
4	10	3	
5	13	3	
6	16	3	
7	18	2	
8	20	2	
9	23	3	
2520	26	3	
1	27	1	
2	29	2	
3	30	1	
4	31	1	
5	33	2	
6	34	1	
7	36	2	
8	38	2	
9	39	1	
2530	40	1	CONN
1	<del>46</del> 49	3	
2	52	3	
3	56	4	
4	59	3	
5	12:03	4	
6	06	3	
7	08	2	
8	10	2	
9	12	2	
2540	15	3	
1	17	2	
2	20	3	
3	22	2	CLEAN PUMP SCREEN
4	<del>27</del> 30	3	
5	33	3	
6	36	3	
7	39	3	
8	42	3	
9	45	3	
2550	47	2	

DEPTH	TIME O'CLOCK	MIN.	REMARKS
<del>2550</del>	<del>11:47</del>		
1	49	2	
2	51	2	
3	53	2	
4	55	2	
5	57	2	
6	59	2	
7	1:01	2	
8	03	2	
9	05	2	
2560	06	1	
1	09	3	CONN 2561
2	<del>14</del> 16	2	
3	18	2	
4	20	2	
5	21	1	
6	1/2	1/2	
7	22	1/2	
8	24	2	
9	25	1	
2570	26	1	
1	27	1	
2	28	1	
3	29	1	
4	30	1	
5	31	1	
6	32	1	
7	34	2	
8	35	1	
9	37	2	
2580	39	2	
1	40	1	
2	42	2	
3	43	1	
4	45	2	
5	46	1	
6	48	2	
7	49	1	
8	51	2	
9	52	1	
2590	54	2	
1	55	1	
2	56	1	CONN
3	<del>2:01</del> 03	2	
4	05	2	
5	08	3	
6	11	3	
7	13	2	
8	16	3	
9	18	2	
2600	21	3	Call Whis

RECEIVED  
 NOV 29 1990  
 OPERATIONS DIVISION  
 STATE OF KANSAS  
 MONROE, KANSAS

NOV 29 1990

COMPANY Shields Oil Prod FARM Antart WELL NO. A-5  
 SEC. TWP. RGE. LOC. COUNTY Russell STATE Kans  
 CONTRACTOR Shields Drly Co SIZE HOLE 7 7/8" DRILL PIPE 4 1/2"  
 REMARKS: SIZE PUMP LINERS 6" LENGTH STROKE 14"

DATE

DEPTH	TIME O'CLOCK	MIN.	REMARKS
<del>2600</del>	<del>1 2:21</del>	<del>25</del>	
2	29	4	
3	33	4	
4	37	4	
5	41	4	
6	45	4	
7	49	4	
8	52	3	
9	56	4	
2610	59	3	mix mud
1	3:01	2	
2	03	2	
3	05	2	
4	07	2	ZPK 2615 1774
5	10	3	-841
6	15	5	
7	21	6	
8	27	6	
9	35	8	
2620	47	7	
1	47	5	
2	51	7	
3	4:00	6	conn rig pump
4	<del>15</del> 20	5	
5	25	5	
6	30	5	
7	35	5	
8	39	4	
9	42	3	
2630	48	6	
1	53	5	
2	57	4	
3	5:01	4	
4	06	5	
5	10	4	
6	15	5	
7	19	4	
8	24	5	
9	31	7	
2640	35	4	
1	38	3	
2	40	2	
3	42	2	
4	44	2	
5	45	1	
6	47	2	
7	48	1	
8	53	5	
9	57	4	
2650	59	2	

DEPTH	TIME O'CLOCK	MIN.	REMARKS
<del>2650</del>	<del>1 5:59</del>	<del>01</del>	
2	06	5	
3	10	4	
4	13	3	conn
5	<del>19</del> 22	3	
6	25	3	
7	29	4	
8	33	4	vis 42 w1-12.6 w1-97
9	37	4	lcm 2#
2660	42	5	CFS DST #1
1	<del>17</del> 08	4	26' Anchor
2	13	5	I will be back
3	18	5	-W
4	22	4	
5	26	4	
6	30	4	
7	35	5	
8	39	4	
9	42	3	
2670	45	3	
1	47	2	
2	50	3	
3	53	3	
4	55	2	
5	59	4	
6	8:01	2	
7	04	3	
8	07	3	
9	10	3	
2680	13	3	
1	17	4	
2	20	3	
3	24	4	
4	28	4	
5	31	3	Conn.
6	<del>36</del> 39	3	
7	43	4	
8	46	3	
9	49	3	
2690	51	2	
1	54	3	
2	57	3	
3	9:00	3	
4	03	3	
5	06	3	
6	09	3	
7	13	4	
8	17	4	
9	20	3	
2700	24	4	

CONSERVATIVE LUBRICANTS  
 VICTORIA, KANSAS  
 6261 6 2 NON  
 START 7:00 AM  
 NOV 28 1990  
 CONTRACTOR

NOV 28 1990

COMPANY Shields Oil Procl. FARM Eulert WELL NO. A-5  
 SEC. TWP. RGE. LOC. COUNTY Russell STATE Ks  
 CONTRACTOR Shields Drilling Co. SIZE HOLE 7 7/8 DRILL PIPE 4 1/2  
 REMARKS: SIZE PUMP LINERS 6 LENGTH STROKE 14

DATE

DEPTH	TIME O'CLOCK	MIN.	REMARKS
<del>2700</del>	<del>24</del>		
1	27	3	
2	30	3	
3	33	3	
4	37	4	
5	40	3	
6	43	3	
7	47	4	
8	50	3	
9	54	4	
2710	58	4	
1	10:01	3	
2	05	4	
3	08	3	
4	12	4	Conn.
5	<del>16</del> 19	3	
6	22	3	
7	26	4	
8	29	3	
9	32	3	
2720	34	2	
1	36	2	
2	38	2	
3	40	2	
4	43	3	
5	45	2	
6	48	3	
7	50	2	
8	53	3	
9	55	2	
2730	58	3	
1	11:01	3	
2	05	4	
3	07	2	
4	09	2	
5	13	4	
6	18	5	
7	22	4	
8	24	2	
9	26	2	
2740	30	4	
1	33	3	
2	37	4	
3	40	3	
4	42	2	
5	45	3	Conn
6	<del>50</del> 53	2	
7	54	2	
8	58	4	
9	12:01	3	
2750	05	4	

DEPTH	TIME O'CLOCK	MIN.	REMARKS
<del>2750</del>	<del>65</del>		
1	10	5	
2	14	4	
3	18	4	
4	22	4	
5	25	3	
6	28	3	
7	30	2	
8	32	2	
9	35	3	
2760	38	3	
1	42	4	
2	46	4	
3	50	4	
4	52	2	
5	55	3	
6	58	3	
7	1:01	3	
8	05	4	
9	08	3	
2770	12	4	VIS 38 WL 15.2 WT 9.7 ACM 1 1/2
1	17	5	
2	20	3	
3	23	3	
4	27	4	
5	31	4	Conn
6	<del>35</del> 39	4	
7	44	5	
8	47	3	
9	51	4	
2780	57	6	
1	2:00	3	
2	03	3	
3	06	3	
4	09	3	
5	11	2	
6	15	4	
7	20	5	
8	25	5	
9	29	4	
2790	33	4	
1	38	5	
2	43	5	
3	47	4	
4	51	4	
5	53	2	
6	55	2	
7	59	4	
8	3:04	5	
9	09	5	
2800	13	4	

STATE OF KANSAS  
 COUNTY OF RUSSELL  
 NOV 29 1930  
 WITNESSES  
 Wm. H. Kates  
 J. H. Kates

NOV 29 1930



COMPANY Shields Oil Prod

FARM Eulert

WELL NO. A-5

SEC. TWP. RGE. LOC.

COUNTY Russell

STATE Kans

CONTRACTOR Shields Drilling Co

SIZE HOLE 7 7/8" DRILL PIPE 4 1/2"

REMARKS:

SIZE PUMP LINERS 6" LENGTH STROKE 14"

DATE

DEPTH	TIME O'CLOCK	MIN.	REMARKS
<del>2800</del>	<del>3:13</del>	<del>17</del>	
1	21	4	
2	24	3	
3	29	5	
4	32	3	
5	34	2	conn - w rig Pump screen
6	<del>49</del>	<del>49 1/2</del>	
7	51	1 1/2	
8	53	2	
9	56	3	
2810	4:00	4	
1	04	4	
2	08	4	
3	13	5	
4	17	4	
5	22	5	
6	28	6	
7	33	5	
8	37	4	
9	41	4	
2820	45	4	
1	49	4	
2	54	5	
3	5:00	6	
4	05	5	
5	10	5	
6	14	4	
7	18	4	
8	21	3	
9	24	3	
2830	30	6	
1	32	2	
2	34	2	
3	37	3	
4	39	2	
5	42	3	conn
6	<del>47</del>	<del>49</del>	
7	51	2	
8	52	1	
9	53	1	
2840	56	3	
1	58	2	
2	6:00	2	
3	01	1	
4	03	2	
5	04	1	
6	06	2	
7	08	2	
8	09	1	
9	12	3	

DEPTH	TIME O'CLOCK	MIN.	REMARKS
<del>2850</del>	<del>6:12</del>	<del>14</del>	
1	18	4	
2	22	4	
3	26	3	
4	27	2	
5	30	3	VIS 37 w/1 - 18.8 w/199
6	33	3	LCM 1 1/2
7	36	3	
8	39	3	
9	42	3	
2860	44	2	
1	48	4	
2	52	4	
3	56	4	
4	7:00	4	
5	07	3	
6	06	3	conn
7	<del>11</del>	<del>14</del>	
8	19	3	
9	24	5	
2870	29	5	
1	33	4	
2	35	2	
3	37	2	
4	42	5	
5	49	7	
6	57	8	
7	8:02	5	mix mud
8	05	3	
9	09	4	
2880	14	5	
1	20	6	
2	26	6	
3	32	6	
4	39	7	
5	45	6	
6	50	5	
7	54	4	
8	9:00	6	
9	06	6	
2890	10	4	
1	16	6	
2	24	8	
3	29	5	
4	34	5	
5	39	5	
6	45	6	
7	53	8	conn
8	<del>58</del>	<del>10:03</del>	
9	08	5	
2900	08	5	

NOV 29 1990

COMPANY Shields Oil Prod FARM Eulert WELL NO. A-5  
 SEC. TWP. RGE. LOC. COUNTY Russell STATE Ks  
 CONTRACTOR Shields Drtg Co. SIZE HOLE 7 7/8 DRILL PIPE 4 1/2  
 REMARKS: SIZE PUMP LINERS 6 LENGTH STROKE 14

101 483-2107

DATE

DEPTH	TIME O'CLOCK	MIN.	REMARKS
2900	10:08		
1	13	5	
2	20	7	
3	28	8	
4	33	5	
5	39	6	
6	44	5	
7	48	4	
8	52	4	
9	57	5	
2910	11:00	3	
1	03	3	
2	05	2	
3	07	2	
4	10	3	
5	12	2	
6	14	2	
7	16	2	
8	18	2	
9	21	3	
2920	23	2	
1	25	2	
2	28	3	
3	33	5	
4	36	3	Vis 42 Wt 9.9
5	40	4	WL 14.0 LCM 1/2+
6	45	5	
7	50	5	
8	55	5	Conn. Serv. rig
9	12	5	Clear pump screen
2930	17	5	Start P.dry pumps
1	20	3	
2	25	5	
3	30	5	
4	36	6	
5	41	5	
6	47	6	
7	53	6	
8	58	5	
9	1:05	7	
2940	17	8	
1	19	6	
2	24	5	
3	29	5	
4	34	5	
5	39	5	
6	44	5	
7	49	4	
8	53	5	
9	59	6	
2950	2:04	5	wake tool

DEPTH	TIME O'CLOCK	MIN.	REMARKS
2950	2:04		
1	07	3	
2	10	3	
3	14	4	
4	20	6	
5	26	6	
6	33	7	
7	39	6	
8	47	8	
9	55	8	
2960	2:03	8	CFS DST #2
1	31	4	20' Anchor
2	42	5	Mix Mud
3	46	4	
4	51	5	
5	55	4	
6	59	4	
7	1:03	4	
8	07	4	
9	11	4	
2970	16	5	
1	20	4	
2	25	5	
3	28	3	
4	31	3	
5	35	4	
6	39	4	
7	42	3	
8	49	3	
9	50	5	
2980	54	4	CFS DST #3
1	16	5	21' Anchor
2	22	6	Call me on blow
3	27	5	
4	32	5	
5	38	6	
6	42	4	
7	45	3	
8	50	5	
9	55	5	
2990	58	3	
1	11:02	4	Conn. Serv. rig -
2	45	4	Jet water on top
3	50	5	pits - Clear pump screen
4	54	4	Vis. 40 Wt. 9.7+
5	58	4	WL. 12.0 LCM. 2#
6	12:01	3	
7	05	4	NOV 29 1990
8	11	6	Mix mud
9	16	5	
3000	23	7	

wake Geol @ 3010'

COMPANY Shields Oil Prod. FARM Fulcut WELL NO. A-5  
 SEC. TWP. RGE. LOC. COUNTY Russell STATE Ks.  
 CONTRACTOR Shields Dig. Co SIZE HOLE 7 7/8" DRILL PIPE 4 1/2"  
 REMARKS: SIZE PUMP LINERS 6" LENGTH STROKE 14"  
 Room 101 483-2107

DATE NOV 29 1980 VIS 40 wt. 9.74 WL 12.0 LCM 2\*

DEPTH	TIME O'CLOCK	MIN.	REMARKS
<del>3000</del>	<del>12:23</del>		
1	29	6	Mix mud
2	37	8	
3	45	8	↓
4	52	7	
5	57	5	
6	1:01	4	
7	06	5	
8	11	5	
9	15	4	
<del>3010</del>	18	3	Wake Cool
1	20	2	
2	22	2	
3	26	4	
4	31	5	
5	37	6	
6	43	6	
7	50	7	OST 2.4
8	55	5	17' Anchor
9	59	4	
<del>3020</del>	2:03	4	Conn. 42 vis CFS
1	<del>1:20</del> 23	3	
2	25	2	
3	27	2	
4	28	1	
5	29	1	
6	30	1	
7	31	1	
8	33	2	
9	36	3	
<del>3030</del>	39	3	
1	44	5	CFS
2	<del>2:51</del> 53	4	
3	3:00	5	
4	04	4	
5	09	5	
6	14	5	
7	18	4	
8	23	5	
9	28	5	
<del>3040</del>	33	5	
1	38	5	
2	43	5	
3	48	5	VIS 41 W.L. 14.2
4	53	5	WT. 9.8 LCM 2*
5	57	4	
6	4:03	6	
7	08	5	
8	14	6	
9	20	6	
<del>3050</del>	25	5	

DEPTH	TIME O'CLOCK	MIN.	REMARKS
<del>3050</del>	<del>25</del>		
1	31	6	
2	36	5	
3	41	5	conn ✓ rig
4	<del>53</del> 58	3	
5	5:02	4	
6	05	3	
7	11	6	
8	15	4	
9	18	3	
<del>3060</del>	21	3	
1	23	2	
2	26	3	
3	29	3	
4	32	3	
5	35	3	call wh. @ 6:30
6	39	4	
7	42	3	
8	45	3	
9	49	4	
<del>3070</del>	51	2	
1	54	3	
2	57	3	
3	6:02	5	
4	06	4	
5	10	4	
6	15	5	
7	20	5	
8	26	6	
9	30	4	
<del>3080</del>	35	5	
1	37	2	
2	40	3	
3	43	3	
4	48	5	conn
5	<del>52</del> 58	6	vis 41 w.l. 14.6 wt 9.8
6	7:04	6	LCM 2#
7	09	5	
8	14	5	
9	19	5	
<del>3090</del>	24	5	
1	28	4	
2	31	3	
3	36	5	
4	40	4	
5	44	4	
6	48	4	
7	51	3	
8	55	4	
9	58	3	
<del>3100</del>	8:01	3	

STATE OF KANSAS  
 DEPARTMENT OF REVENUE  
 NOV 29 1980  
 RECEIVED  
 WISEMAN/KANSAS  
 MICHAEL KANSAS

NOV 29 1980

COMPANY Shields Oil Prod

FARM E. J. Hurt

WELL NO. A-5

SEC. TWP. RGE. LOC.

COUNTY Russell

STATE Ks

CONTRACTOR Shields Drig Co.

SIZE HOLE 7 7/8

DRILL PIPE 4 1/2

REMARKS:

SIZE PUMP LINERS 6

LENGTH STROKE 14

DATE

DEPTH	TIME O'CLOCK	MIN.	REMARKS
3100	4:01		
1	03	2	
2	07	4	
3	13	6	
4	19	6	
5	25	6	
6	31	6	
7	37	6	
8	43	6	
9	49	6	
3110	55	6	
1	9:00	5	
2	06	6	
3	08	2	
4	10	2	conn
5	14	2	
6	18	2	
7	22	4	
8	26	4	
9	31	5	
3120	35	4	CFS DST # 5
1	8:00	5	34' Anchor
2	11	6	wake me on blow
3	16	5	
4	22	6	
5	27	5	
6	33	6	
7	38	5	
8	40	2	
9	43	3	
3130	49	6	
1	54	5	
2	59	5	
3	9:04	5	
4	09	5	
5	14	5	
6	18	4	
7	23	5	
8	26	3	
9	30	4	
3140	33	3	
1	38	5	
2	43	5	
3	49	6	
4	54	5	
5	59	5	conn
6	10:07	5	
7	15	6	
8	20	5	
9	25	5	
3150	31	5	

DEPTH	TIME O'CLOCK	MIN.	REMARKS
3150	31		
1	37	6	
2	43	6	
3	49	6	
4	54	5	
5	59	5	
6	11:04	5	
7	08	4	
8	13	5	
9	18	5	
3160	22	4	
1	26	4	
2	32	6	
3	37	5	
4	42	5	
5	48	6	
6	53	5	
7	58	5	
8	12:01	3	
9	04	3	
3170	09	5	
1	15	6	
2	21	6	
3	27	6	
4	33	5	
5	37	5	
6	42	5	conn
7	47	4	
8	57	6	
9	1:02	5	
3180	07	5	vis. 38 WT 9.8
1	13	6	WL 14.0 LCM 1 1/2
2	20	7	Mix mud
3	26	6	
4	30	4	
5	34	4	
6	37	3	
7	40	3	
8	43	3	
9	47	4	
3190	51	4	
1	57	6	
2	2:02	5	
3	08	6	
4	15	7	
5	21	6	
6	27	6	
7	33	6	
8	40	7	
9	43	3	
3200	45	2	

NOV 20 1990  
 U.S. GEOLOGICAL SURVEY  
 WICHITA, KANSAS

NOV 20 1990

STOP @ 3,235'

COMPANY Shields Oil Prod FARM Eulert WELL NO. A5  
 SEC 34 TWP. 11 RGE. 15 LOC. COUNTY Russell STATE Kansas  
 CONTRACTOR Shields Drilg. Co. SIZE HOLE 7 1/8 DRILL PIPE 4 1/2  
 REMARKS: SIZE PUMP LINERS 6 LENGTH STROKE 14

DICK 816-756-1500 # 7809

218 W/140  
851-84

DATE

DEPTH	TIME O'CLOCK	MIN.	REMARKS
3200	2:45		
1	48	3	
2	50	2	
3	53	3	
4	55	2	
5	57	2	
6	3:02	5	
7	09	7	conn v rig pump screen
8	28	6	
9	34	6	
3210	39	5	
11	42	3	
12	46	4	
13	51	5	vis 41 wt. 16.0 wt. 9.8
14	53	2	LCM 2#
15	56	3	
16	58	2	
17	4:00	2	mix mud
18	03	3	
19	06	3	
3220	10	4	
21	14	4	
22	19	5	
23	25	6	
24	32	7	
25	38	6	
26	45	7	
27	50	5	
28	57	7	VSR
29	5:04	7	
3230	09	5	SR -1456
31	14	5	VSR
32	18	4	
33	22	4	SR
34	25	3	CFS -1460
35	38	41	3 -1461
36	44	3	VSR
37	46	2	VSR
38	49	3	conn
39	6:54	57	3
3240	7:00	3	CFS -1466
41	8:01	04	2
42	06	2	
43	08	2	
44	10	2	
45	12	2	-1471
46	14	2	
47	16	2	
48	18	2	
49	20	2	
3250	22	2	-1476

DEPTH	TIME O'CLOCK	MIN.	REMARKS
3250	8:22		
1	24	2	
2	25	1	
3	27	2	
4	29	2	
55	31	2	-1481
6	33	2	
7	35	2	
8	37	2	
9	38	1	
3260	39	1	
1	40	1	
2	41	1	
3	43	2	
4	45	2	
65	46	1	-1491
6	47	1	
7	49	2	VSR
8	50	1	VSR
9	52	2	VSR CONN
3270	56	58	2 -1496
1	9:00	2	
2	03	3	vis, 50
3	05	2	wt 9.9
4	07	2	VSR WL 12
75	08	1	-1501
6	09	1	
7	10	1	
8	11	1	VSR
9	12	1	
3280	14	2	-1506
1	15	1	
2	16	1	
3	18	2	
4	19	1	
85	21	2	
6	24	3	
7	26	2	
8	29	3	
9	31	2	
3290	33	2	CFS -1516
1			
2			
3			
4			
95			-1521
6			
7			
8			
9			
3300			-1526

RECEIVED  
 NOV 29 1990  
 STATE OF KANSAS  
 COMMISSIONER OF REVENUE  
 DIVISION  
 TO: SHIELDS OIL PROD  
 FROM: SHIELDS DRILG. CO.  
 WICHITA, KANSAS

NOV 29 1990

3230  
1774