

15-167-23102-00-00

FOR KCC USE:

FORM MUST BE TYPED

EFFECTIVE DATE: 7-31-95

State of Kansas

FORM MUST BE SIGNED

DISTRICT # 4

NOTICE OF INTENTION TO DRILL

ALL BLANKS MUST BE FILLED

SSA? Yes No

Must be approved by the K.C.C. five (5) days prior to commencing well

Expected Spud Date 8 month 7 day 95 year

Spot NE SW NE Sec 29 Twp 11 S Rg 15 East West

OPERATOR: License # 3613 Hallwood Petroleum, Inc. 4582 S. Ulster St. Pkwy, Ste 1700 Denver, CO 80237 Nonya K. Durham 303-850-6257

1650 feet from South North line of Section 1650 feet from East West line of Section IS SECTION X REGULAR IRREGULAR?

CONTRACTOR: License # 5418 Allen Drilling Company

(NOTE: Locate well on the Section Plat on Reverse Side) County: Russell Lease Name: Booth "B" Well #: 4 Field Name: Fairport North

Well Drilled For: Oil Enh Rec Infield Mud Rotary Gas Storage Pool Ext Air Rotary OAWD Disposal Wildcat Cable Seismic # of Holes Other

Is this a Prorated/Spaced Field? yes X no Target Formation(s): Topeka & Lansing-Kansas Cit Nearest lease or unit boundary: 1650'

If OAWD: old well information as follows: Operator: N/A Well Name: Comp. Date: Old Total Depth:

Ground Surface Elevation: 1769 feet MSL Water well within one-quarter mile: yes X no Public water supply well within one mile: yes X no

Directional, Deviated or Horizontal wellbore? yes X no If yes, true vertical depth: Bottom Hole Location:

Depth to bottom of fresh water: 180 Depth to bottom of usable water: 400 Surface Pipe by Alternate: X 1 2 Length of Surface Pipe Planned to be set: 420

AFFIDAVIT

The undersigned hereby affirms that the drilling, completion and eventual plugging of this well will comply with K.S.A. 55-101, et. seq. It is agreed that the following minimum requirements will be met:

- 1. Notify the appropriate district office prior to spudding of well; 2. A copy of the approved notice of intent to drill shall be posted on each drilling rig; 3. The minimum amount of surface pipe as specified below shall be set by circulating cement to the top; in all cases surface pipe shall be set through all unconsolidated materials plus a minimum of 20 feet into the underlying formation; 4. If the well is dry hole, an agreement between the operator and the district office on plug length and placement is necessary prior to plugging; 5. The appropriate district office will be notified before well is either plugged or production casing is cemented in; 6. IF AN ALTERNATE II COMPLETION, PRODUCTION PIPE SHALL BE CEMENTED FROM BELOW ANY USABLE WATER TO SURFACE WITHIN 120 DAYS OF SPUD DATE. IN ALL CASES, NOTIFY DISTRICT OFFICE PRIOR TO ANY CEMENTING.

I hereby certify that the statements made herein are true and to the best of my knowledge and belief. Date: 7-21-95 Signature of Operator or Agent: Nonya K. Durham Title: Production Technician

FOR KCC USE: API # 15- 167-231020000 Conductor pipe required NONE feet Minimum surface pipe required 420 feet per Alt. (1) X Approved by: JK 7-26-95 This authorization expires: 1-26-96 (This authorization void if drilling not started within 6 months of effective date.) Spud date: Agent:

RECEIVED STATE CORPORATION COMMISSION JUL 26 1995 07-26-95 WICHITA, KANSAS

REMEMBER TO:

- File Drill Pit Application (form CDP-1) with Intent to Drill; - File Completion Form ACO-1 within 120 days of spud date; - File acreage attribution plat according to field prorations orders; - Notify appropriate district office 48 hours prior to workover or re-entry; - Submit plugging report (CP-4) after plugging is completed; - Obtain written approval before disposing or injecting salt water.

Mail to: Conservation Division, 200 Colorado Derby Building, 202 W. First St., Wichita, Kansas 67202-1286.

IN ALL CASES PLOT THE INTENDED WELL ON THE PLAT BELOW

**PLAT OF ACREAGE ATTRIBUTABLE TO A WELL IN A PRORATED OR SPACED FIELD**

If the intended well is in a prorated or spaced field, please fully complete this side of the form. If the intended well is in a prorated or spaced field complete the plat below showing that the well will be properly located in relationship to other wells producing from the common source of supply. Please show all the wells within 1 mile of the boundaries of the proposed acreage attribution unit for gas wells and within 1/2 mile of the boundaries of the proposed acreage attribution unit for oil wells.

API NO. 15- \_\_\_\_\_  
 OPERATOR \_\_\_\_\_  
 LEASE \_\_\_\_\_  
 WELL NUMBER \_\_\_\_\_  
 FIELD \_\_\_\_\_

LOCATION OF WELL: COUNTY \_\_\_\_\_  
 \_\_\_\_\_ feet from south/north line of section  
 \_\_\_\_\_ feet from east/west line of section  
 SECTION \_\_\_\_\_ TWP \_\_\_\_\_ RG \_\_\_\_\_

NUMBER OF ACRES ATTRIBUTABLE TO WELL \_\_\_\_\_  
 QTR/QTR/QTR OF ACREAGE \_\_\_\_\_

IS SECTION \_\_\_\_\_ REGULAR or \_\_\_\_\_ IRREGULAR  
IF SECTION IS IRREGULAR, LOCATE WELL FROM NEAREST CORNER BOUNDARY.

Section corner used: \_\_\_\_\_ NE \_\_\_\_\_ NW \_\_\_\_\_ SE \_\_\_\_\_ SW

**PLAT**

(Show location of the well and shade attributable acreage for prorated or spaced wells.)  
 (Show footage to the nearest lease or unit boundary line.)

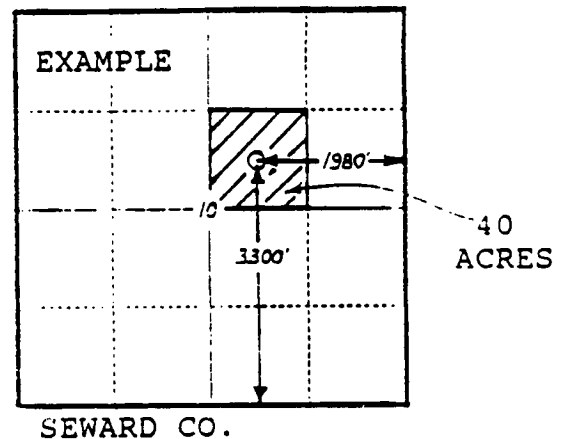
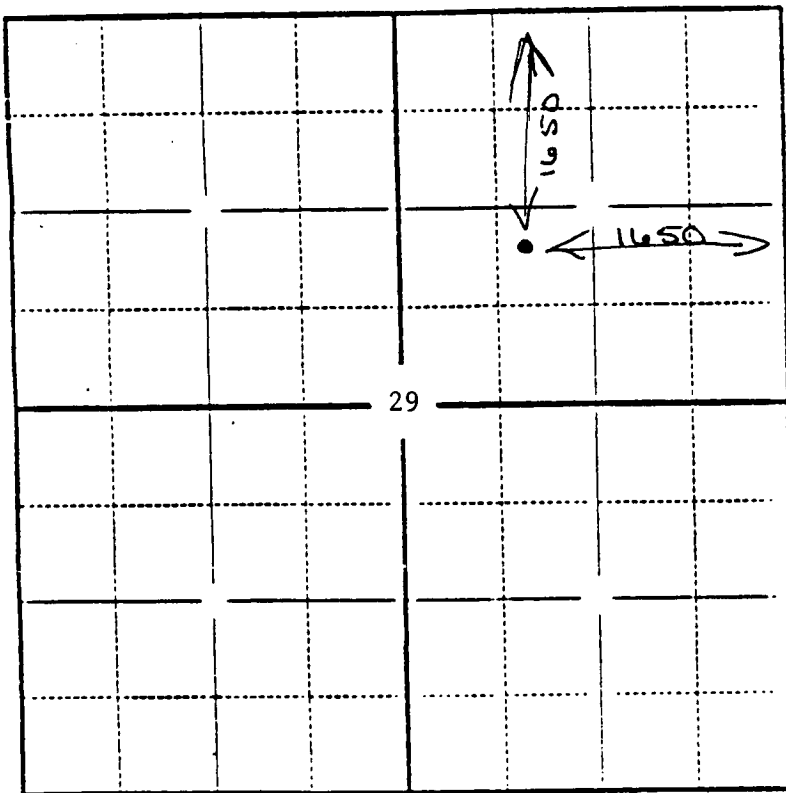

In plotting the proposed location of the well, you must show:

- 1) The manner in which you are using the depicted plat by identifying section lines, i.e. 1 section, 1 section with 8 surrounding sections, 4 sections, etc.;
- 2) the distance of the proposed drilling location from the section's south/north and east/west lines; and
- 3) the distance to the nearest lease or unit boundary line.