

**ORIGINAL**

RECEIVED

JUL 27 2010

Form must be Typed

**WELL COMPLETION FORM**

**WELL HISTORY - DESCRIPTION OF WELL & LEASE**

**KCC WICHITA**

OPERATOR: License # 4549  
 Name: ANADARKO PETROLEUM CORPORATION  
 Address 1: P.O. BOX 1330  
 Address 2: \_\_\_\_\_  
 City HOUSTON State TX Zip: 77251 + 1330  
 Contact Person: DIANA SMART  
 Phone ( 832 ) 636-8380  
 CONTRACTOR: License # 33784  
 Name: Trinidad Drilling LP  
 Wellsite Geologist: \_\_\_\_\_  
 Purchaser: Anadarko Energy Services Company

Designate Type of Completion  
 New Well     Re-Entry     Workover  
 Oil     SWD     SIOW  
 Gas     ENHR     SIGW  
 CM (Coal Bed Methane)     Temp. Abd.  
 Dry     Other \_\_\_\_\_  
 (Core, WSW, Expl., Cathodic, etc.)

If Workover/Reentry: Old Well Info as follows:  
 Operator: \_\_\_\_\_  
 Well Name: \_\_\_\_\_  
 Original Comp. Date \_\_\_\_\_ Original Total Depth \_\_\_\_\_  
 Deepening     Re-perf.     Conv.to Enhr     Conv.to SWD  
 Plug Back    \_\_\_\_\_ Plug Back Total Depth \_\_\_\_\_  
 Commingled    Docket No. \_\_\_\_\_  
 Dual Completion    Docket No. \_\_\_\_\_  
 Other (SWD or Enhr?)    Docket No. \_\_\_\_\_  

<u>04/04/2010</u>	<u>04/06/2010</u>	<u>04/12/2010</u>
Spud Date or Recompletion Date	Date Reached TD	Completion Date or Recompletion Date

API NO. 15- 189-22706-00-00  
 Spot Description: \_\_\_\_\_  
SE - SE - NW - NW Sec. 21 Twp. 31 S. R. 38  East  West  
 \_\_\_\_\_ 1250 Feet from  North /  South Line of Section  
 \_\_\_\_\_ 1250 Feet from  East /  West Line of Section  
 Footages Calculated from Nearest Outside Section Corner:  
 NE     NW     SE     SW  
 County Stevens  
 Lease Name Spikes B Well # 5H  
 Field Name Hugoton  
 Producing Formation Chase  
 Elevation: Ground 3058 Kelley Bushing \_\_\_\_\_  
 Total Depth 2820 Plug Back Total Depth \_\_\_\_\_  
 Amount of Surface Pipe Set and Cemented at \_\_\_\_\_ 620 Feet  
 Multiple Stage Cementing Collar Used?  Yes  No  
 If yes, show depth set \_\_\_\_\_ Feet  
 If Alternate II completion, cement circulated from \_\_\_\_\_  
 feet depth to \_\_\_\_\_ w/ \_\_\_\_\_ sx cmt.

**Drilling Fluid Management Plan**  
 (Data must be collected from the Reserve Pit)  
 Chloride content 4600 ppm Fluid volume 70 bbls  
 Dewatering method used HAUL OFF  
 Location of fluid disposal if hauled offsite: \_\_\_\_\_  
 Operator Name ANADARKO PETROLEUM CORPORATION  
 Lease Name KEEFER A 1 License No. 4549  
 Quarter SW Sec. 13 Twp. 32 S R. 38  East  West  
 County STEVENS Docket No. D17157

**INSTRUCTIONS:** An original and two copies of this form shall be filed with the Kansas Corporation Commission, 130 S. Market - Room 2078, Wichita, Kansas 67202, within 120 days of the spud date, recompletion, workover or conversion of a well. Rule 82-3-130, 82-3-106 and 82-3-107 apply. Information on side two of this form will be held confidential for a period of 12 months if requested in writing and submitted with the form (see rule 82-3-107 for confidentiality in excess of 12 months). One copy of all wireline logs and geologist well report shall be attached with this form. ALL CEMENTING TICKETS MUST BE ATTACHED. Submit CP-4 form with all plugged wells. Submit CP-111 form with all temporarily abandoned wells.

All requirements of the statutes, rules and regulations promulgated to regulate the oil and gas industry have been fully complied with and the statements herein are complete and correct to the best of my knowledge.

Signature Diana Smart  
 Title STAFF REGULATORY ANALYST Date 07/26/2010  
 Submitted and sworn to before me on the 16<sup>th</sup> day of July  
 2010  
 ANNA WELMORE  
 NOTARY PUBLIC STATE OF KANSAS  
 MY COMMISSION EXPIRES  
SEPT. 10, 2011  
 Date Commission Expires

**KCC Office Use ONLY**

Letter of Confidentiality Attached  
 If Denied, Yes  Date: \_\_\_\_\_  
 Wireline Log Received  
 Geologist Report Received  
 UIC Distribution  
 A111 - Dlg - 7/28/10 Copy to Jim H.

Operator Name ANADARKO PETROLEUM CORPORATION

Lease Name Spikes B

Well # 5H

Sec. 21 Twp. 31 S.R. 38  East  West

County Stevens

**INSTRUCTIONS:** Show important tops and base of formations penetrated. Detail all cores. Report all drill stem tests giving interval tested, time tool open and closed, flowing and shut-in pressures, whether shut-in pressure reached static level, hydrostatic pressures, bottom hole temperature, fluid recovery, and flow rates if gas to surface during test, along with final chart(s). Attach extra sheet if more space is needed. Attach copy of all Electric Wireline Logs surveyed. Attach final geological well site report.

Drill Stem Tests Taken  Yes  No  
(Attach Additional Sheets)

Samples Sent to Geological Survey  Yes  No

Cores Taken  Yes  No

Electric Log Run  Yes  No  
(Submit Copy)

List All E.Logs Run:

NEUTRON  
CBL

Log Formation (Top), Depth and Datums  Sample

Name Top Datum

Base Cedar Hills 1293  
Base Stone Corral 1620  
Chase 2315  
Council Grove 2622

CASING RECORD  New  Used

Report all strings set-conductor, surface, intermediate, production, etc.

Purpose of String	Size Hole Drilled	Size Casing Set (In O.D.)	Weight Lbs./Ft.	Setting Depth	Type of Cement	# Sacks Used	Type and Percent Additives
<b>SURFACE</b>	12.25	8 5/8	24	620	STANDARD	450	2% 2% CC
<b>PRODUCTION</b>	7.875	5 1/2	14	2815	MIDCON50/50	580	.5 HALAD
					TOC=170'		

ADDITIONAL CEMENTING/SQUEEZE RECORD

Purpose	Depth Top Bottom	Type of Cement	#Sacks Used	Type and Percent Additives
____ Perforate				
____ Protect Casing				
____ Plug Back TD				
____ Plug Off Zone				

Shots Per Foot	PERFORATION RECORD - Bridge Plugs Set/Type Specify Footage of Each Interval Perforated	Acid, Fracture, Shot, Cement Squeeze Record (Amount and Kind of Material Used)	Depth
2	2350-56, 2412-18, 2464-72	2500 GALS 7.5% FE HCL	2350-2547
2	2510-16, 2538-47	143,934 Gls Bor. 300,000 #s 12/20	2350-2547

TUBING RECORD Size Set At Packer At Liner Run  Yes  No  
None

Date of First, Resumed Production, SWD or Enhr. 04/12/2010 Producing Method  Flowing  Pumping  Gas Lift  Other (Explain)

Estimated Production Per 24 Hours Oil Bbls. 0 Gas Mcf 304 Water Bbls. 0 Gas-Oil Ratio Gravity

DISPOSITION OF GAS: <input type="checkbox"/> Vented <input checked="" type="checkbox"/> Sold <input type="checkbox"/> Used on Lease (If vented, submit ACO-18.)	METHOD OF COMPLETION <input type="checkbox"/> Open Hole <input checked="" type="checkbox"/> Perf. <input type="checkbox"/> Dually Comp. <input type="checkbox"/> Commingled <input type="checkbox"/> Other (Specify) _____	Production Interval <u>2350 - 2547</u>
---	--	---

**PLAT AND CERTIFICATION OF ACREAGE ATTRIBUTABLE TO A GAS WELL**

Kansas Corporation Commission, Conservation Division

Finney State Office Building, 130 South Market, Room 2078 Wichita, Kansas 67202

API NUMBER 15- 189-22706-00-00

OPERATOR: Anadarko Petroleum Corporation

LEASE: Spikes B

WELL NUMBER: 5H

FIELD: Hugoton

NUMBER OF ACRES ATTRIBUTABLE TO WELL: 600

QTR/QTR/QTR: SE - NW - NW

(Show the location for the well and shade attributable acreage for prorated or spaced wells). (Show the footage to the nearest lease or unit boundary line, and show footage to the nearest common source supply well).

LOCATION OF WELL: COUNTY: Stevens

1250 feet from South X North line of section

1250 feet from East X West line of section

SECTION 21 TWP 31(S) RNG 38W

IS SECTION X REGULAR or IRREGULAR

IF SECTION IS IRREGULAR, LOCATE WELL FROM

NEAREST CORNER BOUNDARY (check line below)

Section corner used: NE X NW SE SW

RECEIVED

JUL 27 2010

KCC WICHITA

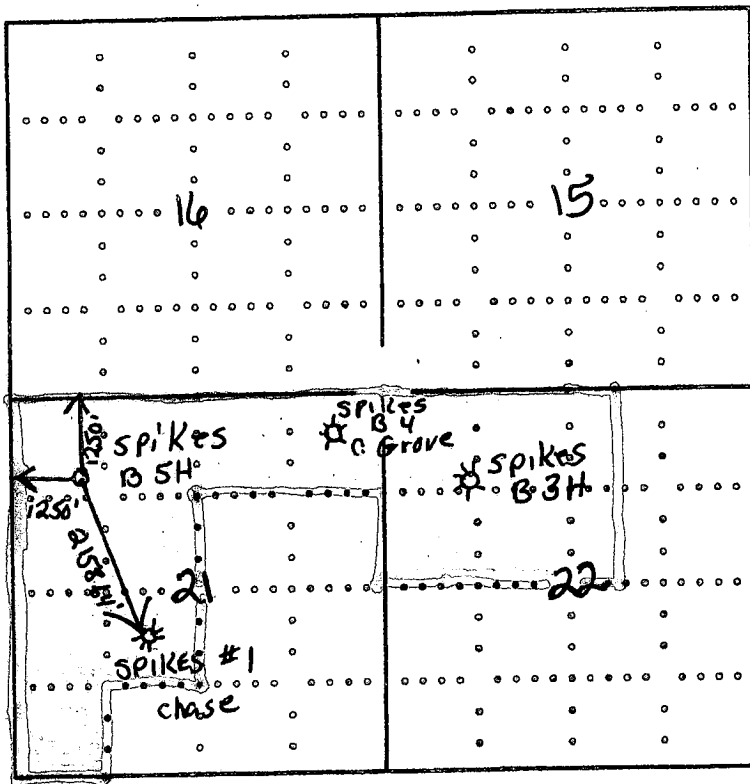

Divergent Interest

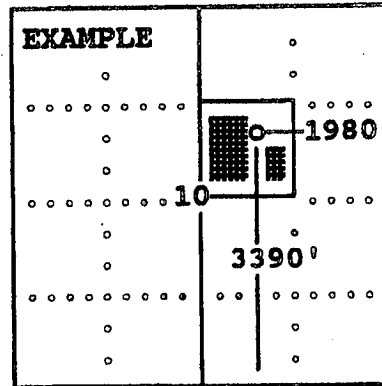

SEWARD CO.

The undersigned hereby certifies as Staff Regulatory Analyst (title) for Anadarko Petroleum Corporation (Co.), a duly authorized agent, that all information shown hereon is true and correct to the best of my knowledge and belief, that all acreage claimed attributable to the well named herein is held by production from that well and hereby make application for an allowable to be assigned to the well upon the filing of this form and the State test, whichever is later.

Signature Diana Smart

Subscribed and sworn before me this 23rd day of December, 2009

Bertha Neff  
Notary Public

My Commission expires 12-27-09

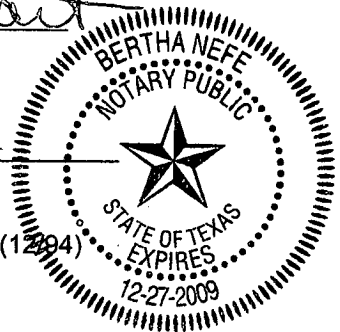

RECEIVED

JUL 27 2010

HALLIBURTON

KCC WICHITA

**Cementing Job Summary**

The Road to Excellence Starts with Safety

Sold To #: 300466	Ship To #: 2777533	Quote #:	Sales Order #: 7285416
Customer: ANADARKO PETROLEUM CORP - EBUS		Customer Rep:	
Well Name: SPIKES	Well #: B#5	API/UWI #:	
Field:	City (SAP): HUGOTON	County/Parish: Stevens	State: Kansas
Contractor: TRINIDAD	Rig/Platform Name/Num: 208		
Job Purpose: Cement Surface Casing			
Well Type: Development Well		Job Type: Cement Surface Casing	
Sales Person: HESTON, MYRON		Srvc Supervisor: WILTSHIRE, MERSHEK	MBU ID Emp #: 195811

**Job Personnel**

HES Emp Name	Exp Hrs	Emp #	HES Emp Name	Exp Hrs	Emp #	HES Emp Name	Exp Hrs	Emp #
AGUILERA, FABIAN	8.3	442123	MATA, ADOLFO V	8.3	419999	SLATER, JOE P	8.3	106095
WILTSHIRE, MERSHEK Tonje	8.3	195811						

**Equipment**

HES Unit #	Distance-1 way	HES Unit #	Distance-1 way	HES Unit #	Distance-1 way	HES Unit #	Distance-1 way

**Job Hours**

Date	On Location Hours	Operating Hours	Date	On Location Hours	Operating Hours	Date	On Location Hours	Operating Hours
TOTAL			Total is the sum of each column separately					

**Job**

**Job Times**

Formation Name	Formation Depth (MD) Top	Bottom	Called Out	Date	Time	Time Zone
Form Type		BHST	On Location	04 - Apr - 2010	20:00	CST
Job depth MD	675 ft	Job Depth TVD	Job Started	04 - Apr - 2010	19:00	CST
Water Depth		Wk Ht Above Floor	Job Completed	05 - Apr - 2010	01:24	CST
Perforation Depth (MD) From		To	Job Completed	05 - Apr - 2010	02:19	CST
			Departed Loc	05 - Apr - 2010	03:30	CST

**Well Data**

Description	New / Used	Max pressure psig	Size in	ID in	Weight lbm/ft	Thread	Grade	Top MD ft	Bottom MD ft	Top TVD ft	Bottom TVD ft
Production				7.625				0' 06			
8 5/8 Surface Casing	Unknown		8.625	8.097	24.			675.	3750.	2815' 06	06
Cement Production Casing	Unknown		5.5	4.974	15.				3750.	2815' 06	06

**Sales/Rental/3<sup>rd</sup> Party (HES)**

Description	Qty	Qty uom	Depth	Supplier
SHOE,GID,8-5/8 8RD	1	EA		
VLVASSY,INSR FLOAT,8-5/8 8RD, 24 lbs/ft	1	EA		
FILLUP ASSY - 1.500 ID - 7 IN. - 8-5/8	1	EA		
CENTRALIZER ASSY - API - 8-5/8 CSG X	3	EA		
BASKET - CEMENT - 8 5/8 CSG X 12 1/4	1	EA		
PLUG,CMTG, TOP,8 5/8,HWE,7.20 MIN/8.09 MA	1	EA		

**Tools and Accessories**

Type	Size	Qty	Make	Depth	Type	Size	Qty	Make	Depth	Type	Size	Qty	Make
Guide Shoe					Packer					Top Plug			
Float Shoe					Bridge Plug					Bottom Plug			
Float Collar					Retainer					SSR plug set			
Insert Float										Plug Container			
Stage Tool										Centralizers			

Miscellaneous Materials											
Gelling Agt	Conc	Surfactant	Conc	Acid Type	Qty	Conc	%	Treatment Fld	Conc	Inhibitor	Conc
				Acid Type	Qty	Conc	%				
				Sand Type	Size	Qty					
Fluid Data											
Stage/Plug #: 1											
Fluid #	Stage Type	Fluid Name	Qty	Qty uom	Mixing Density lbm/gal	Yield ft3/sk	Mix Fluid Gal/sk	Rate bbl/min	Total Mix Fluid Gal/sk		
1	Water Pre-Flush			bbl	8.33	.0	.0	5.0			
2	HALLIBURTON LIGHT STANDARD	HALLIBURTON LIGHT STANDARD - SBM (12313)	250.0	sacks	12.4	2.07	11.35	5.0	11.35		
2 %		CALCIUM CHLORIDE - HI TEST PELLET (100005053)									
0.5 lbm		POLY-E-FLAKE (101216940)									
11.35 Gal		FRESH WATER									
3	Standard Cement	CMT - STANDARD CEMENT (100003684)	200.0	sacks	15.6	1.2	5.24	5.0	5.24		
94 lbm		CMT - STANDARD - CLASS A REG OR TYPE I, BULK (100003684)									
2 %		CALCIUM CHLORIDE - HI TEST PELLET (100005053)									
0.25 lbm		POLY-E-FLAKE (101216940)									
5.238 Gal		FRESH WATER									
4	Displacement		37.00	bbl	8.33	.0	.0	5.0			
Calculated Values			Pressures			Volumes					
Displacement	Shut In: Instant		Lost Returns			Cement Slurry			Pad		
Top Of Cement	5 Min		Cement Returns			Actual Displacement			Treatment		
Frac Gradient	15 Min		Spacers			Load and Breakdown			Total Job		
Rates											
Circulating		Mixing		Displacement		Avg. Job					
Cement Left In Pipe	Amount	0 ft	Reason	Shoe Joint							
Frac Ring # 1 @	ID	Frac ring # 2 @	ID	Frac Ring # 3 @	ID	Frac Ring # 4 @	ID				
The Information Stated Herein Is Correct				Customer Representative Signature							

RECEIVED

JUL 27 2010

KCC WICHITA

RECEIVED

JUL 27 2010

HALLIBURTON

KCC WICHITA

Cementing Job Summary

The Road to Excellence Starts with Safety

Sold To #: 300466	Ship To #: 2777533	Quote #:	Sales Order #: 7288961
Customer: ANADARKO PETROLEUM CORP - EBUS		Customer Rep:	
Well Name: Spikes	Well #: B5	API/UWI #:	
Field:	City (SAP): HUGOTON	County/Parish: Morton	State: Kansas
Contractor: TRINIDAD	Rig/Platform Name/Num: TRINIDAD #208		
Job Purpose: Cement Production Casing			
Well Type: Development Well		Job Type: Cement Production Casing	
Sales Person: HESTON, MYRON		Srvc Supervisor: SMITH, BOBBY	MBU ID Emp #: 106036

Job Personnel

HES Emp Name	Exp Hrs	Emp #	HES Emp Name	Exp Hrs	Emp #	HES Emp Name	Exp Hrs	Emp #
AGUILERA, FABIAN	9	442123	ARNETT, JAMES Ray	9	226567	PORTILLO, CESAR S	9	457847
SMITH, BOBBY Wayne	9	106036						

Equipment

HES Unit #	Distance-1 way	HES Unit #	Distance-1 way	HES Unit #	Distance-1 way	HES Unit #	Distance-1 way

Job Hours

Date	On Location Hours	Operating Hours	Date	On Location Hours	Operating Hours	Date	On Location Hours	Operating Hours
TOTAL			Total is the sum of each column separately					

Job

Job Times

Formation Name	Formation Depth (MD)	Top	Bottom	Date	Time	Time Zone
				Called Out	06 - Apr - 2010	11:00 CST
Form Type			BHST	On Location	06 - Apr - 2010	14:00 CST
Job depth MD	3750. ft		Job Depth TVD	2816. ft	Job Started	06 - Apr - 2010 20:30 CST
Water Depth			Wk Ht Above Floor	3. ft	Job Completed	06 - Apr - 2010 22:00 CST
Perforation Depth (MD)	From		To		Departed Loc	06 - Apr - 2010 23:00 CST

Well Data

Description	New / Used	Max pressure psig	Size in	ID in	Weight lbf/ft	Thread	Grade	Top MD ft	Bottom MD ft	Top TVD ft	Bottom TVD ft
5 1/2 Production Casing	Unknown		5.5	5.012	14.				3750.	2815'	DL
Production Open Hole	Unknown		5.5	5.012	14.			675. 620' DL	3750.	2815'	DL
Surface Casing	Unknown		8.625	8.097	24.				675. 620' DL		

Sales/Rental/3<sup>rd</sup> Party (HES)

Description	Qty	Qty uom	Depth	Supplier
SHOE,GID,5-1/2 8RD	1	EA		
PLUG ASSY,3 WIPR LTH-DWN,5 1/2 CSG	1	EA		
BAFFLE ASSY - 5-1/2 8RD - LATCH-DOWN	1	EA		
CENTRALIZER ASSY - TURBO - API -	14	EA		
KIT,HALL WELD-A	1	EA		

Tools and Accessories

Type	Size	Qty	Make	Depth	Type	Size	Qty	Make	Depth	Type	Size	Qty	Make
Guide Shoe					Packer					Top Plug			
Float Shoe					Bridge Plug					Bottom Plug			
Float Collar					Retainer					SSR plug set			
Insert Float										Plug Container			
Stage Tool										Centralizers			

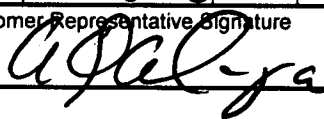
Miscellaneous Materials											
Gelling Agt		Conc		Surfactant		Conc		Acid Type		Qty	Conc %
Treatment Fld		Conc		Inhibitor		Conc		Sand Type		Size	Qty
Fluid Data											
Stage/Plug #: 1											
Fluid #	Stage Type	Fluid Name			Qty	Qty uom	Mixing Density lbm/gal	Yield ft <sup>3</sup> /sk	Mix Fluid Gal/sk	Rate bbl/min	Total Mix Fluid Gal/sk
1	Water Pre-Flush					bbl	8.33	.0	.0	6.0	
2	Mid-Con 2 Standard	MIDCON-2 CEMENT STANDARD - SBM (15078)			200.0	sacks	11.4	2.89	17.84	6.0	17.84
	0.25 lbm	POLY-E-FLAKE (101216940)									
	17.838 Gal	FRESH WATER									
3	50/50 Poz Standard	POZ STANDARD 50/50 - SBM (12308)			380.0	sacks	13.3	1.63	7.25	6.0	7.25
	10 lbm	KOL-SEAL, BULK (100064233)									
	0.5 %	HALAD(R)-322, 50 LB (100003646)									
	0.25 lbm	POLY-E-FLAKE (101216940)									
	7.25 Gal	FRESH WATER									
4	2% Clay-Fix 3 Water w/ Biocide Displacement				70.00	bbl	8.33	.0	.0	6.0	
	0.105 gal/bbl	CLAYFIX 3, TOTETANK (101583425)									
	0.021 gal/bbl	BE-7, TOTE TANK (101649552)									
	42 gal/bbl	WATER - FRESH - GAL (24047)									
Calculated Values			Pressures			Volumes					
Displacement		Shut In: Instant		Lost Returns		Cement Slurry		Pad			
Top Of Cement		5 Min		Cement Returns	35	Actual Displacement		Treatment			
Frac Gradient		15 Min		Spacers		Load and Breakdown		Total Job			
Rates											
Circulating		Mixing		Displacement		Avg. Job					
Cement Left In Pipe	Amount	0 ft	Reason	Shoe Joint							
Frac Ring # 1 @	ID	Frac ring # 2 @	ID	Frac Ring # 3 @	ID	Frac Ring # 4 @	ID				
The Information Stated Herein Is Correct				Customer Representative Signature 							

RECEIVED

JUL 27 2010

KCC WICHITA



July 23, 2010

Kansas Corporation Commission  
Conservation Division  
Finney State Office Building  
130 S. Market Room 2078  
Wichita, KS 67202-3802

RE: Spikes B 5H  
Section 21-31S-38W  
API 15-189-22706  
Stevens County, Kansas

Gentlemen:

Enclosed are the following forms and documents for the completion of the above referenced new well:

ACO-1 Well Completion form (original & 2 copies)  
CG-8 Form  
Cementing Tickets  
Copies of all logs run

No confidentiality is requested.

Please call me at 832-636-8380 if there are any questions.

Sincerely,

A handwritten signature in cursive script that reads "Diana Smart".

Diana Smart  
Staff Regulatory Analyst  
[Diana.Smart@anadarko.com](mailto:Diana.Smart@anadarko.com)

Enclosures

RECEIVED  
JUL 27 2010  
KCC WICHITA