

For KCC Use: 9-13-2010
 Effective Date: 4
 District #: 4
 SGA? Yes No

KANSAS CORPORATION COMMISSION
 OIL & GAS CONSERVATION DIVISION

OWWO

Form C-1
 March 2010

Form must be Typed
 Form must be Signed
 All blanks must be Filled

NOTICE OF INTENT TO DRILL

Must be approved by KCC five (5) days prior to commencing well
 Form KSONA-1, Certification of Compliance with the Kansas Surface Owner Notification Act, MUST be submitted with this form.

Expected Spud Date: 10 5 2010
 month day year

OPERATOR: License# 33937 ✓
 Name: Meridian Energy Inc.
 Address 1: 1475 N. Ward Cr.
 Address 2: _____
 City: Franktown State: CO Zip: 80116 + _____
 Contact Person: Neal LaFon, President
 Phone: 303-688-4022

CONTRACTOR: License# _____ Must be licensed by KCC
 Name: Advise on ACO-1 ✓

Well Drilled For: Oil Gas Seismic; _____ # of Holes Other: _____
 Well Class: Enh Rec Storage Disposal Other: _____
 Type Equipment: Mud Rotary Air Rotary Cable

If OWWO: old well information as follows:
 Operator: L. B. Stableford and K and E
 Well Name: #1 Hamel
 Original Completion Date: 7/20/51 Original Total Depth: 3744

Directional, Deviated or Horizontal wellbore? Yes No
 If Yes, true vertical depth: _____
 Bottom Hole Location: _____
 KCC DKT #: _____

Spot Description: _____
 _____ - SW - SW - SW Sec. 33 Twp. 9 S. R. 19 E W
 (Q/Q/Q/Q) 330 feet from N / S Line of Section
330 feet from E / W Line of Section

Is SECTION: Regular Irregular?
 (Note: Locate well on the Section Plat on reverse side)

County: Rooks
 Lease Name: Hamel Well #: #1
 Field Name: Lynd ✓

Is this a Prorated / Spaced Field? Yes No
 Target Formation(s): Arbuckle ✓
 Nearest Lease or unit boundary line (in footage): 330 ✓

Ground Surface Elevation: 2211 feet MSL
 Water well within one-quarter mile: Yes No
 Public water supply well within one mile: Yes No
 Depth to bottom of fresh water: 150
 Depth to bottom of usable water: 900
 Surface Pipe by Alternate: I II

Length of Surface Pipe Planned to be set: 8 5/8 @ 205 5 1/2 @ 3741
 Length of Conductor Pipe (if any): _____
 Projected Total Depth: 3740 ✓
 Formation at Total Depth: Arbuckle ✓

Water Source for Drilling Operations: Well Farm Pond Other: _____
 DWR Permit #: _____

(Note: Apply for Permit with DWR)
 Will Cores be taken? Yes No
 If Yes, proposed zone: _____

AFFIDAVIT

The undersigned hereby affirms that the drilling, completion and eventual plugging of this well will comply with K.S.A. 55 et. seq.

It is agreed that the following minimum requirements will be met:

1. Notify the appropriate district office **prior** to spudding of well;
2. A copy of the approved notice of intent to drill **shall be** posted on each drilling rig;
3. The minimum amount of surface pipe as specified below **shall be set** by circulating cement to the top; in all cases surface pipe **shall be set** through all unconsolidated materials plus a minimum of 20 feet into the underlying formation.
4. If the well is dry hole, an agreement between the operator and the district office on plug length and placement is necessary **prior to plugging**;
5. The appropriate district office will be notified before well is either plugged or production casing is cemented in;
6. If an ALTERNATE II COMPLETION, production pipe shall be cemented from below any usable water to surface within **120 DAYS** of spud date. Or pursuant to Appendix "B" - Eastern Kansas surface casing order #133,891-C, which applies to the KCC District 3 area, alternate II cementing must be completed within 30 days of the spud date or the well shall be plugged. **In all cases, NOTIFY district office** prior to any cementing.

I hereby certify that the statements made herein are true and to the best of my knowledge and belief.

Date: 9/3/10 Signature of Operator or Agent: Neal LaFon Title: President

For KCC Use ONLY
 API # 15 - 163-01708-00-01
 Conductor pipe required None feet
 Minimum surface pipe required 205 feet per ALT. I II
 Approved by: Lu 9-8-2010
 This authorization expires 9-8-2011
 (This authorization void if drilling not started within 12 months of approval date.)
 Spud date: _____ Agent: _____

Remember to:

- File Certification of Compliance with the Kansas Surface Owner Notification Act (KSONA-1) with Intent to Drill;
- File Drill Pit Application (form CDP-1) with Intent to Drill;
- File Completion Form ACO-1 within 120 days of spud date;
- File acreage attribution plat according to field proration orders;
- Notify appropriate district office 48 hours prior to workover or re-entry;
- Submit plugging report (CP-4) after plugging is completed (within 60 days);
- Obtain written approval before disposing or injecting salt water.
- If well will not be drilled or permit has expired (See: authorized expiration date) please check the box below and return to the address below.

Well will not be drilled or Permit Expired Date: _____
 Signature of Operator or Agent: _____

Mail to: KCC - Conservation Division,
 130 S. Market - Room 2078, Wichita, Kansas 67202

RECEIVED
 SEP 07 2010
 KCC WICHITA

33
 9
 19
 E
 W

For KCC Use ONLY

API # 15 - 163-01708-00-01

IN ALL CASES PLOT THE INTENDED WELL ON THE PLAT BELOW

In all cases, please fully complete this side of the form. Include items 1 through 5 at the bottom of this page.

Operator: Meridian Energy Inc.

Lease: Hamel

Well Number: #1

Field: Lynd

Number of Acres attributable to well: _____

QTR/QTR/QTR/QTR of acreage: _____ - SW - SW - SW

Location of Well: County: Rooks

330 feet from N / S Line of Section
330 feet from E / W Line of Section
Sec. 33 Twp. 9 S. R. 19 E W

Is Section: Regular or Irregular

If Section is Irregular, locate well from nearest corner boundary.

Section corner used: NE NW SE SW

PLAT

Show location of the well. Show footage to the nearest lease or unit boundary line. Show the predicted locations of lease roads, tank batteries, pipelines and electrical lines, as required by the Kansas Surface Owner Notice Act (House Bill 2032). You may attach a separate plat if desired.

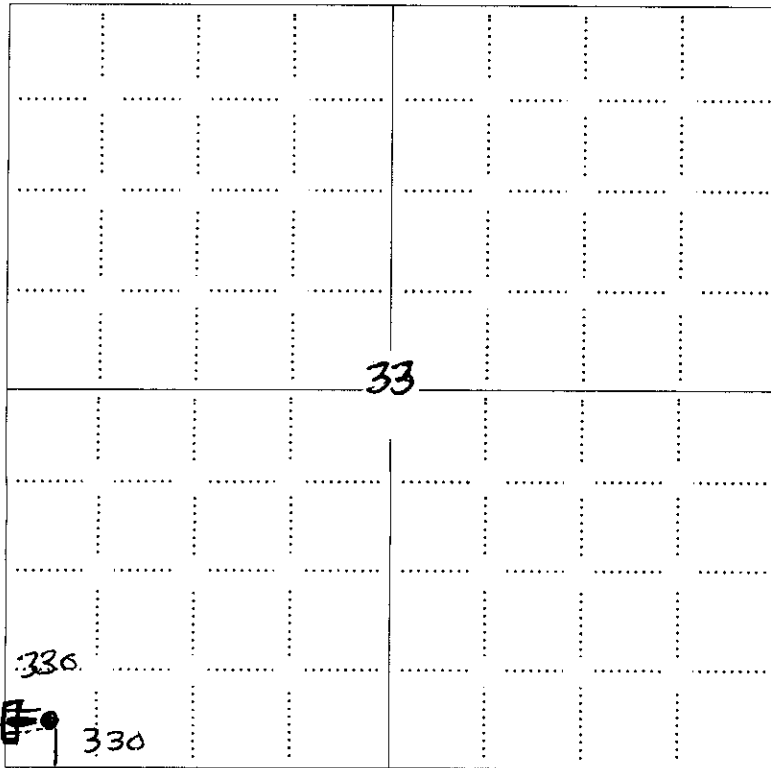

LEGEND

- Well Location
- Tank Battery Location
- Pipeline Location
- Electric Line Location
- Lease Road Location

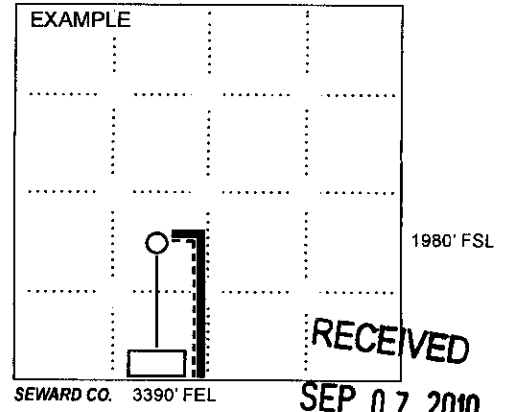

RECEIVED
SEP 07 2010

KCC WICHITA

NOTE: In all cases locate the spot of the proposed drilling location.

In plotting the proposed location of the well, you must show:

1. The manner in which you are using the depicted plat by identifying section lines, i.e. 1 section, 1 section with 8 surrounding sections, 4 sections, etc.
2. The distance of the proposed drilling location from the south / north and east / west outside section lines.
3. The distance to the nearest lease or unit boundary line (in footage).
4. If proposed location is located within a prorated or spaced field a certificate of acreage attribution plat must be attached: (C0-7 for oil wells; CG-8 for gas wells).
5. The predicted locations of lease roads, tank batteries, pipelines, and electrical lines.

KANSAS CORPORATION COMMISSION
OIL & GAS CONSERVATION DIVISION

Form CDP-1
May 2010
Form must be Typed

APPLICATION FOR SURFACE PIT

Submit in Duplicate

Operator Name: Meridian Energy Inc.		License Number: 33937	
Operator Address: 1475 N. Ward Cr.		Franktown CO 80116	
Contact Person: Neal LaFon, President		Phone Number: 303-688-4022	
Lease Name & Well No.: Hamel #1		Pit Location (QQQQ): _____ - <u>SW</u> - <u>SW</u> - <u>SW</u> Sec. <u>33</u> Twp. <u>9</u> R. <u>19</u> <input type="checkbox"/> East <input type="checkbox"/> West <u>330</u> Feet from <input type="checkbox"/> North / <input checked="" type="checkbox"/> South Line of Section <u>330</u> Feet from <input type="checkbox"/> East / <input checked="" type="checkbox"/> West Line of Section Rooks _____ County	
Type of Pit: <input type="checkbox"/> Emergency Pit <input type="checkbox"/> Burn Pit <input type="checkbox"/> Settling Pit <input type="checkbox"/> Drilling Pit <input checked="" type="checkbox"/> Workover Pit <input type="checkbox"/> Haul-Off Pit <small>(If WP Supply API No. or Year Drilled)</small>	Pit is: <input checked="" type="checkbox"/> Proposed <input type="checkbox"/> Existing If Existing, date constructed: _____ Pit capacity: _____ (bbls)		
Is the pit located in a Sensitive Ground Water Area? <input type="checkbox"/> Yes <input checked="" type="checkbox"/> No		Chloride concentration: _____ mg/l <small>(For Emergency Pits and Settling Pits only)</small>	
Is the bottom below ground level? <input checked="" type="checkbox"/> Yes <input type="checkbox"/> No		Artificial Liner? <input checked="" type="checkbox"/> Yes <input type="checkbox"/> No	
How is the pit lined if a plastic liner is not used?			
Pit dimensions (all but working pits): <u>8</u> Length (feet) <u>15</u> Width (feet) <input type="checkbox"/> N/A: Steel Pits Depth from ground level to deepest point: <u>6</u> (feet) <input type="checkbox"/> No Pit			
If the pit is lined give a brief description of the liner material, thickness and installation procedure. 3 mil plastic, anchored around edges		Describe procedures for periodic maintenance and determining liner integrity, including any special monitoring. temporary pit, visual monitoring	
Distance to nearest water well within one-mile of pit: <u>4977</u> feet Depth of water well <u>80</u> feet		Depth to shallowest fresh water <u>35</u> feet. Source of information: <input type="checkbox"/> measured <input type="checkbox"/> well owner <input type="checkbox"/> electric log <input checked="" type="checkbox"/> KDWR	
Emergency, Settling and Burn Pits ONLY: Producing Formation: _____ Number of producing wells on lease: _____ Barrels of fluid produced daily: _____ Does the slope from the tank battery allow all spilled fluids to flow into the pit? <input type="checkbox"/> Yes <input type="checkbox"/> No		Drilling, Workover and Haul-Off Pits ONLY: Type of material utilized in drilling/workover: _____ Number of working pits to be utilized: <u>2</u> Abandonment procedure: <u>evaporate or dispose of water, remove liner and backfill</u> Drill pits must be closed within 365 days of spud date.	
I hereby certify that the above statements are true and correct to the best of my knowledge and belief. <u>9/3/10</u> Date		RECEIVED SEP 07 2010 KCC WICHITA <i>Neal A LaFon</i> Signature of Applicant or Agent	
KCC OFFICE USE ONLY			
Date Received: <u>9-7-10</u> Permit Number: _____ Permit Date: <u>9-7-10</u> Lease Inspection: <input type="checkbox"/> Yes <input checked="" type="checkbox"/> No			

15-163-01708-00-01

STATE OF KANSAS
STATE CORPORATION COMMISSION
200 Colorado Derby Building
Wichita, Kansas 67202

WELL PLUGGING RECORD
K.A.R.-82-3-117

#4 API NUMBER 15-163-01708-00-00

TYPE OR PRINT
NOTICE: Fill out completely
and return to Cons. Div.
office within 30 days.

LEASE NAME Hamel
WELL NUMBER 1
SPOT LOCATION SW SW SW
SEC. 33 TWP. 9 RGE. 19 (E) or (W)
COUNTY Rooks
Date Well Completed _____
Plugging Commenced 7-29-88
Plugging Completed 7-29-88

LEASE OPERATOR Okmar Oil Company
ADDRESS Box 723 Hays, Ks. 67601
PHONE # 913 628 6101 OPERATORS LICENSE NO. 5245

Character of Well Oil
(Oil, Gas, D&A, SWD, Input, Water Supply Well)

Did you notify the KCC/KDHE Joint District Office prior to plugging this well? Yes

Which KCC/KDHE Joint Office did you notify? Hays, Ks.

Is ACO-1 filed? Yes If not, is well log attached? _____

Producing formation _____ Depth to top _____ bottom _____ T.D. _____

Show depth and thickness of all water, oil and gas formations.

OIL, GAS OR WATER RECORDS | CASING RECORD

Formation	Content	From	To	Size	Put In	Pulled out
	Surface	0	209	8 5/8		
	Casing	0	3740	5 1/2		

Describe in detail the manner in which the well was plugged, indicating where the mud fluid was placed and the method or methods used in introducing it into the hole. If cement or other plugs were used state the character of same and depth placed, from feet to feet each set. Mixed and pump 100 sks. thrifty mix and 5 hulls down annulus shut in 400#. Mix and pump 230 sks. thrifty mix and 3 hulls and shut in at 1000#.

(If additional description is necessary, use BACK of this form.)

Name of Plugging Contractor Okmar Oil Co. License No. 5245
Address Box 723 Hays, Kansas 67601

BJ Titan (cement)

STATE OF Kansas COUNTY OF Ellis, ss.

Mr. Ted Crawford (employee of operator) or (operator) of above-described well, being first duly sworn on oath, says: That I have read the facts, statements, and matters herein contained and the information above-described well as filed that the same are true and correct, so help me God.

RECEIVED
STATE CORPORATION COMMISSION

AUG 15 1988
8-15-88
CONSERVATION DIVISION
Wichita, Kansas

(Signature) Ted Crawford
(Address) Box 723 Hays, Ks.

SUBSCRIBED AND SWORN TO before me this 12 day of August, 1988

Rosemary Smith
Notary Public

My Commission expires: 5-1-1991

CERTIFICATION OF COMPLIANCE WITH THE KANSAS SURFACE OWNER NOTIFICATION ACT

This form must be submitted with all Forms C-1 (Notice of Intent to Drill); CB-1 (Cathodic Protection Borehole Intent); T-1 (Request for Change of Operator Transfer of Injection or Surface Pit Permit); and CP-1 (Well Plugging Application). Any such form submitted without an accompanying Form KSONA-1 will be returned.

Select the corresponding form being filed: C-1 (Intent) CB-1 (Cathodic Protection Borehole Intent) T-1 (Transfer) CP-1 (Plugging Application)

OPERATOR: License # 33937
Name: Meridian Energy Inc.
Address 1: 1475 N. Ward Cr.
Address 2: _____
City: Franktown State: CO Zip: 80116 + _____
Contact Person: Neal LaFon
Phone: (303) 688-4022 Fax: (_____) _____
Email Address: _____

Well Location:
_____ SW SW SW Sec. 33 Twp. 9 S. R. 19 East West
County: Rooks
Lease Name: Hamel Well #: #1

If filing a Form T-1 for multiple wells on a lease, enter the legal description of the lease below:

Surface Owner Information:

Name: Renee M. Baas, Trustee of the M.R.K. Trust dated 12-1-09
Address 1: 1123 Rd. M
Address 2: _____
City: Emporia State: KS Zip: 66801 + _____

When filing a Form T-1 involving multiple surface owners, attach an additional sheet listing all of the information to the left for each surface owner. Surface owner information can be found in the records of the register of deeds for the county, and in the real estate property tax records of the county treasurer.

If this form is being submitted with a Form C-1 (Intent) or CB-1 (Cathodic Protection Borehole Intent), you must supply the surface owners and the KCC with a plat showing the predicted locations of lease roads, tank batteries, pipelines, and electrical lines. The locations shown on the plat are preliminary non-binding estimates. The locations may be entered on the Form C-1 plat, Form CB-1 plat, or a separate plat may be submitted.

Select one of the following:

I certify that, pursuant to the Kansas Surface Owner Notice Act (House Bill 2032), I have provided the following to the surface owner(s) of the land upon which the subject well is or will be located: 1) a copy of the Form C-1, Form CB-1, Form T-1, or Form CP-1 that I am filing in connection with this form; 2) if the form being filed is a Form C-1 or Form CB-1, the plat(s) required by this form; and 3) my operator name, address, phone number, fax, and email address.

I have not provided this information to the surface owner(s). I acknowledge that, because I have not provided this information, the KCC will be required to send this information to the surface owner(s). To mitigate the additional cost of the KCC performing this task, I acknowledge that I am being charged a \$30.00 handling fee, payable to the KCC, which is enclosed with this form.

If choosing the second option, submit payment of the \$30.00 handling fee with this form. If the fee is not received with this form, the KSONA-1 form and the associated Form C-1, Form CB-1, Form T-1, or Form CP-1 will be returned.

I hereby certify that the statements made herein are true and correct to the best of my knowledge and belief.

Date: 9/3/10 Signature of Operator or Agent: Neal LaFon Title: President

RECEIVED
SEP 07 2010
KCC WICHITA