

FOR KCC USE:

15-051-24894-00-00

FORM C-1 7/91

FORM MUST BE TYPED

EFFECTIVE DATE: 3-27-95  
DISTRICT # 4  
SGA? Yes  No

State of Kansas  
NOTICE OF INTENTION TO DRILL

FORM MUST BE SIGNED  
ALL BLANKS MUST BE FILLED

Must be approved by the K.C.C. five (5) days prior to commencing well

Expected Spud Date MARCH 27, 1995  
month day year

AP: NE-NE - NW: NW  
Spot  
Sec 2 Twp 11 S, Rg 17 East  
X West

OPERATOR: License # 3842  
Name: LARSON OPERATING CO., DIV OF LARSON ENGINEERING, INC.  
Address: 562 WEST HIGHWAY 4  
City/State/Zip: OLMITZ, KS 67564-8561  
Contact Person: TOM LARSON  
Phone: (316) 653-7368

5 feet from North / line of Section  
1299 feet from / West line of Section  
IS SECTION X REGULAR IRREGULAR  
(Note: Locate well on the Section Plat on Reverse Side)  
County: ELLIS  
Lease Name: BRUNGARDT UNIT Well #: 21  
Field Name: BRUNGARDT

CONTRACTOR: License #: 5929  
Name: DUKE DRILLING CO., INC.

Is this a Prorated Field? yes X no  
Target Formation(s): ARBUCKLE, LKC, TORONTO, CONG SAND  
Nearest lease or unit boundary: 1299'  
Ground Surface Elevation: 1905 EST feet MSL  
Water well within one-quarter mile: yes X no  
Public water supply well within one mile: yes X no  
Depth to bottom of fresh water: 180'  
Depth to bottom of usable water: 620'  
Surface Pipe by Alternate: 1 X 2  
Length of Surface Pipe Planned to be set: 200  
Length of Conductor pipe required: NONE  
Projected Total Depth: 3650  
Formation At Total Depth: ARBUCKLE  
Water Source for Drilling Operations:

Well Drilled For: Well Class: Type Equipment:  
X Oil Enh Rec X Infield X Mud Rotary  
Gas Storage Pool Ext Air Rotary  
OWMO Disposal Wildcat Cable  
Seismic; # of Holes Other  
Other

If OWMO: old well information as follows:

Operator:  
Well Name:  
Comp. Date: Old Total Depth:

... well ... farm pond X other  
DWR Permit #: DRILLING CONTRACTOR APPL W/ DWR  
Will Cores Be Taken?: yes X no  
If yes, proposed zones:

Directional, Deviated or Horizontal wellbore? yes X no  
If yes, true vertical depth:  
Bottom Hole Location:

AFFIDAVIT

The undersigned hereby affirms that the drilling, completion and eventual plugging of this well will comply with K.S.A. 55-101, et. seq.

It is agreed that the following minimum requirements will be met:

- 1. Notify the appropriate district office prior to spudding of well;
- 2. A copy of the approved notice of intent to drill shall be posted on each drilling rig;
- 3. The minimum amount of surface pipe as specified below shall be set by circulating cement to the top in all cases surface pipe shall be set through all unconsolidated materials plus a minimum of 20 feet into the underlying formation;
- 4. If the well is dry hole, an agreement between the operator and the district office on plug length and placement is necessary prior to plugging;
- 5. The appropriate district office will be notified before well is either plugged or production casing is cemented in;
- 6. If AN ALTERNATE II COMPLETION, PRODUCTION PIPE SHALL BE CEMENTED FROM BELOW ANY USABLE WATER TO SURFACE WITHIN 120 DAYS OF SPUD DATE. IN ALL CASES, NOTIFY DISTRICT OFFICE PRIOR TO ANY CEMENTING.

I hereby certify that the statements made herein are true and to the best of my knowledge and belief.

Date: MARCH 21, 1995 Signature of Operator or Agent: Carol Larson Title: SECRETARY/TREASURER

FOR KCC USE:  
API # 15- 051-248940000  
Conductor pipe required NONE feet  
Minimum surface pipe required 200 feet per Alt. X(2)  
Approved by: DPW 3-22-95  
This authorization expires: 9-22-95  
(This authorization void if drilling not started within 6 months of effective date.)  
Spud date: Agent:

REMEMBER TO:

- File Drill Pit Application (form CDP-1) with Intent to Drill;
- File Completion Form ACO-1 within 120 days of spud date;
- File acreage attribution plat according to field proration orders;
- Notify appropriate district office 48 hours prior to workover or re-entry;
- Submit plugging report (CP-4) after plugging is completed;
- Obtain written approval before disposing or injecting salt water.

Mail to: Conservation Division, Wichita State Office Building, 130 South Market, Room 2078, Wichita, Kansas 67202.

STATE COMMISSION ON CONSERVATION  
3-22-95  
MAR 22 1995  
CIVIL RIGHTS DIVISION

2  
11  
17w

IN ALL CASES PLOT THE INTENDED WELL ON THE PLAT BELOW

**PLAT OF ACREAGE ATTRIBUTABLE TO A WELL IN A PRORATED OR SPACED FIELD**

If the intended well is in a prorated or spaced field, please fully complete this side of the form. If the intended well is in a prorated or spaced field complete the plat below showing that the well will be properly located in relationship to other wells producing from the common source of supply. Please show all the wells within 1 mile of the boundaries of the proposed acreage attribution unit for gas wells and within 1/2 mile of the boundaries of the proposed acreage attribution unit for oil wells.

API NO. 15- \_\_\_\_\_  
 OPERATOR \_\_\_\_\_  
 LEASE \_\_\_\_\_  
 WELL NUMBER \_\_\_\_\_  
 FIELD \_\_\_\_\_

LOCATION OF WELL: COUNTY \_\_\_\_\_  
 \_\_\_\_\_ feet from south/north line of section  
 \_\_\_\_\_ feet from east/west line of section  
 SECTION \_\_\_\_\_ TWP \_\_\_\_\_ RG \_\_\_\_\_

NUMBER OF ACRES ATTRIBUTABLE TO WELL \_\_\_\_\_  
 QTR/QTR/QTR OF ACREAGE \_\_\_\_\_ - \_\_\_\_\_ - \_\_\_\_\_

IS SECTION \_\_\_\_\_ REGULAR or \_\_\_\_\_ IRREGULAR  
IF SECTION IS IRREGULAR, LOCATE WELL FROM NEAREST CORNER BOUNDARY.

Section corner used: \_\_\_\_\_ NE \_\_\_\_\_ NW \_\_\_\_\_ SE \_\_\_\_\_ SW  
PLAT

(Show location of the well and shade attributable acreage for prorated or spaced wells.)  
 (Show footage to the nearest lease or unit boundary line.)

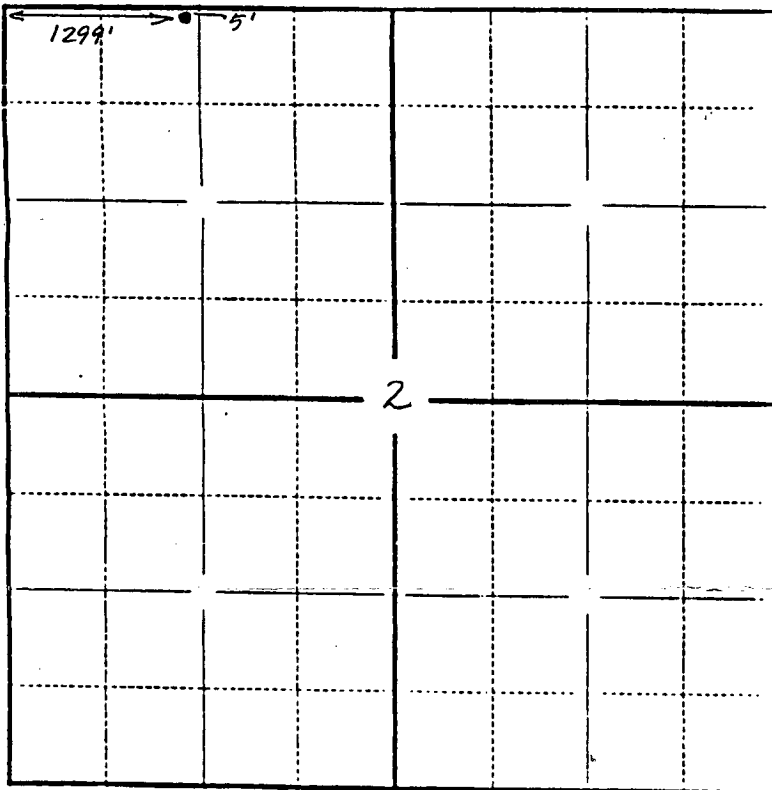

*Ellis County*

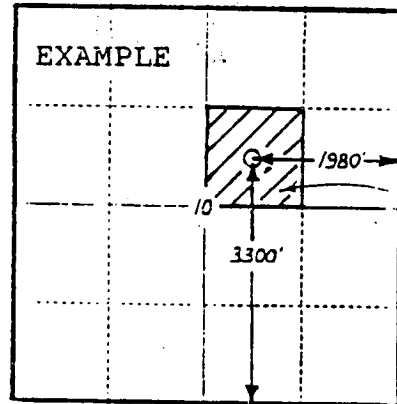

40  
ACRES

In plotting the proposed location of the well, you must show:

- 1) The manner in which you are using the depicted plat by identifying section lines; i.e. 1 section, 1 section with 8 surrounding sections, 4 sections, etc.;
- 2) the distance of the proposed drilling location from the section's south/north and east/west lines; and
- 3) the distance to the nearest lease or unit boundary line.