

July 28, 2010

Erin Joseph
Noble Energy, Inc.
1625 Broadway, Suite 2200
Denver, CO 80202

RE: Approved Commingling CO061005
Black 2-15, Sec. 15-T34S-R31W, Seward County
API No. 15-175-21872-00-01

Dear Ms Joseph:

Your Application for Commingling (ACO-4) for the above described well has been reviewed and approved by the Kansas Corporation Commission (KCC) per K.A.R. 82-3-123. Notice was examined and found to be proper per K.A.R. 82-3-135a. No protest had been filed within the 15-day protest period. This application, which was received by the KCC on June 24, 2010 concerns approval to simultaneously produce from the following sources of supply through the same tubing string in the same wellbore:

Source of Supply	Estimated Current Production			Perf Depth
	BOPD	MCFPD	BWPD	
Cherokee	3.00	0.00	12.00	5357-5369
Morrow	0.50	42.00	0.00	5660-5682
Chester	0.50	42.00	0.00	5700-5900
Total Estimated Current Production	4.00	84.00	12.00	

Based upon the depth of the Chester formation perforations, total oil production shall not exceed 200 BOPD and total gas production shall not exceed 50% of the absolute open flow (AOF).

File form ACO-1 upon completion of the well to commingle.

Docket Number CO061005 has been assigned to this approved application. Use this number for well completion reports (ACO-1) and other correspondence that may concern this approved commingling.

Sincerely,



Rick Hestermann
Production Department

KANSAS CORPORATION COMMISSION
OIL & GAS CONSERVATION DIVISION

Form ACO-4
Form must be typed
March 2009

APPLICATION FOR COMMINGLING OF
PRODUCTION (K.A.R. 82-3-123) OR FLUIDS (K.A.R. 82-3-123a)

Commingling ID # CD061005

OPERATOR: License # 33190
Name: Noble Energy, Inc.
Address 1: 1625 Broadway, Suite 2200
Address 2: _____
City: Denver State: CO Zip: 80202 + _____
Contact Person: Erin Joseph
Phone: (303) 228-4089

API No. 15 - 175-21872
Spot Description: _____
C SW Sec. 15 Twp. 34 S. R. 31 East West
1,320 Feet from North / South Line of Section
1,320 Feet from East / West Line of Section
County: Seward
Lease Name: Black Well #: 2-15

1. Name and upper and lower limit of each production interval to be commingled:
- | | |
|----------------------------|---------------------------|
| Formation: <u>Cherokee</u> | (Perfs): <u>5357-5369</u> |
| Formation: <u>Morrow</u> | (Perfs): <u>5660-5682</u> |
| Formation: <u>Chester</u> | (Perfs): <u>5700-5900</u> |
| Formation: _____ | (Perfs): _____ |
| Formation: _____ | (Perfs): _____ |

2. Estimated amount of fluid production to be commingled from each interval:
- | | | | |
|----------------------------|-----------------|------------------|-----------------|
| Formation: <u>Cherokee</u> | BOPD: <u>3</u> | MCFPD: <u>0</u> | BWPD: <u>12</u> |
| Formation: <u>Morrow</u> | BOPD: <u>.5</u> | MCFPD: <u>42</u> | BWPD: <u>0</u> |
| Formation: <u>Chester</u> | BOPD: <u>.5</u> | MCFPD: <u>42</u> | BWPD: <u>0</u> |
| Formation: _____ | BOPD: _____ | MCFPD: _____ | BWPD: _____ |
| Formation: _____ | BOPD: _____ | MCFPD: _____ | BWPD: _____ |

3. Plat map showing the location of the subject well, all other wells on the subject lease, and all wells on offsetting leases within a 1/2 mile radius of the subject well, and for each well the names and addresses of the lessee of record or operator.

4. Signed certificate showing service of the application and affidavit of publication as required in K.A.R. 82-3-135a.

For Commingling of PRODUCTION ONLY, include the following:

5. Wireline log of subject well. Previously Filed with ACO-1: Yes No *DNF*
6. Complete Form ACO-1 (Well Completion form) for the subject well.

RECEIVED
KANSAS CORPORATION COMMISSION

JUN 24 2010

CONSERVATION DIVISION
WICHITA, KS

For Commingling of FLUIDS ONLY, include the following:

7. Well construction diagram of subject well.
8. Any available water chemistry data demonstrating the compatibility of the fluids to be commingled.

AFFIDAVIT: I am the affiant and hereby certify that to the best of my current information, knowledge and personal belief, this request for commingling is true and proper and I have no information or knowledge, which is inconsistent with the information supplied in this application.

Signature: *Erin Joseph*
Printed Name: Erin Joseph
Title: Regulatory Analyst II

KCC Office Use Only

Denied Approved

15-Day Periods Ends: 7-28-2010

Approved By: _____ Date: _____

Protests may be filed by any party having a valid interest in the application. Protests must be in writing and comply with K.A.R. 82-3-135b and must be filed within 15 days of publication of the notice of application.

TOPOGRAPHIC LAND SURVEYORS OF P.A., TEXAS

2225 PERRYTON PKWY • PAMPA, TEXAS 79065
(806) 665-7218 • (800) 658-6382 • FAX (806) 665-7210
Kansas Certificate of Authorization No. LS-99

Operator: Noble Energy Inc. Lease Name: BLACK Well No.: 2-15
Footages: 1320'FSL & 1320'FWL Elevation: 2477'GR
Section: 15 Township: 34S Range: 31W SEWARD County, Kansas

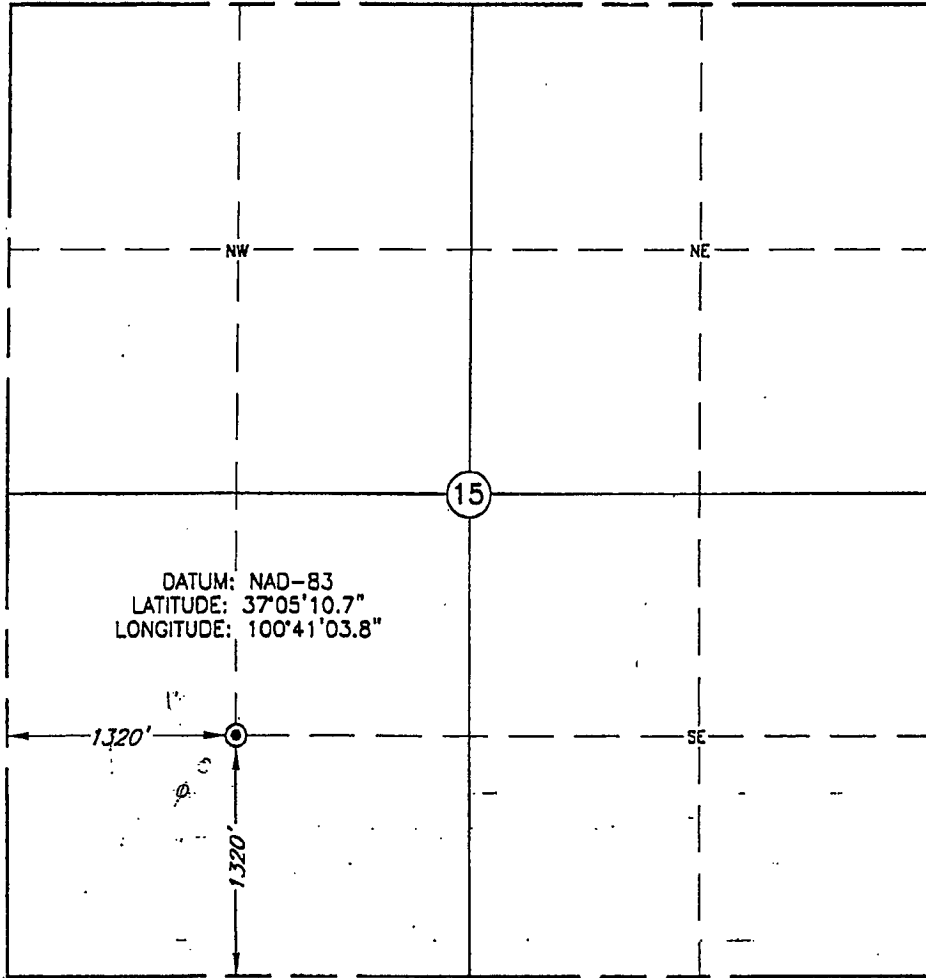

RECEIVED
KANSAS CORPORATION COMMISSION
JUN 24 2010
CONSERVATION DIVISION
WICHITA, KS

Topography & Vegetation: PASTURE

Reference or Alternate Stakes Set: ALT. 1175'FSL & 1175'FWL ELEV.(2482'GR)

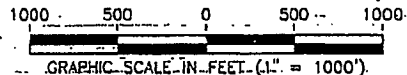

Best Accessibility to Location: FROM TRAIL ROAD SOUTHWEST OF LOCATION

Distance & Direction: ±7 MILES SOUTH/SOUTHEAST OF KISMET, KANSAS.

This plat DOES NOT represent a true Boundary Survey. The footages and ties shown are from lines of occupation, which may not be actual Property Lines.
Date Surveyed: 2-19-02
Date Drawn: 2-23-02
Drawn by: J.WILLIAMS
Job No.: 80488
Book: _____ Page: _____

CERTIFICATE
I, V. Lynn Bezner, a Registered Land Surveyor and an authorized agent of Topographic Land Surveyors, do hereby certify that the above described well location was surveyed and staked on the ground as shown.
V. Lynn Bezner 2-26-02
V. Lynn Bezner, R.P.S. No. 1059

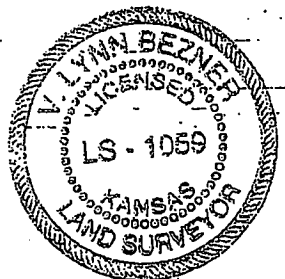

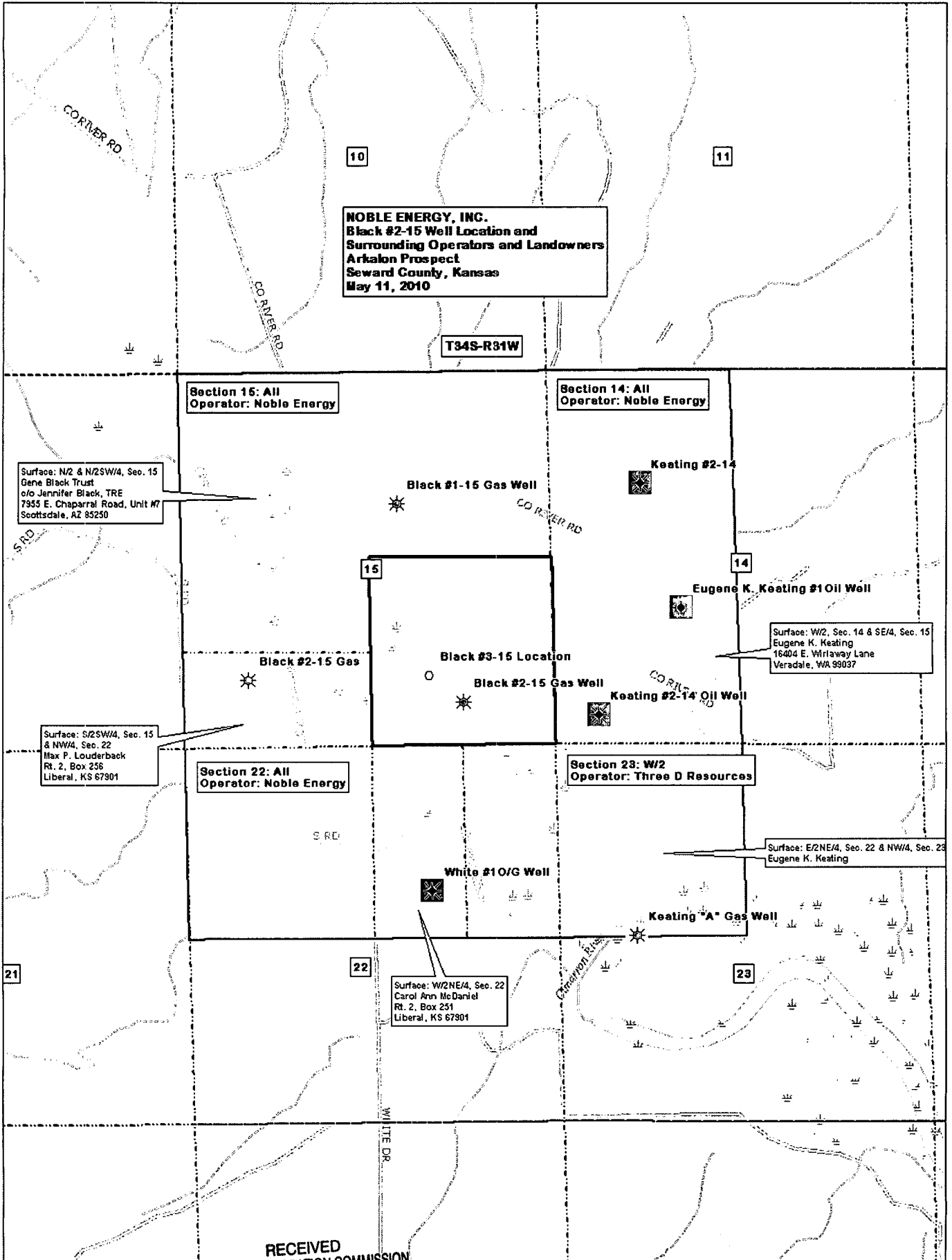

RECEIVED
KANSAS CORPORATION COMMISSION

Data use subject to license.

© DeLorme. XMap® 7.

www.delorme.com

JUN 24 2010

CONSERVATION DIVISION
WICHITA, KS

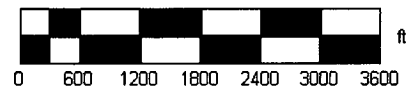

Data Zoom 13-2

*1625 Broadway
Suite 2200
Denver, CO 80202

Tel: 303.228.4000
Fax: 303.228.4286
www.nobleenergyinc.com



CO 061005

Affidavit of Notice Served

RE: Application for Commingle

Well Name: Black 2-15

Legal Location: C, SW, Sec 15, T34S, R34W, Seward County, KS

The undersigned hereby certifies that he / she is a duly authorized agent for the applicant, and that on the day 7th of July, 2010, a true and correct copy of the application referenced above was delivered or mailed to the following parties:

Three D Resources, Attn: Norman Brungardt, Jr., P O Box 856, Liberal, KS 67901

Certified Mail # 7008 3230 0001 8977 7091



Applicant

Subscribed and sworn to before me this 13th day of July, 2010



Notary Public

My Commission Expires 09/11/2014

My Commission Expires: _____

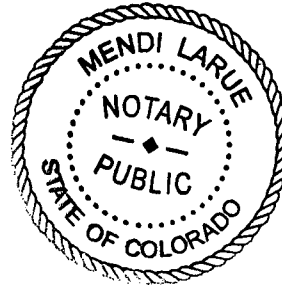

RECEIVED

JUL 14 2010

KCC WICHITA

PROOF OF PUBLICATION

STATE OF KANSAS, SEWARD COUNTY, ss:

Betty J. Dubois, being first duly sworn, deposes and says: That he is the publisher - principal clerk - of

THE HIGH PLAINS DAILY LEADER

a newspaper printed in the State of Kansas, and published in and of general circulation in Seward County, Kansas, with a general paid circulation on a daily basis in Seward County, Kansas, and that said newspaper is not a trade, religious or fraternal publication.

Said newspaper is published at least weekly 50 times a year; has been so published continuously and uninterruptedly in said county and state for a period of more than five years prior to the first publication of said notice; and has been admitted at the post office of Liberal in said County as second class matter.

That the attached notice is a true copy thereof and was published in the regular and

entire issue of said newspaper for 6 consecutive days, the first publication thereof being made as aforesaid on the 31st day of May, 2010, with subsequent publications being made on the following dates:

- June 1, 2010
June 2, 2010
June 3, 2010
June 4, 2010
June 6, 2010

Betty J. Dubois
SUBSCRIBED AND SWORN to before me this 7th day of June, 2010.

Laurie E. Love
Notary Public

My Commission Expires, November 10, 2012

Printer's Fee . . . \$ 315.90

37
tions.net
otos At
ion.com
tion
ctioneer
, CO
758
all Away"
TION
AUCTION
2010 - 1:00 P.M.
, COLORADO
E ROAD
ASHCRAFT
Brick Home, 1 1/2
t, Partial Finished
rage, Several Out
t, One And A Half'
r Ditch Water
son Haney, Broker
7852
utos At
tion.com
ction

l, Kansas, on May 31, 2010)t6
RATION
TION
brize the
d County, KS
st Owners,
y, Inc.,
and Cherokee
le SW/4 of Section 15, 34S,
be required to file their
State Corporation
e date of this publication.
tions and must state specific
iolate correlative rights or
ests are received, this
f valid protests are received,
regoing and shall govern

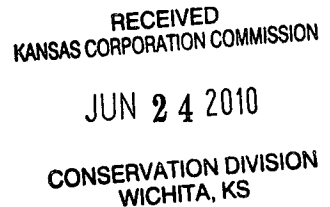
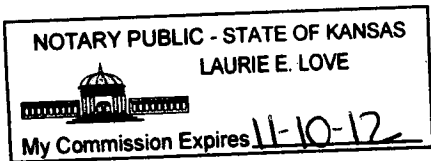

AFFIDAVIT

STATE OF KANSAS \
- SS.
County of Sedgwick /

RECEIVED
JUL 08 2010
KCC WICHITA

Mark Fletchall, of lawful age, being first duly sworn, depose and saith: That he is Record Clerk of The Wichita Eagle, a daily newspaper published in the City of Wichita, County of Sedgwick, State of Kansas, and having a general paid circulation on a daily basis in said County, which said newspaper has been continuously and uninterruptedly published in said County for more than one year prior to the first publication of the notice hereinafter mentioned, and which said newspaper has been entered as second class mail matter at the United States Post Office in Wichita, Kansas, and which said newspaper is not a trade, religious or fraternal publication and that a notice of a true copy is hereto attached was published in the regular and entire Morning issue of said The Wichita Eagle for 1 issues, that the first publication of said notice was

made as aforesaid on the 1st of

July A.D. 2010, with

subsequent publications being made on the following dates:

And affiant further says that he has personal knowledge of the statements above set forth and that they are true.

Mark Fletchall

Subscribed and sworn to before me this

1st day of July, 2010

PENNY L. CASE
Notary Public - State of Kansas
My Appt. Expires 5/28/2014

Penny L Case
Notary Public Sedgwick County, Kansas

Printer's Fee : \$115.60

LEGAL PUBLICATION

First Published in The Wichita Eagle
July 1, 2010 (3050777)

BEFORE THE STATE
CORPORATION
COMMISSION OF THE
STATE OF KANSAS

NOTICE OF FILING APPLICATION

RE: Noble Energy, Inc. - Application for a permit to authorize the commingling of zones in the Black 2-15 located in Seward County, KS
TO: All Oil and Gas Producers, Unleased Minerals Interest Owners, Landowners and all persons whomever concerned.

You, and each of you, are hereby notified that Noble Energy, Inc., has filed an application to commingle the Chester, Morrow and Cherokee zones in the Black 2-15, located approximately Center of the SW/4 of Section 15, 34S, 31W, in Seward County, KS. Any persons who object to or protest this application shall be required to file their objections or protests with the Conservation Division of the State Corporation Commission of the State of Kansas within (15) days from the date of this publication. These protests shall be filed pursuant to Commission regulations and must state specific reasons why the grant of the application may cause waste, violate correlative rights or pollute the natural resources of the State of Kansas. If no protests are received, this application may be granted through a summary proceeding. If valid protests are received, this matter will be set for hearing. All persons interested or concerned shall take notice of the foregoing and shall govern themselves accordingly.
Noble Energy, Inc
1625 Broadway Suite 2200
Denver, CO 80202
(303) 228-4000
ATTN: Erin Joseph

KANSAS CORPORATION COMMISSION
OIL & GAS CONSERVATION DIVISION

Form ACO-1
September 1999
Form Must Be Typed

WELL COMPLETION FORM
WELL HISTORY - DESCRIPTION OF WELL & LEASE

Operator: License # 33184
Name: PATINA OIL & GAS CORPORATION
Address: RT 3 BOX 203
City/State/Zip: DUNCAN, OK 73533
Purchaser: DUKE ENERGY
Operator Contact Person: JOYCE WILLIAMS
Phone: (580) 444-3408
Contractor: Name: _____
License: _____
Wellsite Geologist: _____

Designate Type of Completion:
____ New Well ____ Re-Entry Workover
____ Oil ____ SWD ____ SIOW ____ Temp. Abd.
 Gas ____ ENHR ____ SIGW
____ Dry ____ Other (Core, WSW, Expl., Cathodic, etc)

If Workover/Re-entry: Old Well Info as follows:

Operator: PATINA OIL & GAS CORPORATION
Well Name: BLACK #2-15
Original Comp. Date: 05/21/02 Original Total Depth: 6390'
____ Deepening Re-perf. ____ Conv. to Enhr./SWD
____ Plug Back ____ Plug Back Total Depth
____ Commingled Docket No. _____
____ Dual Completion Docket No. _____
____ Other (SWD or Enhr.?) Docket No. _____

<u>11/02/03</u>	<u>11/15/03</u>
Spud Date or Recompletion Date	Date Reached TD Completion Date or Recompletion Date

API No. 15 - 175-21872-00-01
County: SEWARD
NE NE SW SW Sec. 15 Twp. 34 S. R. 31 East West
1175' feet from S / N (circle one) Line of Section
1175' feet from E / W (circle one) Line of Section

Footages Calculated from Nearest Outside Section Corner:
(circle one) NE SE NW SW
Lease Name: BLACK Well #: 2-15
Field Name: ARKALON
Producing Formation: MORROW / CHESTER
Elevation: Ground: 2482' Kelly Bushing: 2496'
Total Depth: 6390' Plug Back Total Depth: 5902'
Amount of Surface Pipe Set and Cemented at 1368' Feet
Multiple Stage Cementing Collar Used? Yes No
If yes, show depth set _____ Feet
If Alternate II completion, cement circulated from _____
feet depth to _____ w/ _____ sx cmt.

Drilling Fluid Management Plan
(Data must be collected from the Reserve Pit)
Chloride content _____ ppm Fluid volume _____ bbls
Dewatering method used _____
Location of fluid disposal if hauled offsite:
Operator Name: _____
Lease Name: _____ License No.: _____
Quarter _____ Sec. _____ Twp. _____ S. R. _____ East West
County: _____ Docket No.: _____

INSTRUCTIONS: An original and two copies of this form shall be filed with the Kansas Corporation Commission, 130 S. Market - Room 2078, Wichita, Kansas 67202, within 120 days of the spud date, recompletion, workover or conversion of a well. Rule 82-3-130, 82-3-106 and 82-3-107 apply. Information of side two of this form will be held confidential for a period of 12 months if requested in writing and submitted with the form (see rule 82-3-107 for confidentiality in excess of 12 months). One copy of all wireline logs and geologist well report shall be attached with this form. ALL CEMENTING TICKETS MUST BE ATTACHED. Submit CP-4 form with all plugged wells. Submit CP-111 form with all temporarily abandoned wells.

All requirements of the statutes, rules and regulations promulgated to regulate the oil and gas industry have been fully complied with and the statements herein are complete and correct to the best of my knowledge.

Signature: Joyce Williams
Title: Eng Tech Date: 2-13-04
Subscribed and sworn to before me this 13th day of February,
20 04.
Notary Public: Kimberly A Rowell

Date Commission Expires _____
KIMBERLY A. ROWELL
Stephens County
Notary Public in and for
State of Oklahoma
Commission # 02002293 Expires 2/11/06

KCC Office Use ONLY

____ Letter of Confidentiality Attached
If Denied, Yes Date: _____
____ Wireline Log Received
____ Geologist Report Received
____ UIC Distribution

RECEIVED
KANSAS CORPORATION COMMISSION

JUN 24 2010

**CONSERVATION DIVISION
WICHITA, KS**

Operator Name: PATINA OIL & GAS CORPORATION Lease Name: BLACK Well #: 2-15
 Sec. 15 Twp. 34 S. R. 31 East West County: SEWARD

INSTRUCTIONS: Show important tops and base of formations penetrated. Detail all cores. Report all final copies of drill stems tests giving interval tested, time tool open and closed, flowing and shut-in pressures, whether shut-in pressure reached static level, hydrostatic pressures, bottom hole temperature, fluid recovery, and flow rates if gas to surface test, along with final chart(s). Attach extra sheet if more space is needed. Attach copy of all Electric Wireline Logs surveyed. Attach final geological well site report.

Drill Stem Tests Taken <input checked="" type="checkbox"/> Yes <input type="checkbox"/> No (Attach Additional Sheets) Samples Sent to Geological Survey <input checked="" type="checkbox"/> Yes <input type="checkbox"/> No Cores Taken <input type="checkbox"/> Yes <input checked="" type="checkbox"/> No Electric Log Run <input checked="" type="checkbox"/> Yes <input type="checkbox"/> No (Submit Copy) List All E. Logs Run:	<table border="0" style="width: 100%;"> <tr> <td><input checked="" type="checkbox"/> Log</td> <td>Formation (Top), Depth and Datum</td> <td><input type="checkbox"/> Sample</td> </tr> <tr> <td>Name</td> <td>Top</td> <td>Datum</td> </tr> <tr> <td>COUNCIL GROVE</td> <td>2772'</td> <td>KB</td> </tr> <tr> <td>TONTONTO</td> <td>4161'</td> <td>KB</td> </tr> <tr> <td>MARMATON</td> <td>5006'</td> <td>KB</td> </tr> <tr> <td>CHEROKEE</td> <td>5330'</td> <td>KB</td> </tr> <tr> <td>MORROW</td> <td>5548'</td> <td>KB</td> </tr> <tr> <td>CHESTER</td> <td>5682'</td> <td>KB</td> </tr> </table>	<input checked="" type="checkbox"/> Log	Formation (Top), Depth and Datum	<input type="checkbox"/> Sample	Name	Top	Datum	COUNCIL GROVE	2772'	KB	TONTONTO	4161'	KB	MARMATON	5006'	KB	CHEROKEE	5330'	KB	MORROW	5548'	KB	CHESTER	5682'	KB
<input checked="" type="checkbox"/> Log	Formation (Top), Depth and Datum	<input type="checkbox"/> Sample																							
Name	Top	Datum																							
COUNCIL GROVE	2772'	KB																							
TONTONTO	4161'	KB																							
MARMATON	5006'	KB																							
CHEROKEE	5330'	KB																							
MORROW	5548'	KB																							
CHESTER	5682'	KB																							

CASING RECORD <input type="checkbox"/> New <input type="checkbox"/> Used							
Report all strings set-conductor, surface, intermediate, production, etc.							
Purpose of String	Size Hole Drilled	Size Casing Set (In O.D.)	Weight Lbs. / Ft.	Setting Depth	Type of Cement	# Sacks Used	Type and Percent Additives
SURFACE SASING	12 1/4"	8 5/8"	24#	1368'	PREMIUM	925	2% Cacl, 1/8#/sx Flocele
PRODUCTION	7 7/8"	4 1/2"	11.6#	5941'	PREMIUM	300	5% Haled-322, 1/8#/sx Flocele

ADDITIONAL CEMENTING / SQUEEZE RECORD				
Purpose:	Depth Top Bottom	Type of Cement	#Sacks Used	Type and Percent Additives
___ Perforate				
___ Protect Casing				
___ Plug Back TD				
___ Plug Off Zone				

Shots Per Foot	PERFORATION RECORD - Bridge Plugs Set/Type Specify Footage of Each Interval Perforated	Acid, Fracture, Shot, Cement Squeeze Record (Amount and Kind of Material Used)	Depth
8	5700'-08' & 5714'-21'	5500 gal 15% HCL Acid	
4	5677'-82' & 5660'-67'	1000 gal 7 1/2 % HCL Acid- Frac w/ 20,000# sand + CO2 foam	
2	5872'-5900', 5856'-60', 5814'-36', 5798'-5808', 5777'-79', 5770'-72', 5734'-50'	5000 gal 15% HCL Acid- Frac w/ 3660 bbls Acid treated water w/ 45,500# Sand	

TUBING RECORD		Size	Set At	Packer At	Liner Run
		2 3/8"	5600'		<input type="checkbox"/> Yes <input type="checkbox"/> No
Date of First, Resumerd Production, SWD or Enhr.			Producing Method		
11/22/03			<input type="checkbox"/> Flowing <input checked="" type="checkbox"/> Pumping <input type="checkbox"/> Gas Lift <input type="checkbox"/> Other (Explain)		
Estimated Production Per 24 Hours	Oil Bbls.	Gas Mcf	Water Bbls.	Gas-Oil Ratio	Gravity
	14	135	34	9643	

Disposition of Gas Vented Sold Used on Lease (If vented, Submit ACO-18.)

METHOD OF COMPLETION Open Hole Perf. Dually Comp. Commingled Other (Specify) _____

Production Interval _____