

WELL COMPLETION FORM

WELL HISTORY - DESCRIPTION OF WELL & LEASE

OPERATOR: License # 4549

Name: ANADARKO PETROLEUM CORPORATION

Address 1: P.O. BOX 1330

Address 2: _____

City HOUSTON State TX Zip: 77251 + 1330

Contact Person: MELANIE WIGGINS

Phone (832) 636-1053

CONTRACTOR: License # 33784

Name: Trinidad Drilling LP

Wellsite Geologist: _____

Purchaser: Anadarko Energy Services Company

Designate Type of Completion

New Well _____ Re-Entry _____ Workover _____

_____ Oil _____ SWD _____ SIOW

Gas _____ ENHR _____ SIGW

_____ CM (Coal Bed Methane) _____ Temp. Abd.

_____ Dry _____ Other _____

(Core, WSW, Expl., Cathodic, etc.)

If Workover/Reentry: Old Well Info as follows:

Operator: _____

Well Name: _____

Original Comp. Date _____ Original Total Depth _____

_____ Deepening _____ Re-perf. _____ Conv.to Enhr _____ Conv.to SWD

_____ Plug Back _____ Plug Back Total Depth _____

_____ Commingled _____ Docket No. _____

_____ Dual Completion _____ Docket No. _____

_____ Other (SWD or Enhr?) _____ Docket No. _____

<u>5/1/2010</u>	<u>05/03/2010</u>	<u>05/22/2010</u>
Spud Date or	Date Reached TD	Completion Date or
Recompletion Date		Recompletion Date

API NO. 15- 189-22707-00-00

Spot Description: _____

NE - NE - SW - NW Sec. 20 Twp. 32 S. R. 38 East West

_____ 1390 Feet from North / South Line of Section

_____ 1250 Feet from East / West Line of Section

Footages Calculated from Nearest Outside Section Corner:

NE NW SE SW

County Stevens

Lease Name Swan B Well # 1H

Field Name Hugoton

Producing Formation Chase

Elevation: Ground 3200 Kelley Bushing _____

Total Depth 2988 Plug Back Total Depth _____

Amount of Surface Pipe Set and Cemented at _____ 630 Feet

Multiple Stage Cementing Collar Used? Yes No

If yes, show depth set _____ Feet

If Alternate II completion, cement circulated from _____

feet depth to _____ w/ _____ sx cmt.

Drilling Fluid Management Plan

(Data must be collected from the Reserve Pit)

Chloride content 4680 ppm Fluid volume 90 bbls

Dewatering method used HAUL OFF

Location of fluid disposal if hauled offsite: _____

Operator Name ANADARKO PETROLEUM CORPORATION

Lease Name KEEFER A 1 License No. 4549

Quarter SW Sec. 13 Twp. 32 S. R. 38 East West

County STEVENS Docket No. D17157

INSTRUCTIONS: An original and two copies of this form shall be filed with the Kansas Corporation Commission, 130 S. Market - Room 2078, Wichita, Kansas 67202, within 120 days of the spud date, recompletion, workover or conversion of a well. Rule 82-3-130, 82-3-106 and 82-3-107 apply. Information on side two of this form will be held confidential for a period of 12 months if requested in writing and submitted with the form (see rule 82-3-107 for confidentiality in excess of 12 months). One copy of all wireline logs and geologist reports shall be attached with this form. ALL CEMENTING TICKETS MUST BE ATTACHED. Submit CP-4 form with all plugged wells. Submit CP-111 form with all temporarily abandoned wells.

All requirements of the statutes, rules and regulations promulgated by the oil and gas industry have been fully complied with and the statements herein are complete and correct to the best of my knowledge.

Signature Melanie Wiggins

Title REGULATORY ANALYST Date 09/02/2010

Subscribed and sworn to before me this 2ND day of September

20 10

Notary Public Cynthia Rodriguez

Date Commission Expires Nov 9, 2010

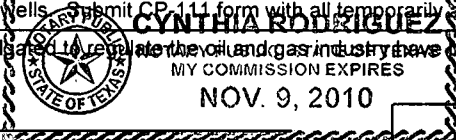

KCC Office Use ONLY

Letter of Confidentiality Attached

If Denied, Yes Date: _____

Wireline Log Received

Geologist Report Received

UIC Distribution

Alt 1-Dlg - 9/3/10

Operator Name ANADARKO PETROLEUM CORPORATION

Lease Name Swan B

Well # 1H

Sec. 20 Twp. 32 S.R. 38 East West

County Stevens

INSTRUCTIONS: Show important tops and base of formations penetrated. Detail all cores. Report all drill stem tests giving interval tested, time tool open and closed, flowing and shut-in pressures, whether shut-in pressure reached static level, hydrostatic pressures, bottom hole temperature, fluid recovery, and flow rates if gas to surface during test, along with final chart(s). Attach extra sheet if more space is needed. Attach copy of all Electric Wireline Logs surveyed. Attach final geological well site report.

Drill Stem Tests Taken <i>(Attach Additional Sheets)</i> <input type="checkbox"/> Yes <input checked="" type="checkbox"/> No Samples Sent to Geological Survey <input checked="" type="checkbox"/> Yes <input type="checkbox"/> No Cores Taken <input type="checkbox"/> Yes <input checked="" type="checkbox"/> No Electric Log Run <i>(Submit Copy)</i> <input checked="" type="checkbox"/> Yes <input type="checkbox"/> No List All E.Logs Run: CEMENT BOND LOG NEUTRON LOG	<input checked="" type="checkbox"/> Log Formation (Top), Depth and Datums <input type="checkbox"/> Sample <table style="width:100%; border-collapse: collapse;"> <tr> <td style="width:60%;">Name</td> <td style="width:20%;">Top</td> <td style="width:20%;">Datum</td> </tr> <tr> <td>Base Cedar Hills</td> <td>1413</td> <td></td> </tr> <tr> <td>Base Stone Corral</td> <td>1744</td> <td></td> </tr> <tr> <td>Chase</td> <td>2487</td> <td></td> </tr> <tr> <td>Council Grove</td> <td>2795</td> <td></td> </tr> </table>	Name	Top	Datum	Base Cedar Hills	1413		Base Stone Corral	1744		Chase	2487		Council Grove	2795	
Name	Top	Datum														
Base Cedar Hills	1413															
Base Stone Corral	1744															
Chase	2487															
Council Grove	2795															

CASING RECORD <input checked="" type="checkbox"/> New <input type="checkbox"/> Used							
Report all strings set-conductor, surface, intermediate, production, etc.							
Purpose of String	Size Hole Drilled	Size Casing Set (In O.D.)	Weight Lbs./Ft.	Setting Depth	Type of Cement	# Sacks Used	Type and Percent Additives
<u>SURFACE</u>	12.25	8 5/8	24	630	STANDARD	450	2% 2% CC
<u>PRODUCTION</u>	7.875	5 1/2	14	2988	MIDCON50/50	480	.5 HALAD
					TOC=190		

ADDITIONAL CEMENTING/SQUEEZE RECORD				
Purpose	Depth Top Bottom	Type of Cement	#Sacks Used	Type and Percent Additives
<input type="checkbox"/> Perforate				
<input type="checkbox"/> Protect Casing				
<input type="checkbox"/> Plug Back TD				
<input type="checkbox"/> Plug Off Zone				

Shots Per Foot	PERFORATION RECORD - Bridge Plugs Set/Type Specify Footage of Each Interval Perforated	Acid, Fracture, Shot, Cement Squeeze Record <i>(Amount and Kind of Material Used)</i>	Depth
2	2685-2700; 2629-2645; 2587-2593; 2516-2522	Frac w/124,910 gal 30&25# x-linked patriot.5% KCL w/295,000# 12/20snc	2516-2700

TUBING RECORD	Size	Set At	Packer At	Liner Run
	2 3/8	2714	-	<input type="checkbox"/> Yes <input checked="" type="checkbox"/> No

Date of First, Resumed Production, SWD or Enhr.	Producing Method
5-22-10	<input type="checkbox"/> Flowing <input checked="" type="checkbox"/> Pumping <input type="checkbox"/> Gas Lift <input type="checkbox"/> Other (Explain)

Estimated Production Per 24 Hours	Oil Bbls.	Gas Mcf	Water Bbls.	Gas-Oil Ratio	Gravity
	0	403	0		

DISPOSITION OF GAS: <input type="checkbox"/> Vented <input checked="" type="checkbox"/> Sold <input type="checkbox"/> Used on Lease <i>(If vented, submit ACO-18.)</i>	METHOD OF COMPLETION <input type="checkbox"/> Open Hole <input checked="" type="checkbox"/> Perf. <input type="checkbox"/> Dually Comp. <input type="checkbox"/> Commingled <input type="checkbox"/> Other (Specify) _____	Production Interval 2516-2700
---	---	---

PLAT AND CERTIFICATION OF ACREAGE ATTRIBUTABLE TO A GAS WELL

Kansas Corporation Commission, Conservation Division

Finney State Office Building, 130 South Market, Room 2078 Wichita, Kansas 67202

API NUMBER 15- _____
 OPERATOR: Anadarko Petroleum Corporation
 LEASE: Swan B
 WELL NUMBER: 1H
 FIELD: Hugoton
 NUMBER OF ACRES ATTRIBUTABLE TO WELL: 640
 QTR/QTR/QTR: NE - SW - NW

(Show the location for the well and shade attributable acreage for prorated or spaced wells). (Show the footage to the nearest lease or unit boundary line; and show footage to the nearest common source supply well).

LOCATION OF WELL: COUNTY: Stevens
1390 feet from South X North line of section
1250 feet from East X West line of section

SECTION 20 TWP 32(S) RNG 38W
 IS SECTION X REGULAR or IRREGULAR
 IF SECTION IS IRREGULAR, LOCATE WELL FROM
 NEAREST CORNER BOUNDARY (check line below)
 Section corner used: NE X NW SE SW

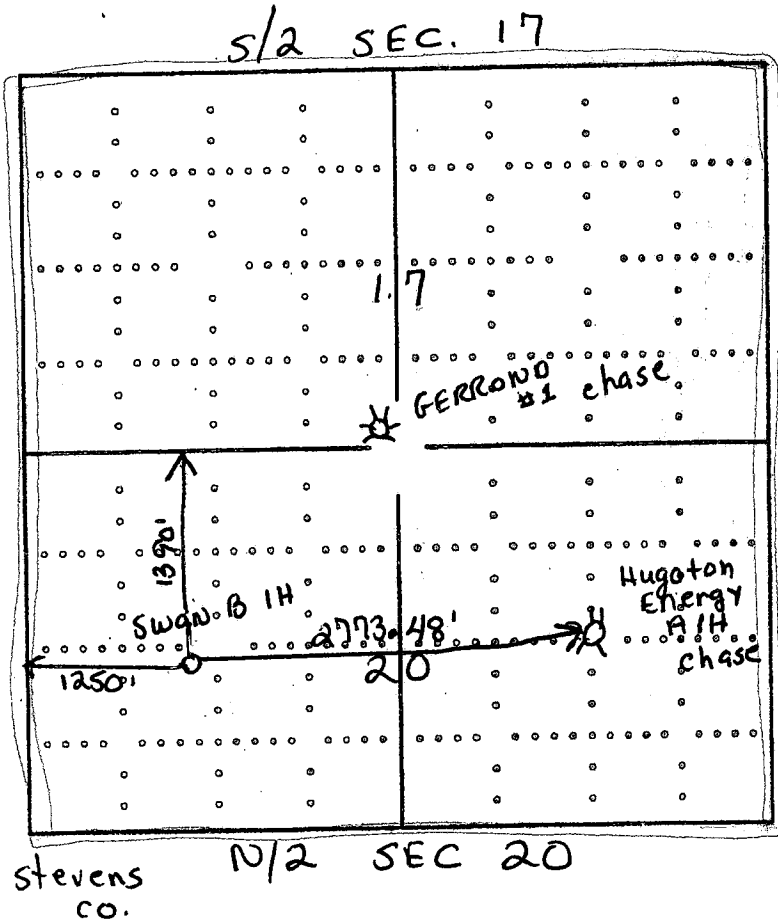

RECEIVED
 SEP 03 2010
 KCC WICHITA

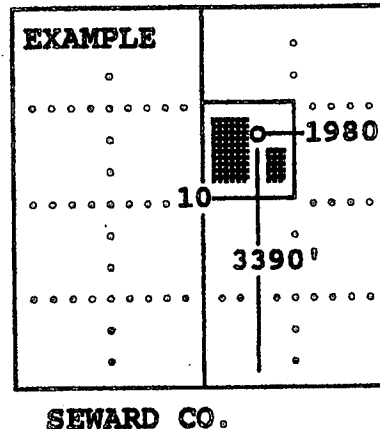

The undersigned hereby certifies as Staff Regulatory Analyst (title) for Anadarko Petroleum Corporation (Co.), a duly authorized agent, that all information shown hereon is true and correct to the best of my knowledge and belief, that all acreage claimed attributable to the well named herein is held by production from that well and hereby make application for an allowable to be assigned to the well upon the filing of this form and the State test, whichever is later.

Signature Diana Smart

Subscribed and sworn before me this 23rd day of December, 2009

Bertha Neff
 Notary Public

My Commission expires 12-27-09

FORM CG-8 (12/94)

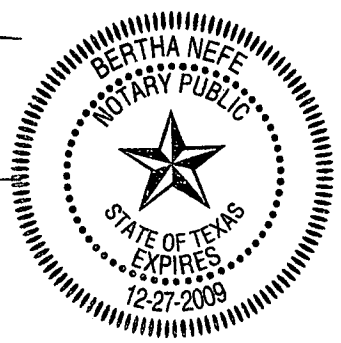

The Road to Excellence Starts with Safety

Sold To #: 300466	Ship To #: 2782203	Quote #:	Sales Order #: 7344280
Customer: ANADARKO PETROLEUM CORP - EBUS		Customer Rep:	
Well Name: SWAN	Well #: B # 1H	API/UWI #:	
Field:	City (SAP): HUGOTON	County/Parish: Stevens	State: Kansas
Contractor: TRINIDAD	Rig/Platform Name/Num: 208		
Job Purpose: Cement Surface Casing			
Well Type: Development Well		Job Type: Cement Surface Casing	
Sales Person:		Srvc Supervisor: SMITH, BOBBY	MBU ID Emp #: 106036

Job Personnel

HES Emp Name	Exp Hrs	Emp #	HES Emp Name	Exp Hrs	Emp #	HES Emp Name	Exp Hrs	Emp #
ARNETT, JAMES Ray	11	226567	HAYES, CRAIG H	11	449385	SLATER, JOE P	11	106095
SMITH, BOBBY Wayne	11	106036						

Equipment

HES Unit #	Distance-1 way	HES Unit #	Distance-1 way	HES Unit #	Distance-1 way	HES Unit #	Distance-1 way
10240245	25 mile	10243558	25 mile	10244148	25 mile	10286731	25 mile
10714253C	25 mile	10994449	25 mile	11133699	25 mile		

Job Hours

Date	On Location Hours	Operating Hours	Date	On Location Hours	Operating Hours	Date	On Location Hours	Operating Hours

TOTAL Total is the sum of each column separately

Job

Job Times

Formation Name	Date	Time	Time Zone	
Formation Depth (MD) Top	Called Out	01 - May - 2010	13:00	CST
Formation Depth (MD) Bottom	On Location	01 - May - 2010	15:00	CST
Form Type	Job Started	01 - May - 2010	20:08	CST
Job depth MD <i>630-875 ft</i>	Job Completed	01 - May - 2010	20:47	CST
Water Depth	Departed Loc	01 - May - 2010	23:00	CST
Perforation Depth (MD) From				
Perforation Depth (MD) To				

Well Data

Description	New / Used	Max pressure psig	Size in	ID in	Weight lbm/ft	Thread	Grade	Top MD ft	Bottom MD ft	Top TVD ft	Bottom TVD ft
Surface Hole				12.25					680.650		
8 5/8 Surface Casing	Unknown		8.625	8.097	24				875 630		

Sales/Rental/3rd Party (HES)

Description	Qty	Qty uom	Depth	Supplier
SHOE, GID, 8-5/8 8RD	1	EA		
VLVASSY, INSR FLOAT, 8-5/8 8RD, 24 lbs/ft	1	EA		
FILLUP ASSY - 1.500 ID - 7 IN. - 8-5/8	1	EA		
CENTRALIZER ASSY - API - 8-5/8 CSG X	3	EA		
BASKET - CEMENT - 8 5/8 CSG X 12 1/4	1	EA		
PLUG, CMTG, TOP, 8 5/8, HW, 7.20 MIN/8.09 MA	1	EA		

Tools and Accessories

Type	Size	Qty	Make	Depth	Type	Size	Qty	Make	Depth	Type	Size	Qty	Make
Guide Shoe					Packer					Top Plug			
Float Shoe					Bridge Plug					Bottom Plug			
Float Collar					Retainer					SSR plug set			
Insert Float										Plug Container			
Stage Tool										Centralizers			

Miscellaneous Materials

Gelling Agt	Conc	Surfactant	Conc	Acid Type	Qty	Conc	%
Treatment Fld	Conc	Inhibitor	Conc	Sand Type	Size	Qty	

HALLIBURTON

Cementing Job Summary

Fluid Data										
Stage/Plug #: 1										
Fluid #	Stage Type	Fluid Name	Qty	Qty uom	Mixing Density lbm/gal	Yield ft ³ /sk	Mix Fluid Gal/sk	Rate bbl/min	Total Mix Fluid Gal/sk	
1	Water Pre-Flush			bbl	8.33	.0	.0	5.0		
2	Halliburton Light Standard	HALLIBURTON LIGHT STANDARD - SBM (12313)	230.0	sacks	12.4	2.09	11.42	5.0	11.42	
	2 %	CALCIUM CHLORIDE - HI TEST PELLETT (100005053)								
	0.5 lbm	POLY-E-FLAKE (101216940)								
	11.423 Gal	FRESH WATER								
3	Standard Cement	CMT - STANDARD CEMENT (100003684)	220.0	sacks	15.6	1.2	5.24	5.0	5.24	
	94 lbm	CMT - STANDARD - CLASS A REG OR TYPE I, BULK (100003684)								
	2 %	CALCIUM CHLORIDE - HI TEST PELLETT (100005053)								
	0.25 lbm	POLY-E-FLAKE (101216940)								
	5.238 Gal	FRESH WATER								
4	Displacement		43.00	bbl	8.33	.0	.0	5.0		
Calculated Values			Pressures			Volumes				
Displacement		Shut In: Instant		Lost Returns		Cement Slurry		Pad		
Top Of Cement		5 Min		Cement Returns 30		Actual Displacement		Treatment		
Frac Gradient		15 Min		Spacers		Load and Breakdown		Total Job		
Rates										
Circulating			Mixing			Displacement			Avg. Job	
Cement Left In Pipe		Amount	0 ft	Reason	Shoe Joint					
Frac Ring # 1 @	ID	Frac ring # 2 @	ID	Frac Ring # 3 @	ID	Frac Ring # 4 @	ID			
The Information Stated Herein Is Correct				Customer Representative Signature						

RECEIVED

SEP 03 2010

KCC WICHITA

HALLIBURTONRECEIVED
SEP 03 2010

KCC WICHITA

Cementing Job Log*The Road to Excellence Starts with Safety*

Sold To #: 300466	Ship To #: 2782203	Quote #:	Sales Order #: 7344280
Customer: ANADARKO PETROLEUM CORP - EBUS		Customer Rep:	
Well Name: SWAN	Well #: B # 1H	API/UWI #:	
Field:	City (SAP): HUGOTON	County/Parish: Stevens	State: Kansas
Legal Description:			
Lat:		Long:	
Contractor: TRINIDAD		Rig/Platform Name/Num: 208	
Job Purpose: Cement Surface Casing			Ticket Amount:
Well Type: Development Well		Job Type: Cement Surface Casing	
Sales Person:		Srvc Supervisor: SMITH, BOBBY	MBU ID Emp #: 106036

Activity Description	Date/Time	Cht #	Rate bbl/min	Volume bbl		Pressure psig		Comments
				Stage	Total	Tubing	Casing	
Call Out	05/01/2010 13:00							
Depart Location Safety Meeting	05/01/2010 14:00							
Arrive At Loc	05/01/2010 15:00							
Assessment Of Location Safety Meeting	05/01/2010 15:00							Rig is drilling
Pre-Rig Up Safety Meeting	05/01/2010 15:05							
Rig-Up Completed	05/01/2010 16:00							
Other	05/01/2010 17:30							drill pipe out of the hole
Other	05/01/2010 18:00							casing going in the hole
Other	05/01/2010 19:30							casing on bottom. rig circulating.
Safety Meeting - Pre Job	05/01/2010 20:00							
Start Job	05/01/2010 20:08							
Test Lines	05/01/2010 20:09						3500.0	
Pump Lead Cement	05/01/2010 20:12			85.6			100.0	230 sx = 517.5 ft3 = top of cement surface
Other	05/01/2010 20:13							mud returns
Pump Tail Cement	05/01/2010 20:25			47.01			100.0	220 sx = 264 ft3. top of cement 603.18 ft
Drop Top Plug	05/01/2010 20:36							
Pump Displacement	05/01/2010 20:37			0			100.0	water
Bump Plug	05/01/2010 20:46			37.39		250.0	1250.0	30 BBLS OF CEMENT TO SURFACE

Sold To #: 300466

Ship To #: 2782203

Quote #:

Sales Order #:

7344280

SUMMIT Version: 7.20.130

Saturday, May 01, 2010 09:23:00

HALLIBURTONRECEIVED
SEP 03 2010
KCC WICHITA*Cementing Job Log*

Activity Description	Date/Time	Cht #	Rate bbl/ min	Volume bbl		Pressure psig		Comments
				Stage	Total	Tubing	Casing	
Release Casing Pressure	05/01/2010 20:47							float held
End Job	05/01/2010 20:47							
Safety Meeting - Pre Rig-Down	05/01/2010 20:55							
Rig-Down Completed	05/01/2010 22:45							
Safety Meeting - Departing Location	05/01/2010 22:55							
Depart Location for Service Center or Other Site	05/01/2010 23:00							Thank you for calling Halliburton. Bob and crew.

Sold To # : 300466

Ship To # : 2782203

Quote # :

Sales Order # :

7344280

SUMMIT Version: 7.20.130

Saturday, May 01, 2010 09:23:00

RECEIVED

HALLIBURTON

SEP 03 2010

Cementing Job Summary

The Road to Excellence Starts with Safety

Sold To #: 300466	Ship To #: 2782203	Quote #:	Sales Order #: 7346696
Customer: ANADARKO PETROLEUM CORP - EBUS		Customer Rep: Almanza, Abraham	
Well Name: Swan	Well #: B #1H	API/UWI #:	
Field:	City (SAP): HUGOTON	County/Parish: Stevens	State: Kansas
Contractor: TRINIDAD		Rig/Platform Name/Num: TRINIDAD #208	
Job Purpose: Cement Production Casing			
Well Type: Development Well		Job Type: Cement Production Casing	
Sales Person: HESTON, MYRON		Srvc Supervisor: SMITH, BOBBY	MBU ID Emp #: 106036

Job Personnel

HES Emp Name	Exp Hrs	Emp #	HES Emp Name	Exp Hrs	Emp #	HES Emp Name	Exp Hrs	Emp #
ARNETT, JAMES Ray	10	226567	HAYES, CRAIG H	10	449385	PORTILLO, CESAR S	10	457847
SMITH, BOBBY Wayne	10	106036						

Equipment

HES Unit #	Distance-1 way	HES Unit #	Distance-1 way	HES Unit #	Distance-1 way	HES Unit #	Distance-1 way
10240245	50 mile	10243558	50 mile	10244148	50 mile	10286731	50 mile
10714253C	50 mile	10994449	50 mile	11133699	50 mile		

Job Hours

Date	On Location Hours	Operating Hours	Date	On Location Hours	Operating Hours	Date	On Location Hours	Operating Hours

TOTAL Total is the sum of each column separately

Job

Job Times

Formation Name	Formation Depth (MD) Top	Bottom	Called Out	Date	Time	Time Zone	
			On Location	03 - May - 2010	07:00	CST	
Form Type		BHST	On Location	03 - May - 2010	09:00	CST	
Job depth MD	3750. ft	Job Depth TVD	3750. ft	Job Started	03 - May - 2010	15:22	CST
Water Depth		Wk Ht Above Floor	3. ft	Job Completed	03 - May - 2010	16:40	CST
Perforation Depth (MD) From		To	Deparred Loc	03 - May - 2010	19:00	CST	

Well Data

Description	New / Used	Max pressure psig	Size in	ID in	Weight lbm/ft	Thread	Grade	Top MD ft	Bottom MD ft	Top TVD ft	Bottom TVD ft
Production Hole				7.875				630 875	3750.2988		
5 1/2 Production	Unknown		5.5	5.012	14.				3750.2988		
Surface Casing	Unknown		8.625	8.097	24.			630			

Sales/Rental/3rd Party (HES)

Description	Qty	Qty uom	Depth	Supplier
SHOE,GID,5-1/2 8RD	1	EA		
PLUG ASSY,LTH-DWN,5 1/2 13-23#,F/ 2.875	1	EA		
BAFFLE ASSY - 5-1/2 8RD - LATCH-DOWN	1	EA		
CENTRALIZER ASSY - TURBO - API -	14	EA		
KIT,HALL WELD-A	1	EA		

Tools and Accessories

Type	Size	Qty	Make	Depth	Type	Size	Qty	Make	Depth	Type	Size	Qty	Make
Guide Shoe					Packer					Top Plug			
Float Shoe					Bridge Plug					Bottom Plug			
Float Collar					Retainer					SSR plug set			
Insert Float										Plug Container			
Stage Tool										Centralizers			

RECEIVED

SEP 03 2010

HALLIBURTON

Cementing Job Summary

KCC WICHITA

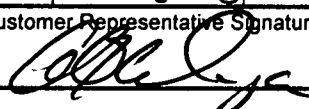
Miscellaneous Materials										
Gelling Agt	Conc	Surfactant	Conc	Acid Type	Qty	Conc	%			
Treatment Fld	Conc	Inhibitor	Conc	Sand Type	Size	Qty				
Fluid Data										
Stage/Plug #: 1										
Fluid #	Stage Type	Fluid Name	Qty	Qty uom	Mixing Density lbm/gal	Yield ft ³ /sk	Mix Fluid Gal/sk	Rate bbl/min	Total Mix Fluid Gal/sk	
1	Water Pre-Flush			bbl	8.33	.0	.0	6.0		
2	MID-CON 2 STANDARD	MIDCON-2 CEMENT STANDARD - SBM (15078)	200.0	sacks	11.4	2.89	17.84	6.0	17.84	
	0.25 lbm	POLY-E-FLAKE (101216940)								
	17.838 Gal	FRESH WATER								
3	50/50 POZ STANDARD	POZ STANDARD 50/50 - SBM (12308)	280.0	sacks	13.3	1.63	7.25	6.0	7.25	
	10 lbm	KOL-SEAL, BULK (100064233)								
	0.5 %	HALAD(R)-322, 50 LB (100003646)								
	0.25 lbm	POLY-E-FLAKE (101216940)								
	7.25 Gal	FRESH WATER								
4	2% KCL Water w/ Biocide Displacement		72.00	bbl	8.33	.0	.0	6.0		
	2.5 gal/Mgal	CLAYFIX 3, TOTETANK (101583425)								
	0.021 gal/bbl	BE-7, TOTE TANK (101649552)								
	42 gal/bbl	WATER - FRESH - GAL (24047)								
Calculated Values			Pressures			Volumes				
Displacement		Shut In: Instant		Lost Returns		Cement Slurry		Pad		
Top Of Cement		5 Min		Cement Returns	60	Actual Displacement		Treatment		
Frac Gradient		15 Min		Spacers		Load and Breakdown		Total Job		
Rates										
Circulating		Mixing		Displacement		Avg. Job				
Cement Left In Pipe	Amount	0 ft	Reason	Shoe Joint						
Frac Ring # 1 @	ID	Frac ring # 2 @	ID	Frac Ring # 3 @	ID	Frac Ring # 4 @	ID			
The Information Stated Herein Is Correct				Customer Representative Signature						
										

HALLIBURTON

RECEIVED

SEP 03 2010

Cementing Job Log**KCC WICHITA***The Road to Excellence Starts with Safety*

Sold To #: 300466	Ship To #: 2782203	Quote #:	Sales Order #: 7346696
Customer: ANADARKO PETROLEUM CORP - EBUS		Customer Rep: Almanza, Abraham	
Well Name: Swan	Well #: B #1H	API/UWI #:	
Field:	City (SAP): HUGOTON	County/Parish: Stevens	State: Kansas
Legal Description:			
Lat:		Long:	
Contractor: TRINIDAD		Rig/Platform Name/Num: TRINIDAD #208	
Job Purpose: Cement Production Casing			Ticket Amount:
Well Type: Development Well		Job Type: Cement Production Casing	
Sales Person: HESTON, MYRON		Srv Supervisor: SMITH, BOBBY	MBU ID Emp #: 106036

Activity Description	Date/Time	Cht #	Rate bbl/min	Volume bbl		Pressure psig		Comments
				Stage	Total	Tubing	Casing	
Call Out	05/03/2010 07:00							
Depart Location Safety Meeting	05/03/2010 08:00							
Arrive At Loc	05/03/2010 09:00							
Assessment Of Location Safety Meeting	05/03/2010 09:00							the rig is pulling drill pipe out of the hole
Pre-Rig Up Safety Meeting	05/03/2010 09:05							
Rig-Up Completed	05/03/2010 09:30							
Other	05/03/2010 13:00							drill pipe out of the hole
Other	05/03/2010 13:30							casing going in the hole
Other	05/03/2010 14:45							casing on bottom. rig circulating.
Safety Meeting - Pre Job	05/03/2010 15:15							
Start Job	05/03/2010 15:22							
Test Lines	05/03/2010 15:24						3500.0	
Pump Lead Cement	05/03/2010 15:35			102.94			200.0	200 sx = 578 ft3 = top of cement surface
Other	05/03/2010 15:36							mud returns
Pump Tail Cement	05/03/2010 15:54			81.28			100.0	280 sx = 510.25 ft3. top of cement 698.01 ft
Drop Top Plug	05/03/2010 16:13							
Pump Displacement	05/03/2010 16:22			0			100.0	water
Bump Plug	05/03/2010 16:37			71.63		800.0	1600.0	

Sold To #: 300466

Ship To #: 2782203

Quote #:

Sales Order #: 7346696

SUMMIT Version: 7.20.130

Monday, May 03, 2010 05:19:00

HALLIBURTON

RECEIVED

SEP 03 2010

KCC WICHITA

Cementing Job Log

Activity Description	Date/Time	Cht #	Rate bbl/min	Volume bbl		Pressure psig		Comments
				Stage	Total	Tubing	Casing	
Latch Tool Downhole	05/03/2010 16:39							latch down plug held.
End Job	05/03/2010 16:40							
Safety Meeting - Pre Rig-Down	05/03/2010 16:45							
Rig-Down Completed	05/03/2010 18:40							
Safety Meeting - Departing Location	05/03/2010 18:50							
Depart Location for Service Center or Other Site	05/03/2010 19:00							Thank you for calling Halliburton. Bob and crew.

Sold To # : 300466

Ship To # : 2782203

Quote # :

Sales Order # :

7346696

SUMMIT Version: 7.20.130

Monday, May 03, 2010 05:19:00