

WELL COMPLETION FORM

WELL HISTORY - DESCRIPTION OF WELL & LEASE

KCC WICHITA ORIGINAL

OPERATOR: License # 4549

Name: ANADARKO PETROLEUM CORPORATION

Address 1: P.O. BOX 1330

Address 2: _____

City HOUSTON State TX Zip: 77251 + 1330

Contact Person: MELANIE WIGGINS

Phone (832) 636-1053

CONTRACTOR: License # 33784

Name: Trinidad Drilling LP

Wellsite Geologist: _____

Purchaser: Anadarko Energy Services Company

Designate Type of Completion

New Well Re-Entry Workover
 Oil SWD SIOW
 Gas ENHR SIGW
 CM (Coal Bed Methane) Temp. Abd.
 Dry Other _____
(Core, WSW, Expl., Cathodic, etc.)

If Workover/Reentry: Old Well Info as follows:

Operator: _____

Well Name: _____

Original Comp. Date _____ Original Total Depth _____

Deepening Re-perf. Conv.to Enhr Conv.to SWD

Plug Back Plug Back Total Depth

Commingled Docket No. _____

Dual Completion Docket No. _____

Other (SWD or Enhr?) Docket No. _____

05/04/2010 05/06/2010 05/22/2010
Spud Date or Date Reached TD Completion Date or
Recompletion Date Recompletion Date

API NO. 15- 189-22698-00-00

Spot Description: _____

NW - NW - SE - SE Sec. 18 Twp. 32 S. R. 38 East West

1250 Feet from North / South Line of Section

1250 Feet from East / West Line of Section

Footages Calculated from Nearest Outside Section Corner:

NE NW SE SW

County Stevens

Lease Name BRADSHAW B Well # 1H

Field Name Hugoton

Producing Formation Chase

Elevation: Ground 3193 Kelley Bushing -

Total Depth 2915 Plug Back Total Depth -

Amount of Surface Pipe Set and Cemented at 632 Feet

Multiple Stage Cementing Collar Used? Yes No

If yes, show depth set _____ Feet

If Alternate II completion, cement circulated from _____

feet depth to _____ w/ _____ sx cmt.

Drilling Fluid Management Plan
(Data must be collected from the Reserve Pit)

Chloride content 3800 ppm Fluid volume 70 bbls

Dewatering method used HAUL OFF

Location of fluid disposal if hauled offsite: _____

Operator Name ANADARKO PETROLEUM CORPORATION

Lease Name KEEFER A 1 License No. 4549

Quarter SW Sec. 13 Twp. 32 S. R. 38 East West

County STEVENS Docket No. D17157

INSTRUCTIONS: An original and two copies of this form shall be filed with the Kansas Corporation Commission, 130 S. Market - Room 2078, Wichita, Kansas 67202, within 120 days of the spud date, recompletion, workover or conversion of a well. Rule 82-3-130, 82-3-106 and 82-3-107 apply. Information on side two of this form will be held confidential for a period of 12 months if requested in writing and submitted with the form (see rule 82-3-107 for confidentiality in excess of 12 months). One copy of all wireline logs and geologist well report shall be attached with this form. ALL CEMENTING TICKETS MUST BE ATTACHED. Submit CP-4 form with all plugged wells. Submit CP-1 form with all temporarily abandoned wells.

All requirements of the statutes, rules and regulations promulgated to regulate the oil and gas industry have been fully complied with and the statements herein are complete and correct to the best of my knowledge.

Signature Melanie Wiggins

Title REGULATORY ANALYST

Subscribed and sworn to before me this 7 day of _____

Notary Public Daye Lynette G... 10-16-2014

Date Commission Expires 10-16-2014

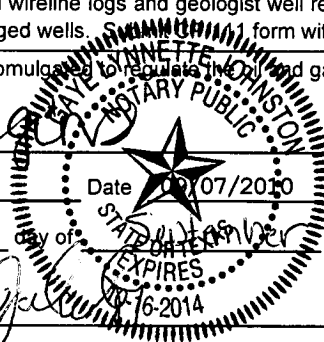

KCC Office Use ONLY
 Letter of Confidentiality Attached
If Denied, Yes Date: _____
 Wireline Log Received
 Geologist Report Received
 UIC Distribution

Operator Name ANADARKO PETROLEUM CORPORATION Lease Name BRADSHAW B Well # 1H

Sec. 18 Twp. 32 S.R. 38 East West County Stevens

INSTRUCTIONS: Show important tops and base of formations penetrated. Detail all cores. Report all drill stem tests giving interval tested, time tool open and closed, flowing and shut-in pressures, whether shut-in pressure reached static level, hydrostatic pressures, bottom hole temperature, fluid recovery, and flow rates if gas to surface during test, along with final chart(s). Attach extra sheet if more space is needed. Attach copy of all Electric Wireline Logs surveyed. Attach final geological well site report.

Drill Stem Tests Taken <i>(Attach Additional Sheets)</i>	<input type="checkbox"/> Yes <input checked="" type="checkbox"/> No	<input checked="" type="checkbox"/> Log	Formation (Top), Depth and Datums	<input type="checkbox"/> Sample
Samples Sent to Geological Survey	<input checked="" type="checkbox"/> Yes <input type="checkbox"/> No	Name	Top	Datum
Cores Taken	<input type="checkbox"/> Yes <input checked="" type="checkbox"/> No	Base Cedar Hills	1418	
Electric Log Run <i>(Submit Copy)</i>	<input checked="" type="checkbox"/> Yes <input type="checkbox"/> No	Base Stone Corral	1726	
List All E.Logs Run:		Chase	2455	
CEMENT BOND LOG		Council Grove	2763	
NEUTRON LOG				

CASING RECORD <input checked="" type="checkbox"/> New <input type="checkbox"/> Used							
Report all strings set-conductor, surface, intermediate, production, etc.							
Purpose of String	Size Hole Drilled	Size Casing Set (In O.D.)	Weight Lbs./Ft.	Setting Depth	Type of Cement	# Sacks Used	Type and Percent Additives
SURFACE	12.25	8 5/8	24	632	STANDARD	450	2% 2% CC
PRODUCTION	7.875	5 1/2	14	2914	MIDCON50/50	480	.5 HALAD
					TOC-270		

ADDITIONAL CEMENTING/SQUEEZE RECORD				
Purpose	Depth Top Bottom	Type of Cement	#Sacks Used	Type and Percent Additives
<input type="checkbox"/> Perforate				
<input type="checkbox"/> Protect Casing				
<input type="checkbox"/> Plug Back TD				
<input type="checkbox"/> Plug Off Zone				

Shots Per Foot	PERFORATION RECORD - Bridge Plugs Set/Type Specify Footage of Each Interval Perforated	Acid, Fracture, Shot, Cement Squeeze Record <i>(Amount and Kind of Material Used)</i>	Depth
2	2670-2682; 2654-2660; 2614-2620; 2600-2610	Frac w/119,166 gal 30&25# x-linked	2490-2682
	2553-2559; 2490-2496	patriot gel w/303,740# 12/20 sand	

TUBING RECORD		Size 2 3/8	Set At 2710	Packer At -	Liner Run <input type="checkbox"/> Yes <input checked="" type="checkbox"/> No
Date of First, Resumed Production, SWD or Enhr. 05-22-2010			Producing Method <input type="checkbox"/> Flowing <input checked="" type="checkbox"/> Pumping <input type="checkbox"/> Gas Lift <input type="checkbox"/> Other (Explain)		
Estimated Production Per 24 Hours	Oil Bbbs. 0	Gas Mcf 454	Water Bbbs. 0	Gas-Oil Ratio	Gravity

DISPOSITION OF GAS: <input type="checkbox"/> Vented <input checked="" type="checkbox"/> Sold <input type="checkbox"/> Used on Lease <i>(if vented, submit ACO-18.)</i>	METHOD OF COMPLETION <input type="checkbox"/> Open Hole <input checked="" type="checkbox"/> Perf. <input type="checkbox"/> Dually Comp. <input type="checkbox"/> Commingled <input type="checkbox"/> Other (Specify) _____	Production Interval 2490-2682
---	---	----------------------------------

PLAT AND CERTIFICATION OF ACREAGE ATTRIBUTABLE TO A GAS WELL

Kansas Corporation Commission, Conservation Division

Finney State Office Building, 130 South Market, Room 2078 Wichita, Kansas 67202

API NUMBER 15-
 OPERATOR: Anadarko Petroleum Corporation
 LEASE: Bradshaw B
 WELL NUMBER: 1H
 FIELD: Hugoton
 NUMBER OF ACRES ATTRIBUTABLE TO WELL: 640
 QTR/QTR/QTR: NW - SE - SE

(Show the location for the well and shade attributable acreage for prorated or spaced wells). (Show the footage to the nearest lease or unit boundary line; and show footage to the nearest common source supply well).

LOCATION OF WELL: COUNTY: Stevens
1250 feet from X South North line of section
1250 feet from X East West line of section

SECTION 18 TWP 32(S) RNG 38W
 IS SECTION X REGULAR or IRREGULAR
 IF SECTION IS IRREGULAR, LOCATE WELL FROM
 NEAREST CORNER BOUNDARY (check line below)
 Section corner used: NE NW X SE SW

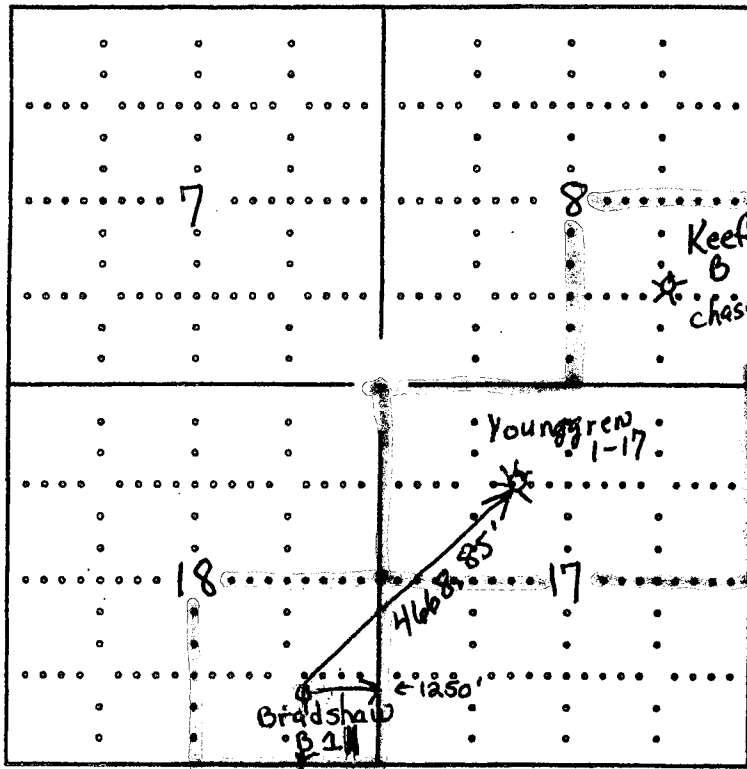

RECEIVED
 SEP 08 2010
 KCC WICHITA

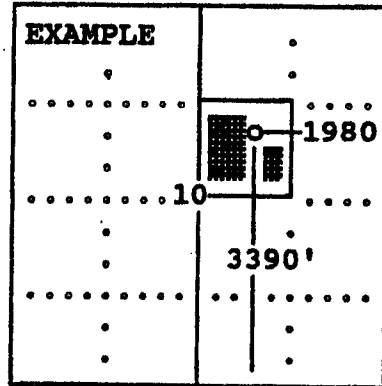

SEWARD CO.

The undersigned hereby certifies as Staff Regulatory Analyst (title) for Anadarko Petroleum Corporation (Co.), a duly authorized agent, that all information shown hereon is true and correct to the best of my knowledge and belief, that all acreage claimed attributable to the well named herein is held by production from that well and hereby make application for an allowable to be assigned to the well upon the filing of this form and the State test, whichever is later.

Signature Diana Smart

Subscribed and sworn before me this 23rd day of December, 20 09

Bertha Neff
 Notary Public

My Commission expires 12-27-09

FORM CG-8 (12/94)

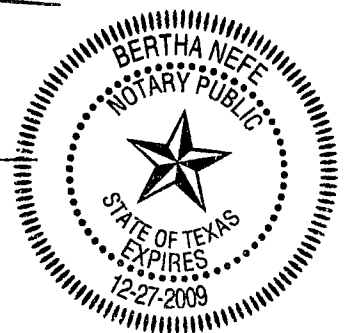

The Road to Excellence Starts with Safety

Sold To #: 300466	Ship To #: 2782568	Quote #:	Sales Order #: 7348737
Customer: ANADARKO PETROLEUM CORP - EBUS		Customer Rep:	
Well Name: Bradshaw	Well #: B1H	API/UWI #:	
Field:	City (SAP): ELKHART	County/Parish: Stevens	State: Kansas
Contractor: TRINIDAD	Rig/Platform Name/Num: 208		
Job Purpose: Cement Surface Casing			
Well Type: Development Well		Job Type: Cement Surface Casing	
Sales Person: HESTON, MYRON	Srv Supervisor: SMITH, BOBBY	MBU ID Emp #: 106036	

Job Personnel

HES Emp Name	Exp Hrs	Emp #	HES Emp Name	Exp Hrs	Emp #	HES Emp Name	Exp Hrs	Emp #
ARNETT, JAMES Ray	9	226567	HAYES, CRAIG H	9	449385	PORTILLO, CESAR S	9	457847
SMITH, BOBBY Wayne	9	106036						

Equipment

HES Unit #	Distance-1 way	HES Unit #	Distance-1 way	HES Unit #	Distance-1 way	HES Unit #	Distance-1 way
10240245	50 mile	10243558	50 mile	10244148	50 mile	10286731	50 mile
10714253C	50 mile	10994449	50 mile	11133699	50 mile		

Job Hours

Date	On Location Hours	Operating Hours	Date	On Location Hours	Operating Hours	Date	On Location Hours	Operating Hours

TOTAL Total is the sum of each column separately

Job

Job Times

Formation Name	Formation Depth (MD)	Top	Bottom	Called Out	Date	Time	Time Zone
		632			04 - May - 2010	15:30	CST
Form Type		632	BHST	On Location	04 - May - 2010	17:00	CST
Job depth MD		675 ft	Job Depth TVD	Job Started	04 - May - 2010	23:04	CST
Water Depth			Wk Ht Above Floor	Job Completed	04 - May - 2010	23:49	CST
Perforation Depth (MD)	From		To	Departed Loc	05 - May - 2010	02:00	CST

Well Data

Description	New / Used	Max pressure psig	Size in	ID in	Weight lbm/ft	Thread	Grade	Top MD ft	Bottom MD ft	Top TVD ft	Bottom TVD ft
Surface Hole				12.25					680.640		
8 5/8 Surface Casing	Unknown		8.625	8.097	24				675	632	MW

Sales/Rental/3rd Party (HES)

Description	Qty	Qty uom	Depth	Supplier
SHOE,GID,8-5/8 8RD	1	EA		RECEIVED
MLVASSY,INSR FLOAT,8-5/8 8RD, 24 lbs/ft	1	EA		
FILLUP ASSY - 1.500 ID - 7 IN. - 8-5/8	1	EA		
CENTRALIZER ASSY - API - 8-5/8 CSG X	3	EA		SEP 08 2010
BASKET - CEMENT - 8 5/8 CSG X 12 1/4	1	EA		KCC WICHITA
PLUG,CMTG, TOP, 8 5/8, HWE, 7.20 MIN/8.09 MA	1	EA		

Tools and Accessories

Type	Size	Qty	Make	Depth	Type	Size	Qty	Make	Depth	Type	Size	Qty	Make
Guide Shoe					Packer					Top Plug			
Float Shoe					Bridge Plug					Bottom Plug			
Float Collar					Retainer					SSR plug set			
Insert Float										Plug Container			
Stage Tool										Centralizers			

Miscellaneous Materials

Gelling Agt	Conc	Surfactant	Conc	Acid Type	Qty	Conc	%
Treatment Fld	Conc	Inhibitor	Conc	Sand Type	Size	Conc	Qty

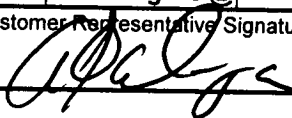
Fluid Data									
Stage/Plug #: 1									
Fluid #	Stage Type	Fluid Name	Qty	Qty uom	Mixing Density lbm/gal	Yield ft ³ /sk	Mix Fluid Gal/sk	Rate bbl/min	Total Mix Fluid Gal/sk
1	Water Pre-Flush			bbl	8.33	.0	.0	5.0	
2	Halliburton Light Standard	HALLIBURTON LIGHT STANDARD - SBM (12313)	230.0	sacks	12.4	2.09	11.42	5.0	11.42
	2 %	CALCIUM CHLORIDE - HI TEST PELLET (100005053)							
	0.5 lbm	POLY-E-FLAKE (101216940)							
	11.423 Gal	FRESH WATER							
3	Standard Cement	CMT - STANDARD CEMENT (100003684)	220.0	sacks	15.6	1.2	5.24	5.0	5.24
	94 lbm	CMT - STANDARD - CLASS A REG OR TYPE I, BULK (100003684)							
	2 %	CALCIUM CHLORIDE - HI TEST PELLET (100005053)							
	0.25 lbm	POLY-E-FLAKE (101216940)							
	5.238 Gal	FRESH WATER							
4	Displacement			bbl	8.33	.0	.0	5.0	
Calculated Values		Pressures			Volumes				
Displacement		Shut In: Instant		Lost Returns		Cement Slurry		Pad	
Top Of Cement		5 Min		Cement Returns	60	Actual Displacement		Treatment	
Frac Gradient		15 Min		Spacers		Load and Breakdown		Total Job	
Rates									
Circulating		Mixing		Displacement		Avg. Job			
Cement Left In Pipe	Amount	0 ft	Reason	Shoe Joint					
Frac Ring # 1 @	ID	Frac ring # 2 @	ID	Frac Ring # 3 @	ID	Frac Ring # 4 @	ID		
The Information Stated Herein Is Correct				Customer Representative Signature					
									

RECEIVED
SEP 08 2010
KCC WICHITA

HALLIBURTON

Cementing Job Log

The Road to Excellence Starts with Safety

Sold To #: 300466	Ship To #: 2782568	Quote #:	Sales Order #: 7348737
Customer: ANADARKO PETROLEUM CORP - EBUS		Customer Rep:	
Well Name: Bradshaw	Well #: B1H	API/UWI #:	
Field:	City (SAP): ELKHART	County/Parish: Stevens	State: Kansas
Legal Description:			
Lat:		Long:	
Contractor: TRINIDAD		Rig/Platform Name/Num: 208	
Job Purpose: Cement Surface Casing			Ticket Amount:
Well Type: Development Well		Job Type: Cement Surface Casing	
Sales Person: HESTON, MYRON		Srvc Supervisor: SMITH, BOBBY	MBU ID Emp #: 106036

Activity Description	Date/Time	Cht #	Rate bbl/min	Volume bbl		Pressure psig		Comments
				Stage	Total	Tubing	Casing	
Call Out	05/04/2010 15:30							
Depart Location Safety Meeting	05/04/2010 16:00							
Arrive At Loc	05/04/2010 17:00							
Assessment Of Location Safety Meeting	05/04/2010 17:00							Rig is drilling
Pre-Rig Up Safety Meeting	05/04/2010 17:05							
Rig-Up Completed	05/04/2010 17:30							
Other	05/04/2010 21:00							drill pipe out of the hole
Other	05/04/2010 21:15							casing going in the hole
Other	05/04/2010 22:45							casing on bottom. rig circulating.
Safety Meeting - Pre Job	05/04/2010 22:55							
Start Job	05/04/2010 23:04							
Test Lines	05/04/2010 23:05						3000.0	
Pump Lead Cement	05/04/2010 23:11		85.61				200.0	230 sx = 480.7 ft3 = top of cement surface
Other	05/04/2010 23:12							mud returns
Pump Tail Cement	05/04/2010 23:24		47.01				100.0	220 sx = 264 ft3. top of cement 604.95 ft
Drop Top Plug	05/04/2010 23:33							
Pump Displacement	05/04/2010 23:35		0				100.0	water
Bump Plug	05/04/2010 23:47		38.24			225.0	1180.0	

RECEIVED
SEP 08 2010
KCC WICHITA

Sold To #: 300466

Ship To #: 2782568

Quote #:

Sales Order #: 7348737

SUMMIT Version: 7.20.130

Wednesday, May 05, 2010 12:11:00

HALLIBURTON

Cementing Job Log

Activity Description	Date/Time	Cht #	Rate bbl/min	Volume bbl		Pressure psig		Comments
				Stage	Total	Tubing	Casing	
Release Casing Pressure	05/04/2010 23:48							float held
End Job	05/04/2010 23:49							60 bbls of cement back to surface.
Safety Meeting - Pre Rig-Down	05/04/2010 23:55							
Rig-Down Completed	05/05/2010 01:45							
Safety Meeting - Departing Location	05/05/2010 01:55							
Depart Location for Service Center or Other Site	05/05/2010 02:00							Thank you for calling Halliburton. Bob and crew.

RECEIVED
SEP 08 2010
KCC WICHITA

Sold To #: 300466

Ship To #: 2782568

Quote #:

Sales Order #:

7348737

SUMMIT Version: 7.20.130

Wednesday, May 05, 2010 12:11:00

HALLIBURTON

Cementing Job Summary

The Road to Excellence Starts with Safety

Sold To #: 300466	Ship To #: 2782568	Quote #:	Sales Order #: 7353425
Customer: ANADARKO PETROLEUM CORP - EBUS		Customer Rep: Almanza, Abraham	
Well Name: Bradshaw	Well #: B1H	API/UWI #:	
Field:	City (SAP): ELKHART	County/Parish: Stevens	State: Kansas
Contractor: TRINIDAD	Rig/Platform Name/Num: TRINIDAD #208		
Job Purpose: Cement Production Casing			
Well Type: Development Well	Job Type: Cement Production Casing		
Sales Person: HESTON, MYRON	Srvc Supervisor: SMITH, BOBBY	MBU ID Emp #: 106036	

Job Personnel								
HES Emp Name	Exp Hrs	Emp #	HES Emp Name	Exp Hrs	Emp #	HES Emp Name	Exp Hrs	Emp #
ARNETT, JAMES Ray	8	226567	PORTILLO, CESAR S	8	457847	SMITH, BOBBY Wayne	8	106036
TORRES, CLEMENTE	8	344233						

Equipment							
HES Unit #	Distance-1 way	HES Unit #	Distance-1 way	HES Unit #	Distance-1 way	HES Unit #	Distance-1 way

Job Hours								
Date	On Location Hours	Operating Hours	Date	On Location Hours	Operating Hours	Date	On Location Hours	Operating Hours
TOTAL								

Job				Job Times			
Formation Name	Formation Depth (MD) Top	Bottom	Job	Date	Time	Time Zone	
			BHST	Called Out	06 - May - 2010	14:00	CST
Form Type				On Location	06 - May - 2010	15:00	CST
Job depth MD	3750. ft		Job Depth TVD	Job Started	06 - May - 2010	21:14	CST
Water Depth	2914		Wk Ht Above Floor	Job Completed	06 - May - 2010	22:13	CST
Perforation Depth (MD) From			To	Departed Loc	07 - May - 2010	00:00	CST

Well Data											
Description	New / Used	Max pressure psig	Size in	ID in	Weight lbm/ft	Thread	Grade	Top MD ft	Bottom MD ft	Top TVD ft	Bottom TVD ft
Production Open Hole				7.875				675.	3750.		
5 1/2 Production Casing	Unknown		5.5	5.012	14.				2915		
Surface Casing	Unknown		8.625	8.097	24.				2914		

Sales/Rental/3 rd Party (HES)				
Description	Qty	Qty uom	Depth	Supplier
SHOE,GID,5-1/2 8RD	1	EA		
PLUG ASSY,LTH-DWN,5 1/2 13-23#,F/ 2.875	1	EA		
BAFFLE ASSY - 5-1/2 8RD - LATCH-DOWN	1	EA		
CENTRALIZER ASSY - TURBO - API -	14	EA		
KIT,HALL WELD-A	1	EA		

Tools and Accessories											
Type	Size	Qty	Make	Depth	Type	Size	Qty	Make	Depth	Type	Size
Guide Shoe					Packer					Top Plug	
Float Shoe					Bridge Plug					Bottom Plug	
Float Collar					Retainer					SSR plug set	
Insert Float										Plug Container	
Stage Tool										Centralizers	

RECEIVED
SEP 08 2010

KCC WICHITA

Miscellaneous Materials											
Gelling Agt	Conc	Surfactant	Conc	Acid Type	Qty	Conc	%	Treatment Fld	Conc	Inhibitor	%
	Conc		Conc	Sand Type	Size	Qty	Conc		Qty		%
Fluid Data											
Stage/Plug #: 1											
Fluid #	Stage Type	Fluid Name	Qty	Qty uom	Mixing Density lbm/gal	Yield ft ³ /sk	Mix Fluid Gal/sk	Rate bbl/min	Total Mix Fluid Gal/sk		
1	Water Pre-Flush										
2	MID-CON 2 STANDARD	MIDCON-2 CEMENT STANDARD - SBM (15078)		bbl	8.33	.0	.0	6.0			
	0.25 lbm	POLY-E-FLAKE (101216940)		sacks	11.4	2.89	17.84	6.0	17.84		
	17.838 Gal	FRESH WATER									
3	50/50 POZ STANDARD	POZ STANDARD 50/50 - SBM (12308)		sacks	13.3	1.63	7.25	6.0	7.25		
	10 lbm	KOL-SEAL, BULK (100064233)									
	0.5 %	HALAD(R)-322, 50 LB (100003646)									
	0.25 lbm	POLY-E-FLAKE (101216940)									
	7.25 Gal	FRESH WATER									
4	2% KCL Water w/ Biocide Displacement			bbl	8.33	.0	.0	6.0			
	2.5 gal/Mgal	CLAYFIX 3, TOTETANK (101583425)									
	0.021 gal/bbl	BE-7, TOTE TANK (101649552)									
	42 gal/bbl	WATER - FRESH - GAL (24047)									
Calculated Values			Pressures			Volumes					
Displacement		Shut In: Instant		Lost Returns		Cement Slurry		Pad			
Top Of Cement		5 Min		Cement Returns	34	Actual Displacement		Treatment			
Frac Gradient		15 Min		Spacers		Load and Breakdown		Total Job			
Rates											
Circulating		Mixing		Displacement		Avg. Job					
Cement Left In Pipe	Amount	0 ft	Reason	Shoe Joint							
Frac Ring # 1 @	ID	Frac ring # 2 @	ID	Frac Ring # 3 @	ID	Frac Ring # 4 @	ID				
The Information Stated Herein Is Correct				Customer Representative Signature							
				 6250-101							

RECEIVED
 SEP 08 2010
 KCC WICHITA

HALLIBURTON

Cementing Job Log

The Road to Excellence Starts with Safety

Sold To #: 300466	Ship To #: 2782568	Quote #:	Sales Order #: 7353425
Customer: ANADARKO PETROLEUM CORP - EBUS		Customer Rep: Almanza, Abraham	
Well Name: Bradshaw	Well #: B1H	API/UWI #:	
Field:	City (SAP): ELKHART	County/Parish: Stevens	State: Kansas
Legal Description:			
Lat: N 0 deg. OR N 0 deg. 0 min. 0 secs.		Long: E 0 deg. OR E 0 deg. 0 min. 0 secs.	
Contractor: TRINIDAD	Rig/Platform Name/Num: TRINIDAD #208		
Job Purpose: Cement Production Casing			Ticket Amount:
Well Type: Development Well	Job Type: Cement Production Casing		
Sales Person: HESTON, MYRON	Srv Supervisor: SMITH, BOBBY	MBU ID Emp #: 106036	

Activity Description	Date/Time	Cht #	Rate bbl/min	Volume bbl		Pressure psig		Comments
				Stage	Total	Tubing	Casing	
Call Out	05/06/2010 14:00							
Depart Location Safety Meeting	05/06/2010 14:00							
Arrive At Loc	05/06/2010 15:00							
Assessment Of Location Safety Meeting	05/06/2010 15:00							on bottom with drill pipe
Pre-Rig Up Safety Meeting	05/06/2010 15:05							
Rig-Up Completed	05/06/2010 15:30							
Other	05/06/2010 17:30							drill pipe out of the hole
Other	05/06/2010 18:00							casing going in the hole
Other	05/06/2010 20:55							casing on bottom. rig circulating.
Safety Meeting - Pre Job	05/06/2010 21:10							
Latch Tool Downhole	05/06/2010 21:12							latch down plug held.
End Job	05/06/2010 21:13							
Start Job	05/06/2010 21:14							
Safety Meeting - Pre Rig-Down	05/06/2010 21:15							
Test Lines	05/06/2010 21:16							
Pump Lead Cement	05/06/2010 21:22							200 sx = 578 ft3 = top of cement surace ft
Other	05/06/2010 21:23							mud returns
Pump Tail Cement	05/06/2010 21:34							280 sx = 456.4 ft3. top of cement 315.87 ft

RECEIVED
SEP 08 2010
KCC WICHITA

HALLIBURTON

Cementing Job Log

Activity Description	Date/Time	Cht #	Rate bbl/min	Volume bbl		Pressure psig		Comments
				Stage	Total	Tubing	Casing	
Drop Top Plug	05/06/2010 21:48							
Pump Displacement	05/06/2010 21:55							water
Bump Plug	05/06/2010 22:11							
Rig-Down Completed	05/06/2010 22:45							
Safety Meeting - Departing Location	05/06/2010 23:55							
Depart Location for Service Center or Other Site	05/07/2010 00:00							Thank you for calling Halliburton. Bob and crew.

RECEIVED
SEP 08 2010
KCC WICHITA

Sold To #: 300466

Ship To #: 2782568

Quote #:

Sales Order #:

7353425

SUMMIT Version: 7.20.130

Thursday, May 06, 2010 10:39:00