

For KCC Use: 10-16-2010
 Effective Date: 2
 District #: 2
 SGA? Yes No

KANSAS CORPORATION COMMISSION
 OIL & GAS CONSERVATION DIVISION

Form C-1
 March 2010

Form must be Typed
 Form must be Signed
 All blanks must be Filled

NOTICE OF INTENT TO DRILL

Must be approved by KCC five (5) days prior to commencing well
 Form KSONA-1, Certification of Compliance with the Kansas Surface Owner Notification Act, MUST be submitted with this form.

Expected Spud Date: October 14, 2010
 month day year

Spot Description: 100' west
 Sec. 31 Twp. 33 S. R. 8 E W
 990 feet from N / S Line of Section
 3,070 feet from E / W Line of Section
 Is SECTION: Regular Irregular?

OPERATOR: License# 33936
 Name: Charles N. Griffin
 Address 1: P.O BOX 347
 Address 2:
 City: PRATT State: ks Zip: 67124 +
 Contact Person: CHARLES N. GRIFFIN
 Phone: 720-490-5648

(Note: Locate well on the Section Plat on reverse side)
 County: HARPER
 Lease Name: DENA Well #: 2B
 Field Name: Hibbard Northeast

CONTRACTOR: License# 33549
 Name: Landmark Drilling LLC.

Is this a Prorated / Spaced Field? Yes No
 Target Formation(s): MISSISSIPPIAN

Well Drilled For: Oil Enh Rec Infield Mud Rotary
 Gas Storage Pool Ext. Air Rotary
 Disposal Wildcat Cable
 Seismic: # of Holes Other
 Other:

Nearest Lease or unit boundary line (in footage): 330'
 Ground Surface Elevation: 1301 feet MSL

If OWWO: old well information as follows:
 Operator:
 Well Name:
 Original Completion Date: Original Total Depth:

Water well within one-quarter mile: Yes No
 Public water supply well within one mile: Yes No

Depth to bottom of fresh water: 180'
 Depth to bottom of usable water: 170'

Surface Pipe by Alternate: II
 Length of Surface Pipe Planned to be set: 200+

Length of Conductor Pipe (if any):
 Projected Total Depth: 5100'
 Formation at Total Depth: arbuttle

Water Source for Drilling Operations:
 Well Farm Pond Other:

Directional, Deviated or Horizontal wellbore? Yes No

DWR Permit #:
 (Note: Apply for Permit with DWR)

If Yes, true vertical depth:

Will Cores be taken? Yes No
 If Yes, proposed zone:

Bottom Hole Location:

KCC DKT #:

AFFIDAVIT

The undersigned hereby affirms that the drilling, completion and eventual plugging of this well will comply with K.S.A. 55 et. seq.
 It is agreed that the following minimum requirements will be met:

RECEIVED
 OCT 11 2010

1. Notify the appropriate district office prior to spudding of well;
2. A copy of the approved notice of intent to drill shall be posted on each drilling rig;
3. The minimum amount of surface pipe as specified below shall be set by circulating cement to the top; in all cases surface pipe shall be set through all unconsolidated materials plus a minimum of 20 feet into the underlying formation.
4. If the well is dry hole, an agreement between the operator and the district office on plug length and placement is necessary prior to plugging;
5. The appropriate district office will be notified before well is either plugged or production casing is cemented in;
6. If an ALTERNATE II COMPLETION, production pipe shall be cemented from below any usable water to surface within 120 DAYS of spud date. Or pursuant to Appendix "B" - Eastern Kansas surface casing order #133,891-C, which applies to the KCC District 3 area, alternate II cementing must be completed within 30 days of the spud date or the well shall be plugged. In all cases, NOTIFY district office prior to any cementing.

KCC WICHITA

I hereby certify that the statements made herein are true and to the best of my knowledge and belief.

Date: 10/11/2010 Signature of Operator or Agent: _____ Title: agent

For KCC Use ONLY
 API # 15 - 077-21706-0000
 Conductor pipe required None feet
 Minimum surface pipe required 200 feet per ALT. I II
 Approved by: [Signature] 10-11-2010
 This authorization expires: 10-11-2011
 (This authorization void if drilling not started within 12 months of approval date.)
 Spud date: _____ Agent: _____

Remember to:

- File Certification of Compliance with the Kansas Surface Owner Notification Act (KSONA-1) with Intent to Drill;
- File Drill Pit Application (form CDP-1) with Intent to Drill;
- File Completion Form ACO-1 within 120 days of spud date;
- File acreage attribution plat according to field proration orders;
- Notify appropriate district office 48 hours prior to workover or re-entry;
- Submit plugging report (CP-4) after plugging is completed (within 60 days);
- Obtain written approval before disposing or injecting salt water.
- If well will not be drilled or permit has expired (See: authorized expiration date) please check the box below and return to the address below.

Well will not be drilled or Permit Expired Date: _____
 Signature of Operator or Agent: _____

Mail to: KCC - Conservation Division,
 130 S. Market - Room 2078, Wichita, Kansas 67202

31
 33
 8
 E
 W

For KCC Use ONLY

API # 15 - 077-21706-000

IN ALL CASES PLOT THE INTENDED WELL ON THE PLAT BELOW

In all cases, please fully complete this side of the form. Include items 1 through 5 at the bottom of this page.

Operator: Charles N. Griffin
Lease: DENA
Well Number: 2B
Field: Hibbord Northeast

Location of Well: County: HARPER
990 feet from N / S Line of Section
3,070 feet from E / W Line of Section
Sec. 31 Twp. 33 S. R. 8 E W

Number of Acres attributable to well:
QTR/QTR/QTR/QTR of acreage: - ne - se - sw

Is Section: [X] Regular or [] Irregular

If Section is Irregular, locate well from nearest corner boundary.

Section corner used: [] NE [] NW [] SE [] SW

PLAT

Show location of the well. Show footage to the nearest lease or unit boundary line. Show the predicted locations of lease roads, tank batteries, pipelines and electrical lines, as required by the Kansas Surface Owner Notice Act (House Bill 2032). You may attach a separate plat if desired.

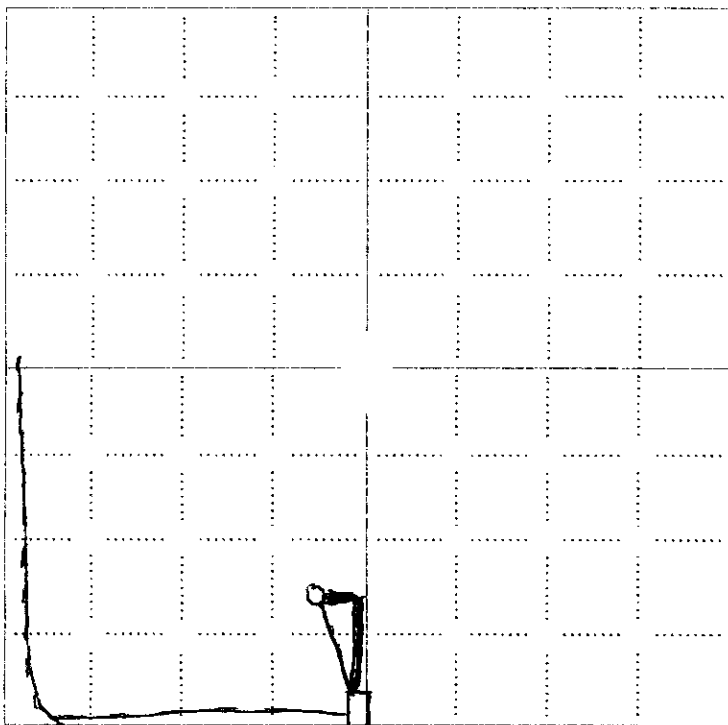

990' FSL

3070' FEL

NOTE: In all cases locate the spot of the proposed drilling location.

LEGEND

- Well Location (circle)
Tank Battery Location (rectangle)
Pipeline Location (solid line)
Electric Line Location (dashed line)
Lease Road Location (thick solid line)

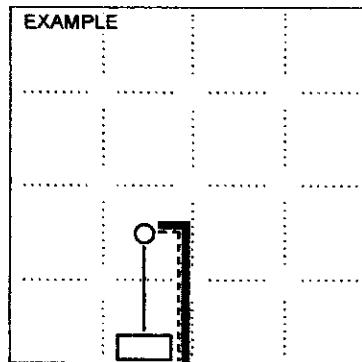

SEWARD CO. 3390' FEL

In plotting the proposed location of the well, you must show:

- 1. The manner in which you are using the depicted plat by identifying section lines, i.e. 1 section, 1 section with 8 surrounding sections, 4 sections, etc.
2. The distance of the proposed drilling location from the south / north and east / west outside section lines.
3. The distance to the nearest lease or unit boundary line (in footage).
4. If proposed location is located within a prorated or spaced field a certificate of acreage attribution plat must be attached: (CO-7 for oil wells, CG-8 for gas wells).
5. The predicted locations of lease roads, tank batteries, pipelines, and electrical lines.

RECEIVED
OCT 11 2010

KCC WICHITA

GRIFFIN MANAGEMENT, LLC
DENA LEASE
SW. 1/4, SECTION 31, T33S, R8W
HARPER COUNTY, KANSAS

15-077-21706-0000

Ingress and egress to location as shown on this plot is per usage only and may not be legally opened for public use. Contact landowner, tenant and county road department for access.

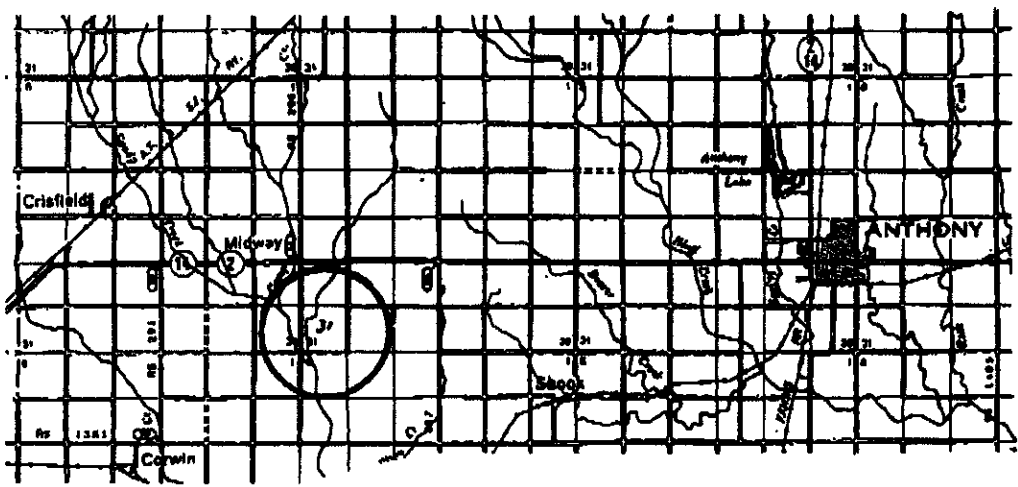
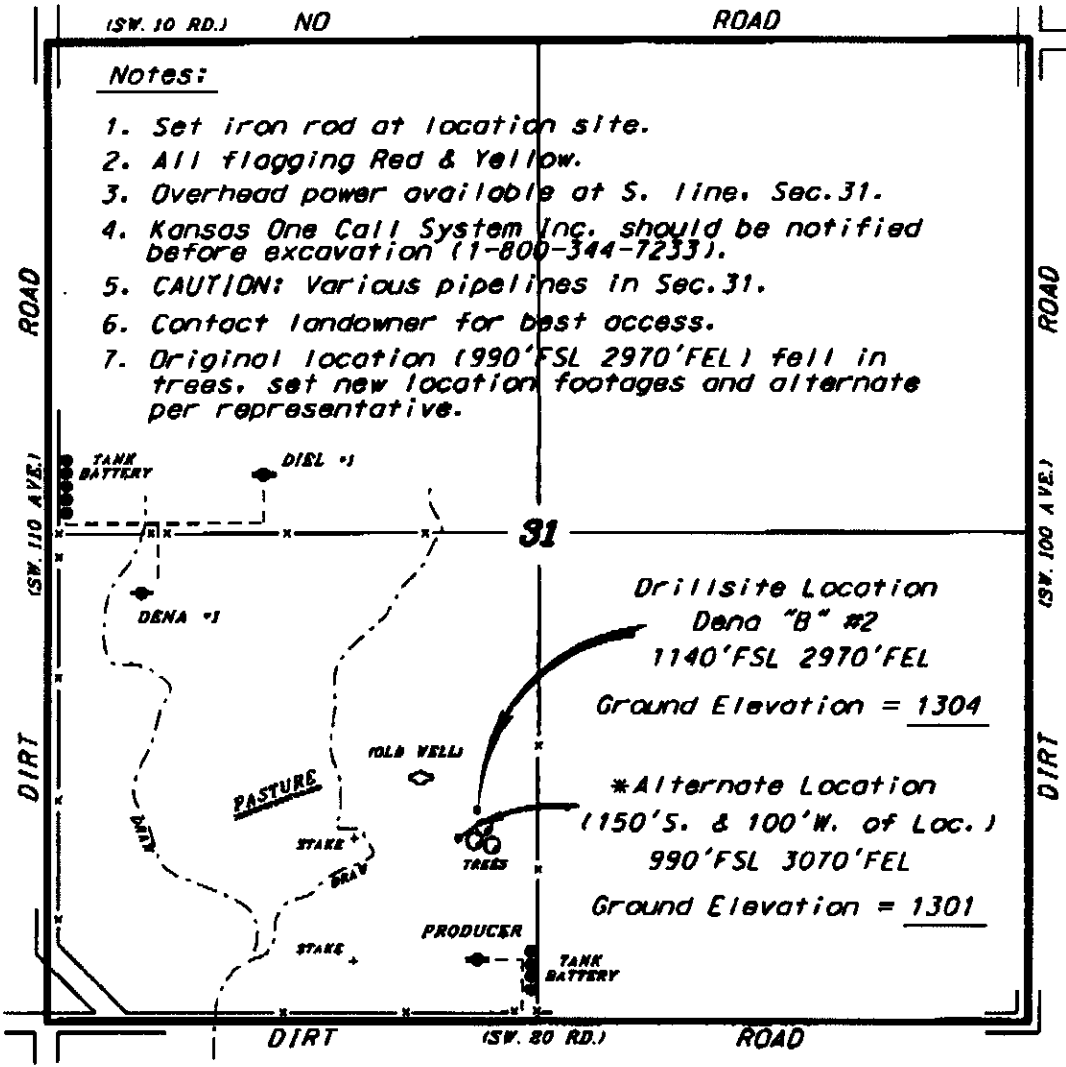

Controlling data is based upon the best maps and photographs available to us and upon a regular section of land containing 360 acres.

Approximate section lines were determined using the normal bearings of one of Griffith surveys existing in the state of Kansas. The section corners which establish the precise section lines were not necessarily located, and the exact location of the drillsite location in the section is not guaranteed. Therefore, the operator accepting this service and accepting this plot and all other parties relying thereon agree to hold Central Kansas Oilfield Services, Inc., its officers and employees harmless from all claims, suits and demands and shall defend and hold harmless from all liability from incidental or consequential damages.

Elevations derived from National Geodetic Vertical Datum.

RECEIVED
OCT 11 2010
KCC WICHITA

Date October 6, 2010

**KANSAS CORPORATION COMMISSION
OIL & GAS CONSERVATION DIVISION
APPLICATION FOR SURFACE PIT**

Form CDP-1
May 2010
Form must be Typed

Submit in Duplicate

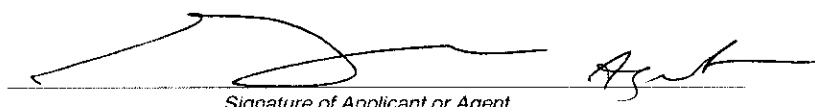
Operator Name: CHARLES GRIFFIN		License Number: 33936
Operator Address: PO BOX 347		PRATT KS 67124
Contact Person: CHARLES GRIFFIN		Phone Number: 740-490-5648
Lease Name & Well No.: DENA 2B		Pit Location (QQQQ): NE SE SW
Type of Pit: <input type="checkbox"/> Emergency Pit <input type="checkbox"/> Burn Pit <input type="checkbox"/> Settling Pit <input checked="" type="checkbox"/> Drilling Pit <input type="checkbox"/> Workover Pit <input type="checkbox"/> Haul-Off Pit <small>(If WP Supply API No. or Year Drilled)</small>	Pit is: <input type="checkbox"/> Proposed <input type="checkbox"/> Existing If Existing, date constructed: _____ Pit capacity: _____ (bbls)	Sec. 31 Twp. 33 R. 8 <input type="checkbox"/> East <input checked="" type="checkbox"/> West 990 Feet from <input type="checkbox"/> North / <input checked="" type="checkbox"/> South Line of Section 3,070 Feet from <input checked="" type="checkbox"/> East / <input type="checkbox"/> West Line of Section HARPER _____ County
Is the pit located in a Sensitive Ground Water Area? <input type="checkbox"/> Yes <input checked="" type="checkbox"/> No		Chloride concentration: _____ mg/l <small>(For Emergency Pits and Settling Pits only)</small>
Is the bottom below ground level? <input type="checkbox"/> Yes <input type="checkbox"/> No	Artificial Liner? <input type="checkbox"/> Yes <input type="checkbox"/> No	How is the pit lined if a plastic liner is not used?
Pit dimensions (all but working pits): _____ Length (feet) _____ Width (feet) Depth from ground level to deepest point: _____ (feet)		<input checked="" type="checkbox"/> N/A: Steel Pits <input type="checkbox"/> No Pit
If the pit is lined give a brief description of the liner material, thickness and installation procedure.		Describe procedures for periodic maintenance and determining liner integrity, including any special monitoring.
Distance to nearest water well within one-mile of pit: <u>N/A</u> feet Depth of water well _____ feet	Depth to shallowest fresh water _____ feet. Source of information: <input type="checkbox"/> measured <input type="checkbox"/> well owner <input type="checkbox"/> electric log <input type="checkbox"/> KDWR	
Emergency, Settling and Burn Pits ONLY: Producing Formation: _____ Number of producing wells on lease: _____ Barrels of fluid produced daily: _____ Does the slope from the tank battery allow all spilled fluids to flow into the pit? <input type="checkbox"/> Yes <input type="checkbox"/> No	Drilling, Workover and Haul-Off Pits ONLY: Type of material utilized in drilling/workover: _____ Number of working pits to be utilized: _____ Abandonment procedure: _____ Drill pits must be closed within 365 days of spud date.	
I hereby certify that the above statements are true and correct to the best of my knowledge and belief.		
<u>10/11/10</u> Date	 Signature of Applicant or Agent	

15-077-21706-00-00

KCC OFFICE USE ONLY			
Date Received: <u>10-11-10</u>	Permit Number: _____	Permit Date: <u>10-11-10</u>	Lease Inspection: <input type="checkbox"/> Yes <input checked="" type="checkbox"/> No
<input type="checkbox"/> Liner		<input checked="" type="checkbox"/> Steel Pit <input checked="" type="checkbox"/> RFAC <input type="checkbox"/> RFAS	

Mail to: KCC - Conservation Division, 130 S. Market - Room 2078, Wichita, Kansas 67202

**CERTIFICATION OF COMPLIANCE WITH THE
KANSAS SURFACE OWNER NOTIFICATION ACT**

This form must be submitted with all Forms C-1 (Notice of Intent to Drill); CB-1 (Cathodic Protection Borehole Intent); T-1 (Request for Change of Operator Transfer of Injection or Surface Pit Permit); and CP-1 (Well Plugging Application). Any such form submitted without an accompanying Form KSONA-1 will be returned.

Select the corresponding form being filed: C-1 (Intent) CB-1 (Cathodic Protection Borehole Intent) T-1 (Transfer) CP-1 (Plugging Application)

OPERATOR: License # 33936
Name: Charles N. Griffin
Address 1: P.O BOX 347
Address 2:
City: PRATT State: ks Zip: 67124 +
Contact Person: CHARLES GRIFFIN
Phone: (720) 490-5648 Fax: (620) 239-4012
Email Address:

Well Location:
ne se sw Sec. 31 Twp. 33 S. R. 8 East West
County: HARPER
Lease Name: DENA Well #: 2B

If filing a Form T-1 for multiple wells on a lease, enter the legal description of the lease below:

Surface Owner Information:

Name: Diel Farms LLC. c/o Brent Diel
Address 1: 212 Coates
Address 2:
City: kiowa State: ks Zip: 67070 +

When filing a Form T-1 involving multiple surface owners, attach an additional sheet listing all of the information to the left for each surface owner. Surface owner information can be found in the records of the register of deeds for the county, and in the real estate property tax records of the county treasurer.

If this form is being submitted with a Form C-1 (Intent) or CB-1 (Cathodic Protection Borehole Intent), you must supply the surface owners and the KCC with a plat showing the predicted locations of lease roads, tank batteries, pipelines, and electrical lines. The locations shown on the plat are preliminary non-binding estimates. The locations may be entered on the Form C-1 plat, Form CB-1 plat, or a separate plat may be submitted.

Select one of the following:

I certify that, pursuant to the Kansas Surface Owner Notice Act (House Bill 2032), I have provided the following to the surface owner(s) of the land upon which the subject well is or will be located: 1) a copy of the Form C-1, Form CB-1, Form T-1, or Form CP-1 that I am filing in connection with this form; 2) if the form being filed is a Form C-1 or Form CB-1, the plat(s) required by this form; and 3) my operator name, address, phone number, fax, and email address.

I have not provided this information to the surface owner(s). I acknowledge that, because I have not provided this information, the KCC will be required to send this information to the surface owner(s). To mitigate the additional cost of the KCC performing this task, I acknowledge that I am being charged a \$30.00 handling fee, payable to the KCC, which is enclosed with this form.

If choosing the second option, submit payment of the \$30.00 handling fee with this form. If the fee is not received with this form, the KSONA-1 form and the associated Form C-1, Form CB-1, Form T-1, or Form CP-1 will be returned.

I hereby certify that the statements made herein are true and correct to the best of my knowledge and belief.

Date: 10/11/2010 Signature of Operator or Agent: _____ Title: agent

October 11, 2010

Charles N. Griffin
PO Box 347
Pratt, KS 67124

RE: Drilling Pit Application
Dena Lease Well No. 2B
SW/4 Sec. 31-33S-08W
Harper County, Kansas

According to the drilling pit application referenced above, no earthen pits will be used at this location. Steel pits will be used. Please inform the Commission in writing as to which disposal well you utilized to dispose of the contents in the steel pits and the amount of fluid that was disposed. Please file form CDP-5 (August 2004), Exploration and Production Waste Transfer, within 30 days of fluid removal.

Should a haul-off pit be necessary please file form CDP-1 (April 2004), Application for Surface Pit, This location will have to be inspected prior to approval of the haul-off pit application.

Conservation division forms are available through our office and on the KCC web site: www.kcc.state.ks.us/conservation/forms.

A copy of this letter should be posted in the doghouse along with the approved Intent to Drill. If you have any questions or concerns please feel free to contact the District Office at (316) 630-4000.