

RECEIVED

For KCC Use: Effective Date: 10-16-2010 District #: 3 SGA? Yes No

KANSAS CORPORATION COMMISSION OIL & GAS CONSERVATION DIVISION

Form C-1 March 2010 Form must be Typed Form must be Signed All blanks must be Filled

NOTICE OF INTENT TO DRILL KCC WICHITA

Must be approved by KCC five (5) days prior to commencing well Form KSONA-1, Certification of Compliance with the Kansas Surface Owner Notification Act, MUST be submitted with this form.

Expected Spud Date: October 16, 2010 month day year

OPERATOR: License# 34349 Name: Pharyn Resources, LLC Address 1: 15621 West 87th Street, Suite 262 Address 2: City: Lenexa State: KS Zip: 66219 Contact Person: Brad Kramer Phone: (913) 669-2253

CONTRACTOR: License# 8509 Name: Evans Energy Development, Inc.

Well Drilled For: Oil Gas Enh Rec Storage Disposal Seismic: # of Holes Other: Well Class: Infield Pool Ext. Wildcat Other: Type Equipment: Mud Rotary Air Rotary Cable

If OWWO: old well information as follows: Operator: Well Name: Original Completion Date: Original Total Depth:

Directional, Deviated or Horizontal wellbore? If Yes, true vertical depth: Bottom Hole Location: KCC DKT #:

Spot Description: NE - SW - SE - SW Sec. 6 Twp. 14 S. R. 21 495 feet from 3,465 feet from

Is SECTION: Regular Irregular

County: Douglas

Lease Name: Werts Well #: 4 Field Name: Little Wakanusa

Is this a Prorated / Spaced Field? Target Formation(s): Squirrel Sandstone

Nearest Lease or unit boundary line (in footage): 165'

Ground Surface Elevation: Est 933 feet MSL

Water well within one-quarter mile: Public water supply well within one mile:

Depth to bottom of fresh water: 150'

Depth to bottom of usable water: 250'

Surface Pipe by Alternate: II

Length of Surface Pipe Planned to be set: 40'

Length of Conductor Pipe (if any): N/A

Projected Total Depth: 800'

Formation at Total Depth: Squirrel Sandstone

Water Source for Drilling Operations: Well Farm Pond Other:

DWR Permit #: (Note: Apply for Permit with DWR)

Will Cores be taken? If Yes, proposed zone:

AFFIDAVIT

The undersigned hereby affirms that the drilling, completion and eventual plugging of this well will comply with K.S.A. 55 et. seq.

It is agreed that the following minimum requirements will be met:

- 1. Notify the appropriate district office prior to spudding of well; 2. A copy of the approved notice of intent to drill shall be posted on each drilling rig; 3. The minimum amount of surface pipe as specified below shall be set by circulating cement to the top; in all cases surface pipe shall be set through all unconsolidated materials plus a minimum of 20 feet into the underlying formation. 4. If the well is dry hole, an agreement between the operator and the district office on plug length and placement is necessary prior to plugging; 5. The appropriate district office will be notified before well is either plugged or production casing is cemented in; 6. If an ALTERNATE II COMPLETION, production pipe shall be cemented from below any usable water to surface within 120 DAYS of spud date. Or pursuant to Appendix "B" - Eastern Kansas surface casing order #133,891-C, which applies to the KCC District 3 area, alternate II cementing must be completed within 30 days of the spud date or the well shall be plugged. In all cases, NOTIFY district office prior to any cementing.

I hereby certify that the statements made herein are true and to the best of my knowledge and belief.

Date: October 2, 2010 Signature of Operator or Agent: Brad Kramer Title: Director

For KCC Use ONLY API # 15 - 045-21691-00-00 Conductor pipe required None feet Minimum surface pipe required 40 feet per ALT. Approved by: Puma 10-11-2010 This authorization expires: 10-11-2011 Spud date: Agent:

Remember to:

- File Certification of Compliance with the Kansas Surface Owner Notification Act (KSONA-1) with Intent to Drill; - File Drill Pit Application (form CDP-1) with Intent to Drill; - File Completion Form ACO-1 within 120 days of spud date; - File acreage attribution plat according to field proration orders; - Notify appropriate district office 48 hours prior to workover or re-entry; - Submit plugging report (CP-4) after plugging is completed (within 60 days); - Obtain written approval before disposing or injecting salt water. - If well will not be drilled or permit has expired (See: authorized expiration date) please check the box below and return to the address below.

Well will not be drilled or Permit Expired Date: Signature of Operator or Agent:

Mall to: KCC - Conservation Division, 130 S. Market - Room 2078, Wichita, Kansas 67202

6 14 21

RECEIVED
OCT 08 2010
KCC WICHITA

Side Two

For KCC Use ONLY
API # 15 - 045-21691-0000

IN ALL CASES PLOT THE INTENDED WELL ON THE PLAT BELOW

In all cases, please fully complete this side of the form. Include items 1 through 5 at the bottom of this page.

Operator: Pharyn Resources, LLC
Lease: Werts
Well Number: 4
Field: Little Wakarusa
Number of Acres attributable to well: 2.5
QTR/QTR/QTR/QTR of acreage: NE - SW - SE - SW

Location of Well: County: Douglas
495 feet from N / S Line of Section
3,465 feet from E / W Line of Section
Sec. 6 Twp. 14 S. R. 21 E W

Is Section: Regular or Irregular

If Section is irregular, locate well from nearest corner boundary.
Section corner used: NE NW SE SW

PLAT

Show location of the well. Show footage to the nearest lease or unit boundary line. Show the predicted locations of lease roads, tank batteries, pipelines and electrical lines, as required by the Kansas Surface Owner Notice Act (House Bill 2032).
You may attach a separate plat if desired.

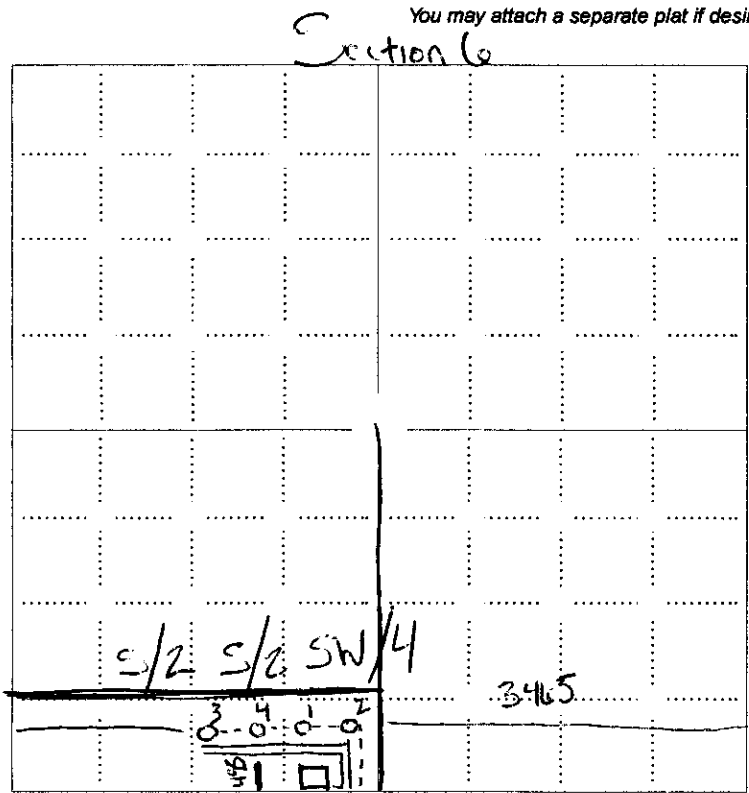

- LEGEND**
- Well Location
 - Tank Battery Location
 - Pipeline Location
 - Electric Line Location
 - Lease Road Location

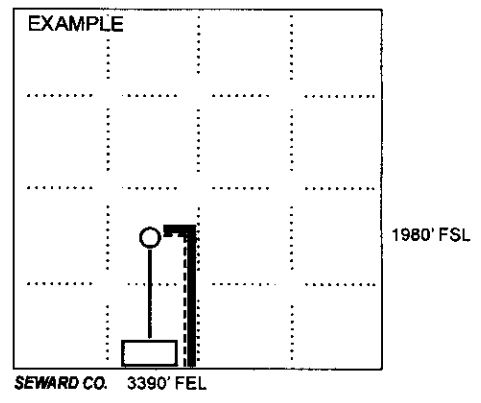

NOTE: In all cases locate the spot of the proposed drilling location.

In plotting the proposed location of the well, you must show:

1. The manner in which you are using the depicted plat by identifying section lines, i.e. 1 section, 1 section with 8 surrounding sections, 4 sections, etc.
2. The distance of the proposed drilling location from the south / north and east / west outside section lines.
3. The distance to the nearest lease or unit boundary line (in footage).
4. If proposed location is located within a prorated or spaced field a certificate of acreage attribution plat must be attached: (CO-7 for oil wells; CG-8 for gas wells).
5. The predicted locations of lease roads, tank batteries, pipelines, and electrical lines.

**KANSAS CORPORATION COMMISSION
OIL & GAS CONSERVATION DIVISION
APPLICATION FOR SURFACE PIT**

**RECEIVED
OCT 08 2010
KCC WICHITA**

Form CDP-1
May 2010
Form must be Typed

Submit in Duplicate

Operator Name: Pharyn Resources, LLC		License Number: 34349
Operator Address: 15621 West 87th Street, Suite 262		Lenexa KS 66219
Contact Person: Brad Kramer		Phone Number: (913) 669-2253
Lease Name & Well No.: Werts 4		Pit Location (QQQQ): NE SW SE SW
Type of Pit: <input type="checkbox"/> Emergency Pit <input type="checkbox"/> Burn Pit <input type="checkbox"/> Settling Pit <input checked="" type="checkbox"/> Drilling Pit <input type="checkbox"/> Workover Pit <input type="checkbox"/> Haul-Off Pit <small>(If WP Supply API No. or Year Drilled)</small>	Pit is: <input checked="" type="checkbox"/> Proposed <input type="checkbox"/> Existing If Existing, date constructed: _____ Pit capacity: 120 (bbls)	Sec. 6 Twp. 14 R. 21 <input checked="" type="checkbox"/> East <input type="checkbox"/> West 495 Feet from <input type="checkbox"/> North / <input checked="" type="checkbox"/> South Line of Section 3,465 Feet from <input checked="" type="checkbox"/> East / <input type="checkbox"/> West Line of Section Douglas County
Is the pit located in a Sensitive Ground Water Area? <input type="checkbox"/> Yes <input checked="" type="checkbox"/> No		Chloride concentration: _____ mg/l <small>(For Emergency Pits and Settling Pits only)</small>
Is the bottom below ground level? <input checked="" type="checkbox"/> Yes <input type="checkbox"/> No	Artificial Liner? <input type="checkbox"/> Yes <input checked="" type="checkbox"/> No	How is the pit lined if a plastic liner is not used? Native Mud
Pit dimensions (all but working pits): 12 Length (feet) 6 Width (feet) <input type="checkbox"/> N/A: Steel Pits Depth from ground level to deepest point: 5 (feet) <input type="checkbox"/> No Pit		
If the pit is lined give a brief description of the liner material, thickness and installation procedure.		Describe procedures for periodic maintenance and determining liner integrity, including any special monitoring.
Distance to nearest water well within one-mile of pit: 4979 feet Depth of water well 100 feet		Depth to shallowest fresh water 16 feet. Source of information: <input type="checkbox"/> measured <input type="checkbox"/> well owner <input type="checkbox"/> electric log <input checked="" type="checkbox"/> KDWR
Emergency, Settling and Burn Pits ONLY: Producing Formation: _____ Number of producing wells on lease: _____ Barrels of fluid produced daily: _____ Does the slope from the tank battery allow all spilled fluids to flow into the pit? <input type="checkbox"/> Yes <input type="checkbox"/> No		Drilling, Workover and Haul-Off Pits ONLY: Type of material utilized in drilling/workover: Drilling Mud Number of working pits to be utilized: 1 Abandonment procedure: Air dry and backfill Drill pits must be closed within 365 days of spud date.
I hereby certify that the above statements are true and correct to the best of my knowledge and belief.		
October 2, 2010 Date	 Signature of Applicant or Agent	

15-045-21691-00-00

KCC OFFICE USE ONLY			
Date Received: 10/8/10	Permit Number: _____	Permit Date: 10/8/10	Lease Inspection: <input type="checkbox"/> Yes <input checked="" type="checkbox"/> No
<input type="checkbox"/> Liner <input type="checkbox"/> Steel Pit <input type="checkbox"/> RFAC <input type="checkbox"/> RFAS			

Mail to: KCC - Conservation Division, 130 S. Market - Room 2078, Wichita, Kansas 67202

**CERTIFICATION OF COMPLIANCE WITH THE
KANSAS SURFACE OWNER NOTIFICATION ACT**

This form must be submitted with all Forms C-1 (Notice of Intent to Drill); CB-1 (Cathodic Protection Borehole Intent); T-1 (Request for Change of Operator Transfer of Injection or Surface Pit Permit); and CP-1 (Well Plugging Application). Any such form submitted without an accompanying Form KSONA-1 will be returned.

Select the corresponding form being filed: C-1 (Intent) CB-1 (Cathodic Protection Borehole Intent) T-1 (Transfer) CP-1 (Plugging Application)

OPERATOR: License # 34349
Name: Pharyn Resources, LLC
Address 1: 15621 West 87th Street, Suite 262
Address 2:
City: Lenexa State: KS Zip: 66219 +
Contact Person: Brad Kramer
Phone: (913) 669-2253 Fax: (913) 344-1521
Email Address: brad@pharynresources.com

Well Location:
NE SW SE SW Sec. 6 Twp. 14 S. R. 21 East West
County: Douglas
Lease Name: Werts Well #: 4

If filing a Form T-1 for multiple wells on a lease, enter the legal description of the lease below:

Surface Owner Information:

Name: Terry Howard Werts
Address 1: 119 East Manor Drive
Address 2:
City: Griffith State: IN Zip: 46319 +

When filing a Form T-1 involving multiple surface owners, attach an additional sheet listing all of the information to the left for each surface owner. Surface owner information can be found in the records of the register of deeds for the county, and in the real estate property tax records of the county treasurer.

If this form is being submitted with a Form C-1 (Intent) or CB-1 (Cathodic Protection Borehole Intent), you must supply the surface owners and the KCC with a plat showing the predicted locations of lease roads, tank batteries, pipelines, and electrical lines. The locations shown on the plat are preliminary non-binding estimates. The locations may be entered on the Form C-1 plat, Form CB-1 plat, or a separate plat may be submitted.

Select one of the following:

I certify that, pursuant to the Kansas Surface Owner Notice Act (House Bill 2032), I have provided the following to the surface owner(s) of the land upon which the subject well is or will be located: 1) a copy of the Form C-1, Form CB-1, Form T-1, or Form CP-1 that I am filing in connection with this form; 2) if the form being filed is a Form C-1 or Form CB-1, the plat(s) required by this form; and 3) my operator name, address, phone number, fax, and email address.

I have not provided this information to the surface owner(s). I acknowledge that, because I have not provided this information, the KCC will be required to send this information to the surface owner(s). To mitigate the additional cost of the KCC performing this task, I acknowledge that I am being charged a \$30.00 handling fee, payable to the KCC, which is enclosed with this form.

If choosing the second option, submit payment of the \$30.00 handling fee with this form. If the fee is not received with this form, the KSONA-1 form and the associated Form C-1, Form CB-1, Form T-1, or Form CP-1 will be returned.

I hereby certify that the statements made herein are true and correct to the best of my knowledge and belief.

Date: October 2, 2010 Signature of Operator or Agent: Brad Kramer Title: Director