

**\* Corrected \***  
**KANSAS CORPORATION COMMISSION**  
**OIL & GAS CONSERVATION DIVISION**

**CORRECTED**

Form C-1  
 March 2010  
 Form must be Typed  
 Form must be Signed  
 All blanks must be Filled

For KCC Use: 8-29-2010  
 Effective Date: \_\_\_\_\_  
 District #: 3  
 SGA?  Yes  No

**NOTICE OF INTENT TO DRILL**

*Must be approved by KCC five (5) days prior to commencing well*  
**Form KSONA-1, Certification of Compliance with the Kansas Surface Owner Notification Act, MUST be submitted with this form.**

Expected Spud Date: September 15, 2010  
month day year

Spot Description: \_\_\_\_\_  
 \* NW SE - SE - SW Sec. 6 Twp. 14 S. R. 21  E  W  
(0000)  
495 feet from  N /  S Line of Section  
3135 feet from  E /  W Line of Section

OPERATOR: License# 34349  
 Name: Pharyn Resources, LLC  
 Address 1: 15621 West 87th Street, Suite 262  
 Address 2: \_\_\_\_\_  
 City: Lenexa State: KS Zip: 66219 + \_\_\_\_\_  
 Contact Person: Brad Kramer  
 Phone: (813) 669-2253  
 CONTRACTOR: License# 32079  
 Name: John Lela

Is SECTION:  Regular  Irregular?  
 (Note: Locate well on the Section Plat on reverse side)

County: Douglas  
 Lease Name: Werts Well #: 1  
 Field Name: Little Wakarusa  
 Is this a Prorated / Spaced Field?  Yes  No

Well Drilled For:  Oil  Gas  Enh Rec  Storage  Disposal  Seismic; \_\_\_\_\_ # of Holes  Other: \_\_\_\_\_  
 Well Class:  Infield  Pool Ext.  Wildcat  Other: \_\_\_\_\_  
 Type Equipment:  Mud Rotary  Air Rotary  Cable

Nearest Lease or unit boundary line (in footage): 185'  
 Ground Surface Elevation: 990 est. 922 est feet MSL  
 Water well within one-quarter mile:  Yes  No  
 Public water supply well within one mile:  Yes  No  
 Depth to bottom of fresh water: 150'  
 Depth to bottom of usable water: 250'  
 Surface Pipe by Alternate:  I  II  
 Length of Surface Pipe Planned to be set: 40'  
 Length of Conductor Pipe (if any): N/A  
 Projected Total Depth: 800'  
 Formation at Total Depth: Squirrel Sandstone

If OWWO: old well information as follows:  
 Operator: \_\_\_\_\_  
 Well Name: \_\_\_\_\_  
 Original Completion Date: \_\_\_\_\_ Original Total Depth: \_\_\_\_\_

Water Source for Drilling Operations:  
 Well  Farm Pond  Other: \_\_\_\_\_  
 DWR Permit #: \_\_\_\_\_  
 (Note: Apply for Permit with DWR)   
 Will Cores be taken?  Yes  No  
 If Yes, proposed zone: \_\_\_\_\_

\*WAS: SE-SE-SE-SW 165 FSL; 2805 FEL  
 IS: NW-SE-SE-SW 495 FSL; 3135 FEL

**AFFIDAVIT**

**RECEIVED**  
**AUG 24 2010**

The undersigned hereby affirms that the drilling, completion and eventual plugging of this well will comply with K.S.A. 55 et. seq.  
 It is agreed that the following minimum requirements will be met:

1. Notify the appropriate district office *prior* to spudding of well;
2. A copy of the approved notice of intent to drill *shall be posted* on each drilling rig;
3. The minimum amount of surface pipe as specified below *shall be set* by circulating cement to the top; in all cases surface pipe *shall be set* through all unconsolidated materials plus a minimum of 20 feet into the underlying formation.
4. If the well is dry hole, an agreement between the operator and the district office on plug length and placement is necessary *prior to plugging*;
5. The appropriate district office will be notified before well is either plugged or production casing is cemented in;
6. If an ALTERNATE II COMPLETION, production pipe shall be cemented from below any usable water to surface within **120 DAYS** of spud date. Or pursuant to Appendix "B" - Eastern Kansas surface casing order #133,891-C, which applies to the KCC District 3 area, alternate II cementing must be completed within 30 days of the spud date or the well shall be plugged. *in all cases, NOTIFY district office prior to any cementing.*

**KCC WICHITA**

I hereby certify that the statements made herein are true and to the best of my knowledge and belief.

Date: August 18, 2010 Signature of Operator or Agent: [Signature] Title: Director

**For KCC Use ONLY**  
 API # 15 - 045-21672-00-00  
 Conductor pipe required None feet  
 Minimum surface pipe required 40 feet per ALT.  I  II  
 Approved by: [Signature] 8-24-2010 / [Signature] 10-26-2010  
 This authorization expires: 8-24-2011  
 (This authorization void if drilling not started within 12 months of approval date.)  
 Spud date: \_\_\_\_\_ Agent: \_\_\_\_\_

**Remember to:**

- File Certification of Compliance with the Kansas Surface Owner Notification Act (KSONA-1) with Intent to Drill;
- File Drill Pit Application (form CDP-1) with Intent to Drill;
- File Completion Form ACO-1 within 120 days of spud date;
- File acreage attribution plat according to field proration orders;
- Notify appropriate district office 48 hours prior to workover or re-entry;
- Submit plugging report (CP-4) after plugging is completed (within 60 days);
- Obtain written approval before disposing or injecting salt water.
- If well will not be drilled or permit has expired (See: authorized expiration date) please check the box below and return to the address below.

Well will not be drilled or Permit Expired Date: \_\_\_\_\_  
 Signature of Operator or Agent: \_\_\_\_\_

Mail to: KCC - Conservation Division,  
 130 S. Market - Room 2078, Wichita, Kansas 67202

**RECEIVED**

**OCT 25 2010**

**KCC WICHITA**

6  
14  
21  
 E  
 W

CORRECTED

For KCC Use ONLY

API # 15 - 045-21672-0000

IN ALL CASES PLOT THE INTENDED WELL ON THE PLAT BELOW

In all cases, please fully complete this side of the form. Include items 1 through 5 at the bottom of this page.

Operator: Pharyn Resources, LLC
Lease: Werts
Well Number: 1
Field: Little Wakarusa

Location of Well: County: Douglas
785 \* 495 feet from N / X S Line of Section
2,805 \* 3,135 feet from X E / W Line of Section
Sec. 6 Twp. 14 S. R. 21 X E W

Number of Acres attributable to well: 2.5
QTR/QTR/QTR/QTR of acreage: -0E - SE - SE - SW

\* NW

Is Section: X Regular or Irregular

If Section is Irregular, locate well from nearest corner boundary.

Section corner used: NE NW SE SW

PLAT

Show location of the well. Show footage to the nearest lease or unit boundary line. Show the predicted locations of lease roads, tank batteries, pipelines and electrical lines, as required by the Kansas Surface Owner Notice Act (House Bill 2032). You may attach a separate plat if desired.

SW/4 Section 6

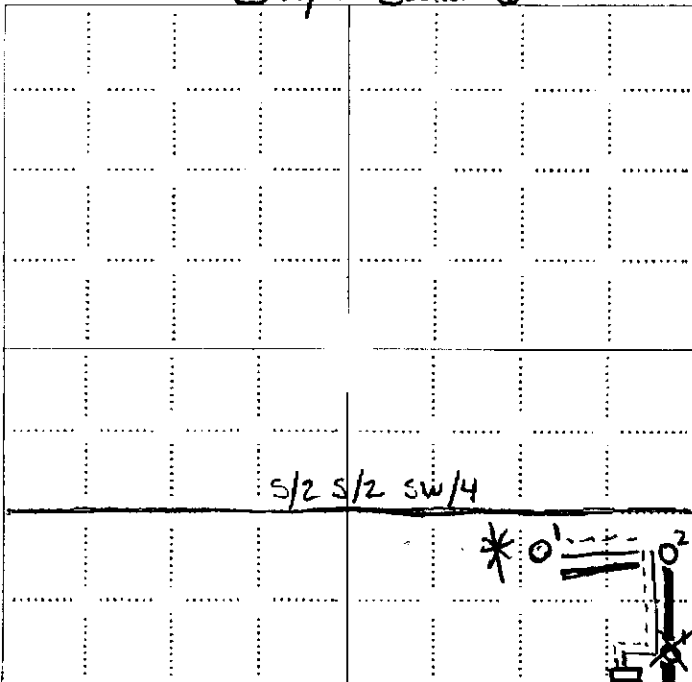

LEGEND

- Well Location (circle)
Tank Battery Location (rectangle)
Pipeline Location (solid line)
Electric Line Location (dashed line)
Lease Road Location (thick solid line)

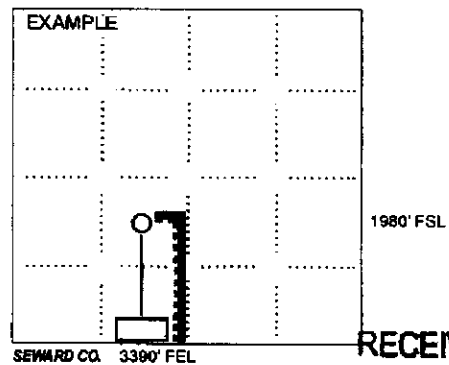

NOTE: In all cases locate the spot of the proposed drilling location.

In plotting the proposed location of the well, you must show:

- 1. The manner in which you are using the depicted plat by identifying section lines, i.e. 1 section, 1 section with 8 surrounding sections, 4 sections, etc.
2. The distance of the proposed drilling location from the south / north and east / west outside section lines.
3. The distance to the nearest lease or unit boundary line (in footage).
4. If proposed location is located within a prorated or spaced field a certificate of acreage attribution plat must be attached: (CO-7 for oil wells; CG-8 for gas wells).
5. The predicted locations of lease roads, tank batteries, pipelines, and electrical lines.

RECEIVED
AUG 24 2010

KCC WICHITA

RECEIVED
OCT 25 2010
KCC WICHITA

15-045-21672-00-00

KANSAS CORPORATION COMMISSION  
OIL & GAS CONSERVATION DIVISION

**CERTIFICATION OF COMPLIANCE WITH THE  
KANSAS SURFACE OWNER NOTIFICATION ACT**

Form KSONA-1  
July 2010  
Form Must Be Typed  
Form must be Signed  
All blanks must be Filled

**CORRECTED**

This form must be submitted with all Forms C-1 (Notice of Intent to Drill); CB-1 (Cathodic Protection Borehole Intent); T-1 (Request for Change of Operator Transfer of Injection or Surface Pit Permit); and CP-1 (Well Plugging Application). Any such form submitted without an accompanying Form KSONA-1 will be returned.

Select the corresponding form being filed:  C-1 (Intent)  CB-1 (Cathodic Protection Borehole Intent)  T-1 (Transfer)  CP-1 (Plugging Application)

OPERATOR: License # 34349  
Name: Pharyn Resources, LLC  
Address 1: 15621 West 87th Street, Suite 262  
Address 2: \_\_\_\_\_  
City: Lenexa State: KS Zip: 66219 + \_\_\_\_\_  
Contact Person: Brad Kramer  
Phone: ( 913 ) 669-2253 Fax: ( 913 ) 344-1521  
Email Address: brad@pharynresources.com

Well Location:  
X NW SE SE SE SW Sec. 6 Twp. 14 S. R. 21  East  West  
County: Douglas  
Lease Name: Werts Well #: 1

If filing a Form T-1 for multiple wells on a lease, enter the legal description of the lease below:

Surface Owner Information:  
Name: Terry Howard Werts  
Address 1: 119 East Manor Drive  
Address 2: \_\_\_\_\_  
City: Griffith State: IN Zip: 46319 + \_\_\_\_\_

When filing a Form T-1 involving multiple surface owners, attach an additional sheet listing all of the information to the left for each surface owner. Surface owner information can be found in the records of the register of deeds for the county, and in the real estate property tax records of the county treasurer.

If this form is being submitted with a Form C-1 (Intent) or CB-1 (Cathodic Protection Borehole Intent), you must supply the surface owners and the KCC with a plat showing the predicted locations of lease roads, tank batteries, pipelines, and electrical lines. The locations shown on the plat are preliminary non-binding estimates. The locations may be entered on the Form C-1 plat, Form CB-1 plat, or a separate plat may be submitted.

Select one of the following:

- I certify that, pursuant to the Kansas Surface Owner Notice Act (House Bill 2032), I have provided the following to the surface owner(s) of the land upon which the subject well is or will be located: 1) a copy of the Form C-1, Form CB-1, Form T-1, or Form CP-1 that I am filing in connection with this form; 2) if the form being filed is a Form C-1 or Form CB-1, the plat(s) required by this form; and 3) my operator name, address, phone number, fax, and email address.
- I have not provided this information to the surface owner(s). I acknowledge that, because I have not provided this information, the KCC will be required to send this information to the surface owner(s). To mitigate the additional cost of the KCC performing this task, I acknowledge that I am being charged a \$30.00 handling fee, payable to the KCC, which is enclosed with this form.

If choosing the second option, submit payment of the \$30.00 handling fee with this form. If the fee is not received with this form, the KSONA-1 form and the associated Form C-1, Form CB-1, Form T-1, or Form CP-1 will be returned.

I hereby certify that the statements made herein are true and correct to the best of my knowledge and belief.

Date: August 16, 2010 Signature of Operator or Agent: [Signature] Title: Director

RECEIVED  
OCT 25 2010  
KCC WICHITA  
RECEIVED  
AUG 24 2010  
KCC WICHITA

KANSAS CORPORATION COMMISSION  
OIL & GAS CONSERVATION DIVISION  
APPLICATION FOR SURFACE PIT

Form CDP-1  
May 2010  
Form must be Typed

**CORRECTED**

Submit in Duplicate

Operator Name: Pharyn Resources, LLC		License Number: 34349	
Operator Address: 15621 West 87th Street, Suite 262		Lenexa KS 66219	
Contact Person: Brad Kramer		Phone Number: (913) 669-2253	
Lease Name & Well No.: Werts 1		Pit Location (QQQQ): *NW SE SE SW Sec. 6 Twp 14 R. 21 <input checked="" type="checkbox"/> East <input type="checkbox"/> West -105 495* Feet from <input type="checkbox"/> North / <input checked="" type="checkbox"/> South Line of Section *3105-2805 Feet from <input checked="" type="checkbox"/> East / <input type="checkbox"/> West Line of Section Douglas County	
Type of Pit: <input type="checkbox"/> Emergency Pit <input type="checkbox"/> Burn Pit <input type="checkbox"/> Settling Pit <input checked="" type="checkbox"/> Drilling Pit <input type="checkbox"/> Workover Pit <input type="checkbox"/> Haul-Off Pit <small>(If WP Supply API No. or Year Drilled)</small>	Pit Is: <input checked="" type="checkbox"/> Proposed <input type="checkbox"/> Existing If Existing, date constructed: Pit capacity: 120 (bbbls)		
Is the pit located in a Sensitive Ground Water Area? <input type="checkbox"/> Yes <input checked="" type="checkbox"/> No		Chloride concentration: _____ mg/l <small>(For Emergency Pits and Settling Pits only)</small>	
Is the bottom below ground level? <input checked="" type="checkbox"/> Yes <input type="checkbox"/> No	Artificial Liner? <input type="checkbox"/> Yes <input checked="" type="checkbox"/> No	How is the pit lined if a plastic liner is not used? Native Mud	
Pit dimensions (all but working pits): 12 Length (feet) 6 Width (feet) Depth from ground level to deepest point: 5 (feet)		<input type="checkbox"/> N/A: Steel Pits <input type="checkbox"/> No Pit	
If the pit is lined give a brief description of the liner material, thickness and installation procedure.		Describe procedures for periodic maintenance and determining liner integrity, including any special monitoring.	
Distance to nearest water well within one-mile of pit: 3049 4813 feet Depth of water well 100 feet	Depth to shallowest fresh water 16 feet. Source of information: <input type="checkbox"/> measured <input type="checkbox"/> well owner <input type="checkbox"/> electric log <input checked="" type="checkbox"/> KDWR		
<b>Emergency, Settling and Burn Pits ONLY:</b> Producing Formation: Number of producing wells on lease: Barrels of fluid produced daily: Does the slope from the tank battery allow all spilled fluids to flow into the pit? <input type="checkbox"/> Yes <input type="checkbox"/> No	<b>Drilling, Workover and Haul-Off Pits ONLY:</b> Type of material utilized in drilling/workover: Drilling Mud Number of working pits to be utilized: 1 Abandonment procedure: Air dry and backfill Drill pits must be closed within 365 days of spud date.		
I hereby certify that the above statements are true and correct to the best of my knowledge and belief.		RECEIVED AUG 24 2010 KCC WICHITA	
August 16, 2010 Date		Signature of Applicant or Agent	
<b>KCC OFFICE USE ONLY</b>			
Date Received: 8-24-10		Permit Number: Permit Date: 8-24-10 Lease Inspection: <input type="checkbox"/> Yes <input checked="" type="checkbox"/> No	
		10-25-10	

15-045-21672-00-00

Mail to: KCC - Conservation Division, 130 S. Market - Room 207B, Wichita, Kansas 67202

RECEIVED  
OCT 25 2010  
KCC WICHITA