

WELL COMPLETION FORM

WELL HISTORY - DESCRIPTION OF WELL & LEASE

KCC WICHITA ORIGINAL

OPERATOR: License # 4549

Name: ANADARKO PETROLEUM CORPORATION

Address 1: P.O. BOX 1330

Address 2: _____

City HOUSTON State TX Zip: 77251 + 1330

Contact Person: MELANIE WIGGINS

Phone (832) 636-1053

CONTRACTOR: License # 33784

Name: Trinidad Drilling LP

Wellsite Geologist: _____

Purchaser: Anadarko Energy Services Company

Designate Type of Completion

- New Well Re-Entry Workover
- Oil SWD SIOW
- Gas ENHR SIGW
- CM (Coal Bed Methane) Temp. Abd.
- Dry Other _____
(Core, WSW, Expl., Cathodic, etc.)

If Workover/Reentry: Old Well Info as follows:

Operator: _____

Well Name: _____

Original Comp. Date _____ Original Total Depth _____

Deepening Re-perf. Conv.to Enhr Conv.to SWD

Plug Back Plug Back Total Depth _____

Commingled Docket No. _____

Dual Completion Docket No. _____

Other (SWD or Enhr?) Docket No. _____

<u>6-2-2010</u>	<u>6-4-2010</u>	<u>6-28-2010</u>
Spud Date or Recompletion Date	Date Reached TD	Completion Date or Recompletion Date

API NO. 15-189-22724-00-00

Spot Description: _____

NE - NE - SW - NW Sec. 36 Twp. 33 S. R. 39 East West

1390 Feet from North / South Line of Section

1250 Feet from East / West Line of Section

Footages Calculated from Nearest Outside Section Corner:

NE NW SE SW

County Stevens

Lease Name NIX H Well # 2HP

Field Name Hugoton/Panoma

Producing Formation Chase/Council Grove

Elevation: Ground 3223 Kelley Bushing -

Total Depth 3270 Plug Back Total Depth -

Amount of Surface Pipe Set and Cemented at 637 Feet

Multiple Stage Cementing Collar Used? Yes No.

If yes, show depth set _____ Feet

If Alternate II completion, cement circulated from _____

feet depth to _____ w/ _____ sx cmt.

Drilling Fluid Management Plan

(Data must be collected from the Reserve Pit)

Chloride content 4200 ppm Fluid volume 120 bbls

Dewatering method used HAUL OFF

Location of fluid disposal if hauled offsite: _____

Operator Name ANADARKO PETROLEUM CORPORATION

Lease Name KEEFER A 1 License No. 4549

Quarter SW Sec. 13 Twp. 32 S R. 38 East West

County STEVENS Docket No. D17157

INSTRUCTIONS: An original and two copies of this form shall be filed with the Kansas Corporation Commission, 130 S. Market - Room 2078, Wichita, Kansas 67202, within 120 days of the spud date, recompletion, workover or conversion of a well. Rule 82-3-130, 82-3-106 and 82-3-107 apply. Information on side two of this form will be held confidential for a period of 12 months if requested in writing and submitted with the form (see rule 82-3-107 for confidentiality in excess of 12 months). One copy of all wireline logs and geologist well report shall be attached with this form. ALL CEMENTING TICKETS MUST BE ATTACHED. Submit CP-4 form with all plugged wells. Submit CP-111 form with all temporarily abandoned wells.

All requirements of the rules and regulations promulgated to regulate the oil and gas industry have been fully complied with and the statements herein are complete and correct to the best of my knowledge.

Signature Melanie Wiggins

Title REGULATORY MANAGER Date 10/05/2010

Subscribed and sworn to before me this 5th day of October

20 10

Notary Public [Signature]

Date Commission Expires 12-27-13

KCC Office Use ONLY

N

Letter of Confidentiality Attached

If Denied, Yes Date: _____

Wireline Log Received

Geologist Report Received

UIC Distribution

141-DIG-10/14/10

Operator Name ANADARKO PETROLEUM CORPORATION Lease Name Nix H Well # 2HP

Sec. 36 Twp. 33 S.R. 39 East West County Stevens

INSTRUCTIONS: Show important tops and base of formations penetrated. Detail all cores. Report all drill stem tests giving interval tested, time tool open and closed, flowing and shut-in pressures, whether shut-in pressure reached static level, hydrostatic pressures, bottom hole temperature, fluid recovery, and flow rates if gas to surface during test, along with final chart(s). Attach extra sheet if more space is needed. Attach copy of all Electric Wireline Logs surveyed. Attach final geological well site report.

Drill Stem Tests Taken <i>(Attach Additional Sheets)</i> <input type="checkbox"/> Yes <input checked="" type="checkbox"/> No Samples Sent to Geological Survey <input type="checkbox"/> Yes <input checked="" type="checkbox"/> No Cores Taken <input type="checkbox"/> Yes <input checked="" type="checkbox"/> No Electric Log Run <i>(Submit Copy)</i> <input checked="" type="checkbox"/> Yes <input type="checkbox"/> No List All E.Logs Run: CEMENT BOND LOG NEUTRON LOG	<input checked="" type="checkbox"/> Log Formation (Top), Depth and Datums <input type="checkbox"/> Sample <table style="width:100%; border-collapse: collapse;"> <tr> <td style="width:60%;">Name</td> <td style="width:20%;">Top</td> <td style="width:20%;">Datum</td> </tr> <tr> <td>Base Cedar Hills</td> <td>1410</td> <td></td> </tr> <tr> <td>Base Stone Corral</td> <td>1710</td> <td></td> </tr> <tr> <td>Chase</td> <td>2533</td> <td></td> </tr> <tr> <td>Council Grove</td> <td>2843</td> <td></td> </tr> </table>	Name	Top	Datum	Base Cedar Hills	1410		Base Stone Corral	1710		Chase	2533		Council Grove	2843	
Name	Top	Datum														
Base Cedar Hills	1410															
Base Stone Corral	1710															
Chase	2533															
Council Grove	2843															

CASING RECORD <input checked="" type="checkbox"/> New <input type="checkbox"/> Used Report all strings set-conductor, surface, intermediate, production, etc.							
Purpose of String	Size Hole Drilled	Size Casing Set (In O.D.)	Weight Lbs./Ft.	Setting Depth	Type of Cement	# Sacks Used	Type and Percent Additives
SURFACE	12.25	8 5/8	24	637	STANDARD	450	2% 2% CC
PRODUCTION	7.875	5 1/2	14	3270	MIDCON50/50	480	.5 HALAD
					TOC-250		

ADDITIONAL CEMENTING/SQUEEZE RECORD				
Purpose	Depth Top Bottom	Type of Cement	#Sacks Used	Type and Percent Additives
<input type="checkbox"/> Perforate <input type="checkbox"/> Protect Casing <input type="checkbox"/> Plug Back TD <input type="checkbox"/> Plug Off Zone				

Shots Per Foot	PERFORATION RECORD - Bridge Plugs Set/Type Specify Footage of Each Interval Perforated	Acid, Fracture, Shot, Cement Squeeze Record <i>(Amount and Kind of Material Used)</i>	Depth
3	2975-83; 2951-60; 2928-42; 2872-77	Frac w/67,175 gals 25# x-linked patriot.5% KCL w/124,000# 12/20sand	2872-2983
2	2733-43; 2680-94; 2617-43; 2566-72	Frac w/145,320 gals 25# x-linked .5% KCL w/300,000# 12/20 sand	2566-2743

TUBING RECORD	Size 2 3/8	Set At 2854	Packer At -	Liner Run <input type="checkbox"/> Yes <input checked="" type="checkbox"/> No
---------------	---------------	----------------	----------------	---

Date of First, Resumed Production, SWD or Enhr. 6-28-2010	Producing Method <input type="checkbox"/> Flowing <input checked="" type="checkbox"/> Pumping <input type="checkbox"/> Gas Lift <input type="checkbox"/> Other (Explain)
--	---

Estimated Production Per 24 Hours	Oil Bbls.	Gas Mcf	Water Bbls.	Gas-Oil Ratio	Gravity
	0	135	0		

DISPOSITION OF GAS: <input type="checkbox"/> Vented <input checked="" type="checkbox"/> Sold <input type="checkbox"/> Used on Lease <i>(If vented, submit ACO-18.)</i>	METHOD OF COMPLETION <input type="checkbox"/> Open Hole <input checked="" type="checkbox"/> Perf. <input type="checkbox"/> Dually Comp. <input type="checkbox"/> Commingled. <input type="checkbox"/> Other (Specify) _____	Production Interval 2566-2983
--	---	----------------------------------



October 5, 2010

Kansas Corporation Commission
Conservation Division
Finney State Office Building
130 S. Market Room 2078
Wichita, KS 67202-3802

RE: Nix H 2HP
Section 36-33S-39W
API 15-189-22724-00-00
Stevens County, Kansas

Gentlemen:

Enclosed are the following forms and documents for the completion of the above referenced new well:

ACO-1 Well Completion form (original & 2 copies)
CG-8 Form
Cementing Tickets
Copies of all logs run

No confidentiality is requested.

Please call me at 832-636-1053 if there are any questions.

Sincerely,

A handwritten signature in cursive script that reads "Melanie Wiggins".

Melanie Wiggins
Regulatory Analyst
melanie.wiggins@anadarko.com

Enclosures

RECEIVED
OCT 07 2010
KCC WICHITA

PLAT AND CERTIFICATION OF ACREAGE ATTRIBUTABLE TO A GAS WELL

Kansas Corporation Commission, Conservation Division
Finney State Office Building, 130 South Market, Room 2078
Wichita, Kansas 67202

API NUMBER 15- _____

LOCATION OF WELL: COUNTY Stevens

OPERATOR Anadarko Petroleum Corporation

LEASE Nix H

1390 feet from south north line of section

WELL NUMBER 2HP

1250 feet from east west line of section

FIELD Hugoton Panoma Council Grove

SECTION 36 TWP 33 (S) RG 39 E W

NUMBER OF ACRES ATTRIBUTABLE TO WELL 640

IS SECTION REGULAR or IRREGULAR

QTR/QTR/QTR OF ACREAGE _____

IF SECTION IS IRREGULAR, LOCATE WELL FROM

(see attached)

NEAREST CORNER BOUNDARY. (check line below)

Section corner used: NE NW SE SW

(Show the location of the well and shade attributable acreage for prorated or spaced wells).
(Show the footage to the nearest lease or unit boundary line; and show footage to the nearest common source supply well).

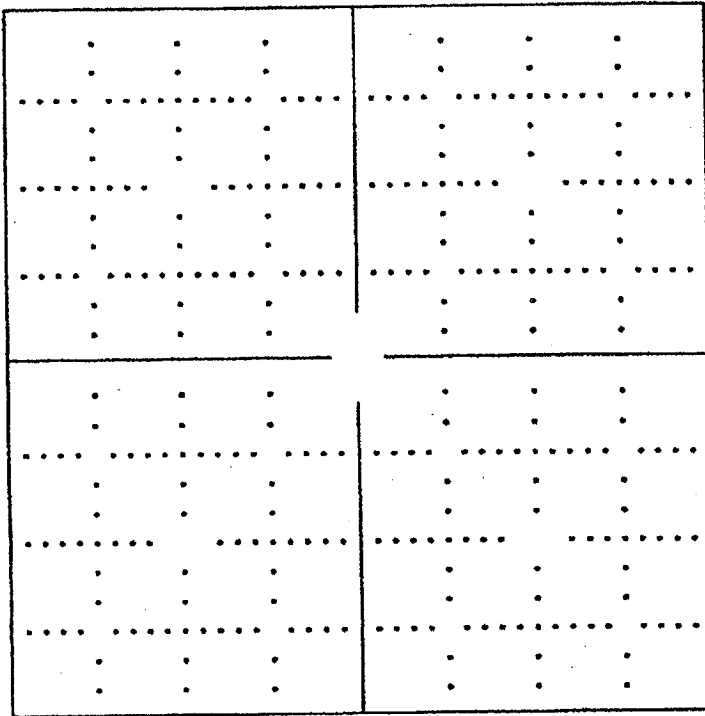

RECEIVED
MAR 10 2010
KCC WICHITA

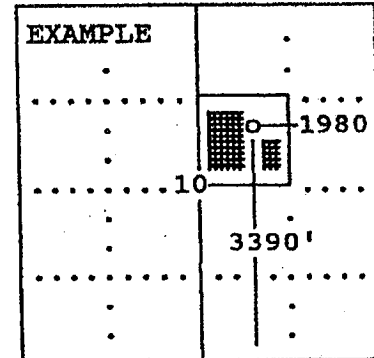

RECEIVED
OCT 07 2010
KCC WICHITA

SEWARD CO.

The undersigned hereby certifies as attorney _____ (title) for

Anadarko Petroleum Corporation (Co.), a duly authorized agent, that all information shown hereon is true and correct to the best of my knowledge and belief, that all acreage claimed attributable to the well named herein is held by production from that well and hereby make application for an allowable to be assigned to the well upon the filing of this form and the State test, whichever is later.

Signature David W. Nickel
David W. Nickel

Subscribed and sworn to before me on this 10th day of March, 2010

Marilyn B. Morlan
Marilyn B. Morlan Notary Public

My Commission expires 10/29/13

FORM CG-8 (12/94)



ATTACHMENT TO FORM CG-8 (12/94)
ANADARKO PETROLEUM CORPORATION
Nix H 2HP Well
Section 36, Township 33 South, Range 39 West
Stevens County, Kansas

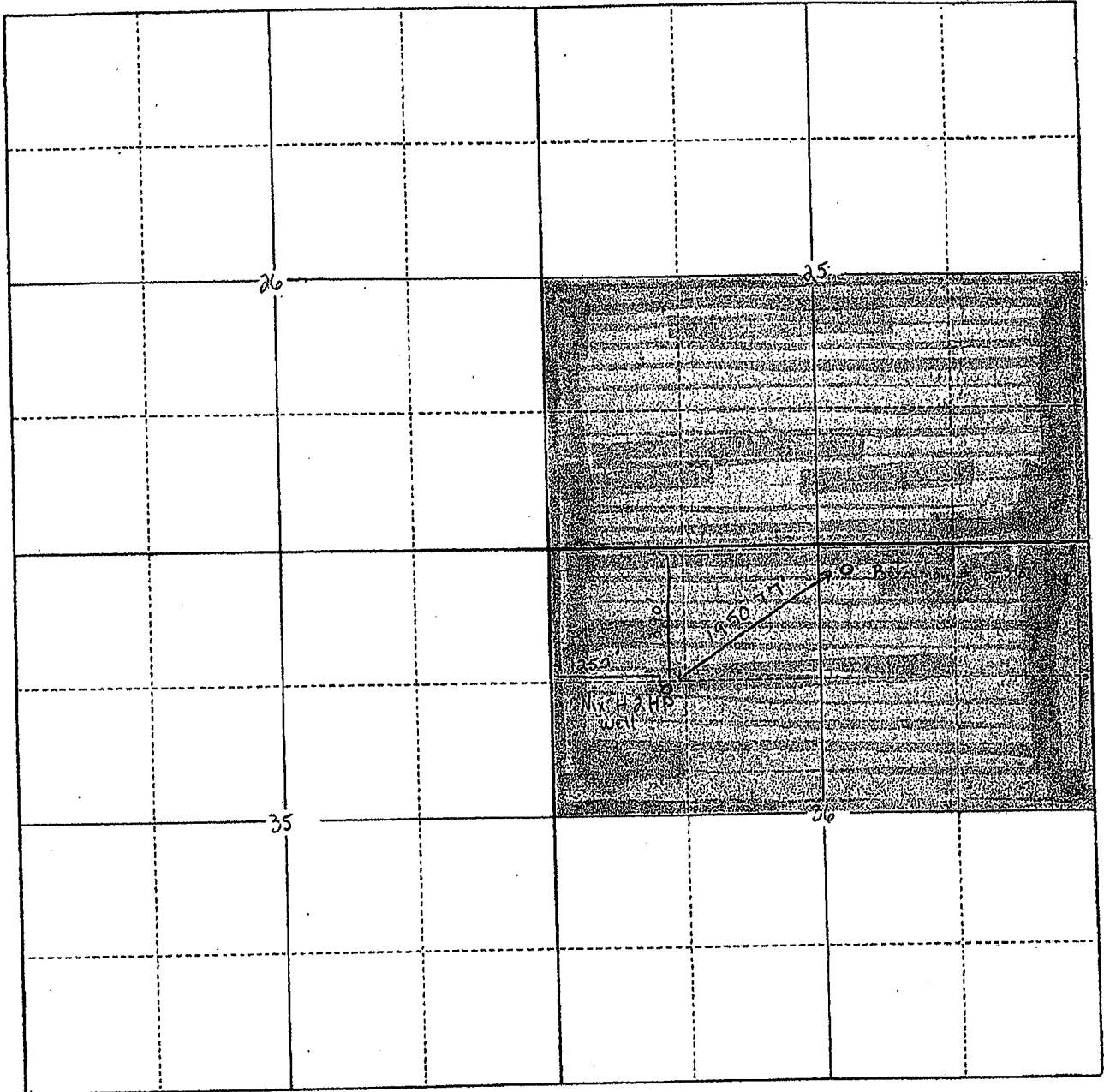

Unit Acreage:

South Half (S/2) of Section 25, and North Half (N/2) of Section 36, in Section 33 South, Range 39 West of the Sixth P.M., Stevens County, Kansas, consisting of 640 acres

RECEIVED
OCT 07 2010

RECEIVED KCC WICHITA
MAR 10 2010
KCC WICHITA

HALLIBURTON

Cementing Job Summary

The Road to Excellence Starts with Safety

Sold To #: 300466	Ship To #: 2787549	Quote #:	Sales Order #: 7410507
Customer: ANADARKO PETROLEUM CORP - EBUS		Customer Rep:	
Well Name: NIX H	Well #: 2HP	API/UWI #:	
Field:	City (SAP): HUGOTON	County/Parish: Stevens	State: Kansas
Contractor: TRINIDAD		Rig/Platform Name/Num: 208	
Job Purpose: Cement Surface Casing			
Well Type: Development Well		Job Type: Cement Surface Casing	
Sales Person: HESTON, MYRON		Srvc Supervisor: SMITH, BOBBY	MBU ID Emp #: 106036

Job Personnel

HES Emp Name	Exp Hrs	Emp #	HES Emp Name	Exp Hrs	Emp #	HES Emp Name	Exp Hrs	Emp #
ARNETT, JAMES Ray	12	226567	MATA, ADOLFO V	12	419999	SLATER, JOE P	12	106095
SMITH, BOBBY Wayne	12	106036						

Equipment

HES Unit #	Distance-1 way	HES Unit #	Distance-1 way	HES Unit #	Distance-1 way	HES Unit #	Distance-1 way

Job Hours

Date	On Location Hours	Operating Hours	Date	On Location Hours	Operating Hours	Date	On Location Hours	Operating Hours

TOTAL Total is the sum of each column separately

Job

Job Times

Formation Name	Formation Depth (MD) Top	Bottom	Called Out	Date	Time	Time Zone
Form Type		BHST				
Job depth MD	637.675 ft	Job Depth TVD	637			
Water Depth		Wk Ht Above Floor	2. ft			
Perforation Depth (MD) From		To	Departed Loc			

Well Data

Description	New / Used	Max pressure psig	Size in	ID in	Weight lbf/ft	Thread	Grade	Top MD ft	Bottom MD ft	Top TVD ft	Bottom TVD ft
Surface Hole				12.25					875.650		
Surface Casing	Unknown		8.625	8.097	24.				876.637		

Sales/Rental/3rd Party (HES)

Description

Qty Qty uom Depth Supplier

SHOE,GID,8-5/8 8RD	1	EA		
VLVASSY,INSR FLOAT,8-5/8 8RD, 24 lbs/ft	1	EA		
FILLUP ASSY - 1.500 ID - 7 IN. - 8-5/8	1	EA		
CENTRALIZER ASSY - API - 8-5/8 CSG X	3	EA		
BASKET - CEMENT - 8 5/8 CSG X 12 1/4	1	EA		
PLUG,CMTG,TOP,8 5/8,HWE,7.20 MIN/8.09 MA	1	EA		

Tools and Accessories

Type	Size	Qty	Make	Depth	Type	Size	Qty	Make	Depth	Type	Size	Qty	Make
Guide Shoe					Packer					Top Plug			
Float Shoe					Bridge Plug					Bottom Plug			
Float Collar					Retainer					SSR plug set			
Insert Float										Plug Container			
Stage Tool										Centralizers			

Miscellaneous Materials

Gelling Agt	Conc	Surfactant	Conc	Acid Type	Qty	Conc	%
Treatment Fld	Conc	Inhibitor	Conc	Sand Type	Size	Conc	Qty

HALLIBURTON

Cementing Job Summary

Fluid Data									
Stage/Plug #: 1									
Fluid #	Stage Type	Fluid Name	Qty	Qty uom	Mixing Density lbm/gal	Yield ft3/sk	Mix Fluid Gal/sk	Rate bbl/min	Total Mix Fluid Gal/sk
1	Water Pre-Flush			bbl	8.33	.0	.0	5.0	
2	Halliburton Light Standard	HALLIBURTON LIGHT STANDARD - SBM (12313)	230.0	sacks	12.4	2.09	11.42	5.0	11.42
	2 %	CALCIUM CHLORIDE - HI TEST PELLET (100005053)							
	0.5 lbm	POLY-E-FLAKE (101216940)							
	11.423 Gal	FRESH WATER							
3	Standard Cement	CMT - STANDARD CEMENT (100003684)	220.0	sacks	15.6	1.2	5.24	5.0	5.24
	94 lbm	CMT - STANDARD - CLASS A REG OR TYPE I, BULK (100003684)							
	2 %	CALCIUM CHLORIDE - HI TEST PELLET (100005053)							
	0.25 lbm	POLY-E-FLAKE (101216940)							
	5.238 Gal	FRESH WATER							
4	Displacement		37.00	bbl	8.33	.0	.0	5.0	
Calculated Values		Pressures			Volumes				
Displacement		Shut In: Instant		Lost Returns		Cement Slurry		Pad	
Top Of Cement		5 Min		Cement Returns	35	Actual Displacement		Treatment	
Frac Gradient		15 Min		Spacers		Load and Breakdown		Total Job	
Rates									
Circulating		Mixing		Displacement		Avg. Job			
Cement Left In Pipe	Amount	0 ft	Reason	Shoe Joint					
Frac Ring # 1 @	ID	Frac ring # 2 @	ID	Frac Ring # 3 @	ID	Frac Ring # 4 @	ID		
The Information Stated Herein Is Correct				Customer Representative Signature					

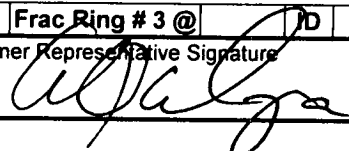

RECEIVED
OCT 07 2010
KCC WICHITA

HALLIBURTON

Cementing Job Log

The Road to Excellence Starts with Safety

Sold To #: 300466	Ship To #: 2787549	Quote #:	Sales Order #: 7410507
Customer: ANADARKO PETROLEUM CORP - EBUS		Customer Rep:	
Well Name: Mix	Well #: H2HP	API/UWI #:	
Field:	City (SAP): HUGOTON	County/Parish: Stevens	State: Kansas
Legal Description:			
Lat:		Long:	
Contractor: TRINIDAD		Rig/Platform Name/Num: 208	
Job Purpose: Cement Surface Casing			Ticket Amount:
Well Type: Development Well		Job Type: Cement Surface Casing	
Sales Person: HESTON, MYRON		Srvc Supervisor: SMITH, BOBBY	MBU ID Emp #: 106036

Activity Description	Date/Time	Cht #	Rate bbl/min	Volume bbl		Pressure psig		Comments
				Stage	Total	Tubing	Casing	
Call Out	06/02/2010 20:00							
Depart Location Safety Meeting	06/02/2010 22:00							
Arrive At Loc	06/02/2010 23:00							
Assessment Of Location Safety Meeting	06/02/2010 23:00							Rig is drilling
Pre-Rig Up Safety Meeting	06/02/2010 23:10							
Rig-Up Completed	06/02/2010 23:55							
Other	06/03/2010 02:00							drill pipe out of the hole
Other	06/03/2010 02:30							casing going in the hole
Other	06/03/2010 03:25							casing on bottom. rig circulating.
Safety Meeting - Pre Job	06/03/2010 03:30							
Start Job	06/03/2010 03:49							
Test Lines	06/03/2010 03:50							
Pump Lead Cement	06/03/2010 03:54		5	85.6			100.0	250 sx = 517.5 ft3 = top of cement surface
Other	06/03/2010 03:55							mud returns
Pump Tail Cement	06/03/2010 04:11		5	47.01			200.0	220 sx = 264 ft3. top of cement 33 ft
Drop Top Plug	06/03/2010 04:20							
Pump Displacement	06/03/2010 04:28		5	0			50.0	water
Bump Plug	06/03/2010 04:39		2	37.8			300.0 900.0	

Sold To #: 300466

Ship To #: 2787549

Quote #:

Sales Order #:

7410507

SUMMIT Version: 7.20.130

Thursday, June 03, 2010 05:23:00

HALLIBURTON

Cementing Job Log

Activity Description	Date/Time	Cht #	Rate bbl/min	Volume bbl		Pressure psig		Comments
				Stage	Total	Tubing	Casing	
Release Casing Pressure	06/03/2010 04:41							float held
End Job	06/03/2010 04:42							35 bbls of cement back to surface
Safety Meeting - Pre Rig-Down	06/03/2010 04:50							
Rig-Down Completed	06/03/2010 06:30							
Safety Meeting - Departing Location	06/03/2010 10:30							waited on the cat to pull the trucks off location
Depart Location for Service Center or Other Site	06/03/2010 11:00							Thank you for calling Halliburton. Bob and crew.

RECEIVED
OCT 07 2010
KCC WICHITA

Sold To # : 300466

Ship To # : 2787549

Quote # :

Sales Order # : 7410507

SUMMIT Version: 7.20.130

Thursday, June 03, 2010 05:23:00

The Road to Excellence Starts with Safety

Sold To #: 300466	Ship To #: 2787549	Quote #:	Sales Order #: 7416979
Customer: ANADARKO PETROLEUM CORP - EBUS		Customer Rep:	
Well Name: NIX H	Well #: 2HP	API/UWI #:	
Field:	City (SAP): HUGOTON	County/Parish: Stevens	State: Kansas
Contractor: TRINIDAD		Rig/Platform Name/Num: TRINIDAD #208	
Job Purpose: Cement Production Casing			RECEIVED OCT 07 2010
Well Type: Development Well		Job Type: Cement Production Casing	
Sales Person: HESTON, MYRON		Srvc Supervisor: WILTSHIRE, MERSHEK	MBU ID Emp #: 195811

Job Personnel

HES Emp Name	Exp Hrs	Emp #	HES Emp Name	Exp Hrs	Emp #	HES Emp Name	Exp Hrs	Emp #
LOPEZ, JUAN R	5.3	198514	SLATER, JOE P	5.3	106095	WILTSHIRE, MERSHEK Tonje	5.3	195811

Equipment

HES Unit #	Distance-1 way	HES Unit #	Distance-1 way	HES Unit #	Distance-1 way	HES Unit #	Distance-1 way

Job Hours

Date	On Location Hours	Operating Hours	Date	On Location Hours	Operating Hours	Date	On Location Hours	Operating Hours

TOTAL Total is the sum of each column separately

Job

Job Times

Formation Name	Formation Depth (MD) Top	Bottom	Called Out	Date	Time	Time Zone
				05 - Jun - 2010	04:00	CST
Form Type	BHST		On Location	05 - Jun - 2010	07:30	CST
Job depth MD	3270 3750 ft	Job Depth TVD	Job Started	05 - Jun - 2010	10:38	CST
Water Depth		Wk Ht Above Floor	Job Completed	05 - Jun - 2010	11:41	CST
Perforation Depth (MD) From		To	Departed Loc	05 - Jun - 2010	13:00	CST

Well Data

Description	New / Used	Max pressure psig	Size in	ID in	Weight lbm/ft	Thread	Grade	Top MD ft	Bottom MD ft	Top TVD ft	Bottom TVD ft
Production Open Hole				7.875				875 650	3750 3270		
5 1/2 Production Casing	Unknown		5.5	5.012	14.				3750 3270		
Surface Casing	Unknown		8.625	8.097	24.				875 637		

Sales/Rental/3rd Party (HES)

Description	Qty	Qty uom	Depth	Supplier
SHOE, GID, 5-1/2 8RD	1	EA		
PLUG ASSY, LTH-DWN, 5 1/2 13-23#, F/ 2.875	1	EA		
BAFFLE ASSY - 5-1/2 8RD - LATCH-DOWN	1	EA		
CENTRALIZER ASSY - TURBO - API -	14	EA		
KIT, HALL WELD-A	1	EA		

Tools and Accessories

Type	Size	Qty	Make	Depth	Type	Size	Qty	Make	Depth	Type	Size	Qty	Make
Guide Shoe					Packer					Top Plug			
Float Shoe					Bridge Plug					Bottom Plug			
Float Collar					Retainer					SSR plug set			
Insert Float										Plug Container			
Stage Tool										Centralizers			

Cementing Job Summary

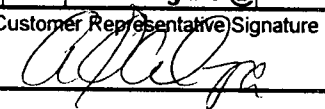
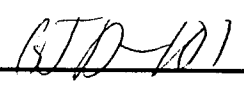
Miscellaneous Materials											
Gelling Agt	Conc	Surfactant	Conc	Acid Type	Qty	Conc	%				
Treatment Fld	Conc	Inhibitor	Conc	Sand Type	Size	Qty					
Fluid Data											
Stage/Plug #: 1											
Fluid #	Stage Type	Fluid Name	Qty	Qty uom	Mixing Density lbm/gal	Yield ft3/sk	Mix Fluid Gal/sk	Rate bbl/min	Total Mix Fluid Gal/sk		
1	Water Pre-Flush			bbl	8.33	.0	.0	6.0			
2	MID-CON 2 STANDARD	MIDCON-2 CEMENT STANDARD - SBM (15078)	200.0	sacks	11.4	2.89	17.84	6.0	17.84		
	0.25 lbm	POLY-E-FLAKE (101216940)									
	17.838 Gal	FRESH WATER									
3	50/50 POZ STANDARD	POZ STANDARD 50/50 - SBM (12308)	280.0	sacks	13.3	1.63	7.25	6.0	7.25		
	10 lbm	KOL-SEAL, BULK (100064233)									
	0.5 %	HALAD(R)-322, 50 LB (100003646)									
	0.25 lbm	POLY-E-FLAKE (101216940)									
	7.25 Gal	FRESH WATER									
4	2% KCL Water w/ Biocide Displacement			bbl	8.33	.0	.0	6.0			
	2.5 gal/Mgal	CLAYFIX 3, TOTETANK (101583425)									
	0.021 gal/bbl	BE-7, TOTE TANK (101649552)									
	42 gal/bbl	WATER - FRESH - GAL (24047)									
Calculated Values			Pressures			Volumes					
Displacement		Shut In: Instant		Lost Returns		Cement Slurry		Pad			
Top Of Cement		5 Min		Cement Returns		Actual Displacement		Treatment			
Frac Gradient		15 Min		Spacers		Load and Breakdown		Total Job			
Rates											
Circulating		Mixing		Displacement		Avg. Job					
Cement Left In Pipe	Amount	0 ft	Reason	Shoe Joint							
Frac Ring # 1 @	ID	Frac ring # 2 @	ID	Frac Ring # 3 @	ID	Frac Ring # 4 @	ID				
The Information Stated Herein Is Correct				Customer Representative Signature							
				 							

RECEIVED
OCT 07 2010
KCC WICHITA

Cementing Job Log

The Road to Excellence Starts with Safety

Sold To #: 300466	Ship To #: 2787549	Quote #:	Sales Order #: 7416979
Customer: ANADARKO PETROLEUM CORP - EBUS		Customer Rep:	
Well Name: MIX	Well #: H2HP	API/UWI #:	
Field:	City (SAP): HUGOTON	County/Parish: Stevens	State: Kansas
Legal Description:			
Lat:		Long:	
Contractor: TRINIDAD		Rig/Platform Name/Num: TRINIDAD #208	
Job Purpose: Cement Production Casing			Ticket Amount:
Well Type: Development Well		Job Type: Cement Production Casing	
Sales Person: HESTON, MYRON		Srvc Supervisor: WILTSHIRE, MERSHEK	MBU ID Emp #: 195811

Activity Description	Date/Time	Cht #	Rate bbl/min	Volume bbl		Pressure psig		Comments
				Stage	Total	Tubing	Casing	
Call Out	06/05/2010 04:00							
Arrive At Loc	06/05/2010 07:30							
Pre-Job Safety Meeting	06/05/2010 07:45							
Start Job	06/05/2010 10:38							5 1/2" PRODUCTION CASING
Test Lines	06/05/2010 10:38						3000.0	
Pump Lead Cement	06/05/2010 10:42		5.5	103			480.0	200 SKS MIDCON 2 @ 11.4#
Pump Tail Cement	06/05/2010 10:59		5.5	82			20.0	280 SKS 50/50 POZ @ 13.3#
Drop Top Plug	06/05/2010 11:14		5.5		185		18.0	END CEMENT
Clean Lines	06/05/2010 11:16							
Pump Displacement	06/05/2010 11:21		6	79			.0	RIG WATER
Other	06/05/2010 11:36		2	69			750.0	SLOW RATE
Other	06/05/2010 11:39						800.0	PRESSURE BEFORE LANDING PLUG
Bump Plug	06/05/2010 11:39		2		79		1900.0	FLOAT HELD
End Job	06/05/2010 11:41							
Cement Returns to Surface	06/05/2010 11:50				38			50 BBLS OF CEMENT TO PIT

RECEIVED

OCT 07 2010

KCC WICHITA