

For KCC Use: Effective Date: 12-11-2010 District #: 4 SGA? Yes No

KANSAS CORPORATION COMMISSION OIL & GAS CONSERVATION DIVISION

Form C-1 March 2010 Form must be Typed Form must be Signed All blanks must be Filled

NOTICE OF INTENT TO DRILL

Must be approved by KCC five (5) days prior to commencing well Form KSONA-1, Certification of Compliance with the Kansas Surface Owner Notification Act, MUST be submitted with this form.

Expected Spud Date: 1/10/11 month day year

Spot Description: Approx S/2 SW SE S/2 SW SE Sec 27 Twp 8 S. R. 13 E W 200' feet from N / S Line of Section 2050' feet from E / W Line of Section

OPERATOR: License# 33599 Name: Barline Oil, LLC Address 1: 7804 E. Funston, Suite 216 Address 2: 2103 Dalton City: Wichita State: KS Zip: 67207 Contact Person: Bill Ree, Manager Phone: 316-425-6990, Cell 316-833-3556 CONTRACTOR: License# 31548 Name: Discovery Drilling

Is SECTION: Regular Irregular? County: Osborne

Lease Name: Becker "A" Well #: 2 Field Name: w/c

Is this a Prorated / Spaced Field? Yes No Target Formation(s): Arbuckle Nearest Lease or unit boundary line (in footage): 600' - Vohs

Well Drilled For: Oil Gas Seismic; # of Holes Other Well Class: Enh Rec Storage Disposal Infield Pool Ext. Wildcat Other Type Equipment: Mud Rotary Air Rotary Cable

Ground Surface Elevation: 1684 feet MSL Water well within one-quarter mile: Yes No

Public water supply well within one mile: Yes No Depth to bottom of fresh water: 180

Depth to bottom of usable water: 525 Surface Pipe by Alternate: II Length of Surface Pipe Planned to be set: 225'

Length of Conductor Pipe (if any): None Projected Total Depth: 3800 Formation at Total Depth: Arbuckle

If OWWO: old well information as follows: Operator: N/A Well Name: Original Completion Date: Original Total Depth:

Water Source for Drilling Operations: Well Farm Pond Other: Covert Creek DWR Permit #: 20100472 20100472

Directional, Deviated or Horizontal wellbore? Yes No If Yes, true vertical depth: Bottom Hole Location: KCC DKT #:

Will Cores be taken? Yes No If Yes, proposed zone:

Oil & gas lease submitted

AFFIDAVIT

The undersigned hereby affirms that the drilling, completion and eventual plugging of this well will comply with K.S.A. 55 et. seq. It is agreed that the following minimum requirements will be met:

RECEIVED DEC 03 2010

KCC WICHITA

- 1. Notify the appropriate district office prior to spudding of well;
2. A copy of the approved notice of intent to drill shall be posted on each drilling rig;
3. The minimum amount of surface pipe as specified below shall be set by circulating cement to the top; in all cases surface pipe shall be set through all unconsolidated materials plus a minimum of 20 feet into the underlying formation.
4. If the well is dry hole, an agreement between the operator and the district office on plug length and placement is necessary prior to plugging;
5. The appropriate district office will be notified before well is either plugged or production casing is cemented in;
6. If an ALTERNATE II COMPLETION, production pipe shall be cemented from below any usable water to surface within 120 DAYS of spud date. Or pursuant to Appendix "B" - Eastern Kansas surface casing order #133,891-C, which applies to the KCC District 3 area, alternate II cementing must be completed within 30 days of the spud date or the well shall be plugged. In all cases, NOTIFY district office prior to any cementing.

I hereby certify that the statements made herein are true and to the best of my knowledge and belief.

Date: 12/1/10 Signature of Operator or Agent: Bill Ree Title: Manager

For KCC Use ONLY API # 15 - 141-20425-0000 Conductor pipe required None feet Minimum surface pipe required 200 feet per ALT. I II Approved by: Perm 12-6-2010 This authorization expires: 12-6-2011 (This authorization void if drilling not started within 12 months of approval date.) Spud date: Agent:

Remember to:

- File Certification of Compliance with the Kansas Surface Owner Notification Act (KSONA-1) with Intent to Drill;
- File Drill Pit Application (form CDP-1) with Intent to Drill;
- File Completion Form ACO-1 within 120 days of spud date;
- File acreage attribution plat according to field proration orders;
- Notify appropriate district office 48 hours prior to workover or re-entry;
- Submit plugging report (CP-4) after plugging is completed (within 60 days);
- Obtain written approval before disposing or injecting salt water.
- If well will not be drilled or permit has expired (See: authorized expiration date) please check the box below and return to the address below.

Well will not be drilled or Permit Expired Date: Signature of Operator or Agent:

Mail to: KCC - Conservation Division, 130 S. Market - Room 2078, Wichita, Kansas 67202

27-8-13

For KCC Use ONLY

API # 15 - 141-20425-0000

IN ALL CASES PLOT THE INTENDED WELL ON THE PLAT BELOW

In all cases, please fully complete this side of the form. Include items 1 through 5 at the bottom of this page.

Operator: 8b _____
 Lease: 8c _____
 Well Number: 8d _____
 Field: 8e _____

Number of Acres attributable to well: 8f _____
 QTR/QTR/QTR/QTR of acreage: 8g _____

Location of Well: County: 8h _____
 8i _____ feet from N / S Line of Section
 8j _____ feet from E / W Line of Section
 Sec. 8k _____ Twp. 8k _____ S. R. 8k _____ E W

Is Section: Regular or Irregular 8l

If Section is Irregular, locate well from nearest corner boundary.

Section corner used: NE NW SE SW 8m

8 PLAT

Show location of the well. Show footage to the nearest lease or unit boundary line. Show the predicted locations of lease roads, tank batteries, pipelines and electrical lines, as required by the Kansas Surface Owner Notice Act (House Bill 2032).

You may attach a separate plat if desired.

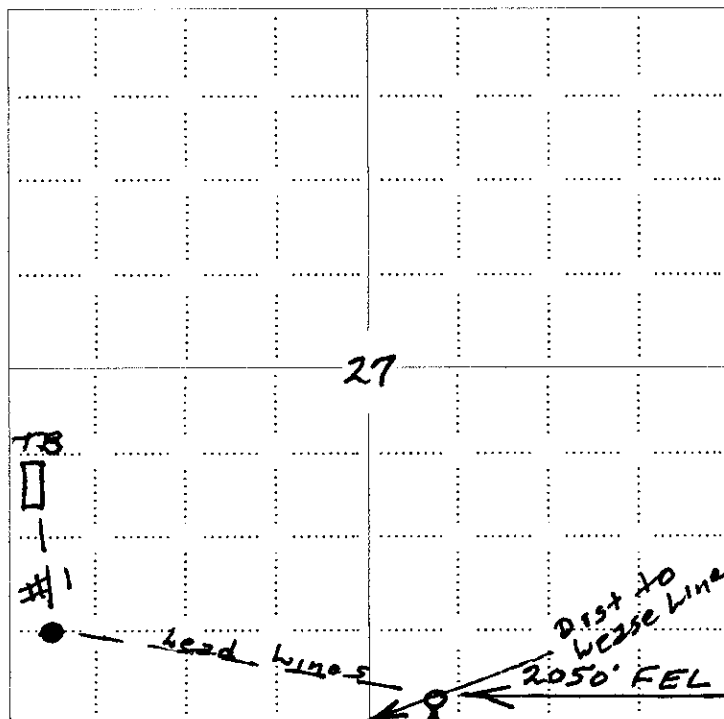

NOTE: In all cases locate the spot of the proposed drilling location.

200' FSL

Note: Road & electrical lines straight south 200' to Section road.

LEGEND

- Well Location
- Tank Battery Location
- Pipeline Location
- Electric Line Location
- Lease Road Location

RECEIVED
 DEC 03 2010

KCC WICHITA

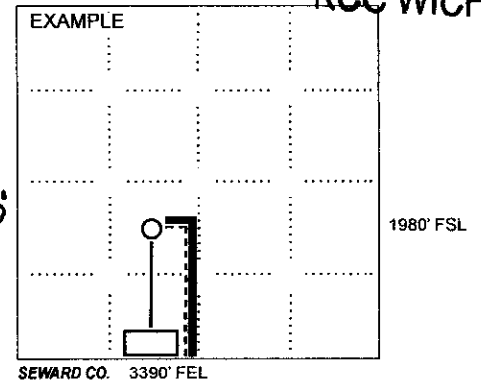

In plotting the proposed location of the well, you must show:

1. The manner in which you are using the depicted plat by identifying section lines, i.e. 1 section, 1 section with 8 surrounding sections, 4 sections, etc.
2. The distance of the proposed drilling location from the south / north and east / west outside section lines.
3. The distance to the nearest lease or unit boundary line (in footage).
4. If proposed location is located within a prorated or spaced field a certificate of acreage attribution plat must be attached: (CO-7 for oil wells; CG-8 for gas wells).
5. The predicted locations of lease roads, tank batteries, pipelines, and electrical lines.

15-141-20425-0000
KANSAS CORPORATION COMMISSION
OIL & GAS CONSERVATION DIVISION

Form KSONA-1
July 2010
Form Must Be Typed
Form must be Signed
All blanks must be Filled

**CERTIFICATION OF COMPLIANCE WITH THE
KANSAS SURFACE OWNER NOTIFICATION ACT**

This form must be submitted with all Forms C-1 (Notice of Intent to Drill); CB-1 (Cathodic Protection Borehole Intent); T-1 (Request for Change of Operator Transfer of Injection or Surface Pit Permit); and CP-1 (Well Plugging Application). Any such form submitted without an accompanying Form KSONA-1 will be returned.

Select the corresponding form being filed: C-1 (Intent) CB-1 (Cathodic Protection Borehole Intent) T-1 (Transfer) CP-1 (Plugging Application)

OPERATOR: License # 33599
Name: Barline Oil, LLC
Address 1: 7804 E. Funston, Suite 216
Address 2: 2103 Dalton
City: Wichita State: KS Zip: 67207
Contact Person: Bill Ree
Phone: (316) 833-3556 Fax: (316) 927-2672
Email Address: mah8042@aol.com

Well Location:
S/2 SW NE Sec. 27 Twp. 8 S. R. 13 East West
County: Osborne
Lease Name: Becker "A" Well #: 2

If filing a Form T-1 for multiple wells on a lease, enter the legal description of the lease below:
W/2 & SE/4 of Sec 27-8S-13W and
NE/4 of Sec 34-8S-13W (640 acres)

Surface Owner Information:

Name: Art & Wilma Becker
Address 1: 3936 SW Lincolnshire Rd.
Address 2: None
City: Topeka State: KS Zip: 66610

When filing a Form T-1 involving multiple surface owners, attach an additional sheet listing all of the information to the left for each surface owner. Surface owner information can be found in the records of the register of deeds for the county, and in the real estate property tax records of the county treasurer.

If this form is being submitted with a Form C-1 (Intent) or CB-1 (Cathodic Protection Borehole Intent), you must supply the surface owners and the KCC with a plat showing the predicted locations of lease roads, tank batteries, pipelines, and electrical lines. The locations shown on the plat are preliminary non-binding estimates. The locations may be entered on the Form C-1 plat, Form CB-1 plat, or a separate plat may be submitted.

Select one of the following:

I certify that, pursuant to the Kansas Surface Owner Notice Act (House Bill 2032), I have provided the following to the surface owner(s) of the land upon which the subject well is or will be located: 1) a copy of the Form C-1, Form CB-1, Form T-1, or Form CP-1 that I am filing in connection with this form; 2) if the form being filed is a Form C-1 or Form CB-1, the plat(s) required by this form; and 3) my operator name, address, phone number, fax, and email address.

I have not provided this information to the surface owner(s). I acknowledge that, because I have not provided this information, the KCC will be required to send this information to the surface owner(s). To mitigate the additional cost of the KCC performing this task, I acknowledge that I am being charged a \$30.00 handling fee, payable to the KCC, which is enclosed with this form.

If choosing the second option, submit payment of the \$30.00 handling fee with this form. If the fee is not received with this form, the KSONA-1 form and the associated Form C-1, Form CB-1, Form T-1, or Form CP-1 will be returned.

I hereby certify that the statements made herein are true and correct to the best of my knowledge and belief.

Date: 11/19/20 Signature of Operator or Agent: Bill Ree Title: Owner-Manager

Mail to: KCC - Conservation Division, 130 S. Market - Room 2078, Wichita, Kansas 67202

RECEIVED
DEC 03 2010
KCC WICHITA

KANSAS CORPORATION COMMISSION
OIL & GAS CONSERVATION DIVISION

Form CDP-1
May 2010
Form must be Typed

APPLICATION FOR SURFACE PIT

Submit in Duplicate

| | | |
|--|--|--|
| Operator Name: Barline Oil, LLC | | License Number: 33599 |
| Operator Address: 7804 E. Funston, Suite 216, Wichita, KS 67207 | | |
| Contact Person: Bill Ree | | Phone Number: Cell 316-833-3556 |
| Lease Name & Well No.: Becker "A", No. 2 | | Pit Location (OOOQ): S³³/2 SW SE |
| Type of Pit: <input type="checkbox"/> Emergency Pit <input type="checkbox"/> Burn Pit <input checked="" type="checkbox"/> Settling Pit <input type="checkbox"/> Drilling Pit <input type="checkbox"/> Workover Pit <input type="checkbox"/> Haul-Off Pit <small>(If WP Supply API No. or Year Drilled)</small> | Pit is: <input checked="" type="checkbox"/> Proposed <input type="checkbox"/> Existing If Existing, date constructed: Pit capacity: 3000 (bbls) | Sec. 27 Twp. 8S. R. 13 <input type="checkbox"/> East <input checked="" type="checkbox"/> West 200 Feet from <input type="checkbox"/> North / <input checked="" type="checkbox"/> South Line of Section 2050 Feet from <input checked="" type="checkbox"/> East / <input type="checkbox"/> West Line of Section Osborne County |
| Is the pit located in a Sensitive Ground Water Area? <input checked="" type="checkbox"/> Yes <input checked="" type="checkbox"/> No | | Chloride concentration: N/A mg/l <small>(For Emergency Pits and Settling Pits only)</small> |
| Is the bottom below ground level? <input checked="" type="checkbox"/> Yes <input type="checkbox"/> No | Artificial Liner? <input type="checkbox"/> Yes <input checked="" type="checkbox"/> No | How is the pit lined if a plastic liner is not used? Clay type soil |
| Pit dimensions (all but working pits): 70 Length (feet) 70 Width (feet) <input type="checkbox"/> N/A: Steel Pits Depth from ground level to deepest point: 4 (feet) <input type="checkbox"/> No Pit | | |
| If the pit is lined give a brief description of the liner material, thickness and installation procedure. N/A | | Describe procedures for periodic maintenance and determining liner integrity, including any special monitoring. N/A |
| Distance to nearest water well within one-mile of pit: 49 190 feet 333 Depth of water well: 80-100 feet | | Depth to shallowest fresh water: 80 4 feet. Source of information: <input type="checkbox"/> measured <input checked="" type="checkbox"/> well owner <input type="checkbox"/> electric log <input type="checkbox"/> KDWR |
| Emergency, Settling and Burn Pits ONLY: Producing Formation: Lansing Number of producing wells on lease: (1) One Barrels of fluid produced daily: 75 Does the slope from the tank battery allow all spilled fluids to flow into the pit? <input checked="" type="checkbox"/> Yes <input type="checkbox"/> No | | Drilling, Workover and Haul-Off Pits ONLY: Type of material utilized in drilling/workover: Drilling Mud Number of working pits to be utilized: 3 Abandonment procedure: Fluid evaporate & backfill Drill pits must be closed within 365 days of spud date. |
| I hereby certify that the above statements are true and correct to the best of my knowledge and belief. 11/17/10 Date | | RECEIVED DEC 03 2010 KCC WICHITA |
| Bill Ree, Manager Signature of Applicant or Agent | | |

15-141-20425-0000

| | | | |
|-------------------------------|----------------------|--|---|
| KCC OFFICE USE ONLY | | | |
| Date Received: 12-3-10 | Permit Number: _____ | Permit Date: 12-6-10 | Lease Inspection: <input checked="" type="checkbox"/> Yes <input type="checkbox"/> No |
| | | <input type="checkbox"/> Liner <input type="checkbox"/> Steel Pit <input checked="" type="checkbox"/> RFAC <input type="checkbox"/> RFAS | |

Mail to: KCC - Conservation Division, 130 S. Market - Room 2078, Wichita, Kansas 67202

December 6, 2010

Barline Oil, LLC
7804 E. Funston, Ste 216
Wichita, KS 67207

RE: Drilling Pit Application
Becker A Lease Well No. 2
SE/4 Sec. 27-08S-13W
Osborne County, Kansas

Dear Sir or Madam:

District staff has inspected the above referenced location and has determined that the reserve pit shall be constructed **without slots**, the bottom shall be flat and reasonably level, and the free fluids must be removed. The fluids are to be removed from the reserve pit as soon as practical after drilling operations have ceased. **Keep pits away from any draw, creek.**

If production casing is set all completion fluids shall be removed from the working pits daily. NO completion fluids or non-exempt wastes shall be placed in the reserve pit.

The fluids should be taken to an authorized disposal well. Please call the District Office at (785) 625-0550 when the fluids have been removed. Please file form CDP-5 (August 2004), Exploration and Production Waste Transfer, within 30 days of fluid removal. Conservation division forms are available through our office and on the KCC web site:
www.kcc.state.ks.us/conservation/forms.

A copy of this letter should be posted in the doghouse along with the approved Intent to Drill. If you have any questions or concerns please feel free to contact the undersigned at the above address.

Sincerely,

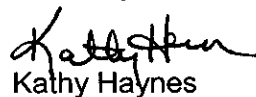
A handwritten signature in black ink, appearing to read "Kathy Haynes".

Kathy Haynes
Environmental Protection and Remediation Department

cc: district