

FOR KCC USE:

15-051-24908-0000

FORM C-1 7/91

EFFECTIVE DATE: 10-23-95DISTRICT # 4

State of Kansas

NOTICE OF INTENTION TO DRILL

FORM MUST BE TYPED

FORM MUST BE SIGNED

ALL BLANKS MUST BE FILLED

SGA? Yes No

Must be approved by the K.C.C. five (5) days prior to commencing well

Expected Spud Date November 16 1995
month day yearSpot
NE - NW - NE Sec 5 Twp 13 S, Rg 16 XX EastOPERATOR: License # 5252 ✓
Name: R.P. Nixon Operations, Inc.
Address: 207 West 12th Street
City/State/Zip: Hays, KS 67601
Contact Person: Dan Nixon
Phone: 913-628-3834✓ 4950 feet from South / North line of Section
✓ 1650 feet from East / West line of Section
IS SECTION XX REGULAR IRREGULAR?

(NOTE: Locate well on the Section Plat on Reverse Side)

County: EllisLease Name: LaMac Trust Well #: 1Field Name: EmmeramIs this a Prorated/Spaced Field? yes XX no ✓Target Formation(s): LKC, ArbuckleNearest lease or unit boundary: 330Ground Surface Elevation: 2015-EST feet MSLWater well within one-quarter mile: yes XX noPublic water supply well within one mile: yes XX noDepth to bottom of fresh water: 180' 180'Depth to bottom of usable water: 650' 760'Surface Pipe by Alternate: 1 XX 2 ✓Length of Surface Pipe Planned to be set: 200'Length of Conductor pipe required: noneProjected Total Depth: 3525'Formation at Total Depth: Arbuckle

Water Source for Drilling Operations:

well farm pond XX other

DWR Permit #: _____

Will Cores Be Taken?: yes XX no

If yes, proposed zone: _____

Well Drilled For: Well Class: Type Equipment:

X Oil Enh Rec Infield X Mud Rotary
Gas Storage X Pool Ext. Air Rotary
OWWO Disposal Wildcat Cable
Seismic # of Holes Other
Other

If OWWO: old well information as follows:

Operator: _____

Well Name: _____

Comp. Date: _____ Old Total Depth _____

Directional, Deviated or Horizontal wellbore? yes XX no ✓

If yes, true vertical depth: _____

Bottom Hole Location _____

AFFIDAVIT

The undersigned hereby affirms that the drilling, completion and eventual plugging of this well will comply with K.S.A. 55-101, et. seq.

It is agreed that the following minimum requirements will be met:

1. Notify the appropriate district office prior to spudding of well;
2. A copy of the approved notice of intent to drill shall be posted on each drilling rig;
3. The minimum amount of surface pipe as specified below shall be set by circulating cement to the top; in all cases surface pipe shall be set through all unconsolidated materials plus a minimum of 20 feet into the underlying formation;
4. If the well is dry hole, an agreement between the operator and the district office on plug length and placement is necessary prior to plugging;
5. The appropriate district office will be notified before well is either plugged or production casing is cemented in;
6. IF AN ALTERNATE II COMPLETION, PRODUCTION PIPE SHALL BE CEMENTED FROM BELOW ANY USABLE WATER TO SURFACE WITHIN 120 DAYS OF SPUD DATE. IN ALL CASES, NOTIFY DISTRICT OFFICE PRIOR TO ANY CEMENTING.

I hereby certify that the statements made herein are true and to the best of my knowledge and belief.

Date: October 17, 1995 Signature of Operator or Agent: [Signature] Title President

FOR KCC USE:

API # 15- 051-249080000Conductor pipe required NONE feetMinimum surface pipe required 200' feet per Alt. X(2)Approved by: JK 10-18-95This authorization expires: 4-18-96

(This authorization void if drilling not started within 6 months of effective date.)

Spud date: _____ Agent: _____

REMEMBER TO:

- File Drill Pit Application (form CDP-1) with Intent to Drill;
- File Completion Form ACO-1 within 120 days of spud date;
- File acreage attribution plat according to field proration orders;
- Notify appropriate district office 48 hours prior to workover or re-entry;
- Submit plugging report (CP-4) after plugging is completed;
- Obtain written approval before disposing or injecting salt water.

Mail to: KCC Conservation Office, Wichita State Office Bldg., 130 S. Market, Rm. 2078, Wichita, Kansas 67202.

RECEIVED
STATE CORPORATION COMMISSIONOCT 18 1995
10-18-1995
CONSERVATION DIVISION
Wichita, Kansas

163

IN ALL CASES PLOT THE INTENDED WELL ON THE PLAT BELOW

PLAT OF ACREAGE ATTRIBUTABLE TO A WELL IN A PRORATED OR SPACED FIELD

If the intended well is in a prorated or spaced field, please fully complete this side of the form. If the intended well is in a prorated or spaced field complete the plat below showing that the well will be properly located in relationship to other wells producing from the common source of supply. Please show all the wells within 1 mile of the boundaries of the proposed acreage attribution unit for gas wells and within 1/2 mile of the boundaries of the proposed acreage attribution unit for oil wells.

API NO. 15- not yet assigned
 OPERATOR R.P. Nixon Operations, Inc.
 LEASE LaMac Trust
 WELL NUMBER 1
 FIELD Emmeram

LOCATION OF WELL: COUNTY Ellis
4950 feet from south/north line of section
1650 feet from east/west line of section
 SECTION 5 TWP 13S RG 16W

NUMBER OF ACRES ATTRIBUTABLE TO WELL 10
 QTR/QTR/QTR OF ACREAGE NE - NW - NE

IS SECTION X REGULAR or IRREGULAR
IF SECTION IS IRREGULAR, LOCATE WELL FROM NEAREST CORNER BOUNDARY.

Section corner used: NE NW XX SE SW

PLAT

(Show location of the well and shade attributable acreage for prorated or spaced wells.)
 (Show footage to the nearest lease or unit boundary line.)

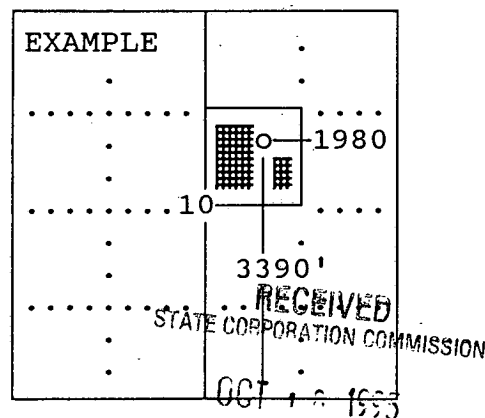
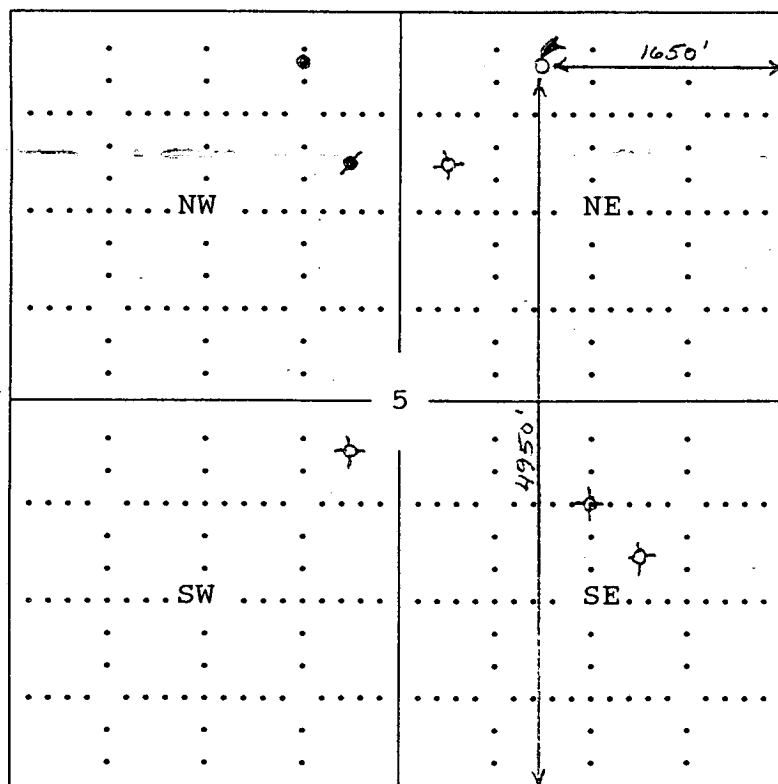

SEWARD CO.
 CONSERVATION DIVISION
 Wichita, Kansas

In plotting the proposed location of the well, you must show:

- 1) The manner in which you are using the depicted plat by identifying section lines, i.e. 1 section, 1 section with 8 surrounding sections, 4 sections, etc.;
- 2) the distance of the proposed drilling location from the section's south/north and east/west; and
- 3) the distance to the nearest lease or unit boundary line.