

Give All Information Completely
Make Required Affidavit
Mail or Deliver Report to:
Conservation Division
State Corporation Commission
212 North Market, Insurance Bldg.
Wichita, Kansas

WELL PLUGGING RECORD

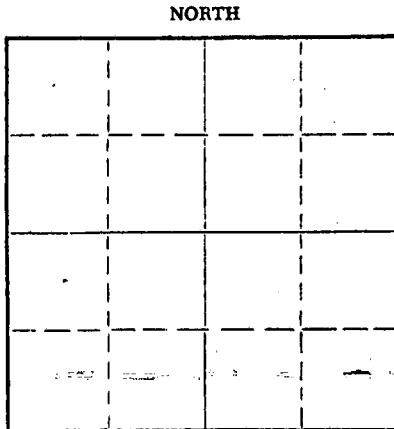

Russell County, Sec. 30 Twp. 13s Rge. 15W (E) (W)
Location as "NE/CNW&SW" or footage from lines SW NE NE
Lease Owner John O. Farmer, Inc.
Lease Name Polcyn Well No. # 1
Office Address P.O. Box 352, Russell, Kansas
Character of Well (completed as Oil, Gas or Dry Hole) Dry
Date well completed 2/23 1964
Application for plugging filed 2/23 1964
Application for plugging approved 2/23 1964
Plugging commenced 2/23 1964
Plugging completed 7 P.M. 2/23 1964
Reason for abandonment of well or producing formation Dry

Locate well correctly on above
Section Plat

If a producing well is abandoned, date of last production _____ 19____
Was permission obtained from the Conservation Division or its agents before plugging was commenced? Yes

Name of Conservation Agent who supervised plugging of this well Don Truan
Producing formation _____ Depth to top _____ Bottom _____ Total Depth of Well 3406' Feet
Show depth and thickness of all water, oil and gas formations.

OIL, GAS OR WATER RECORDS

CASING RECORD

FORMATION	CONTENT	FROM	TO	SIZE	PUT IN	PULLED OUT

Describe in detail the manner in which the well was plugged, indicating where the mud fluid was placed and the method or methods used in introducing it into the hole. If cement or other plugs were used, state the character of same and depth placed, from _____ feet to _____ feet for each plug set.

Plug # 1 350' 20 sx. cement
Plug # 2 150' 20 sx. cement
Plug # 3 40' 10 sx. cement

Completed: 7 P.M. 2/23/64

RECEIVED
STATE CORPORATION COMMISSION

FEB 25 1964

02-25-1964

CONSERVATION DIVISION
Wichita, Kansas

(If additional description is necessary, use BACK of this sheet)
Name of Plugging Contractor John O. Farmer, Inc.
Address P.O. Box 352, Russell, Kansas

STATE OF KANSAS, COUNTY OF RUSSELL, ss.
WENDEL EARP (employee of owner) or (owner or operator) of the above-described

well, being first duly sworn on oath, says: That I have knowledge of the facts, statements, and matters herein contained and the log of the above-described well as filed and that the same are true and correct. So help me God.

(Signature) Wendell H. Earp
129 East 16th., Russell, Kansas
(Address)

SUBSCRIBED AND SWORN TO before me this 25 day of February, 1964
February 15, 1967
My commission expires _____

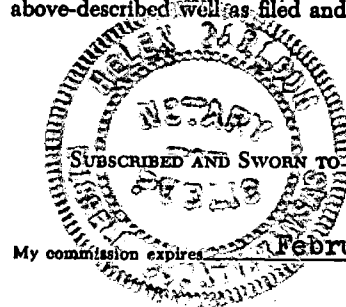

ROBERTS OF HUTCHINSON

Helen Carlson
Notary Public.

RECEIVED
STATE CORPORATION COMMISSION

FEB 28 1964

CONSERVATION DIVISION
Wichita, Kansas

OPERATOR John O. Farmer, Inc.

15-167-00625-00-00
FORMATION RECORD

ADDRESS P.O. Box 352, Russell, Kansas

Give detailed description and thickness of all formation drilled through, contents of sand, whether dry, water, oil or gas.

WELL NO. # 1 COUNTY Russell TWP 138 SEC 30 RGE 15W

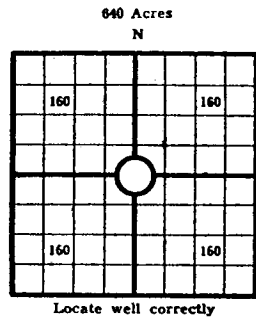

COUNTY Russell, SEC. 30, TWP. 138, RGE. 15W
 COMPANY OPERATING John O. Farmer, Inc.
 OFFICE ADDRESS P.O. Box 352, Russell, Kansas
 DRILLING STARTED 2/14, 1964 DRILLING FINISHED 2/23, 1964
 DATE OF FIRST PRODUCTION _____ COMPLETED _____
 WELL LOCATED SW 1/4 NE 1/4 NE 1/4, North of South Line and _____ ft. East of West Line of Quarter Section
 Elevation (Relative to sea level) DERRICK FLOOR 1923 GROUND, 1900
 CHARACTER OF WELL (Oil, gas or dryhole) Dry

OIL OR GAS SANDS OR ZONES

Name	From	To	Name	From	To
1			4		
2			5		
3			6		

Perforating Record If Any

Shot Record

Formation	From	To	No. of Shots	Formation	From	To	Size of Shot

CASING RECORD

Amount Set						Amount Pulled		Packer Record	
Size	Wt.	Thds.	Make	Ft.	In.	Size	Length	Depth Set	Make

Liner Record: Amount _____ Kind _____ Top _____ Bottom _____

CEMENTING AND MUDDING

Size	Amount Set		Sacks Cement	Chemical		Method of Cementing	Amount	Mudding Method	Results (See Note)
	Ft.	In.		Gal.	Make				
8 5/8	154'		115	ex.					

Note: What method was used to protect sands if outer strings were pulled? _____

NOTE: Were bottom hole plugs used? _____ If so, state kind, depth set and results obtained _____

TOOLS USED

Rotary Tools were used from 0 feet to R.T.D. Cable tools were used from _____ feet to _____ feet, and from _____ feet to _____ feet, and from _____ feet to _____ feet to _____

Type Rig Rotary

INITIAL PRODUCTION TEST

Describe initial test: whether by flow through tubing or casing or by pumping _____

Amount of Oil Production _____ bbls. Size of choke, if any _____ Length of test _____ Water Production _____ bbls. Gravity of oil _____ Type of Pump if pump is used, describe _____

Formation	Top	Bottom	Formation	Top	Bottom
Sub-surface					
Sand	535	625			
Shale	625	670			
Red-bed	670	1025			
Shale & Shells	1025	1845			
Lime	1845	2080			
Lime & Shale	2080	2320			
Shale & Lime	2320	2915			
Lime & Shale	2915	3186			
Lime	3186	3285			
Lime & Shale	3285	3330			
Lime	3330	3360			
Lime & Shale	3360	3406			
R.T.D.	3406'				

Log Tops

Topeka	2837'	(- 912)
Heebner	3061'	(-1136)
Toronto	3080'	(-1155)
Lansing	3108'	(-1183)
Conglomerate	3361'	(-1436)
Arbuckle	3390'	(-1465)
L.T.D.	3405'	(-1480)

RECEIVED
 STATE CORPORATION COMMISSION
 FEB 25 1964
 02-25-1964
 CONSERVATION DIVISION
 Wichita, Kansas

I, the undersigned, being first duly sworn upon oath, state that this well record is true, correct and complete according to the records of this office and to the best of my knowledge and belief.

Mendel H. Earp
 Name and title of representative of company
 Sect. Treas.

Subscribed and sworn to before me this 24 day of February, 1964

My Commission expires 2/15/67

Helen Carlson Notary Public.

FARM NAME POLCYN