

KANSAS CORPORATION COMMISSION
OIL & GAS CONSERVATION DIVISION

Form ACO-4
Form must be typed
July 2006

APPLICATION FOR COMMINGLING OF
PRODUCTION (K.A.R. 82-3-123) OR FLUIDS (K.A.R. 82-3-123a)

Commingling ID # CO10 0801

Operator Information:

License #: 4767
Name: Ritchie Exploration, Inc.
Address: P.O. Box 783188
City/State/Zip: Wichita, KS 67278-3188
Contact Person: John Niernberger
Phone #: 316-691-9500

Well Information:

API #: 15 - 137-20475-0000
Lease Name: Wyrill-Circle Well #: 1
Spot: C - S/2 - S/2 - SW Sec. 34 Twp. 5 S. R. 23 East
County: Norton West
Feet from North / South Line of Section: 104
Feet from East / West Line of Section: 1227

1. Name and upper and lower limit of each production interval to be commingled:

Formation: Toronto (Perfs): 3510' - 3513'
Formation: LKC-A (Perfs): 3526' - 3530'
Formation: LKC-H (Perfs): 3644' - 3646'
Formation: _____ (Perfs): _____
Formation: _____ (Perfs): _____

2. Estimated amount of fluid production to be commingled from each interval:

Formation: Toronto BOPD: 20.33 MCFPD: _____ BWPD: 0.00
Formation: LKC-A BOPD: 21.45 MCFPD: _____ BWPD: 0.00
Formation: LKC-H BOPD: 26.72 MCFPD: _____ BWPD: 102.75
Formation: _____ BOPD: _____ MCFPD: _____ BWPD: _____
Formation: _____ BOPD: _____ MCFPD: _____ BWPD: _____

3. Plat map showing the location of the subject well, all other wells on the subject lease, and all wells on offsetting leases within a 1/2 mile radius of the subject well, and for each well the names and addresses of the lessee of record or operator.

4. Signed certificate showing service of the application and affidavit of publication as required in K.A.R. 82-3-135a.

RECEIVED
KANSAS CORPORATION COMMISSION

OCT 01 2008

CONSERVATION DIVISION
WICHITA, KS

For Commingling of PRODUCTION ONLY, include the following:

- 5. Wireline log of subject well.
- 6. Complete Form ACO-1 (Well Completion form) for the subject well.

For Commingling of FLUIDS ONLY, include the following:

- _____ 5. Well construction diagram of subject well.
- _____ 6. Any available water chemistry data demonstrating the compatibility of the fluids to be commingled.

State of Kansas)
)
County of Sedgwick)

ss:

RONDA MESSER
NOTARY PUBLIC
STATE OF KANSAS
My Appt. Exp. 5/7/12

VERIFICATION: I hereby certify that to the best of my current information, knowledge and personal belief, this request for commingling is true and proper and I have no information or knowledge, which is inconsistent with the information supplied in this application.

Signature: [Signature]
Printed Name: John C. Niernberger
Title: Production Manager

Subscribed & sworn to before me this 30th day of September, 20 08
Notary Public: Ronda Messer
My Commission Expires: 5/7/2012

Protests may be filed by any party having a valid interest in the application. Protests must be in writing and comply with K.A.R. 82-3-135b and must be filed within 15 days of publication of the notice of application.

KCC Office Use Only
 Denied Approved
KCC Date Received: _____ 15-Day Periods Ends: _____
Approved By: _____ Date: _____

October 26, 2010

John Niernberger
Ritchie Exploration, Inc.
PO Box 783188
Wichita, KS 67278-3188

RE: Approved Commingling CO100801
Wyrill-Circle #1, Sec. 34-T5S-R23W, Norton County
API No. 15-137-20475-00-00

Dear Mr. Niernberger:

Your Application for Commingling (ACO-4) for the above described well has been reviewed and approved by the Kansas Corporation Commission (KCC) per K.A.R. 82-3-123. Notice was examined and found to be proper per K.A.R. 82-3-135a. No protest had been filed within the 15-day protest period. This application, which was received by the KCC on October 1, 2008 concerns approval to simultaneously produce from the following sources of supply through the same tubing string in the same wellbore:

Source of Supply	Estimated Current Production			Perf Depth
	BOPD	MCFPD	BWPD	
Toronto	20.33	0	0	3510-3513
LKC-A	21.45	0	0	3526-3530
LKC-H	26.72	0	102.75	3644-3646
Total Estimated Current Production	68.50	0	102.75	

Based upon the depth of the LKC-H formation perforations, total oil production shall not exceed 100 BOPD and total gas production shall not exceed 50% of the absolute open flow (AOF).

Commingling ID number CO100801 has been assigned to this approved application. Use this number for well completion reports (ACO-1) and other correspondence that may concern this approved commingling.

Sincerely,



Rick Hestermann
Production Department

*Rec'd
10-6-10*

R 23 W

H
5
S

H
6
S

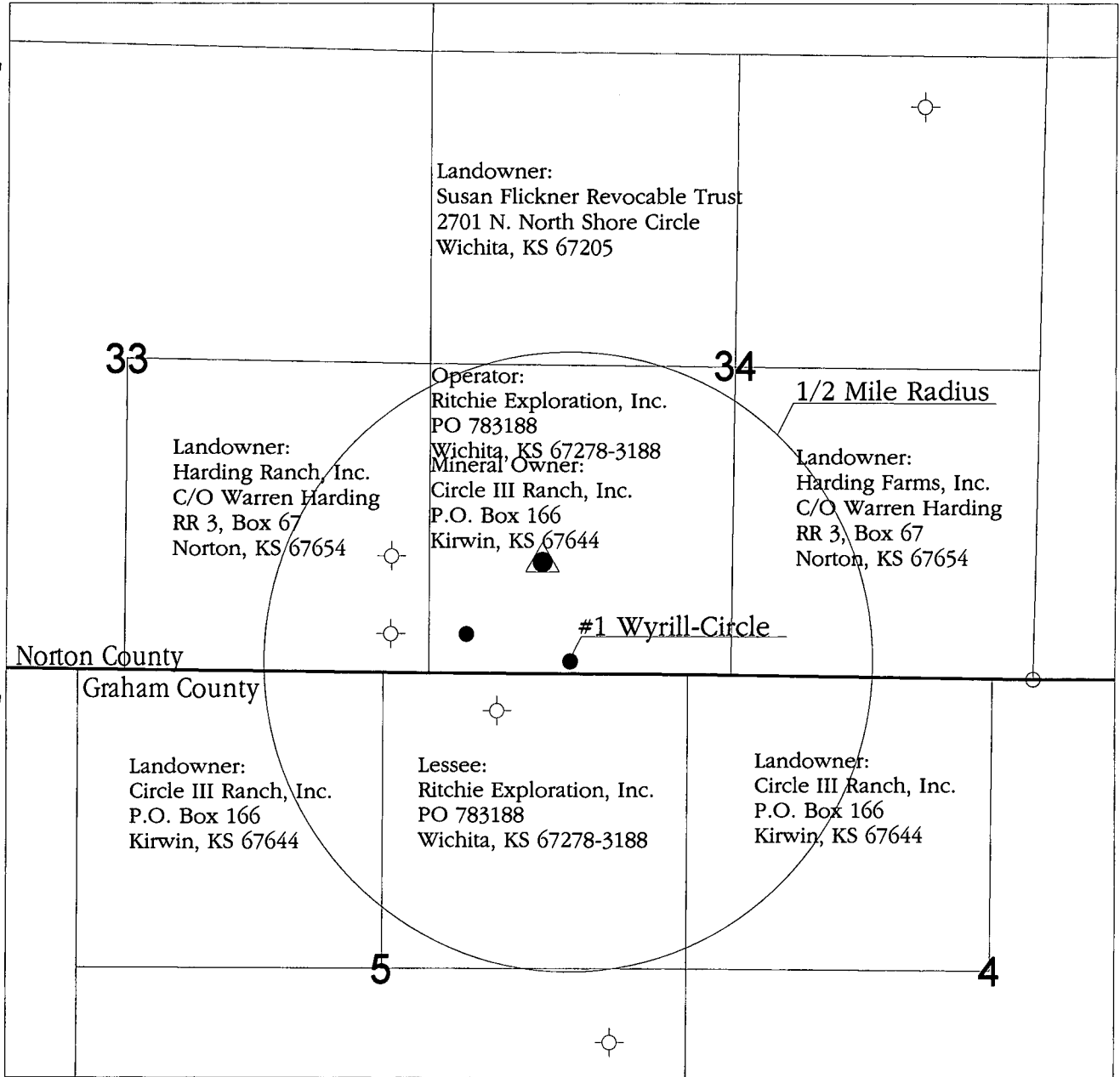

- Legend**
- Oil Well
 - ▲ Service Well / Was Oil Well
 - Dry and Abandoned Well



RITCHIE
EXPLORATION, INC.
Wichita, Kansas

**Application for
Commingling of
Production or Fluids**

Applicant Well: #1 Wyrill-Circle
Wells on Offsetting Leases within 1/2 Mile Radius
Name and Address of Lessee of Record or Operator

Graham / Norton County Kansas

Prepared By: Justin Clegg	Scale: 1 : 17,000	Date: September 26, 2008
------------------------------	----------------------	-----------------------------

RECEIVED
KANSAS CORPORATION COMMISSION

OCT 01 2008

CONSERVATION DIVISION
WICHITA, KS



February 14, 2008

Norton Daily Telegram
213 S. Kansas
Norton, KS 67654

Please publish the described notice as shown below in the legal section of your newspaper one time at the earliest publishing date possible. Please mail a copy of the affidavit of publication to me at the above address along with your invoice for the fee. We will then mail the remittance by return mail upon receipt of that invoice.

Please call if you have any questions. Thank you for your help in this matter.

Sincerely,

John Niernberger
Production Manager

LEGAL NOTICE

You, and each of you, are hereby notified that Ritchie Exploration, Inc. has filed an application to commence the commingling of production from the Toronto, Lansing-Kansas City "A" and Lansing-Kansas City "H" sources of supply for the #1 Wyrill-Circle well located approx C S/2 S/2 SW of Sec. 34-5S-23W, Norton County, Kansas.

Any persons who object to or protest this application shall be required to file their objections or protests with the Conservation Division of the State Corporation Commission of the State of Kansas within fifteen (15) days from the date of the publication. These protests shall be filed pursuant to Commission regulations and must state specific reasons why the grant of the application may cause waste, violate correlative rights or pollute the natural resources of the state of Kansas. If no protests are received, this application may be granted through a summary proceeding. If valid protests are received, this matter will be set for hearing.

All persons interested or concerned shall take notice of the foregoing and shall govern themselves accordingly.

RITCHIE EXPLORATION, INC.
P.O. Box 783188
Wichita, KS 67278-3188
(316) 691-9500

RECEIVED
KANSAS CORPORATION COMMISSION

OCT 01 2008

CONSERVATION DIVISION
WICHITA, KS



September 30, 2008

The Wichita Eagle
825 E. Douglas
Wichita, KS 67202

Please publish the described notice as shown below in the legal section of your newspaper one time at the earliest publishing date possible. Please mail a copy of the affidavit of publication to me at the above address along with your invoice for the fee. We will then mail the remittance by return mail upon receipt of that invoice.

Please call if you have any questions. Thank you for your help in this matter.

Sincerely,

John Niernberger
Production Manager

LEGAL NOTICE

You, and each of you, are hereby notified that Ritchie Exploration, Inc. has filed an application to commence the commingling of production from the Toronto, Lansing-Kansas City "A" and Lansing-Kansas City "H" sources of supply for the #1 Wyrill-Circle well located approx C S/2 S/2 SW of Sec. 34-5S-23W, Norton County, Kansas.

Any persons who object to or protest this application shall be required to file their objections or protests with the Conservation Division of the State Corporation Commission of the State of Kansas within fifteen (15) days from the date of the publication. These protests shall be filed pursuant to Commission regulations and must state specific reasons why the grant of the application may cause waste, violate correlative rights or pollute the natural resources of the state of Kansas. If no protests are received, this application may be granted through a summary proceeding. If valid protests are received, this matter will be set for hearing.

All persons interested or concerned shall take notice of the foregoing and shall govern themselves accordingly.

RITCHIE EXPLORATION, INC.
P.O. Box 783188
Wichita, KS 67278-3188
(316) 691-9500

RECEIVED
KANSAS CORPORATION COMMISSION

OCT 01 2008

CONSERVATION DIVISION
WICHITA, KS



September 30, 2008

Warren Harding
Harding Ranch, Inc.
R.R. 3 Box 67
Norton, KS 67654

To Whom It May Concern:

Enclosed please find Ritchie Exploration, Inc.'s Application for Wellbore Commingling of fluids from the Toronto, Lansing-Kansas City "A" and Lansing-Kansas City "H" sources of supply for the #1 Wyrill-Circle well located approx C S/2 S/2 SW of Sec. 34-5S-23W, Norton County, Kansas.

All oil/gas operators in Kansas are required by the Kansas Corporation Commission Regulations #82-3-123a and #82-3-135a(b) to notify each operator, lessee, or unleased mineral owner within one-half mile radius of the subject well.

No response is required, but if you should have a valid protest, it should be directed to the KCC office in Wichita, Kansas.

If you have any questions, please feel free to call John Niernberger at 316-691-9500.
Thanks for your time.

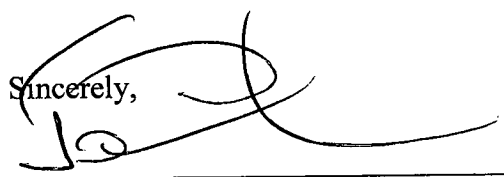
Sincerely,

John Niernberger, Production Manager

Date this application and certificate was mailed : 09/30/2008

STATE OF KANSAS)
COUNTY OF SEDGWICK) SS

This instrument was acknowledged before me on September 30, 2008 by John Niernberger as Production Manager of Ritchie Exploration, Inc., on behalf of said corporation.

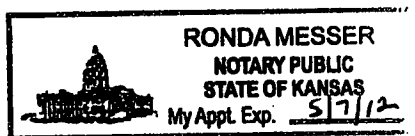

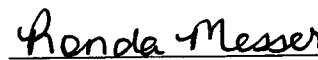
Ronda Messer, Notary Public
My commission expires: 05/07/2012

P.O. Box 783188
Wichita, Kansas 67278-3188

(316) 691-9500
Fax (316) 691-9550
rei@ritchie-exp.com

8100 E. 22nd St. N., Bldg. 700
Wichita, Kansas 67226-2328

RECEIVED
KANSAS CORPORATION COMMISSION

OCT 01 2008

CONSERVATION DIVISION
WICHITA, KS



September 30, 2008

Susan Flickner Revocable Trust
2701 N. North Shore Circle
Wichita, KS 67205

To Whom It May Concern:

Enclosed please find Ritchie Exploration, Inc.'s Application for Wellbore Commingling of fluids from the Toronto, Lansing-Kansas City "A" and Lansing-Kansas City "H" sources of supply for the #1 Wyrill-Circle well located approx C S/2 S/2 SW of Sec. 34-5S-23W, Norton County, Kansas.

All oil/gas operators in Kansas are required by the Kansas Corporation Commission Regulations #82-3-123a and #82-3-135a(b) to notify each operator, lessee, or unleased mineral owner within one-half mile radius of the subject well.

No response is required, but if you should have a valid protest, it should be directed to the KCC office in Wichita, Kansas.

If you have any questions, please feel free to call John Niernberger at 316-691-9500.
Thanks for your time.

Sincerely,

John Niernberger, Production Manager

Date this application and certificate was mailed : 09/30/2008

STATE OF KANSAS)
COUNTY OF SEDGWICK) SS

This instrument was acknowledged before me on September 30, 2008 by John Niernberger as Production Manager of Ritchie Exploration, Inc., on behalf of said corporation.

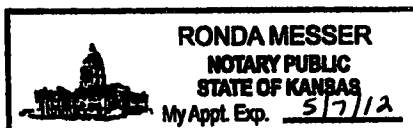

Ronda Messer

Ronda Messer, Notary Public
My commission expires: 05/07/2012

RECEIVED
KANSAS CORPORATION COMMISSION

OCT 01 2008

CONSERVATION DIVISION
WICHITA, KS



September 30, 2008

Circle III Ranch, Inc.
P.O. Box 166
Kirwin, KS 67644

To Whom It May Concern:

Enclosed please find Ritchie Exploration, Inc.'s Application for Wellbore Commingling of fluids from the Toronto, Lansing-Kansas City "A" and Lansing-Kansas City "H" sources of supply for the #1 Wyrill-Circle well located approx C S/2 S/2 SW of Sec. 34-5S-23W, Norton County, Kansas.

All oil/gas operators in Kansas are required by the Kansas Corporation Commission Regulations #82-3-123a and #82-3-135a(b) to notify each operator, lessee, or unleased mineral owner within one-half mile radius of the subject well.

No response is required, but if you should have a valid protest, it should be directed to the KCC office in Wichita, Kansas.

If you have any questions, please feel free to call John Niernberger at 316-691-9500.
Thanks for your time.

Sincerely,

John Niernberger, Production Manager

RECEIVED
KANSAS CORPORATION COMMISSION

Date this application and certificate was mailed : 09/30/2008

OCT 01 2008

STATE OF KANSAS)
COUNTY OF SEDGWICK) SS

CONSERVATION DIVISION
WICHITA, KS

This instrument was acknowledged before me on September 30, 2008 by John Niernberger as Production Manager of Ritchie Exploration, Inc., on behalf of said corporation.

Ronda Messer

Ronda Messer, Notary Public
My commission expires: 05/07/2012

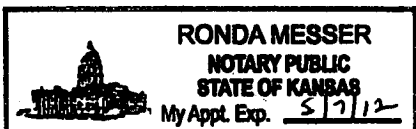

P.O. Box 783188
Wichita, Kansas 67278-3188

(316) 691-9500
Fax (316) 691-9550
rei@ritchie-exp.com

8100 E. 22nd St. N., Bldg. 700
Wichita, Kansas 67226-2328

APPLICATION FOR COMMINGLING OF PRODUCTION OR FLUIDS

**Operator, Lessee or Unleased Mineral Owner
within a ½ mile radius of Ritchie Exploration, Inc.'s**

**#1 Wyrill-Circle
104' FSL & 1227' FWL
Section 34-5S-23W
Norton Co., KS**

Township 5 South, Range 23 West Norton Co., KS

Sec. 33:	SE/4	Harding Ranch, Inc. c/o Warren Harding RR 3, Box 67 Norton, KS 67654	Landowner
Sec. 34:	NW/4	Susan Flickner Revocable Trust 2701 N. North Shore Circle Wichita, KS 67205	Landowner
	SW/4	Ritchie Exploration, Inc.	Operator: #1 Wyrill P #2 Wyrill P SWDW
		Ritchie Exploration, Inc.	Operator: #1 Wyrill-Circle
		Circle III Ranch, Inc. P.O. Box 166 Kirwin, KS 67644	Mineral Owner
	SE/4	Harding Farms, Inc. c/o Warren Harding RR 3, Box 67 Norton, KS 67654	Landowner

Township 6 South, Range 23 West Graham Co., KS

Sec. 4:	NW/4	Circle III Ranch, Inc.	Landowner
Sec. 5:	NE/4	Ritchie Exploration, Inc.	Lessee
	NW/4	Circle III Ranch, Inc.	Landowner

RECEIVED
KANSAS CORPORATION COMMISSION
OCT 01 2008
CONSERVATION DIVISION
WICHITA, KS

Proof of Publication

State of Kansas
NORTON COUNTY

Sherry Hickman of lawful age, being duly sworn upon oath, states that he/she is the designated representative of the Norton Telegram.

Published in The Norton Telegram on Friday, October 3, 2008

LEGAL NOTICE

You, and each of you, are hereby notified that Ritchie Exploration, Inc. has filed an application to commence the commingling of production from the Toro Lansing-Kansas City "A" and Lansing-Kansas City "H" sources of supply for #1 Wyrill-Circle well located approx. C S/2 S/2 SW of Sec. 34-5S-23W, Norton County, Kansas.

THAT said newspaper has been published at least one hundred (100) times a year and has been so published for at least one year prior to the first publication of the attached notice:

Any persons who object to or protest this application shall be required to file their objections or protests with the Conservation Division of the State Corporation Commission of the State of Kansas within fifteen (15) days from the date of publication. These protests shall be filed pursuant to Commission regulations. These protests must state specific reasons why the grant of the application may cause a violation of correlative rights or pollute the natural resources of the state of Kansas. If no protests are received, this application may be granted through a summary proceeding. If valid protests are received, this matter will be set for hearing.

THAT said paper was entered as second class mail matter at the post office of its publication:

All persons interested or concerned shall take notice of the foregoing and govern themselves accordingly.

THAT said paper has a general paid circulation in NORTON County, Kansas, and is NOT a trade, religious or fraternal publication and has been published in NORTON County, Kansas.

RITCHIE EXPLORATION, INC.
P.O. Box 783
Wichita, Kansas 67278-3
(313) 691-9

THE ATTACHED was published on the following dates in a regular issue of the said newspaper:

- 1st publication was made on the 3 day of October, 2008
- 2nd publication was made on the _____ day of _____, 2008
- 3rd publication was made on the _____ day of _____, 2008
- 4th publication was made on the _____ day of _____, 2008
- 5th publication was made on the _____ day of _____, 2008

<u>5</u> " Publication fee	\$ <u>28.30</u>
Affidavit, Notary's fees	\$ _____
Additional copies	\$ _____
TOTAL publication fees	\$ <u>28.30</u>

(Sign) Sherry Hickman

Witness my hand this 31st day of August, 2010

SUBSCRIBED and Sworn to before me this 31st day of August, 2010. State of Kansas, County of Norton.

Daide D. Engel
Chief Clerk

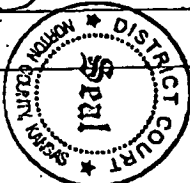

RECEIVED
OCT 22 2010
KCC WICHITA

AFFIDAVIT

STATE OF KANSAS \
- SS.
County of Sedgwick /

Nicole Mandina, of lawful age, being first duly sworn, deposeth and saith: That she is Record Clerk of The Wichita Eagle, a daily newspaper published in the City of Wichita, County of Sedgwick, State of Kansas, and having a general paid circulation on a daily basis in said County, which said newspaper has been continuously and uninterruptedly published in said County for more than one year prior to the first publication of the notice hereinafter mentioned, and which said newspaper has been entered as second class mail matter at the United States Post Office in Wichita, Kansas, and which said newspaper is not a trade, religious or fraternal publication and that a notice of a true copy is hereto attached was published in the regular and entire Morning issue of said The Wichita Eagle for 1 issues - weeks, that the first publication of said notice was

made as aforesaid on the 7th of

October A.D. 2008 , with

subsequent publications being made on the following dates:

And affiant further says that she has personal knowledge of the statements above set forth and that they are true.

Nicole Mandina

Subscribed and sworn to before me this

7th day of October, 2008

Michelle L. Shriver
Notary Public Sedgwick County, Kansas

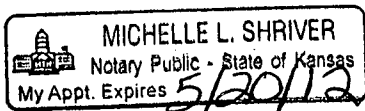

LEGAL PUBLICATION

First Published in the Wichita Eagle
October 7, 2008 (2889684)

LEGAL NOTICE

You, and each of you, are hereby notified that Ritchie Exploration, Inc. has filed an application to commence the commingling of production from the Toronto, Lansing-Kansas City "A" and Lansing-Kansas City "H" sources of supply for the #1 Wyrill-Circle well located approx C 5/2 S/2 SW of Sec. 34-5S-23W, Norton County, Kansas. Any persons who object to or protest this application shall be required to file their objections or protests with the Conservation Division of the State Corporation Commission of the State of Kansas within fifteen (15) days from the date of the publication. These protests shall be filed pursuant to Commission regulations and must state specific reasons why the grant of the application may cause waste, violate correlative rights, or pollute the natural resources of the state of Kansas. If no protests are received, this application may be granted through a summary proceeding. If valid protests are received, this matter will be set for hearing. All persons interested or concerned shall take notice of the foregoing and shall govern themselves accordingly. RITCHIE EXPLORATION, INC. P.O. Box 783188 Wichita, KS 67278-3188 (316)691-9500

RECEIVED

JUL 09 2010

KCC WICHITA



October 21, 2010

Kansas Corporation Commission
Conservation Division
130 S. Market, Room 2078
Wichita, KS 67202

RE: #1 Wyrill-Circle
C S/2 S/2 SW
Sec. 34-5S-23W
Norton County, Kansas

To Whom It May Concern:

Enclosed please find proof of publication from The Norton Telegram. This item is a requirement for the ACO-4 (Application for Commingling) that was previously sent in for the above referenced well.

If you have any questions, please feel free to call the undersigned or John Niernberger at 316-691-9500. Thank you for all of your help in this matter.

Sincerely,

Karen Hopper
Production Assistant

Enclosures

kh

RECEIVED
OCT 22 2010
KCC WICHITA



CO100801

*7-13-2010
Called Karen re:
county Publ.
will send*

July 8, 2010

Kansas Corporation Commission
Conservation Division
130 S. Market, Room 2078
Wichita, KS 67202

RE: #1 Wyrill-Circle
C S/2 S/2 SW
Sec. 34-5S-23W
Norton County, Kansas

To Whom It May Concern:

Enclosed please find proof of publication from The Wichita Eagle. This item is a requirement for the ACO-4 (Application for Commingling) that was previously sent in for the above referenced well.

If you have any questions, please feel free to call the undersigned or John Niernberger at 316-691-9500. Thank you for all of your help in this matter.

Sincerely,

Karen Hopper
Production Assistant

Karen Hopper
Enclosures

RECEIVED
JUL 09 2010
KCC WICHITA



Kathleen Sebelius, Governor
Thomas E. Wright, Chairman
Michael C. Moffet, Commissioner
Joseph F. Harkins, Commissioner

File Cops

March 17, 2009

John Niernberger
Ritchie Exploration, Inc.
PO Box 783188
Wichita, KS 67278-3188

Re: Application for Commingling
Wyrill Circle #1
Sec. 34-T5S-R23W
Norton County

Dear Mr. Niernberger,

The following information is needed to complete the referenced ACO-4, Application for Commingling, submitted on October 1, 2008:

- Affidavit of publication of the application in the Official County Newspaper and the Wichita Eagle Newspaper pursuant to K.A.R. 82-3-135 a (d).

Please return the requested information to my attention.

Sincerely,

A handwritten signature in black ink, appearing to read "Rick Hestermann", with a long horizontal flourish extending to the right.

Rick Hestermann
Production Department



CO 100801

September 30, 2008

Kansas Corporation Commission
Conservation Division
130 S. Market, Room 2078
Wichita, KS 67202

RE: #1 Wyrill-Circle
approx. C S/2 S/2 SW
Sec. 34-5S-23W
Norton County, Kansas

To Whom It May Concern:

Enclosed please find an ACO-4 for the above referenced well. The required attachments have also been enclosed. Ritchie Exploration, Inc. would like for this to be held confidential for the maximum allowable time.

If you have any questions, please feel free to call the undersigned or John Niernberger at 316-691-9500. Thank you for all of your help in this matter.

Sincerely,

Ronda Messer

Ronda Messer
Production Assistant

Enclosures

RECEIVED
KANSAS CORPORATION COMMISSION

OCT 01 2008

CONSERVATION DIVISION
WICHITA, KS