

For KCC Use:
 Effective Date: 1-10-2011
 District # 4
 SGA? Yes No

KANSAS CORPORATION COMMISSION
 OIL & GAS CONSERVATION DIVISION

Form C-1
 March 2010
 Form must be Typed
 Form must be Signed
 All blanks must be Filled

NOTICE OF INTENT TO DRILL

Must be approved by KCC five (5) days prior to commencing well
 Form KSONA-1, Certification of Compliance with the Kansas Surface Owner Notification Act, MUST be submitted with this form.

Expected Spud Date: January 4 2011
month day year

OPERATOR: License# 33335
 Name: IA Operating, Inc.
 Address 1: 9915 West 21st North, Suite 'B'
 Address 2: _____
 City: Wichita State: KS Zip: 67205 + _____
 Contact Person: Robert D. Swann
 Phone: Office 316-721-0036 or cell 660-425-4749

CONTRACTOR: License# 34233
 Name: Maverick Drilling, LLC

Well Drilled For: Oil Gas Seismic; _____ # of Holes Other: _____
 Well Class: Enh Rec Storage Disposal Wildcat Other _____
 Type Equipment: Mud Rotary Air Rotary Cable

If OWWO: old well information as follows:
 Operator: _____
 Well Name: _____
 Original Completion Date: _____ Original Total Depth: _____

Directional, Deviated or Horizontal wellbore? Yes No
 If Yes, true vertical depth: _____
 Bottom Hole Location: _____
 KCC DKT #: _____

Spot Description: _____
 _____ - SE - NW - SE Sec. 8 Twp. 14 S. R. 20 E W
(0/0/0/0) 1,400 feet from N / S Line of Section
1,835 feet from E / W Line of Section

Is SECTION: Regular Irregular?
 (Note: Locate well on the Section Plat on reverse side)

County: Ellis
 Lease Name: Henman Well #: 8-1

Field Name: Edselbet Unnamed
 Is this a Prorated / Spaced Field? Yes No

Target Formation(s): Lansing KC, Arbuckle, Reagan Sand
 Nearest Lease or unit boundary line (in footage): 805 feet

Ground Surface Elevation: 2,175 feet feet MSL
 Water well within one-quarter mile: Yes No
 Public water supply well within one mile: Yes No

Depth to bottom of fresh water: Est. 180
 Depth to bottom of usable water: Est. 750 680
 Surface Pipe by Alternate: I II

Length of Surface Pipe Planned to be set: 200 feet

Length of Conductor Pipe (if any): None
 Projected Total Depth: 4,000 feet

Formation at Total Depth: Reagan Sand

Water Source for Drilling Operations: Well Farm Pond Other: _____
 DWR Permit #: _____

(Note: Apply for Permit with DWR)
 Will Cores be taken? Yes No
 If Yes, proposed zone: _____

RECEIVED
 JAN 05 2011
 KCC WICHITA

AFFIDAVIT

The undersigned hereby affirms that the drilling, completion and eventual plugging of this well will comply with K.S.A. 55 et. seq.
 It is agreed that the following minimum requirements will be met:

1. Notify the appropriate district office **prior** to spudding of well;
2. A copy of the approved notice of intent to drill **shall be posted** on each drilling rig;
3. The minimum amount of surface pipe as specified below **shall be set** by circulating cement to the top; in all cases surface pipe **shall be set** through all unconsolidated materials plus a minimum of 20 feet into the underlying formation.
4. If the well is dry hole, an agreement between the operator and the district office on plug length and placement is **necessary prior to plugging**;
5. The appropriate district office will be notified before well is either plugged or production casing is cemented in;
6. If an ALTERNATE II COMPLETION, production pipe shall be cemented from below any usable water to surface within **120 DAYS** of spud date. Or pursuant to Appendix "B" - Eastern Kansas surface casing order #133,891-C, which applies to the KCC District 3 area, alternate II cementing must be completed within 30 days of the spud date or the well shall be plugged. **In all cases, NOTIFY district office** prior to any cementing.

I hereby certify that the statements made herein are true and to the best of my knowledge and belief.

Date: January 4, 2011 Signature of Operator or Agent: Robert Swann Title: Vice President

For KCC Use ONLY
 API # 15 - 051-26081-0000
 Conductor pipe required None feet
 Minimum surface pipe required 200 feet per ALT. I II
 Approved by: RMS 1-5-2011
 This authorization expires: 1-5-2012
(This authorization void if drilling not started within 12 months of approval date.)
 Spud date: _____ Agent: _____

Remember to:

- File Certification of Compliance with the Kansas Surface Owner Notification Act (KSONA-1) with Intent to Drill;
- File Drill Pit Application (form CDP-1) with Intent to Drill;
- File Completion Form ACO-1 within 120 days of spud date;
- File acreage attribution plat according to field proration orders;
- Notify appropriate district office 48 hours prior to workover or re-entry;
- Submit plugging report (CP-4) after plugging is completed (within 60 days);
- Obtain written approval before disposing or injecting salt water.
- If well will not be drilled or permit has expired (See: authorized expiration date) please check the box below and return to the address below.

Well will not be drilled or Permit Expired Date: _____
 Signature of Operator or Agent: _____

Mail to: KCC - Conservation Division,
 130 S. Market - Room 2078, Wichita, Kansas 67202

8
14
20
 m
 W

Side Two

For KCC Use ONLY

API # 15 - 051-260870000

IN ALL CASES PLOT THE INTENDED WELL ON THE PLAT BELOW

In all cases, please fully complete this side of the form. Include items 1 through 5 at the bottom of this page.

Operator: LA Operating Inc.
Lease: Henman
Well Number: 8-1
Field: Ed Seibel

Location of Well: County: Ellis
1,400 feet from N / S Line of Section
1,835 feet from E / W Line of Section
Sec. 8 Twp. 14 S. R. 20 E W

Number of Acres attributable to well: 10 acres
QTR/QTR/QTR/QTR of acreage: SE - NW - SE 1/4

Is Section: Regular or Irregular

If Section is Irregular, locate well from nearest corner boundary.
Section corner used: NE NW SE SW

PLAT

Show location of the well. Show footage to the nearest lease or unit boundary line. Show the predicted locations of lease roads, tank batteries, pipelines and electrical lines, as required by the Kansas Surface Owner Notice Act (House Bill 2032). You may attach a separate plat if desired.

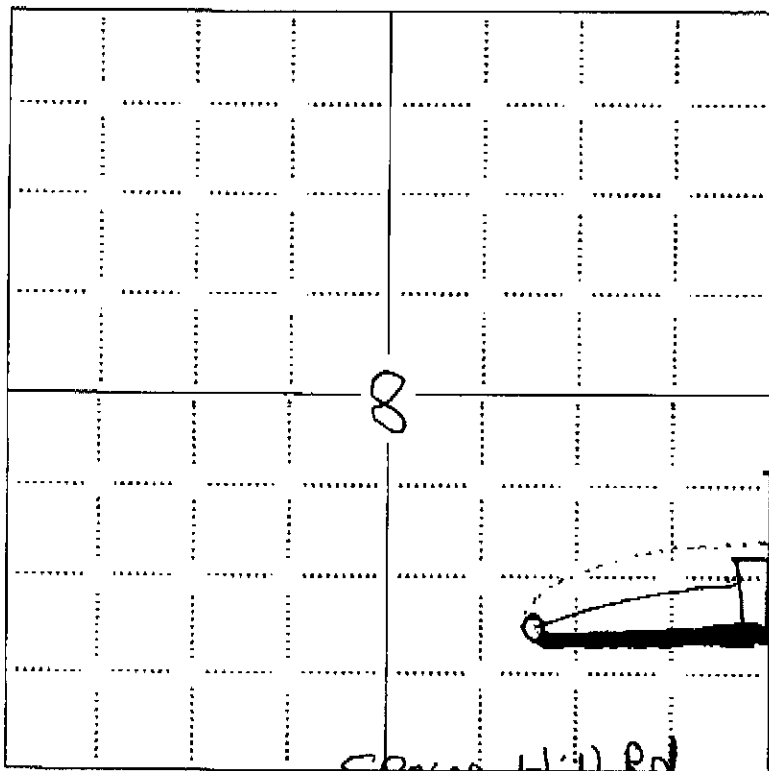

LEGEND

- Well Location
- Tank Battery Location
- Pipeline Location
- Electric Line Location
- Lease Road Location

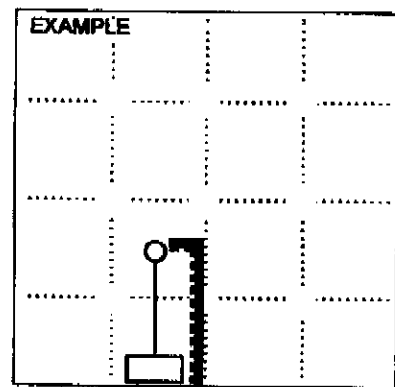

1980' FSL

NOTE: In all cases locate the spot of the proposed drilling location.

RECEIVED
JAN 05 2011

In plotting the proposed location of the well, you must show:

1. The manner in which you are using the depicted plat by identifying section lines, i.e. 1 section, 1 section with 8 surrounding sections, 4 sections, etc.
2. The distance of the proposed drilling location from the south / north and east / west outside section lines.
3. The distance to the nearest lease or unit boundary line (in footage).
4. If proposed location is located within a prorated or spaced field a certificate of acreage attribution plat must be attached: (CO-7 for oil wells; CG-8 for gas wells).
5. The predicted locations of lease roads, tank batteries, pipelines and electrical lines.

KCC WICHITA

I.A. OPERATING, INC.
HENMAN LEASE
SE. 1/4, SECTION 8, T14S, R20W
ELLIS COUNTY, KANSAS

15-051-26 081-00-00

GRAVEL (GOLF COURSE RD.) ROAD

Notes:

1. Set iron rod at location site.
2. All flagging Red & Yellow.
3. Overhead power available at S. & E. lines, Sec. 8.
4. Kansas One Call System Inc. should be notified before excavation (1-800-344-7233).
5. CAUTION; Various pipelines in Sec. 8.
6. Cattle in pasture at date of staking.
7. Contact landowner for best access.

*Ingress and egress to location as shown on this plat is per usage only and may not be legally opened for public use. Contact landowner, tenant and county road department for access.

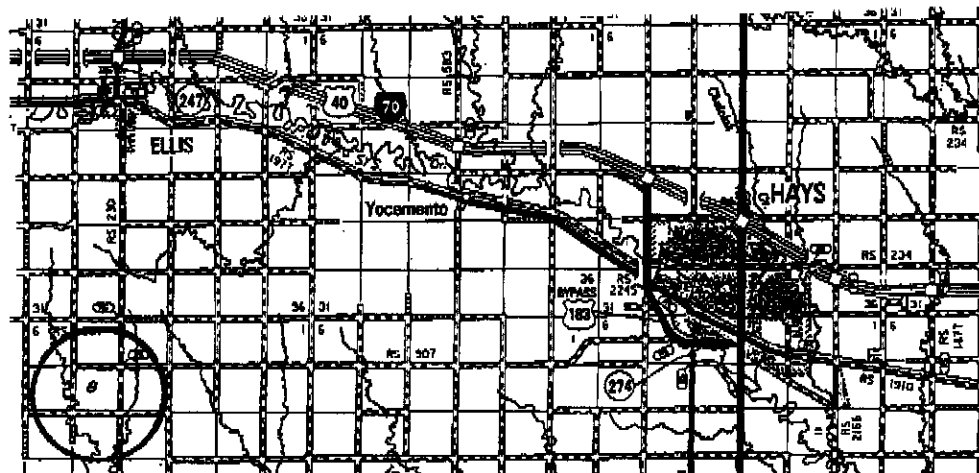
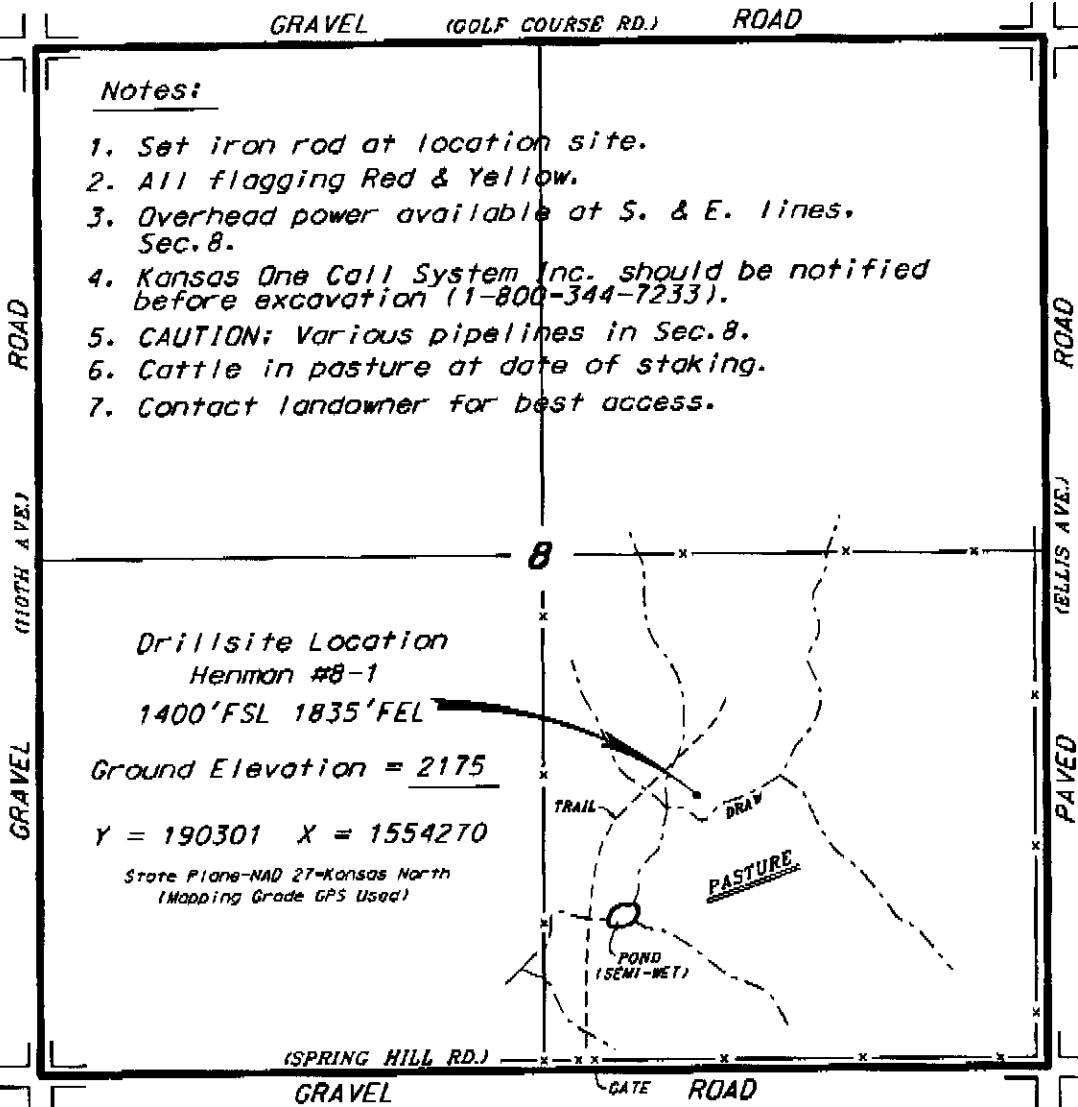

RECEIVED
JAN 05 2011
KCC WICHITA

• Controlling data is based upon the best maps and photographs available to us and upon a regular section of land containing 640 acres.

• Appropriate section lines were determined using the normal standard of care of oilfield surveyors practicing in the state of Kansas. The section corners, which establish the precise section lines, were not necessarily located, and the exact location of the drillsite location in the section is not guaranteed. Therefore, the operator accepting this service and accepting this plat and all other parties relying thereon agree to hold Central Kansas Oilfield Services, Inc., its officers and employees harmless from all losses, costs and expenses and said entities released from any liability from incidental or consequential damages.

Date December 30, 2010

CERTIFICATION OF COMPLIANCE WITH THE KANSAS SURFACE OWNER NOTIFICATION ACT

This form must be submitted with all Forms C-1 (Notice of Intent to Drill); CB-1 (Cathodic Protection Borehole Intent); T-1 (Request for Change of Operator Transfer of Injection or Surface Pit Permit); and CP-1 (Well Plugging Application). Any such form submitted without an accompanying Form KSONA-1 will be returned.

Select the corresponding form being filed: C-1 (Intent) CB-1 (Cathodic Protection Borehole Intent) T-1 (Transfer) CP-1 (Plugging Application)

OPERATOR: License # 33335
Name: I A Operating, Inc.
Address 1: 9915 West 21st North, Suite 'B'
Address 2: _____
City: Wichita State: KS Zip: 67205 + _____
Contact Person: Robert D. Swann
Phone: (660) 425-4749 Fax: (316) 721-0047
Email Address: bobswann@imperialamericanoil.com

Well Location:
SE NW SE Sec. 8 Twp. 14 S. R. 20 East West
County: Ellis
Lease Name: Henman Well #: 8-1

If filing a Form T-1 for multiple wells on a lease, enter the legal description of the lease below:

Surface Owner Information:

Name: Perry S. Henman
Address 1: 1300 Washington
Address 2: _____
City: Ellis State: KS Zip: 67636 + _____

When filing a Form T-1 involving multiple surface owners, attach an additional sheet listing all of the information to the left for each surface owner. Surface owner information can be found in the records of the register of deeds for the county, and in the real estate property tax records of the county treasurer.

If this form is being submitted with a Form C-1 (Intent) or CB-1 (Cathodic Protection Borehole Intent), you must supply the surface owners and the KCC with a plat showing the predicted locations of lease roads, tank batteries, pipelines, and electrical lines. The locations shown on the plat are preliminary non-binding estimates. The locations may be entered on the Form C-1 plat, Form CB-1 plat, or a separate plat may be submitted.

Select one of the following:

- I certify that, pursuant to the Kansas Surface Owner Notice Act (House Bill 2032), I have provided the following to the surface owner(s) of the land upon which the subject well is or will be located: 1) a copy of the Form C-1, Form CB-1, Form T-1, or Form CP-1 that I am filing in connection with this form; 2) if the form being filed is a Form C-1 or Form CB-1, the plat(s) required by this form; and 3) my operator name, address, phone number, fax, and email address.
- I have not provided this information to the surface owner(s). I acknowledge that, because I have not provided this information, the KCC will be required to send this information to the surface owner(s). To mitigate the additional cost of the KCC performing this task, I acknowledge that I am being charged a \$30.00 handling fee, payable to the KCC, which is enclosed with this form.

If choosing the second option, submit payment of the \$30.00 handling fee with this form. If the fee is not received with this form, the KSONA-1 form and the associated Form C-1, Form CB-1, Form T-1, or Form CP-1 will be returned.

I hereby certify that the statements made herein are true and correct to the best of my knowledge and belief.

Date: January 4, 2011 Signature of Operator or Agent: Robert D. Swann Title: Vice President

RECEIVED

JAN 05 2011

KCC WICHITA

**KANSAS CORPORATION COMMISSION
OIL & GAS CONSERVATION DIVISION
APPLICATION FOR SURFACE PIT**

Form CDP-1
May 2010
Form must be Typed

Submit in Duplicate

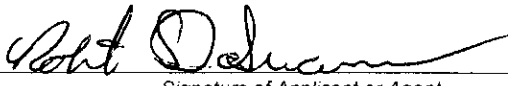
Operator Name: I A Operating, Inc.		License Number: 33335
Operator Address: 9915 West 21st North, Suite 'B'		Wichita KS 67205
Contact Person: Robert D. Swann		Phone Number: Office 316-721-0036 or cell 660-425-4749
Lease Name & Well No.: Henman 8-1		Pit Location (QQQQ): SW SE NW SE
Type of Pit: <input type="checkbox"/> Emergency Pit <input type="checkbox"/> Burn Pit <input type="checkbox"/> Settling Pit <input checked="" type="checkbox"/> Drilling Pit <input type="checkbox"/> Workover Pit <input type="checkbox"/> Haul-Off Pit <small>(If WP Supply API No. or Year Drilled)</small>	Pit is: <input checked="" type="checkbox"/> Proposed <input type="checkbox"/> Existing If Existing, date constructed: Pit capacity: 600 (bbls)	Sec. 8 Twp. 14 R. 20 <input type="checkbox"/> East <input checked="" type="checkbox"/> West 1400 Feet from <input type="checkbox"/> North / <input checked="" type="checkbox"/> South Line of Section 835 Feet from <input checked="" type="checkbox"/> East / <input type="checkbox"/> West Line of Section Ellis County
Is the pit located in a Sensitive Ground Water Area? <input type="checkbox"/> Yes <input checked="" type="checkbox"/> No		Chloride concentration: _____ mg/l <small>(For Emergency Pits and Settling Pits only)</small>
Is the bottom below ground level? <input checked="" type="checkbox"/> Yes <input type="checkbox"/> No	Artificial Liner? <input checked="" type="checkbox"/> Yes <input type="checkbox"/> No	How is the pit lined if a plastic liner is not used?
Pit dimensions (all but working pits): 100 Length (feet) 125 Width (feet) <input type="checkbox"/> N/A: Steel Pits Depth from ground level to deepest point: 4 (feet) <input type="checkbox"/> No Pit		
If the pit is lined give a brief description of the liner material, thickness and installation procedure. Lined with 10 mil. Plastic		Describe procedures for periodic maintenance and determining liner integrity, including any special monitoring. Inspected Daily
Distance to nearest water well within one-mile of pit: 4288 feet Depth of water well 38 feet		Depth to shallowest fresh water 180-25 feet. Source of information: <input type="checkbox"/> measured <input type="checkbox"/> well owner <input type="checkbox"/> electric log <input checked="" type="checkbox"/> KDWR
Emergency, Settling and Burn Pits ONLY: Producing Formation: _____ Number of producing wells on lease: _____ Barrels of fluid produced daily: _____ Does the slope from the tank battery allow all spilled fluids to flow into the pit? <input type="checkbox"/> Yes <input type="checkbox"/> No		Drilling, Workover and Haul-Off Pits ONLY: Type of material utilized in drilling/workover: MUD Number of working pits to be utilized: 4 Abandonment procedure: Allow to Dry & Backfill & Level Drill pits must be closed within 365 days of spud date.
I hereby certify that the above statements are true and correct to the best of my knowledge and belief.		RECEIVED JAN 05 2011 KCC WICHITA
<u>January 4, 2011</u> Date	 Signature of Applicant or Agent	

15-051-26081-00700

KCC OFFICE USE ONLY			
Date Received: 1-5-11	Permit Number: _____	Permit Date: 1-5-11	Lease Inspection: <input type="checkbox"/> Yes <input checked="" type="checkbox"/> No
<input type="checkbox"/> Liner <input type="checkbox"/> Steel Pit <input type="checkbox"/> RFAC <input type="checkbox"/> RFAS			

Mail to: KCC - Conservation Division, 130 S. Market - Room 2078, Wichita, Kansas 67202