

Give All Information Completely
Make Required Affidavit
Mail or Deliver Report to:
Conservation Division
State Corporation Commission
211 No. Broadway
Wichita, Kansas

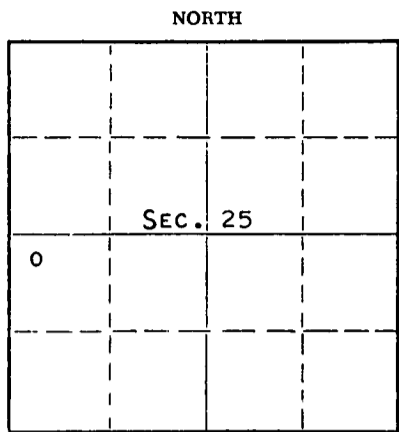

Locate well correctly on above Section Plat

ELLIS County. Sec. 25 Twp. 13 Rge. 17 (E) W (W)
Location as "NE/CNW/SW" or footage from lines NW NW SW
Lease Owner PETROLEUM INC.
Lease Name DREILING Well No. 1
Office Address ROUTE 2, GREAT BEND, KANSAS
Character of Well (completed as Oil, Gas or Dry Hole) DRY HOLE
Date well completed JANUARY 8 19 57
Application for plugging filed JANUARY 8 19 57
Application for plugging approved JANUARY 8 19 57
Plugging commenced JANUARY 8 19 57
Plugging completed JANUARY 8 19 57
Reason for abandonment of well or producing formation NO PRODUCIBLE ZONES

If a producing well is abandoned, date of last production NONE 19
Was permission obtained from the Conservation Division or its agents before plugging was commenced? YES

Name of Conservation Agent who supervised plugging of this well ELDON PETTY, BOX 326, HAYS, KANSAS
Producing formation _____ Depth to top _____ Bottom _____ Total Depth of Well 3603 Feet
Show depth and thickness of all water, oil and gas formations.

OIL, GAS OR WATER RECORDS

CASING RECORD

FORMATION	CONTENT	FROM	TO	SIZE	PUT IN	PULLED OUT
				8 5/8" OD	175'	NONE

Describe in detail the manner in which the well was plugged, indicating where the mud fluid was placed and the method or methods used in introducing it into the hole. If cement or other plugs were used, state the character of same and depth placed, from _____ feet to _____ feet for each plug set.

MUD UP WITH HEAVY MUD TO 170', PUSHED DOWN 1/2 SACK HULLS TO 170' FOLLOWED BY WOODEN PLUG PLACED 15 SACKS CEMENT THROUGH DRILL PIPE ON TO PLUG. MUD UP TO 40' AND PLACE 1/2 SACK HULLS AT 40' FOLLOWED BY WOODEN PLUG AND 10 SACKS CEMENT TO BASE OF WELL CELLAR.

(If additional description is necessary, use BACK of this sheet)
Name of Plugging Contractor GARVEY DRILLING COMPANY
Address ROUTE 2, GREAT BEND, KANSAS

STATE OF KANSAS, COUNTY OF BARTON, ss.
DON SEARLE (employee of owner) or (OWNER) of the above-described well, being first duly sworn on oath, says: That I have knowledge of the facts, statements, and matters herein contained and the log of the above-described well as filed and that the same are true and correct. So help me God.

(Signature) Don Searle
ROUTE 2, GREAT BEND, KANSAS
(Address)

SUBSCRIBED AND SWORN TO before me this 21ST day of JANUARY 19 57

Ed J. Brewer
Notary Public.

My commission expires JULY 11, 1960

PLUGGING
FILE SEC. 25 13 17W
BOOK PAGE 435 LI. E. 22
132

RECEIVED
01-22-1957

WELL LOG

15-051-041031-00-00

COMPANY PETROLEUM, INCORPORATED

SEC 25 T. 13S R. 17W

FARM DREILING NO. 1

LOC. NW, NW, SW

TOTAL DEPTH 3603'

COUNTY Ellis Co., Kansas

COMM. December 30, 1956 COMP. January 8, 1957

CONTRACTOR GARVEY DRILLING COMPANY

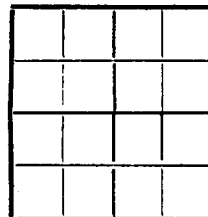

CASING 8 5/8" @ 175' W/125 sax.

ELEVATION 1986' DF

PRODUCTION D & A

FIGURES INDICATE BOTTOM OF FORMATIONS

65	Clay	Anhydrite	1162'
75	Blue shale	Topeka	2980'
490	Shale & shells	Heebner	3230'
1162	Shale, sand & shells	Toronto	3248'
1202	Anhydrite	Lansing	3276'
2135	Shale & shells		
3125	Lime & shale		
3257	Lime		
3325	Lime & shale		
3538	Lime		
3603	Lime & shale		
3603	T. D.		

State of KANSAS

County of BARTON

I, Verne A. Morris

RECEIVED
STATE CORPORATION COMMISSION

JAN 22 1957
01-22-1957

Garvey Drilling Co.

upon oath state that the above and foregoing is a true and correct copy of the log of the #1 Dreiling well

PLUGGING 17W
FILE SEC. 25 T. 13 R. 17
BOOK PAGE 125 LINE 22

Verne A. Morris

Subscribed and sworn to before me this 19th day of January 19 57

My Commission Expires: July 11, 1960

Ed. J. Brown
NOTARY PUBLIC