

For KCC Use: 2-16-2011
 Effective Date: _____
 District #: _____
 SGA? Yes No

**KANSAS CORPORATION COMMISSION
 OIL & GAS CONSERVATION DIVISION**

Form C-1
 March 2010
 Form must be Typed
 Form must be Signed
 All blanks must be Filled

NOTICE OF INTENT TO DRILL

*Must be approved by KCC five (5) days prior to commencing well
 Form KSONA-1, Certification of Compliance with the Kansas Surface Owner Notification Act, MUST be submitted with this form.*

Expected Spud Date: FEBRUARY 11th 2011
month day year

OPERATOR: License# 31458 ✓
 Name: H.J. INC
 Address 1: 70 N. Farmland Rd.
 Address 2: _____
 City: Garden City State: KS Zip: 67846 + _____
 Contact Person: Kenneth Lang
 Phone: 620-640-8218

CONTRACTOR: License# 34127 ✓
 Name: TOMCAT DRILLING LLC

Well Drilled For:	Well Class:	Type Equipment:
<input checked="" type="checkbox"/> Oil	<input type="checkbox"/> Enh Rec	<input type="checkbox"/> Infield
<input checked="" type="checkbox"/> Gas	<input type="checkbox"/> Storage	<input type="checkbox"/> Mud Rotary
	<input type="checkbox"/> Disposal	<input type="checkbox"/> Pool Ext.
		<input type="checkbox"/> Wildcat
		<input type="checkbox"/> Cable
<input type="checkbox"/> Seismic: _____ # of Holes	<input type="checkbox"/> Other	
<input type="checkbox"/> Other: _____		

If OWWO: old well information as follows:
 Operator: _____
 Well Name: _____
 Original Completion Date: _____ Original Total Depth: _____

Directional, Deviated or Horizontal wellbore? Yes No
 If Yes, true vertical depth: _____
 Bottom Hole Location: _____
 KCC DKT #: _____

Spot Description: _____
 NW - NW - SW - _____ Sec. 25 Twp. 33 S. R. 30 E W
(0000) 2284 feet from N / S Line of Section
367 feet from E / W Line of Section

is SECTION: Regular Irregular?
 (Note: Locate well on the Section Plat on reverse side)

County: Meade
 Lease Name: Cora Well #: 1-15

Field Name: Novinger
 is this a Prorated / Spaced Field? Yes No

Target Formation(s): Morrow
 Nearest Lease or unit boundary line (in footage): 367

Ground Surface Elevation: 2689.1 feet MSL
 Water well within one-quarter mile: Yes No

Public water supply well within one mile: Yes No
 Depth to bottom of fresh water: 560

Depth to bottom of usable water: 560
 Surface Pipe by Alternate: It

Length of Surface Pipe Planned to be set: 1800'
 Length of Conductor Pipe (if any): _____

Projected Total Depth: 6500'
 Formation at Total Depth: St. Louis

Water Source for Drilling Operations:
 Well Farm Pond Other: _____

DWR Permit #: _____
 (Note: Apply for Permit with DWR)

Will Cores be taken? Yes No
 If Yes, proposed zone: _____

RECEIVED
 FEB 07 2011

AFFIDAVIT

The undersigned hereby affirms that the drilling, completion and eventual plugging of this well will comply with K.S.A. 55 et. seq.

It is agreed that the following minimum requirements will be met:

KCC WICHITA

1. Notify the appropriate district office *prior* to spudding of well;
2. A copy of the approved notice of intent to drill *shall* be posted on each drilling rig;
3. The minimum amount of surface pipe as specified below *shall* be set by circulating cement to the top; in all cases surface pipe *shall* be set through all unconsolidated materials plus a minimum of 20 feet into the underlying formation.
4. If the well is dry hole, an agreement between the operator and the district office on plug length and placement is necessary *prior to plugging*;
5. The appropriate district office will be notified before well is either plugged or production casing is cemented in;
6. If an ALTERNATE II COMPLETION, production pipe shall be cemented from below any usable water to surface within **120 DAYS** of spud date. Or pursuant to Appendix "B" - Eastern Kansas surface casing order #133,891-C, which applies to the KCC District 3 area, alternate II cementing must be completed within 30 days of the spud date or the well shall be plugged. *in all cases, NOTIFY district office prior to any cementing.*

I hereby certify that the statements made herein are true and to the best of my knowledge and belief.

Date: 2-7-2011 Signature of Operator or Agent: _____ Title: AGENT

For KCC Use ONLY
 API # 15 - 119-21281-0000
 Conductor pipe required None feet
 Minimum surface pipe required 580 feet per ALT. II
 Approved by: [Signature] 2-11-2011
 This authorization expires: 2-11-2012
(This authorization void if drilling not started within 12 months of approval date.)
 Spud date: _____ Agent: _____

- Remember to:**
- File Certification of Compliance with the Kansas Surface Owner Notification Act (KSONA-1) with Intent to Drill;
 - File Drill Pit Application (form CDP-1) with Intent to Drill;
 - File Completion Form ACO-1 within 120 days of spud date;
 - File acreage attribution plat according to field pronation orders;
 - Notify appropriate district office 48 hours prior to workover or re-entry;
 - Submit plugging report (CP-4) after plugging is completed (within 60 days);
 - Obtain written approval before disposing or injecting salt water.
 - If well will not be drilled or permit has expired (See: authorized expiration date) please check the box below and return to the address below.

Well will not be drilled or Permit Expired Date: _____
 Signature of Operator or Agent: _____

Mail to: KCC - Conservation Division,
 130 S. Market - Room 2078, Wichita, Kansas 67202

25
33
30
 E W

For KCC Use ONLY
API # 15 - 119-21281-0000

IN ALL CASES PLOT THE INTENDED WELL ON THE PLAT BELOW

In all cases, please fully complete this side of the form. Include items 1 through 5 at the bottom of this page.

Operator: H.J. INC
Lease: CARA
Well Number: 1-15
Field: _____
Number of Acres attributable to well: _____
QTR/QTR/QTR/QTR of acreage: _____ - NW - NW - SW

Location of Well: County: MEADE
2,284 feet from N / S Line of Section
367 feet from E / W Line of Section
Sec. 25 Twp. 33 S. R. 30 E W

Is Section: Regular or Irregular

If Section is Irregular, locate well from nearest corner boundary.
Section corner used: NE NW SE SW

PLAT

Show location of the well. Show footage to the nearest lease or unit boundary line. Show the predicted locations of lease roads, tank batteries, pipelines and electrical lines, as required by the Kansas Surface Owner Notice Act (House Bill 2032). You may attach a separate plat if desired.

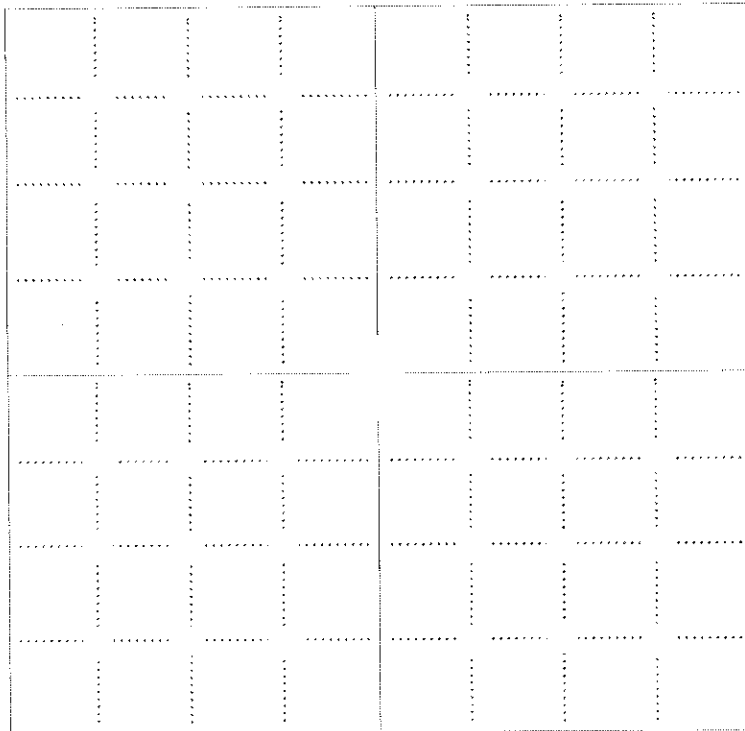

LEGEND

- Well Location
- Tank Battery Location
- Pipeline Location
- Electric Line Location
- Lease Road Location

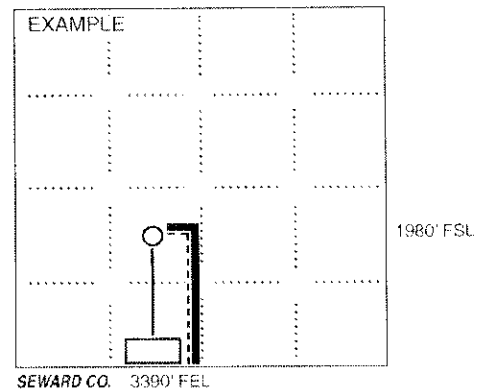

NOTE: In all cases locate the spot of the proposed drilling location.

In plotting the proposed location of the well, you must show:

1. The manner in which you are using the depicted plat by identifying section lines, i.e. 1 section, 1 section with 8 surrounding sections, 4 sections, etc.
2. The distance of the proposed drilling location from the south / north and east / west outside section lines.
3. The distance to the nearest lease or unit boundary line (in footage).
4. If proposed location is located within a prorated or spaced field a certificate of acreage attribution plat must be attached: (CO-7 for oil wells; CG-8 for gas wells).
5. The predicted locations of lease roads, tank batteries, pipelines, and electrical lines.

RECEIVED
FEB 07 2011
KCC WICHITA

15-119-21281-0000
KANSAS CORPORATION COMMISSION
OIL & GAS CONSERVATION DIVISION

Form KSONA-1
July 2010
Form Must Be Typed
Form must be Signed
All blanks must be Filled

**CERTIFICATION OF COMPLIANCE WITH THE
KANSAS SURFACE OWNER NOTIFICATION ACT**

This form must be submitted with all Forms C-1 (Notice of Intent to Drill); CB-1 (Cathodic Protection Borehole Intent); T-1 (Request for Change of Operator Transfer of Injection or Surface Pit Permit); and CP-1 (Well Plugging Application). Any such form submitted without an accompanying Form KSONA-1 will be returned.

Select the corresponding form being filed: C-1 (Intent) CB-1 (Cathodic Protection Borehole Intent) T-1 (Transfer) CP-1 (Plugging Application)

OPERATOR: License # 31458
Name: H.J. INC
Address 1: 70 N. Farmland Rd.
Address 2: _____
City: Garden City State: KS Zip: 67846
Contact Person: Kenneth Lang
Phone: (620) 640-8218 Fax: (____) _____
Email Address: _____

Well Location:
NW NW SW Sec. 25 Twp. 33 S. R. 30 East West
County: MEADE
Lease Name: CARA Well #: 1-15

If filing a Form T-1 for multiple wells on a lease, enter the legal description of the lease below:

Surface Owner Information:

Name: Jay Borth
Address 1: 10209 L Rd.
Address 2: _____
City: Plains State: KS Zip: 67869

When filing a Form T-1 involving multiple surface owners, attach an additional sheet listing all of the information to the left for each surface owner. Surface owner information can be found in the records of the register of deeds for the county, and in the real estate property tax records of the county treasurer.

If this form is being submitted with a Form C-1 (Intent) or CB-1 (Cathodic Protection Borehole Intent), you must supply the surface owners and the KCC with a plat showing the predicted locations of lease roads, tank batteries, pipelines, and electrical lines. The locations shown on the plat are preliminary non-binding estimates. The locations may be entered on the Form C-1 plat, Form CB-1 plat, or a separate plat may be submitted.

Select one of the following:

- I certify that, pursuant to the Kansas Surface Owner Notice Act (House Bill 2032), I have provided the following to the surface owner(s) of the land upon which the subject well is or will be located: 1) a copy of the Form C-1, Form CB-1, Form T-1, or Form CP-1 that I am filing in connection with this form; 2) if the form being filed is a Form C-1 or Form CB-1, the plat(s) required by this form; and 3) my operator name, address, phone number, fax, and email address.
- I have not provided this information to the surface owner(s). I acknowledge that, because I have not provided this information, the KCC will be required to send this information to the surface owner(s). To mitigate the additional cost of the KCC performing this task, I acknowledge that I am being charged a \$30.00 handling fee, payable to the KCC, which is enclosed with this form.

If choosing the second option, submit payment of the \$30.00 handling fee with this form. If the fee is not received with this form, the KSONA-1 form and the associated Form C-1, Form CB-1, Form T-1, or Form CP-1 will be returned.

I hereby certify that the statements made herein are true and correct to the best of my knowledge and belief.

Date: 02/07/2011 Signature of Operator or Agent: _____ Title: AGENT

RECEIVED
FEB 07 2011
KCC WICHITA

15-119-21281-0000



1020111-r
PLAN NO.

Pro-Stake LLC
Oil Field & Construction Site Staking
P.O. Box 2324
Garden City, Kansas 67846
Office/Fax: (620) 276-6159
Cell: (620) 272-1499

9183
INVOICE NO.



HJ Inc.
OPERATOR
Seward County, KS
COUNTY

25 33s 30w
Sec. Twp. Rng.

Cara #1-25
LEASE NAME
2284' FSL - 367' FWL
LOCATION SPOT

SCALE: 1" = 1000'
DATE: Jan. 31st, 2011
MEASURED BY: Luke R.
DRAWN BY: Luke R.
AUTHORIZED BY: Ken L.



GR. ELEVATION: 2689.1'

Directions: From the SE side of Kismet, Ks at the intersection of Hwy 54 & Rd 11 East & Main St. - Now go 1.5 mile East on Rd 11 - Now go 2 miles South on W Rd - Now go 7 mile East on Meade Lake Rd/ V Rd - Now go 1 mile South on 7 Rd to the NW corner of section 25-33s-30w - Now go 0.5 mile South on 7 Rd to ingress stake East into - Now go 370' East on trail to ingress stake South into - Now go 340' South through crp into staked location. Final ingress must be verified with land owner or Operator

*This drawing does not constitute a monumented survey or a land survey plot.
This drawing is for construction purposes only*

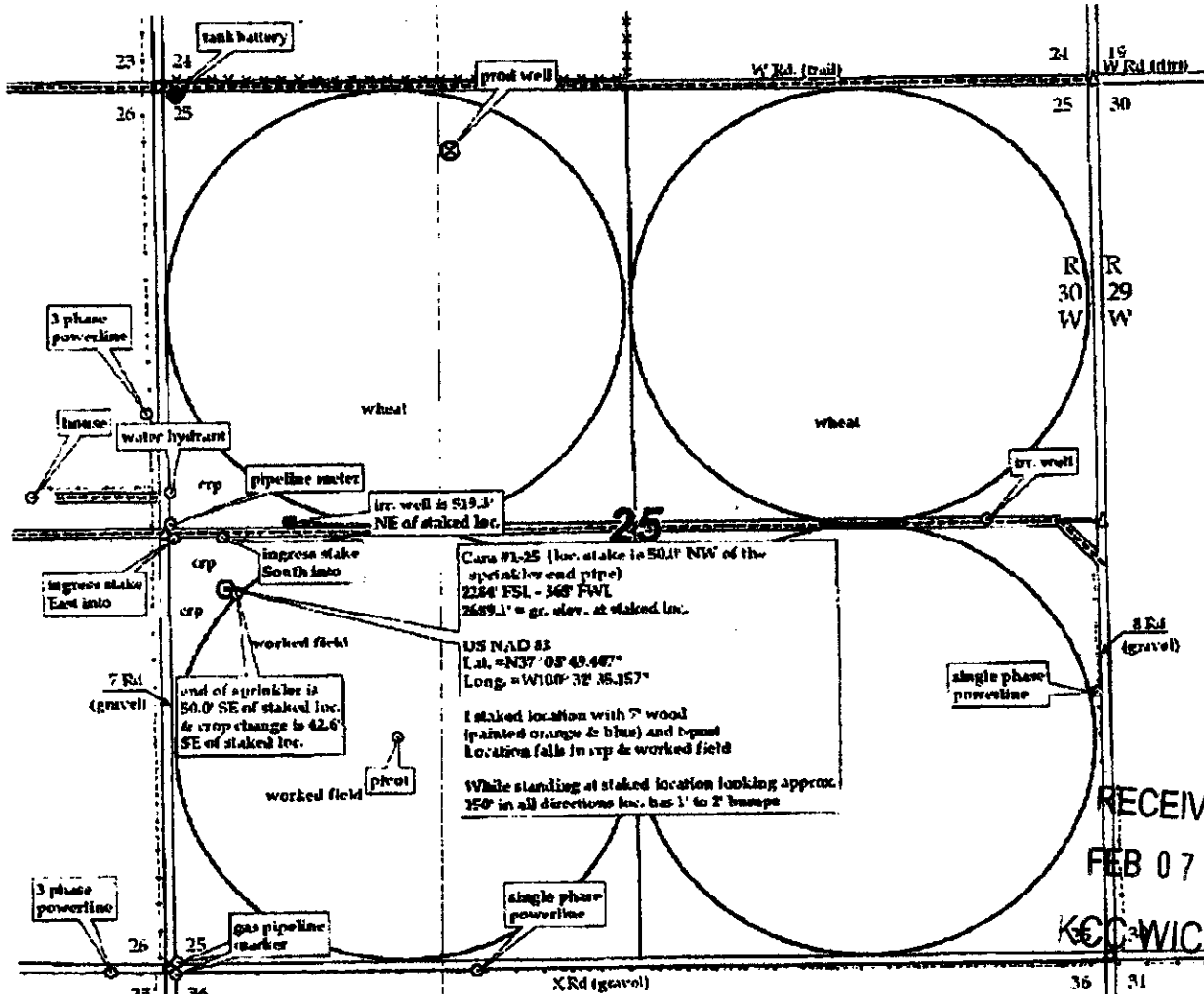

RECEIVED
FEB 07 2011
KCC WICHITA

KANSAS CORPORATION COMMISSION
OIL & GAS CONSERVATION DIVISION

Form CDP-1
May 2010
Form must be Typed

APPLICATION FOR SURFACE PIT

Submit in Duplicate

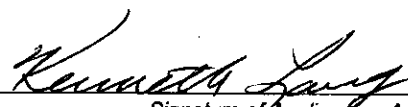
Operator Name: H.J. INC		License Number: 31458
Operator Address: 70 N. Farmland Rd.		Garden City KS 67846
Contact Person: Kenneth Lang		Phone Number: 620-640-8218
Lease Name & Well No.: Cara 1-15		Pit Location (QQQQ): <u>NW</u> - <u>NW</u> - <u>SW</u> - _____ Sec. <u>25</u> Twp. <u>33</u> R. <u>30</u> <input type="checkbox"/> East <input checked="" type="checkbox"/> West <u>2284</u> Feet from <input type="checkbox"/> North / <input checked="" type="checkbox"/> South Line of Section <u>367</u> Feet from <input type="checkbox"/> East / <input checked="" type="checkbox"/> West Line of Section Meade County
Type of Pit: <input type="checkbox"/> Emergency Pit <input type="checkbox"/> Burn Pit <input type="checkbox"/> Settling Pit <input checked="" type="checkbox"/> Drilling Pit <input type="checkbox"/> Workover Pit <input type="checkbox"/> Haul-Off Pit <small>(If WP Supply API No. or Year Drilled)</small>	Pit is: <input type="checkbox"/> Proposed <input type="checkbox"/> Existing If Existing, date constructed: _____ Pit capacity: _____ (bbis)	
Is the pit located in a Sensitive Ground Water Area? <input checked="" type="checkbox"/> Yes <input checked="" type="checkbox"/> No		Chloride concentration: _____ mg/l <small>(For Emergency Pits and Settling Pits only)</small>
Is the bottom below ground level? <input checked="" type="checkbox"/> Yes <input type="checkbox"/> No	Artificial Liner? <input type="checkbox"/> Yes <input checked="" type="checkbox"/> No	How is the pit lined if a plastic liner is not used? Rotary Mud
Pit dimensions (all but working pits): <u>100</u> Length (feet) <u>100</u> Width (feet) <input type="checkbox"/> N/A: Steel Pits Depth from ground level to deepest point: <u>4</u> (feet) <input type="checkbox"/> No Pit		
If the pit is lined give a brief description of the liner material, thickness and installation procedure.		Describe procedures for periodic maintenance and determining liner integrity, including any special monitoring.
Distance to nearest water well within one-mile of pit: <u>920</u> feet Depth of water well <u>416</u> feet		Depth to shallowest fresh water <u>172</u> feet. Source of information: <input type="checkbox"/> measured <input type="checkbox"/> well owner <input type="checkbox"/> electric log <input checked="" type="checkbox"/> KDWR
Emergency, Settling and Burn Pits ONLY: Producing Formation: _____ Number of producing wells on lease: _____ Barrels of fluid produced daily: _____ Does the slope from the tank battery allow all spilled fluids to flow into the pit? <input type="checkbox"/> Yes <input type="checkbox"/> No		Drilling, Workover and Haul-Off Pits ONLY: Type of material utilized in drilling/workover: <u>Drilg mud</u> Number of working pits to be utilized: <u>1</u> Abandonment procedure: <u>Evaporate a backfill.</u> Drill pits must be closed within 365 days of spud date.
I hereby certify that the above statements are true and correct to the best of my knowledge and belief.		
<u>2-9-11</u> Date	 Signature of Applicant or Agent	RECEIVED FEB 10 2011 KCC WICHITA

15-119-21281-0000

KCC OFFICE USE ONLY			
Date Received: <u>2-10-11</u>	Permit Number: _____	Permit Date: <u>2-11-11</u>	Lease Inspection: <input checked="" type="checkbox"/> Yes <input type="checkbox"/> No
		<input type="checkbox"/> Liner <input type="checkbox"/> Steel Pit <input checked="" type="checkbox"/> RFAC <input type="checkbox"/> RFAS	

Mail to: KCC - Conservation Division, 130 S. Market - Room 2078, Wichita, Kansas 67202

Conservation Division
Finney State Office Building
130 S. Market, Rm. 2078
Wichita, KS 67202-3802



phone: 316-337-6200
fax: 316-337-6211
<http://kcc.ks.gov/>

Thomas E. Wright, Chairman
Ward Loyd, Commissioner

Corporation Commission

Sam Brownback, Governor

February 11, 2011

H.J. Inc.
70 N. Farmland Rd.
Garden City, KS 67846

Re: Drilling Pit Application
Cara Lease Well No. 1-15
SW/4 Sec. 25-33S-30W
Meade County, Kansas

Dear Sir or Madam:

District staff has inspected the above referenced location and has determined that the reserve pit shall be constructed **without slots**, the bottom shall be flat and reasonably level, and the free fluids must be removed. The fluids are to be removed from the reserve pit within 96 hours of drilling completion. **Keep pits away draw/drainage.**

If production casing is set all completion fluids shall be removed from the working pits daily. NO completion fluids or non-exempt wastes shall be placed in the reserve pit.

The fluids should be taken to an authorized disposal well. Please call the District Office at (620) 225-8888 when the fluids have been removed. Please file form CDP-5 (August 2004), Exploration and Production Waste Transfer, within 30 days of fluid removal. Conservation division forms are available through our office and on the KCC web site:
www.kcc.state.ks.us/conservation/forms.

A copy of this letter should be posted in the doghouse along with the approved Intent to Drill.

If you have any questions or concerns please feel free to contact the undersigned at the above address.

Sincerely,

A handwritten signature in black ink, appearing to read "Kathy Haynes".

Kathy Haynes
Environmental Protection and Remediation Department

cc: File