

**\* CORRECTED \*** **CORRECTED**

For KCC Use:  
 Effective Date: 10-31-2010  
 District #: 3  
 SGA?  Yes  No

**KANSAS CORPORATION COMMISSION  
 OIL & GAS CONSERVATION DIVISION**

Form C-1  
 March 2010  
 Form must be Typed  
 Form must be Signed  
 All blanks must be Filled

**NOTICE OF INTENT TO DRILL**

*Must be approved by KCC five (5) days prior to commencing well  
 Form KSONA-1, Certification of Compliance with the Kansas Surface Owner Notification Act, MUST be submitted with this form.*

Expected Spud Date: October 27, 2010  
month day year

OPERATOR: License# 34349  
 Name: Pharyn Resources, LLC  
 Address 1: 15621 West 87th Street, Suite 262  
 Address 2: \_\_\_\_\_  
 City: Lenexa State: KS Zip: 66219  
 Contact Person: Brad Kramer  
 Phone: (913) 669-2253

CONTRACTOR: License# 8509  
 Name: Evans Energy Development, Inc.

**NE SE SE NE**

Spot Description: \_\_\_\_\_  
 SW SE NW NE Sec. 25 Twp. 20 S. R. 21  E  W  
 (0000) 425 2983 feet from  N /  S Line of Section  
115 feet from  E /  W Line of Section

Is SECTION:  Regular  Irregular?  
 (Note: Locate well on the Section Plat on reverse side)  
 County: Linn  
 Lease Name: Shkies Well #: 17  
 Field Name: Goodrich-Parker  
 Is this a Prorated / Spaced Field?  Yes  No  
 Target Formation(s): Squirrel Sandstone

\* Nearest Lease or unit boundary line (in footage): 825 115'  
 Ground Surface Elevation: 926 feet MSL  
 Water well within one-quarter mile:  Yes  No  
 Public water supply well within one mile:  Yes  No  
 Depth to bottom of fresh water: 100'  
 Depth to bottom of usable water: 150'  
 Surface Pipe by Alternate:  I  II  
 Length of Surface Pipe Planned to be set: 20'  
 Length of Conductor Pipe (if any): N/A  
 Projected Total Depth: 620'  
 Formation at Total Depth: Squirrel Sandstone

Water Source for Drilling Operations:  
 Well  Farm Pond  Other: \_\_\_\_\_  
 DWR Permit #: \_\_\_\_\_  
 (Note: Apply for Permit with DWR )

Will Cores be taken?  Yes  No  
 If Yes, proposed zone: \_\_\_\_\_

\* Enh Rec

Well Drilled For:  Oil  Gas  
 Enh Rec  Storage  Disposal  
 Seismic: \_\_\_\_\_ # of Holes  Other: \_\_\_\_\_  
 If OWWO: old well information as follows: \_\_\_\_\_

Well Class:  Infield  Pool Ext.  Wildcat  Other  
 Type Equipment:  Mud Rotary  Air Rotary  Cable

Operator: \_\_\_\_\_  
 Well Name: \_\_\_\_\_  
 Original Completion Date: \_\_\_\_\_ Original Total Depth: \_\_\_\_\_

Directional, Deviated or Horizontal wellbore?  Yes  No  
 If Yes, true vertical depth: \_\_\_\_\_  
 Bottom Hole Location: \_\_\_\_\_  
 KCC DKT #: \_\_\_\_\_

\* WAS: Oil; SW-SE-NW-NE; 4125' FSL; 1815' FEL; NLUB: 825  
 IS: Enh Rec; NE-SE-SE-NE; 2983' FSL; 115' FEL; NLUB: 115

**AFFIDAVIT**

The undersigned hereby affirms that the drilling, completion and eventual plugging of this well will comply with K.S.A. 55 et. seq.  
 It is agreed that the following minimum requirements will be met:

1. Notify the appropriate district office prior to spudding of well;
2. A copy of the approved notice of intent to drill shall be posted on each drilling rig;
3. The minimum amount of surface pipe as specified below shall be set by circulating cement to the top; in all cases surface pipe shall be set through all unconsolidated materials plus a minimum of 20 feet into the underlying formation.
4. If the well is dry hole, an agreement between the operator and the district office on plug length and placement is necessary prior to plugging;
5. The appropriate district office will be notified before well is either plugged or production casing is cemented in;
6. If an ALTERNATE II COMPLETION, production pipe shall be cemented from below any usable water to surface within 120 DAYS of spud date.  
 Or pursuant to Appendix "B" - Eastern Kansas surface casing order #133,891-C, which applies to the KCC District 3 area, alternate II cementing must be completed within 30 days of the spud date or the well shall be plugged. In all cases, NOTIFY district office prior to any cementing.

**RECEIVED**  
 OCT 25 2010

**KCC WICHITA**

**RECEIVED**  
 FEB 22 2011

**KCC WICHITA**

I hereby certify that the statements made herein are true and to the best of my knowledge and belief.  
 Date: October 17, 2010 Signature of Operator or Agent: Brad Kramer Title: Director

**For KCC Use ONLY**  
 API # 15 - 107-24333-0000  
 Conductor pipe required None feet  
 Minimum surface pipe required 20 feet per ALT.  I  II  
 Approved by: Perm 10-26-2010/Perm 2-22-2011  
 This authorization expires: 10-26-2011  
(This authorization void if drilling not started within 12 months of approval date.)  
 Spud date: \_\_\_\_\_ Agent: \_\_\_\_\_

**Remember to:**

- File Certification of Compliance with the Kansas Surface Owner Notification Act (KSONA-1) with Intent to Drill;
- File Drill Pit Application (form CDP-1) with Intent to Drill;
- File Completion Form ACO-1 within 120 days of spud date;
- File acreage attribution plat according to field proration orders;
- Notify appropriate district office 48 hours prior to workover or re-entry;
- Submit plugging report (CP-4) after plugging is completed (within 60 days);
- Obtain written approval before disposing or injecting salt water.
- If well will not be drilled or permit has expired (See: authorized expiration date) please check the box below and return to the address below.

Well will not be drilled or Permit Expired Date: \_\_\_\_\_  
 Signature of Operator or Agent: \_\_\_\_\_

25  
20  
21  
 E  
 W

Mail to: KCC - Conservation Division,  
 130 S. Market - Room 2078, Wichita, Kansas 67202

**CORRECTED**

For KCC Use ONLY

API # 15 - 107-24333-0000

**IN ALL CASES PLOT THE INTENDED WELL ON THE PLAT BELOW**

In all cases, please fully complete this side of the form. Include items 1 through 5 at the bottom of this page.

Operator: Pharyn Resources, LLC \*  
 Lease: Shikles \*  
 Well Number: 17 \*  
 Field: Goodrich-Parker

Location of Well: County: Linn  
4 1/2 2983 feet from  N /  S Line of Section  
1 1/2 115 feet from  E /  W Line of Section  
 Sec. 25 Twp. 20 S. R. 21  E  W

Number of Acres attributable to well: 2.5

Is Section:  Regular or  Irregular

\* QTR/QTR/QTR/QTR of acreage: SW - SE - NW - NE  
NE SE SE NE

If Section is Irregular, locate well from nearest corner boundary.  
 Section corner used:  NE  NW  SE  SW

**PLAT**

Show location of the well. Show footage to the nearest lease or unit boundary line. Show the predicted locations of lease roads, tank batteries, pipelines and electrical lines, as required by the Kansas Surface Owner Notice Act (House Bill 2032).  
 You may attach a separate plat if desired.

De/4 section 25

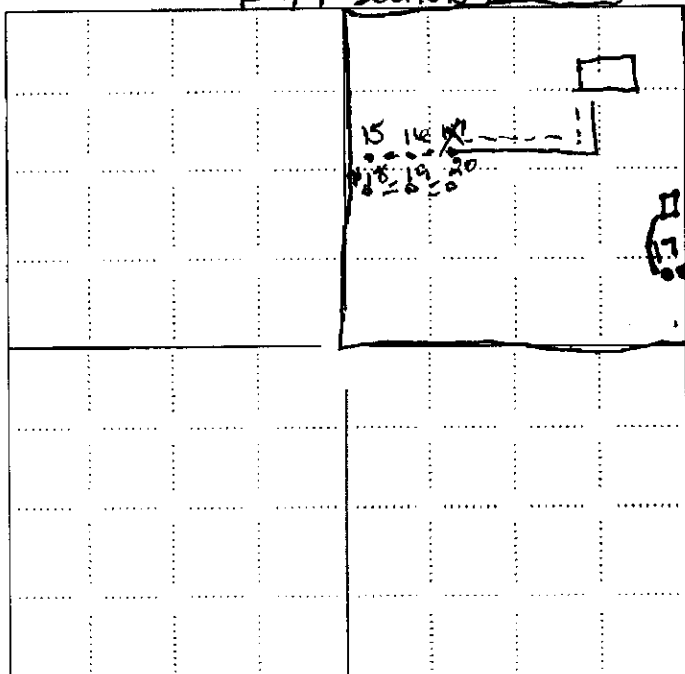

**LEGEND**

- Well Location
- Tank Battery Location
- Pipeline Location
- Electric Line Location
- Lease Road Location

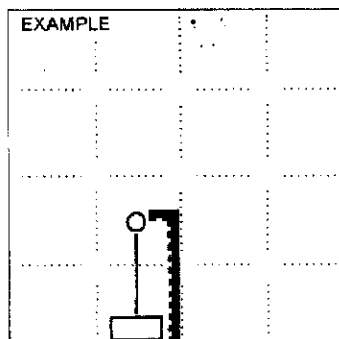

1980' FSL

NOTE: In all cases locate the spot of the proposed drilling location.

In plotting the proposed location of the well, you must show:

1. The manner in which you are using the depicted plat by identifying section lines, i.e. 1 section, 1 section with 8 surrounding sections, 4 sections, etc.
2. The distance of the proposed drilling location from the south / north and east / west outside section lines.
3. The distance to the nearest lease or unit boundary line (in footage).
4. If proposed location is located within a prorated or spaced field a certificate of acreage attribution plat must be attached: (CO-7 for oil wells; CG-8 for gas wells).
5. The predicted locations of lease roads, tank batteries, pipelines, and electrical lines.

**RECEIVED**  
**OCT 25 2010**  
**KCC WICHITA**

**RECEIVED**  
**FEB 22 2011**  
**KCC WICHITA**

15-107-24333-00-00  
KANSAS CORPORATION COMMISSION  
OIL & GAS CONSERVATION DIVISION

**CORRECTED**

Form KSONA-1  
July 2010  
Form Must Be Typed  
Form must be Signed  
All blanks must be Filled

**CERTIFICATION OF COMPLIANCE WITH THE  
KANSAS SURFACE OWNER NOTIFICATION ACT**

*This form must be submitted with all Forms C-1 (Notice of Intent to Drill); CB-1 (Cathodic Protection Borehole Intent); T-1 (Request for Change of Operator Transfer of Injection or Surface Pit Permit); and CP-1 (Well Plugging Application). Any such form submitted without an accompanying Form KSONA-1 will be returned.*

Select the corresponding form being filed:  C-1 (Intent)  CB-1 (Cathodic Protection Borehole Intent)  T-1 (Transfer)  CP-1 (Plugging Application)

OPERATOR: License # 34349  
Name: Pharyn Resources, LLC  
Address 1: 15621 West 87th Street, Suite 262  
Address 2: \_\_\_\_\_  
City: Lenexa State: KS Zip: 66219  
Contact Person: Brad Kramer  
Phone: ( 913 ) 669-2253 Fax: ( 913 ) 344-1521  
Email Address: kramerbradley@yahoo.com

NE SE SE NE  
Well Location: \* SW SE NW NE Sec. 25 Twp. 20 S. R. 21  East  West  
County: Linn  
Lease Name: Shikles Well #: 17

*If filing a Form T-1 for multiple wells on a lease, enter the legal description of the lease below:*

**Surface Owner Information:**

Name: Jewell & Joan Shikles  
Address 1: 14617 W. 81st Street  
Address 2: \_\_\_\_\_  
City: Lenexa State: KS Zip: 66215

*When filing a Form T-1 involving multiple surface owners, attach an additional sheet listing all of the information to the left for each surface owner. Surface owner information can be found in the records of the register of deeds for the county, and in the real estate property tax records of the county treasurer.*

*If this form is being submitted with a Form C-1 (Intent) or CB-1 (Cathodic Protection Borehole Intent), you must supply the surface owners and the KCC with a plat showing the predicted locations of lease roads, tank batteries, pipelines, and electrical lines. The locations shown on the plat are preliminary non-binding estimates. The locations may be entered on the Form C-1 plat, Form CB-1 plat, or a separate plat may be submitted.*

**Select one of the following:**

- I certify that, pursuant to the Kansas Surface Owner Notice Act (House Bill 2032), I have provided the following to the surface owner(s) of the land upon which the subject well is or will be located: 1) a copy of the Form C-1, Form CB-1, Form T-1, or Form CP-1 that I am filing in connection with this form; 2) if the form being filed is a Form C-1 or Form CB-1, the plat(s) required by this form; and 3) my operator name, address, phone number, fax, and email address.
- I have not provided this information to the surface owner(s). I acknowledge that, because I have not provided this information, the KCC will be required to send this information to the surface owner(s). To mitigate the additional cost of the KCC performing this task, I acknowledge that I am being charged a \$30.00 handling fee, payable to the KCC, which is enclosed with this form.

*If choosing the second option, submit payment of the \$30.00 handling fee with this form. If the fee is not received with this form, the KSONA-1 form and the associated Form C-1, Form CB-1, Form T-1, or Form CP-1 will be returned.*

I hereby certify that the statements made herein are true and correct to the best of my knowledge and belief.

Date: October 17, 2010 Signature of Operator or Agent: Brad Kramer Title: Director

RECEIVED  
OCT 25 2010  
KCC WICHITA

Mail to: KCC - Conservation Division, 130 S. Market - Room 2078, Wichita, Kansas 67202

RECEIVED  
FEB 22 2011  
KCC WICHITA

**CORRECTED**

KANSAS CORPORATION COMMISSION  
OIL & GAS CONSERVATION DIVISION  
APPLICATION FOR SURFACE PIT

Form CDP-1  
May 2010  
Form must be Typed

Submit in Duplicate

Operator Name: Pharyn Resources, LLC		License Number: 34349	
Operator Address: 15621 West 87th Street, Suite 262		Lenexa KS 66219	
Contact Person: Brad Kramer		Phone Number: (913) 669-2253	
Lease Name & Well No.: Shikles 17 #		Pit Location (QQQQ): NE SE SE NE	
Type of Pit: <input type="checkbox"/> Emergency Pit <input type="checkbox"/> Burn Pit <input type="checkbox"/> Settling Pit <input checked="" type="checkbox"/> Drilling Pit <input type="checkbox"/> Workover Pit <input type="checkbox"/> Haul-Off Pit <small>(If WP Supply API No. or Year Drilled)</small>		Pit Is: <input checked="" type="checkbox"/> Proposed <input type="checkbox"/> Existing If Existing, date constructed: * 4/25/2008 * Pit capacity: 120 (bbls)	
Is the pit located in a Sensitive Ground Water Area? <input type="checkbox"/> Yes <input checked="" type="checkbox"/> No		Sec. 25 Twp. 20 R. 21 <input checked="" type="checkbox"/> East <input type="checkbox"/> West * 4,225 2983 Feet from <input type="checkbox"/> North / <input checked="" type="checkbox"/> South Line of Section * 1,615 115 Feet from <input checked="" type="checkbox"/> East / <input type="checkbox"/> West Line of Section Linn County	
Is the bottom below ground level? <input checked="" type="checkbox"/> Yes <input type="checkbox"/> No		Artificial Liner? <input type="checkbox"/> Yes <input checked="" type="checkbox"/> No How is the pit lined if a plastic liner is not used? Native Mud	
Pit dimensions (all but working pits): 12 Length (feet) 6 Width (feet) Depth from ground level to deepest point: 5 (feet)		<input type="checkbox"/> N/A: Steel Pits <input type="checkbox"/> No Pit	
If the pit is lined give a brief description of the liner material, thickness and installation procedure.		Describe procedures for periodic maintenance and determining liner integrity, including any special monitoring.	
Distance to nearest water well within one-mile of pit: N/A feet    Depth of water well _____ feet		Depth to shallowest fresh water _____ feet. Source of information: <input type="checkbox"/> measured <input type="checkbox"/> well owner <input type="checkbox"/> electric log <input checked="" type="checkbox"/> KDWR	
<b>Emergency, Settling and Burn Pits ONLY:</b> Producing Formation: _____ Number of producing wells on lease: _____ Barrels of fluid produced daily: _____ Does the slope from the tank battery allow all spilled fluids to flow into the pit? <input type="checkbox"/> Yes <input type="checkbox"/> No		<b>Drilling, Workover and Haul-Off Pits ONLY:</b> Type of material utilized in drilling/workover: Drilling Mud Number of working pits to be utilized: 1 Abandonment procedure: Air dry and backfill Drill pits must be closed within 365 days of spud date.	
I hereby certify that the above statements are true and correct to the best of my knowledge and belief.			
October 17, 2010 Date		Brad Kramer Signature of Applicant or Agent	
<b>RECEIVED OCT 25 2010 KCC WICHITA</b>			
<b>KCC OFFICE USE ONLY</b>			
Date Received: 10/25/10    Permit Number: _____    Permit Date: 10-25-10		<input type="checkbox"/> Liner <input type="checkbox"/> Steel Pit <input checked="" type="checkbox"/> RFAC <input type="checkbox"/> RFAS 2-22-11 Lease Inspection: <input checked="" type="checkbox"/> Yes <input type="checkbox"/> No	

15-107-24333-00-00

Mail to: KCC - Conservation Division, 130 S. Market - Room 2078, Wichita, Kansas 67202

**RECEIVED  
FEB 22 2011  
KCC WICHITA**



**NOTICE TO OPERATORS FILING INTENT TO DRILL  
FOR DISPOSAL OR ENHANCED RECOVERY  
INJECTION WELLS, (CLASS II INJECTION WELL)**

The attached approved Notice of Intent to Drill indicates the proposed well is to be used for injection. An approved "Intent to Drill" does not approve injection authority as a Class II Injection Well in Kansas.

Before any well is used for injection purposes, the operator must file an application for injection authority in accordance with K.A.R. 82-3-401 and provide notice in accordance with K.A.R. 82-3-402. The Conservation Division must issue a written permit granting the application before commencement of injection.

The Conservation Division requirements and restrictions associated with Class II Injection are identified in **K.A.R. 82-3-400 et seq** of our regulations. Associated regulations governing drilling, completion and injection applications may be found in K.A.R. 82-3-135, Table I, Table II, in the Cedar Hills Sandstone Moratorium, (Docket #156,397-C), and the Eastern Kansas Surface Casing Order, (Docket #133,891-C).

If you have questions regarding the approval of injection authority, an injection application may be filed as a "Design Approval" before actual drilling and completion of the well occurs. If you have any questions or concerns regarding Class II injection wells or regulations, call the Underground Injection Control Department at 316-337-6200.

Failure to obtain commission approval before beginning injection is punishable by a penalty, shut-in of the well or both.

Conservation Division  
Finney State Office Building  
130 S. Market, Rm. 2078  
Wichita, KS 67202-3802



phone: 316-337-6200  
fax: 316-337-6211  
<http://kcc.ks.gov/>

Thomas E. Wright, Chairman  
Ward Loyd, Commissioner

Corporation Commission

Sam Brownback, Governor

February 22, 2011

Pharyn Resources LLC  
15621 West 87<sup>th</sup> St Ste 262  
Lenexa, KS 66219

RE: Drilling Pit Application  
Shikles Lease Well No. 17  
NE/4 Sec. 25-20S-21E  
Linn County, Kansas

Dear Sir or Madam:

District staff has inspected the above referenced location and has determined that the reserve pit shall be constructed **without slots**, the bottom shall be flat and reasonably level, and the free fluids must be removed. The fluids are to be removed from the reserve pit immediately after drilling operations have ceased.

**If production casing is set all completion fluids shall be removed from the working pits daily. NO completion fluids or non-exempt wastes shall be placed in the reserve pit.**

The fluids should be taken to an authorized disposal well. Please call the District Office at (620) 432-2300 when the fluids have been removed. Please file form CDP-5 (August 2004), Exploration and Production Waste Transfer, within 30 days of fluid removal. Conservation division forms are available through our office and on the KCC web site:  
[www.kcc.state.ks.us/conservation/forms](http://www.kcc.state.ks.us/conservation/forms).

**A copy of this letter should be posted in the doghouse along with the approved Intent to Drill.**

If you have any questions or concerns please feel free to contact the undersigned at the above address.

Sincerely,

Kathy Haynes  
Environmental Protection and Remediation Department

cc: File