

FOR KCC USE:

15-051-05811-0001
Gwwd

FORM C-1 7/91
FORM MUST BE TYPED
FORM MUST BE SIGNED
ALL BLANKS MUST BE FILLED

EFFECTIVE DATE: Feb 3, 2002

State of Kansas

NOTICE OF INTENTION TO DRILL

DISTRICT # 4

SEAT: Yes No

Must be approved by the K.C.C. five (5) days prior to commencing well

Expected Spud Date ... April 1, 2002 ...
month day year

Spot _____ East
NE - NE - NE Sec 22 Twp 11 S. Rg 17W _____ West

OPERATOR: License # 7064
Name: Cattlemans Oil Operations
Address: 2260 Catherine Rd.
City/State/Zip: Hays, Kansas
Contact Person: Loc. Dorzweiler
Phone: 735-625-5394

330 feet from South / North line of Section
1650 feet from East / West line of Section
IS SECTION REGULAR IRREGULAR?

(NOTE: Locate well on the Section Plat on Reverse Side)
County: Ellis
Lease Name: Johnsons Schmoell #2
Field Name: Pomis
Is this a Prorated/Spaced Field? ... yes no
Target Formation(s): Arbuckle
Nearest lease or unit boundary: 330
Ground Surface Elevation: 1926 feet MSL
Water well within one-quarter mile: yes no
Public water supply well within one mile: yes no
Depth to bottom of fresh water: 450
Depth to bottom of usable water: 640
Surface Pipe by Alternate: 1 2
Length of Surface Pipe: 11.36
Length of Conductor pipe required: NONE
Projected Total Depth: 3450
Formation at Total Depth: Arbuckle
Water Source for Drilling Operations:
... well farm pond other

CONTRACTOR: License #: 7064
Name: Cattlemans Oil Operations

Well Drilled For: Well Class: Type Equipment:
 Oil ... Enh Rec Infield ... Mud Rotary
... Gas ... Storage ... Pool Ext. ... Air Rotary
 OWWO ... Disposal ... Wildcat Cable
... Seismic: ... # of Holes ... Other
... Other: Oil No

If OWWO: old well information as follows:
Operator: Cities Service Oil Co.
Well Name: Johnson #2
Comp. Date: 7-37 Old Total Depth: 3149

Directional, Deviated or Horizontal wellbore? ... yes no
If yes, true vertical depth:
Bottom Hole Location:

* DWR Permit #: _____
Will Cores Be Taken?: ... yes no
If yes, proposed zone: _____

AFFIDAVIT

* Apply for permit with DWR
RECEIVED

The undersigned hereby affirms that the drilling, completion and eventual plugging of this well will comply with K.S.A. 55-101, et. seq.
It is agreed that the following minimum requirements will be met:

JAN 28 2002
01-28-02
KCC WICHITA

1. Notify the appropriate district office prior to spudding of well;
2. A copy of the approved notice of intent to drill shall be posted on each drilling rig;
3. The minimum amount of surface pipe as specified below shall be set by circulating cement to the top; in all cases surface pipe shall be set through all unconsolidated materials plus a minimum of 20 feet into the underlying formation;
4. If the well is dry hole, an agreement between the operator and the district office on plug length and placement is necessary prior to plugging;
5. The appropriate district office will be notified before well is either plugged or production casing is cemented in;
6. IF AN ALTERNATE II COMPLETION, PRODUCTION PIPE SHALL BE CEMENTED FROM BELOW ANY USABLE WATER TO SURFACE WITHIN 120 DAYS OF SPUD DATE. IN ALL CASES, NOTIFY DISTRICT OFFICE PRIOR TO ANY CEMENTING.

I hereby certify that the statements made herein are true and to the best of my knowledge and belief.

Date: 1-22-02 Signature of Operator or Agent: Leo Dorzweiler Title: Owner

FOR KCC USE:
API # 15-051-05811-0001
Conductor pipe required NONE feet
Minimum surface pipe required 11.36 feet per Alt.
Approved by: RJP 1-29-2002
This authorization expires: 7-29-2002
(This authorization void if drilling not started within 6 months of effective date.)
Spud date: _____ Agent: _____

REMEMBER TO:

- File Drill Pit Application (form CDP-1) with Intent to Drill;
- File Completion Form ACO-1 within 120 days of spud date;
- File acreage attribution plat according to field proration orders;
- Notify appropriate district office 48 hours prior to workover or re-entry;
- Submit plugging report (CP-4) after plugging is completed;
- Obtain written approval before disposing or injecting salt water.

Mail to: Conservation Division, 200 Colorado Derby Building, 202 W. First St., Wichita, Kansas 67202-1286.

22
11
172

IN ALL CASES PLOT THE INTENDED WELL ON THE PLAT BELOW

PLAT OF ACREAGE ATTRIBUTABLE TO A WELL IN A PRORATED OR SPACED FIELD

If the intended well is in a prorated or spaced field, please fully complete this side of the form. If the intended well is in a prorated or spaced field complete the plat below showing that the well will be properly located in relationship to other wells producing from the common source of supply. Please show all the wells within 1 mile of the boundaries of the proposed acreage attribution unit for gas wells and within 1/2 mile of the boundaries of the proposed acreage attribution unit for oil wells.

API NO. 15- 7-25-1937
 OPERATOR Cattlemans Oil Operations
 LEASE Johansen- Schmeidler
 WELL NUMBER 2
 FIELD Benis

LOCATION OF WELL: COUNTY Ellis
330 feet from south/north line of section
1650 feet from east/west line of section
 SECTION 22 TWP 11 RG 17W

NUMBER OF ACRES ATTRIBUTABLE TO WELL 10
 QTR/QTR/QTR OF ACREAGE NE - NW - NE

IS SECTION X REGULAR or IRREGULAR
IF SECTION IS IRREGULAR, LOCATE WELL FROM NEAREST CORNER BOUNDARY.

Section corner used: X NE NW SE SW

PLAT

(Show location of the well and shade attributable acreage for prorated or spaced wells.)
 (Show footage to the nearest lease or unit boundary line.)

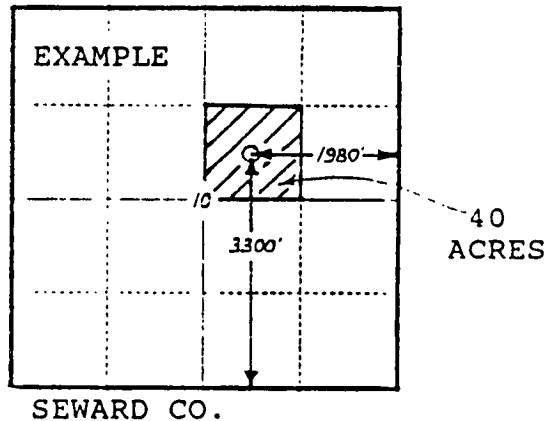
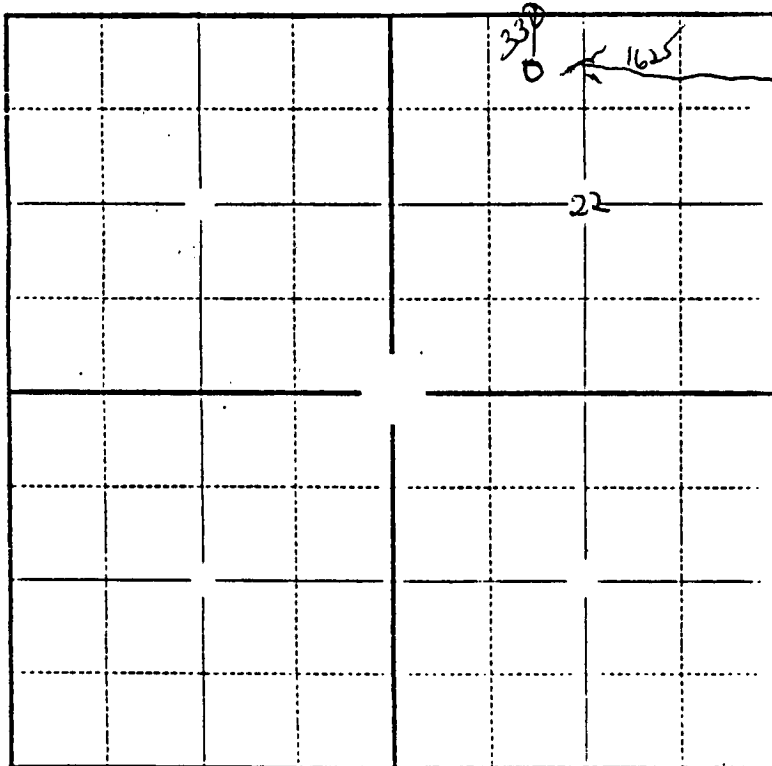

In plotting the proposed location of the well, you must show:

- 1) The manner in which you are using the depicted plat by identifying section lines, i.e. 1 section, 1 section with 8 surrounding sections, 4 sections, etc.;
- 2) the distance of the proposed drilling location from the section's south/north and east/west lines; and
- 3) the distance to the nearest lease or unit boundary line.