

15-051-24837-0000

FORM C-1 7/91

FORM MUST BE TYPED

FORM MUST BE SIGNED

ALL BLANKS MUST BE FILLED

FOR KCC USE:

EFFECTIVE DATE: 5-23-93

DISTRICT # 4

SGAT Yes No

State of Kansas
NOTICE OF INTENTION TO DRILL

Must be approved by the K.C.C. five (5) days prior to commencing well

Expected Spud Date 6 30 93
month day year

Spot SE/4 of NE/4 Sec 8 Twp 13 S Rg 20 East West

OPERATOR: License # 3127
Name: Midwest Energy, Inc.
Address: 1330 Canterbury
City/State/Zip: Hays, Ks. 67601
Contact Person: De Sultzer
Phone: 913-625-3437 Fax - 625-9218

2665 feet from South / ~~XXXX~~ line of Section
452 feet from East / ~~XXXX~~ line of Section
IS SECTION X REGULAR IRREGULAR?

(NOTE: Locate well on the Section Plat on Reverse Side)

County: Ellis
Lease Name: City of Ellis Well #: 4R
Field Name: N/A

CONTRACTOR: License #: Same as Above
Name: Rick Young Drilling

Is this a Prorated/Spaced Field? N/A yes no

Target Formation(s): Blue Hills

Nearest lease or unit boundary: East Line

Ground Surface Elevation: Est 2130 feet MSL

Water well within one-quarter mile: X yes no

Public water supply well within one mile: X yes no

Depth to bottom of fresh water: 50 Feet

Depth to bottom of usable water: N/A

Surface Pipe by Alternate: X 1 2

Length of Surface Pipe Planned to be set: 70'

Length of Conductor pipe required: None

Projected Total Depth: 200 Feet

Formation at Total Depth: Blue Hills Shale

Water Source for Drilling Operations:

X well farm pond other

DWR Permit #: Yes

Will Cores Be Taken?: yes X no

If yes, proposed zone:

Well Drilled For: Well Class: Type Equipment:

Oil Enh Rec Infield X Mud Rotary
Gas Storage Pool Ext. Air Rotary
OWWO Disposal Wildcat Cable
Seismic; # of Holes Other
X Other Cathodic Protection Deep Anode Bed*

If OWWO: old well information as follows:

Operator:
Well Name:
Comp. Date: Old Total Depth

Directional, Deviated or Horizontal wellbore? yes X no

If yes, true vertical depth:

Bottom Hole Location:

AFFIDAVIT

The undersigned hereby affirms that the drilling, completion and eventual plugging of this well will comply with K.S.A. 55-101, et. seq.

It is agreed that the following minimum requirements will be met:

- 1. Notify the appropriate district office prior to spudding of well;
- 2. A copy of the approved notice of intent to drill shall be posted on each drilling rig;
- 3. The minimum amount of surface pipe as specified below shall be set by circulating cement to the top; in all cases surface pipe shall be set through all unconsolidated materials plus a minimum of 20 feet into the underlying formation;
- 4. If the well is dry hole, an agreement between the operator and the district office on plug length and placement is necessary prior to plugging;
- 5. The appropriate district office will be notified before well is either plugged or production casing is cemented in;
- 6. IF AN ALTERNATE II COMPLETION, PRODUCTION PIPE SHALL BE CEMENTED FROM BELOW ANY USABLE WATER TO SURFACE WITHIN 120 DAYS OF SPUD DATE. IN ALL CASES, NOTIFY DISTRICT OFFICE PRIOR TO ANY CEMENTING.

I hereby certify that the statements made herein are true and to the best of my knowledge and belief.

Date: 5-13-93 Signature of Operator or Agent: [Signature] Title: Corrosion Technician

RECEIVED
STATE CORPORATION COMMISSION
MAY 12 1993
CONSERVATION DIVISION
Wichita, Kansas

FOR KCC USE:
API # 15- 051-24837-0000
Conductor pipe required None feet
Minimum surface pipe required 76' feet per Alt. (1+2) (3)
Approved by: CB 5-18-93
This authorization expires: 11-18-93
(This authorization void if drilling not started within 6 months of effective date.)
Spud date: Agent:

REMEMBER TO:

- File Drill Pit Application (form CDP-1) with Intent to Drill;
- File Completion Form ACO-1 within 120 days of spud date;
- File acreage attribution plat according to field prorations orders;
- Notify appropriate district office 48 hours prior to workover or re-entry;
- Submit plugging report (CP-4) after plugging is completed;
- Obtain written approval before disposing or injecting salt water.

Mail to: Conservation Division, 200 Colorado Derby Building, 202 W. First St., Wichita, Kansas 67202-1286

RECEIVED
STATE CORPORATION COMMISSION
MAY 17 1993
CONSERVATION DIVISION
Wichita, Kansas

IN ALL CASES PLOT THE INTENDED WELL ON THE PLAT BELOW

PLAT OF ACREAGE ATTRIBUTABLE TO A WELL IN A PRORATED OR SPACED FIELD

If the intended well is in a prorated or spaced field, please fully complete this side of the form. If the intended well is in a prorated or spaced field complete the plat below showing that the well will be properly located in relationship to other wells producing from the common source of supply. Please show all the wells within 1 mile of the boundaries of the proposed acreage attribution unit for gas wells and within 1/2 mile of the boundaries of the proposed acreage attribution unit for oil wells.

API NO. 15- _____
 OPERATOR _____
 LEASE _____
 WELL NUMBER _____
 FIELD _____

LOCATION OF WELL: COUNTY Ellis

2100 feet from ~~south~~/north line of section
452 feet from east/~~west~~ line of section
 SECTION 8 TWP 13 RG 20

NUMBER OF ACRES ATTRIBUTABLE TO WELL _____
 QTR/QTR/QTR OF ACREAGE _____ - _____ - _____

IS SECTION x REGULAR or _____ IRREGULAR
IF SECTION IS IRREGULAR, LOCATE WELL FROM NEAREST CORNER BOUNDARY.

Section corner used: _____ NE _____ NW _____ SE _____ SW

PLAT

(Show location of the well and shade attributable acreage for prorated or spaced wells.)
 (Show footage to the nearest lease or unit boundary line.)

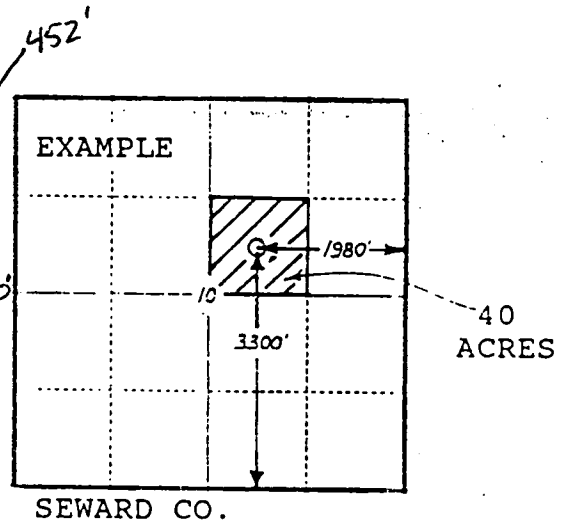
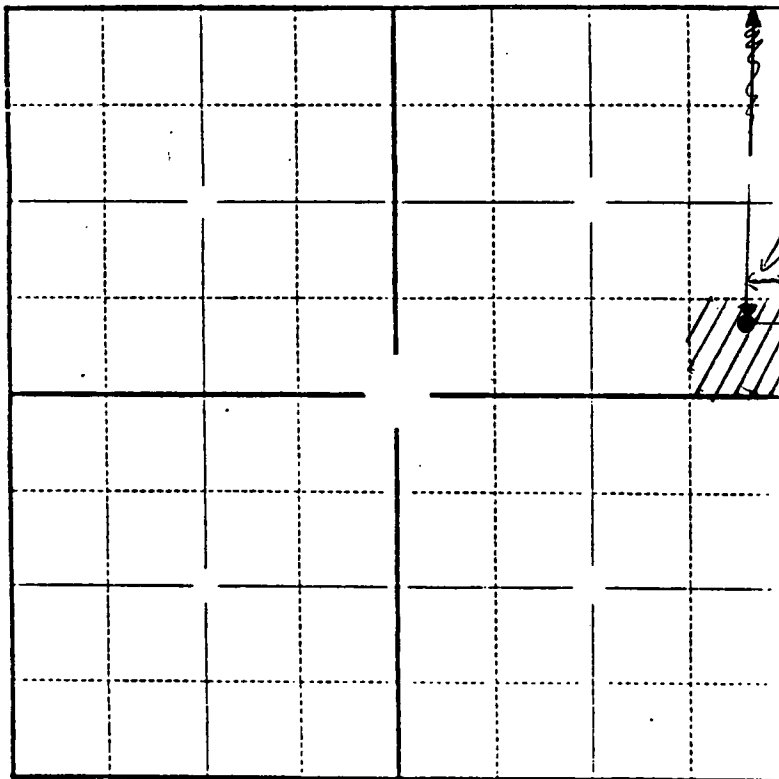

In plotting the proposed location of the well, you must show:

- 1) The manner in which you are using the depicted plat by identifying section lines, i.e. 1 section, 1 section with 8 surrounding sections, 4 sections, etc.;
- 2) the distance of the proposed drilling location from the section's south/north and east/west lines; and
- 3) the distance to the nearest lease or unit boundary line.

Chris DEEP ANODE BED

15-087-24381-00-01

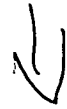

W. S. Subgen

(Refer to D.S.P 9107.1 for specific standards)

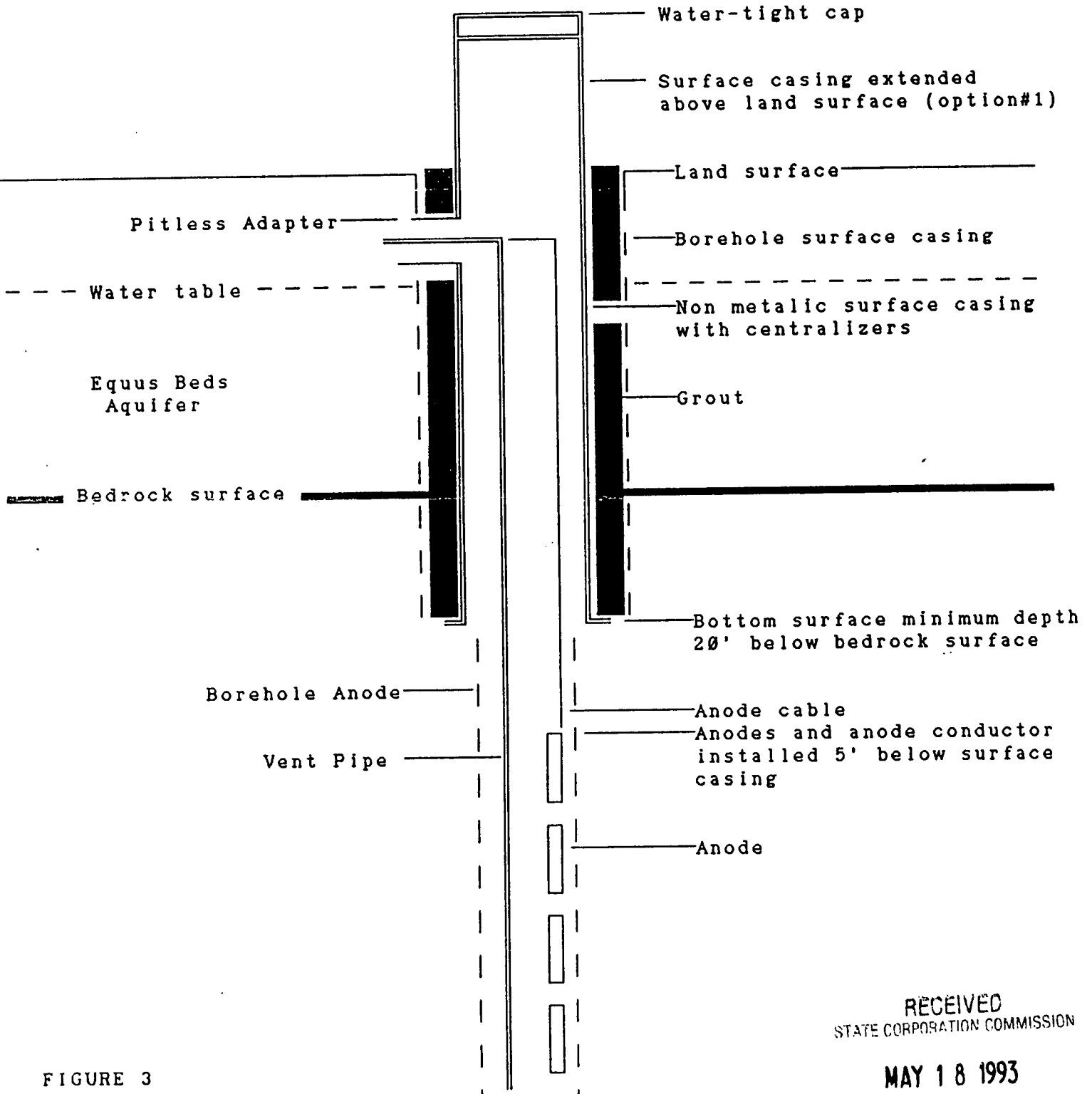

FIGURE 3

RECEIVED
STATE CORPORATION COMMISSION

MAY 18 1993

CONSERVATION DIVISION
Wichita, Kansas