

FOR KCC USE:

15-051-24838-0000 FORM C-1 7/91

EFFECTIVE DATE: 5-23-93

FORM MUST BE TYPED

DISTRICT # 4

State of Kansas
NOTICE OF INTENTION TO DRILL

FORM MUST BE SIGNED

SGA? Yes... No

Must be approved by the K.C.C. five (5) days prior to commencing well

ALL BLANKS MUST BE FILLED

Expected Spud Date 6 30 93
month day year

Spot SE/4 of NE/4 Sec 8 Twp 13 S Rg 20 East
West

OPERATOR: License # 3127
Name: Midwest Energy Inc.
Address: 1330 Canterbury Rd.
City/State/Zip: Hays, Ks. 67601
Contact Person: De Sultzer
Phone: 913-625-3437 Fax: 625-9218
(913) 625 3088 De Sultzer

2630 feet from South / North line of Section
863' feet from East / West line of Section
IS SECTION X REGULAR IRREGULAR?
(NOTE: Locate well on the Section Plat on Reverse Side)

CONTRACTOR: License #: Same as above
Name: Rick Young Drilling

County: Ellis
Lease Name: City of Ellis Well #: 1R
Field Name: N/A
Is this a Prorated/Spaced Field? N/A yes no
Target Formation(s): Blue Hills
Nearest lease or unit boundary: East Line
Ground Surface Elevation: Est. 2114 feet MSL
Water well within one-quarter mile: X yes no
Public water supply well within one mile: X yes no
Depth to bottom of fresh water: 50 Feet
Depth to bottom of usable water: N/A
Surface Pipe by Alternate: X 1 2
Length of Surface Pipe Planned to be set: 70'
Length of Conductor pipe required: None
Projected Total Depth: 200 Feet
Formation at Total Depth: Blue Hills Shale
Water Source for Drilling Operations:

Well Drilled For: Well Class: Type Equipment:
Oil Enh Rec Infield Mud Rotary
Gas Storage Pool Ext Air Rotary
OWWO Disposal Wildcat Cable
Seismic; # of Holes Other
X Other Cathodic Protection Deep Anode Bed

If OWWO: old well information as follows:
Operator:
Well Name:
Comp. Date: Old Total Depth

Directional, Deviated or Horizontal wellbore? yes X no
If yes, true vertical depth:
Bottom Hole Location:

AFFIDAVIT

The undersigned hereby affirms that the drilling, completion and eventual plugging of this well will comply with K.S.A. 55-101, et. seq.

It is agreed that the following minimum requirements will be met:

- 1. Notify the appropriate district office prior to spudding of well;
- 2. A copy of the approved notice of intent to drill shall be posted on each drilling rig;
- 3. The minimum amount of surface pipe as specified below shall be set by circulating cement to the top; in all cases surface pipe shall be set through all unconsolidated materials plus a minimum of 20 feet into the underlying formation;
- 4. If the well is dry hole, an agreement between the operator and the district office on plug length and placement is necessary prior to plugging;
- 5. The appropriate district office will be notified before well is either plugged or production casing is cemented in;
- 6. IF AN ALTERNATE II COMPLETION, PRODUCTION PIPE SHALL BE CEMENTED FROM BELOW ANY USABLE WATER TO SURFACE WITHIN 120 DAYS OF SPUD DATE. IN ALL CASES, NOTIFY DISTRICT OFFICE PRIOR TO ANY CEMENTING.

I hereby certify that the statements made herein are true and to the best of my knowledge and belief.

Date: 5-23-93 Signature of Operator or Agent: De Sultzer Title: Corrosion Technician

RECEIVED
MAY 12 1993
05-12-93
WICHITA DIVISION
Wichita, Kansas

FOR KCC USE:
KAPI # 15- 051-24838-0000
Conductor pipe required None feet
Minimum surface pipe required 70 feet per Alt. X
Approved by: C.B. 5-18-93
This authorization expires: 11-18-93
(This authorization void if drilling not started within 6 months of effective date.)
Spud date: Agent:

REMEMBER TO:

- File Drill Pit Application (form CDP-1) with Intent to Drill;
- File Completion Form ACO-1 within 120 days of spud date;
- File acreage attribution plat according to field proration orders;
- Notify appropriate district office 48 hours prior to workover or re-entry;
- Submit plugging report (CP-4) after plugging is completed;
- Obtain written approval before disposing or injecting salt water.

Mail to: Conservation Division, 200 Colorado Derby Building, 202 W. First St., Wichita, Kansas 67202-1288

RECEIVED
MAY 17 1993
05-13-93
CONSERVATION DIVISION
Wichita, Kansas

8
13
20

IN ALL CASES PLOT THE INTENDED WELL ON THE PLAT BELOW

PLAT OF ACREAGE ATTRIBUTABLE TO A WELL IN A PRORATED OR SPACED FIELD

If the intended well is in a prorated or spaced field, please fully complete this side of the form. If the intended well is in a prorated or spaced field complete the plat below showing that the well will be properly located in relationship to other wells producing from the common source of supply. Please show all the wells within 1 mile of the boundaries of the proposed acreage attribution unit for gas wells and within 1/2 mile of the boundaries of the proposed acreage attribution unit for oil wells.

API NO. 15- _____
OPERATOR _____
LEASE _____
WELL NUMBER _____
FIELD _____

LOCATION OF WELL: COUNTY Ellis
2630 feet from ~~SOUTH~~/north line of section
863' feet from east/~~WEST~~ line of section
SECTION 8 TWP 13 RG 20

NUMBER OF ACRES ATTRIBUTABLE TO WELL _____
QTR/QTR/QTR OF ACREAGE _____

IS SECTION _____ REGULAR or _____ IRREGULAR
IF SECTION IS IRREGULAR, LOCATE WELL FROM NEAREST CORNER BOUNDARY.

Section corner used: _____ NE _____ NW _____ SE _____ SW

PLAT

(Show location of the well and shade attributable acreage for prorated or spaced wells.)

(Show footage to the nearest lease or unit boundary line.)

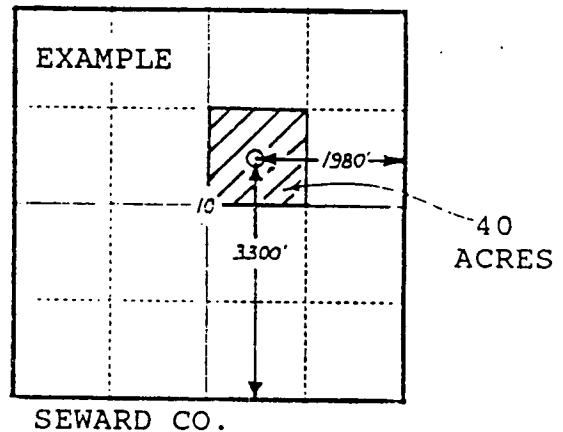
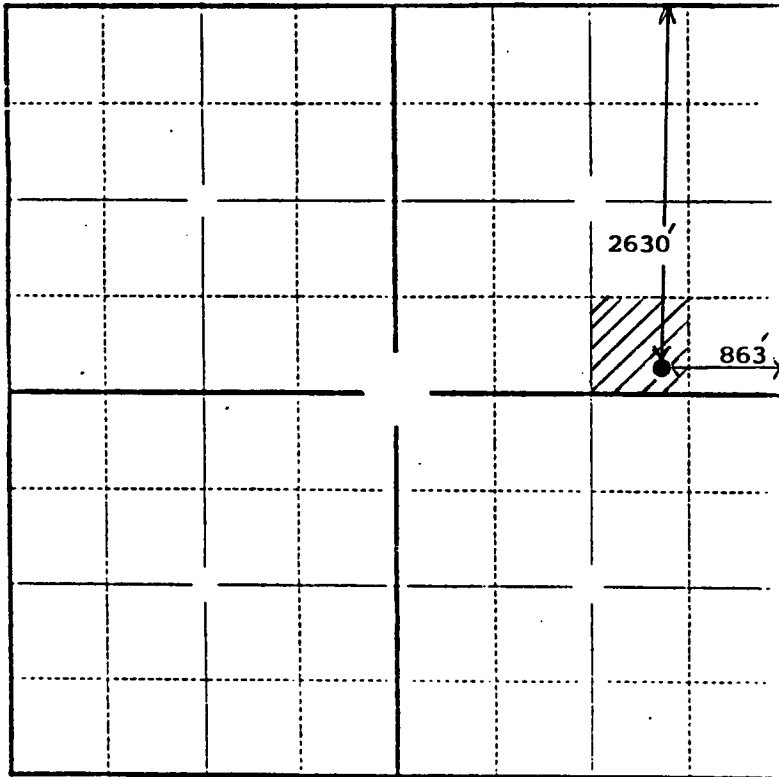

In plotting the proposed location of the well, you must show:

- 1) The manner in which you are using the depicted plat by identifying section lines, i.e. 1 section, 1 section with 8 surrounding sections, 4 sections, etc.;
- 2) the distance of the proposed drilling location from the section's south/north and east/west lines; and
- 3) the distance to the nearest lease or unit boundary line.

CHRIS - DEEP ANODE BED



W. S. Sullivan

15-051-24830-0000

(Refer to D.S.P 9107.1 for specific standards)

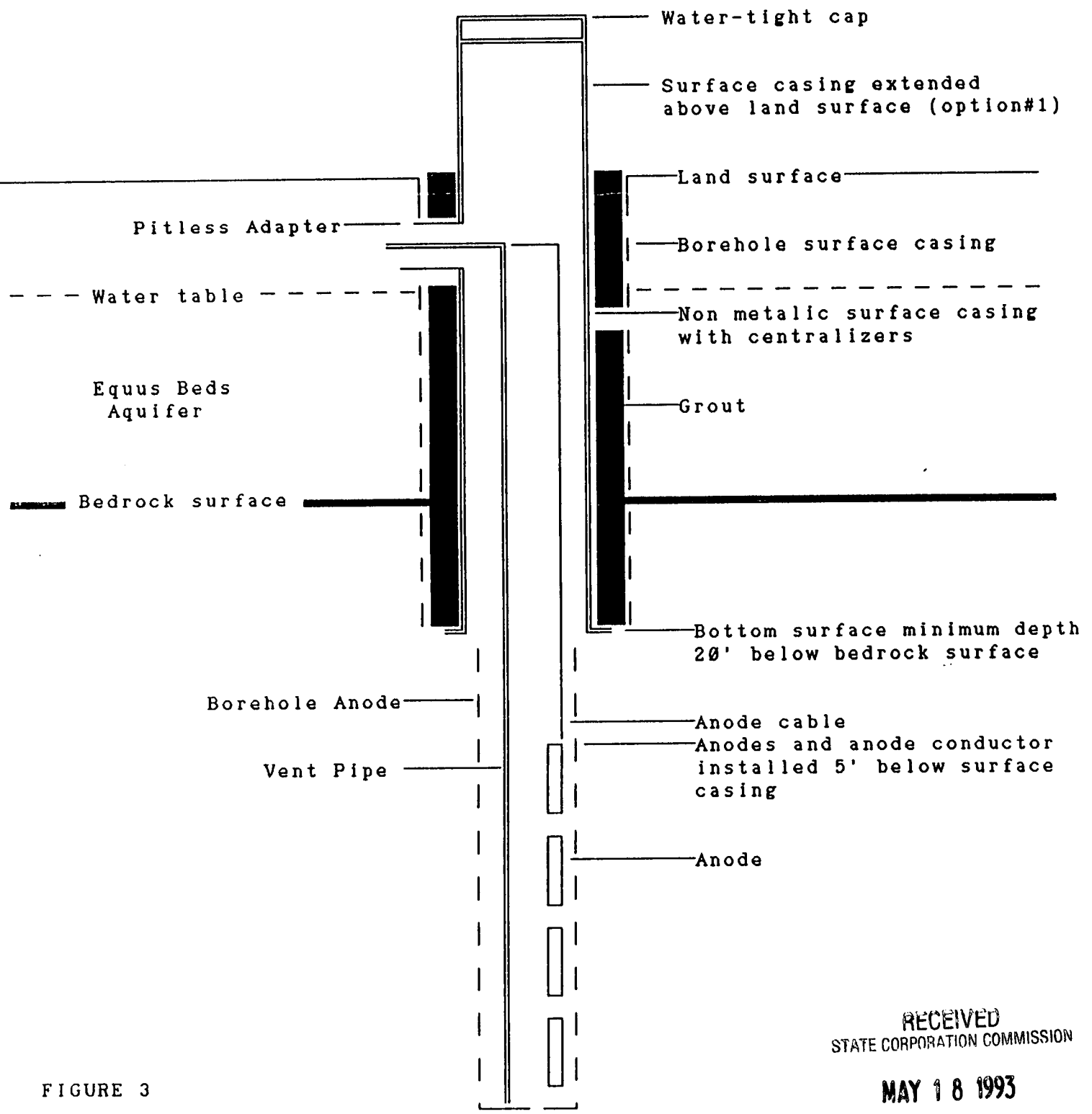

FIGURE 3

RECEIVED
STATE CORPORATION COMMISSION

MAY 18 1993

CONSERVATION DIVISION
Wichita, Kansas