

15-051-84767-0000

FOR KCC USE:

FORM C-1

EFFECTIVE DATE: 10-29-91

FORM MUST BE TY

DISTRICT # 4

State of Kansas
NOTICE OF INTENTION TO DRILL

FORM MUST BE SIG

SEAT Yes No

Must be approved by the K.C.C. five (5) days prior to commencing well

ALL BLANKS MUST BE FILLED

Expected Spud Date October 29, 1991
month day year

Spot C NE NE SW Sec 22 Twp 13 S Rg 18X

OPERATOR: License # 3613
Name: Hallwood Petroleum, Inc.
Address: 4582 So. Ulster St. Pkwy #1700
City/State/Zip: Denver, CO 80237
Contact Person: George Hutton
Phone: 316-792-2756

2970 feet from South / North line of Sec
2970 feet from East / West line of Sec
IS SECTION X REGULAR IRREGULAR

(NOTE: Locate well on the Section Plat on Reverse Side)
County: Ellis
Lease Name: Braun "B" Well #: 4
Field Name: Marvin

CONTRACTOR: License #: UNKNOWN AT THIS TIME
Name:

Is this a Prorated/Spaced Field? yes X no
Target Formation(s): Arbuckle
Nearest lease or unit boundary: 2310

Well Drilled For: Well Class: Type Equipment:
X Oil ... Enh Rec .X Infield .X Mud Rotary
... Gas ... Storage ... Pool Ext. ... Air Rotary
... OWWO ... Disposal ... Wildcat ... Cable
... Seismic; ... # of Holes ... Other

Ground Surface Elevation: feet
Water well within one-quarter mile: X yes
Public water supply well within one mile: yes X

If OWWO: old well information as follows:
Operator:
Well Name:
Comp. Date: Old Total Depth

Depth to bottom of fresh water: 600
Depth to bottom of usable water: 650
Surface Pipe by Alternate: 1 X 300'
Length of Surface Pipe Planned to be set: 300'
Length of Conductor pipe required: N/A

Directional, Deviated or Horizontal wellbore? yes X no
If yes, true vertical depth:
Bottom Hole Location:

Projected Total Depth: 3800'
Formation at Total Depth: Arbuckle
Water Source for Drilling Operations:
... well ... farm pond ... of

DWR Permit #:
Will Cores Be Taken? yes no
If yes, proposed zone:

AFFIDAVIT

The undersigned hereby affirms that the drilling, completion and eventual plugging of this well will comply with K.S.A. 5-101, et. seq.
It is agreed that the following minimum requirements will be met:

- 1. Notify the appropriate district office prior to spudding of well;
- 2. A copy of the approved notice of intent to drill shall be posted on each drilling rig;
- 3. The minimum amount of surface pipe as specified below shall be set by circulating cement to the top; in all cases surface pipe shall be set through all unconsolidated materials plus a minimum of 20 feet into the underlying formation;
- 4. If the well is dry hole, an agreement between the operator and the district office on plug length and placement necessary prior to plugging;
- 5. The appropriate district office will be notified before well is either plugged or production casing is cemented in;
- 6. IF AN ALTERNATE II COMPLETION, PRODUCTION PIPE SHALL BE CEMENTED FROM BELOW ANY USABLE WATER TO SURFACE WITHIN 120 D' OF SPUD DATE. IN ALL CASES, NOTIFY DISTRICT OFFICE PRIOR TO ANY CEMENTING.

I hereby certify that the statements made herein are true and to the best of my knowledge and belief.
Date: 10/21/91 Signature of Operator or Agent: Title: Sr. Engineering Tech.

FOR KCC USE:
API # 15- 051-24,767-0000
Conductor pipe required 1000 feet
Minimum surface pipe required 100 feet per Alt. (C)
Approved by: [Signature] 10-24-91
This authorization expires: 4-24-92
(This authorization void if drilling not started within 6 months of effective date.)
Spud date: Agent:

RECEIVED
KANSAS CORPORATION COMMISSION
OCT 23 1991
CONSERVATION DIVISION
WICHITA, KS
22 13 1800

- REMEMBER TO:
- File Drill Pit Application (form CDP-1) with Intent to Drill;
 - File Completion Form ACO-1 within 120 days of spud date;
 - File acreage attribution plat according to field proration orders;
 - Notify appropriate district office 48 hours prior to workover or re-entry;
 - Submit plugging report (CP-4) after plugging is completed;
 - Obtain written approval before disposing or injecting salt water.

Mail to: Conservation Division, 200 Colorado Derby Building, 202 W. First St., Wichita, Kansas 67202-1286.

IN ALL CASES PLOT THE INTENDED WELL ON THE PLAT BELOW

PLAT OF ACREAGE ATTRIBUTABLE TO A WELL IN A PRORATED OR SPACED FIELD

If the intended well is in a prorated or spaced field, please fully complete this side of the form. If the intended well is in a prorated or spaced field complete the plat below showing that the well will be properly located in relationship to other wells producing from the common source of supply. Please show all the wells within 1 mile of the boundaries of the proposed acreage attribution unit for gas wells and within 1/2 mile of the boundaries of the proposed acreage attribution unit for oil wells.

API NO. 15- _____
 OPERATOR Hallwood Petroleum, Inc.
 LEASE Braun B
 WELL NUMBER #4
 FIELD Marvin

LOCATION OF WELL: COUNTY Ellis
2970 feet from south/north line of section
2970 feet from east/west line of section
 SECTION 22 TWP 135 RG 18W

NUMBER OF ACRES ATTRIBUTABLE TO WELL 10
 QTR/QTR/QTR OF ACREAGE C/NE - NE - SW

IS SECTION X REGULAR or _____ IRREGULAR
IF SECTION IS IRREGULAR, LOCATE WELL FROM NEAREST CORNER BOUNDARY.

Section corner used: _____ NE _____ NW _____ SE _____ SW

PLAT

(Show location of the well and shade attributable acreage for prorated or spaced wells.)
 (Show footage to the nearest lease or unit boundary line.)

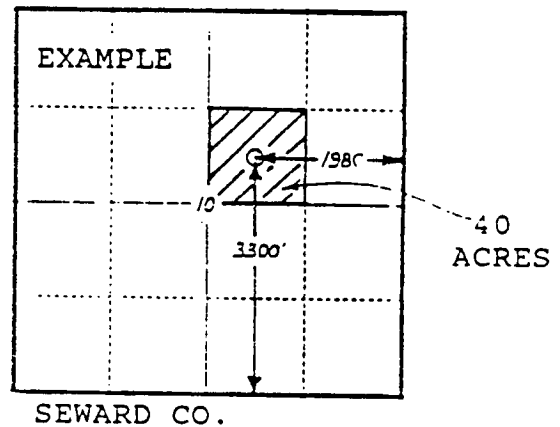
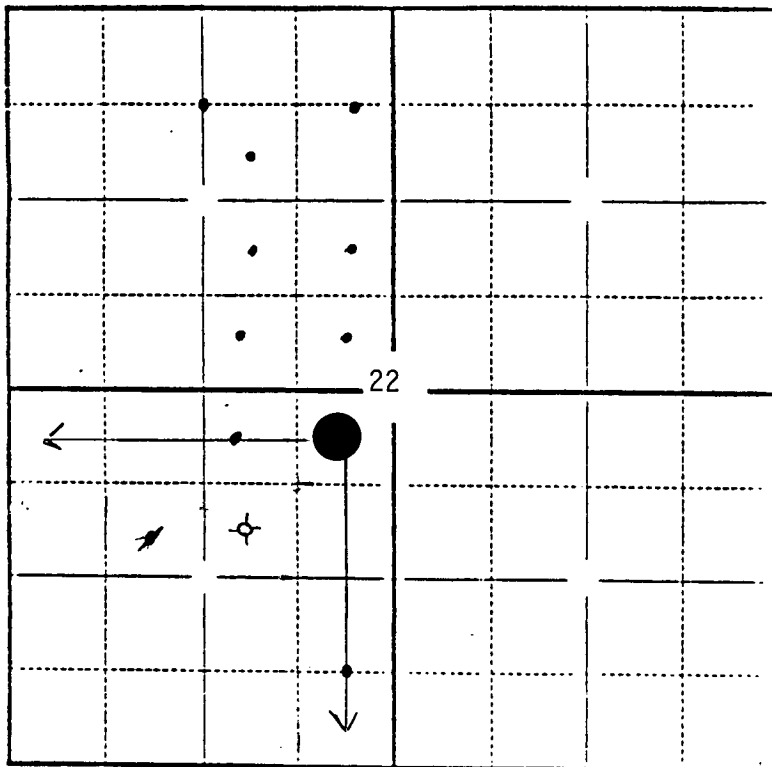

In plotting the proposed location of the well, you must show:

- 1) The manner in which you are using the depicted plat by identifying section lines, i.e. 1 section, 1 section with 8 surrounding sections, 4 sections, etc.;
- 2) the distance of the proposed drilling location from the section's south/north and east/west lines; and
- 3) the distance to the nearest lease or unit boundary line.