

Collected: 100 F.J. North 5/2-NE/NE

**\*CORRECTED\***

Form C-1  
March 2010

Form must be Typed  
Form must be Signed  
All blanks must be Filled

For KCC Use:  
Effective Date: 3-5-2011  
District # 1  
SGA?  Yes  No

KANSAS CORPORATION COMMISSION  
OIL & GAS CONSERVATION DIVISION

**NOTICE OF INTENT TO DRILL**

Must be approved by KCC five (5) days prior to commencing well

Form KSONA-1, Certification of Compliance with the Kansas Surface Owner Notification Act, MUST be submitted with this form.

Expected Spud Date: 03-08-11  
month day year

OPERATOR: License# 3180  
Name: Deutsch Oil Company  
Address 1: 8100 E. 22nd Street North, Bldg. 600  
Address 2:  
City: Wichita State: Ks Zip: 67226 +  
Contact Person: Kent Deutsch  
Phone: 316-681-3567

CONTRACTOR: License# 34233  
Name: Maverick Drilling LLC

Well Drilled For:  Oil  Gas  
Well Class:  Infield  Pool Ext.  Wildcat  Other  
Type Equipment:  Mud Rotary  Air Rotary  Cable  
Seismic: # of Holes  
Other:

If OWWO: old well information as follows:  
Operator:  
Well Name:  
Original Completion Date: Original Total Depth:

Directional, Deviated or Horizontal wellbore?  Yes  No  
If Yes, true vertical depth:  
Bottom Hole Location:  
KCC DKT #:

\*WAS: S/2-NE-NE; 4290' FSL  
IS: 100' N of S/2-NE-NE; 4390' FSL

Spot Description:  
\* S/2 - NE - NE Sec. 24 Twp. 26 S. R. 12  E  W  
4,390 feet from  N /  S Line of Section  
660 feet from  E /  W Line of Section

Is SECTION:  Regular  Irregular?  
(Note: Locate well on the Section Plat on reverse side)

County: Pratt  
Lease Name: Hoover Well #: 3-24

Field Name: Lela east  
Is this a Prorated / Spaced Field?  Yes  No

Target Formation(s): Viola  
Nearest Lease or unit boundary line (in footage): 660

Ground Surface Elevation: 1883 feet MSL  
Water well within one-quarter mile:  Yes  No

Public water supply well within one mile:  Yes  No  
Depth to bottom of fresh water: 50

Depth to bottom of usable water: 180  
Surface Pipe by Alternate:  I  II

Length of Surface Pipe Planned to be set: 260  
Length of Conductor Pipe (if any): none

Projected Total Depth: 4200  
Formation at Total Depth: Viola

Water Source for Drilling Operations:  
 Well  Farm Pond  Other:  
DWR Permit #:

(Note: Apply for Permit with DWR)   
Will Cores be taken?  Yes  No  
If Yes, proposed zone:

RECEIVED  
MAR 03 2011

KCC WICHITA

**AFFIDAVIT**

The undersigned hereby affirms that the drilling, completion and eventual plugging of this well will comply with K.S.A. 55 et. seq.  
It is agreed that the following minimum requirements will be met:

1. Notify the appropriate district office prior to spudding of well;
2. A copy of the approved notice of intent to drill shall be posted on each drilling rig;
3. The minimum amount of surface pipe as specified below shall be set by circulating cement to the top; in all cases surface pipe shall be set through all unconsolidated materials plus a minimum of 20 feet into the underlying formation.
4. If the well is dry hole, an agreement between the operator and the district office on plug length and placement is necessary prior to plugging;
5. The appropriate district office will be notified before well is either plugged or production casing is cemented in;
6. If an ALTERNATE II COMPLETION, production pipe shall be cemented from below any usable water to surface within 120 DAYS of spud date. Or pursuant to Appendix "B" - Eastern Kansas surface casing order #133,891-C, which applies to the KCC District 3 area, alternate II cementing must be completed within 30 days of the spud date or the well shall be plugged. In all cases, NOTIFY district office prior to any cementing.

I hereby certify that the statements made herein are true and to the best of my knowledge and belief.

Date: 03-02-11 Signature of Operator or Agent: [Signature] Title: Owner

For KCC Use ONLY  
API # 15 - 151-22372-0000  
Conductor pipe required None feet  
Minimum surface pipe required 200 feet per ALT.  I  II  
Approved by: [Signature] / Per 2-28-2011 / Rev 3-4-2011  
This authorization expires: 2-28-2012  
(This authorization void if drilling not started within 12 months of approval date.)  
Spud date: Agent:

- Remember to:
- File Certification of Compliance with the Kansas Surface Owner Notification Act (KSONA-1) with Intent to Drill;
  - File Drill Pit Application (form CDP-1) with Intent to Drill;
  - File Completion Form ACO-1 within 120 days of spud date;
  - Notify appropriate district office 48 hours prior to workover or re-entry;
  - Submit plugging report (CP-4) after plugging is completed (within 60 days);
  - Obtain written approval before disposing or injecting salt water.
- If well will not be drilled or permit has expired (See: authorized expiration date) please check the box below and return to the address below.

Well will not be drilled or Permit Expired Date: Signature of Operator or Agent:

Mail to: KCC - Conservation Division,  
130 S. Market - Room 2078, Wichita, Kansas 67202

24  
26  
12  
 E  
 W

For KCC Use ONLY

API # 15 - 151-22372-0000

**IN ALL CASES PLOT THE INTENDED WELL ON THE PLAT BELOW**

In all cases, please fully complete this side of the form. Include items 1 through 5 at the bottom of this page.

Operator: Deutsch Oil Company  
 Lease: Hoover  
 Well Number: 3-24  
 Field: Lela east

Location of Well: County: Pratt  
 4,390 feet from  N /  S Line of Section  
 660 feet from  E /  W Line of Section  
 Sec. 24 Twp. 26 S. R. 12  E  W

Number of Acres attributable to well: \_\_\_\_\_  
 QTR/QTR/QTR/QTR of acreage:  -  S/2 - NE - NE

Is Section:  Regular or  Irregular

If Section is Irregular, locate well from nearest corner boundary.

Section corner used:  NE  NW  SE  SW

**PLAT**

Show location of the well. Show footage to the nearest lease or unit boundary line. Show the predicted locations of lease roads, tank batteries, pipelines and electrical lines, as required by the Kansas Surface Owner Notice Act (House Bill 2032).

You may attach a separate plat if desired.

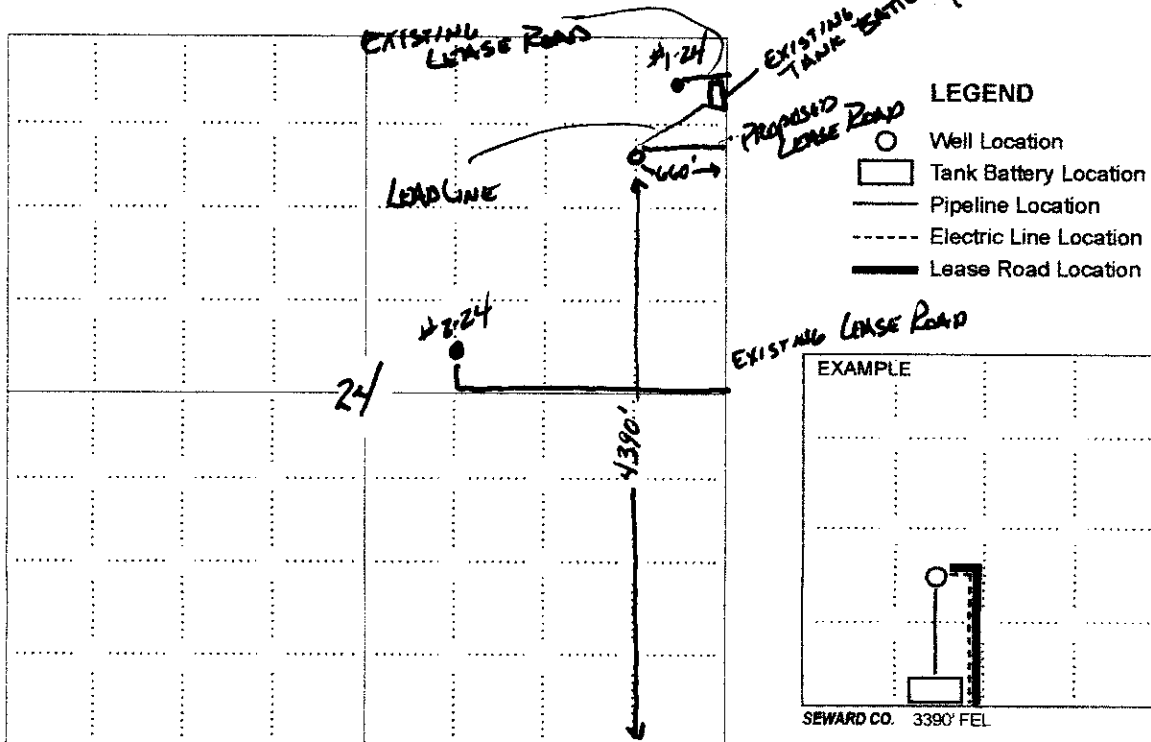

NOTE: In all cases locate the spot of the proposed drilling location.

Pratt County

In plotting the proposed location of the well, you must show:

1. The manner in which you are using the depicted plat by identifying section lines, i.e. 1 section, 1 section with 8 surrounding sections, 4 sections, etc.
2. The distance of the proposed drilling location from the south / north and east / west outside section lines.
3. The distance to the nearest lease or unit boundary line (in footage).
4. If proposed location is located within a prorated or spaced field a certificate of acreage attribution plat must be attached: (CO-7 for oil wells; CG-8 for gas wells).
5. The predicted locations of lease roads, tank batteries, pipelines, and electrical lines.

RECEIVED  
 MAR 03 2011  
 KCC WICHITA

### CERTIFICATION OF COMPLIANCE WITH THE KANSAS SURFACE OWNER NOTIFICATION ACT

This form must be submitted with all Forms C-1 (Notice of Intent to Drill); CB-1 (Cathodic Protection Borehole Intent); T-1 (Request for Change of Operator Transfer of Injection or Surface Pit Permit); and CP-1 (Well Plugging Application). Any such form submitted without an accompanying Form KSONA-1 will be returned.

Select the corresponding form being filed:  C-1 (Intent)  CB-1 (Cathodic Protection Borehole Intent)  T-1 (Transfer)  CP-1 (Plugging Application)

OPERATOR: License # 3180  
Name: Deutsch Oil Company  
Address 1: 8100 E. 22nd Street North, Bldg. 600  
Address 2: \_\_\_\_\_  
City: Wichita State: Ks Zip: 67226 + \_\_\_\_\_  
Contact Person: Kent Deutsch  
Phone: ( 316 ) 681-3567 Fax: ( 316 ) 681-1469  
Email Address: kent@deuschoil.com

Well Location:  
100'  S/2 NE NE Sec. 24 Twp. 26 S. R. 12  East  West  
County: Pratt  
Lease Name: Hoover Well #: 3-24

If filing a Form T-1 for multiple wells on a lease, enter the legal description of the lease below:

**Surface Owner Information:**

Name: Sean & Bryan Allen  
Address 1: 1016 Claflin Rd.  
Address 2: \_\_\_\_\_  
City: Manhattan State: Ks Zip: 66502 + \_\_\_\_\_

When filing a Form T-1 involving multiple surface owners, attach an additional sheet listing all of the information to the left for each surface owner. Surface owner information can be found in the records of the register of deeds for the county, and in the real estate property tax records of the county treasurer.

If this form is being submitted with a Form C-1 (Intent) or CB-1 (Cathodic Protection Borehole Intent), you must supply the surface owners and the KCC with a plat showing the predicted locations of lease roads, tank batteries, pipelines, and electrical lines. The locations shown on the plat are preliminary non-binding estimates. The locations may be entered on the Form C-1 plat, Form CB-1 plat, or a separate plat may be submitted.

**Select one of the following:**

I certify that, pursuant to the Kansas Surface Owner Notice Act (House Bill 2032), I have provided the following to the surface owner(s) of the land upon which the subject well is or will be located: 1) a copy of the Form C-1, Form CB-1, Form T-1, or Form CP-1 that I am filing in connection with this form; 2) if the form being filed is a Form C-1 or Form CB-1, the plat(s) required by this form; and 3) my operator name, address, phone number, fax, and email address.

I have not provided this information to the surface owner(s). I acknowledge that, because I have not provided this information, the KCC will be required to send this information to the surface owner(s). To mitigate the additional cost of the KCC performing this task, I acknowledge that I am being charged a \$30.00 handling fee, payable to the KCC, which is enclosed with this form.

If choosing the second option, submit payment of the \$30.00 handling fee with this form. If the fee is not received with this form, the KSONA-1 form and the associated Form C-1, Form CB-1, Form T-1, or Form CP-1 will be returned.

I hereby certify that the statements made herein are true and correct to the best of my knowledge and belief.

Date: 03-02-11 Signature of Operator or Agent:  Title: Owner

Mail to: KCC - Conservation Division, 130 S. Market - Room 2078, Wichita, Kansas 67202

RECEIVED  
MAR 03 2011  
KCC WICHITA

**KANSAS CORPORATION COMMISSION  
OIL & GAS CONSERVATION DIVISION  
APPLICATION FOR SURFACE PIT**

Form CDP-1  
May 2010  
Form must be Typed

*Submit in Duplicate*

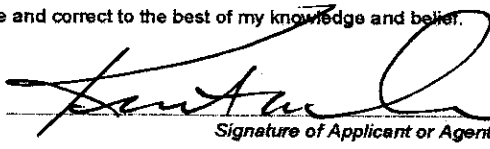
Operator Name: <b>Deutsch Oil Company</b>		License Number: <b>3180</b>	
Operator Address: <b>8100 E. 22nd Street North, Bldg. 600</b>		<b>Wichita Ks 67226</b>	
Contact Person: <b>Kent Deutsch</b>		Phone Number: <b>316-681-3567</b>	
Lease Name & Well No.: <b>Hoover 3-24</b>		Pit Location (QQQQ): 100 ft. North <u>S/2</u> <u>NE</u> <u>NE</u> Sec. <u>24</u> Twp. <u>26</u> R. <u>12</u> <input type="checkbox"/> East <input checked="" type="checkbox"/> West 4,390 Feet from <input type="checkbox"/> North / <input checked="" type="checkbox"/> South Line of Section 660 Feet from <input checked="" type="checkbox"/> East / <input type="checkbox"/> West Line of Section <b>Pratt</b> County	
Type of Pit: <input type="checkbox"/> Emergency Pit <input type="checkbox"/> Burn Pit <input type="checkbox"/> Settling Pit <input checked="" type="checkbox"/> Drilling Pit <input type="checkbox"/> Workover Pit <input type="checkbox"/> Haul-Off Pit <small>(If W/P Supply API No. or Year Drilled)</small>	Pit is: <input checked="" type="checkbox"/> Proposed <input type="checkbox"/> Existing If Existing, date constructed: _____ Pit capacity: _____ (bbis)		
Is the pit located in a Sensitive Ground Water Area? <input checked="" type="checkbox"/> Yes <input type="checkbox"/> No		Chloride concentration: _____ mg/l <small>(For Emergency Pits and Settling Pits only)</small>	
Is the bottom below ground level? <input checked="" type="checkbox"/> Yes <input type="checkbox"/> No	Artificial Liner? <input type="checkbox"/> Yes <input checked="" type="checkbox"/> No	How is the pit lined if a plastic liner is not used? <b>Bentonite gel</b>	
Pit dimensions (all but working pits): <u>50</u> Length (feet) <u>100</u> Width (feet) <input type="checkbox"/> N/A: Steel Pits		Depth from ground level to deepest point: <u>10</u> (feet) <input type="checkbox"/> No Pit	
If the pit is lined give a brief description of the liner material, thickness and installation procedure.		Describe procedures for periodic maintenance and determining liner integrity, including any special monitoring.	
Distance to nearest water well within one-mile of pit: <u>1111</u> feet    Depth of water well <u>100</u> feet <u>1320</u> feet    Depth of water well <u>80</u> feet		Depth to shallowest fresh water <u>50</u> <u>31</u> feet. <u>6</u> Source of information: <input type="checkbox"/> measured <input type="checkbox"/> well owner <input type="checkbox"/> electric log <input checked="" type="checkbox"/> KDWR	
<b>Emergency, Settling and Burn Pits ONLY:</b> Producing Formation: <u>N/A</u> Number of producing wells on lease: _____ Barrels of fluid produced daily: _____ Does the slope from the tank battery allow all spilled fluids to flow into the pit? <input type="checkbox"/> Yes <input type="checkbox"/> No		<b>Drilling, Workover and Haul-Off Pits ONLY:</b> Type of material utilized in drilling/workover: <u>Chemical Mud and Water</u> Number of working pits to be utilized: <u>3</u> Abandonment procedure: <u>Haul off free fluids, allow to dry then backfill.</u> Drill pits must be closed within 365 days of spud date.	
I hereby certify that the above statements are true and correct to the best of my knowledge and belief.  <u>03-02-11</u> Date		 Signature of Applicant or Agent	
		RECEIVED MAR 03 2011 KCC WICHITA	
<b>KCC OFFICE USE ONLY</b>			
Date Received: <u>3/3/11</u>	Permit Number: _____	Permit Date: <u>3/3/11</u>	Lease Inspection: <input checked="" type="checkbox"/> Yes <input type="checkbox"/> No

15-151-22372-0000

Mail to: KCC - Conservation Division, 130 S. Market - Room 2078, Wichita, Kansas 67202

*City of Preston  
PWS well located 5272' away in: NWNE NW 30-26-11W*

Conservation Division  
Finney State Office Building  
130 S. Market, Rm. 2078  
Wichita, KS 67202-3802



phone: 316-337-6200  
fax: 316-337-6211  
<http://kcc.ks.gov/>

Thomas E. Wright, Chairman  
Ward Loyd, Commissioner

Corporation Commission

Sam Brownback, Governor

~~February 28, 2011~~ March 3, 2011

Deutsch Oil Company  
8100 E. 22<sup>nd</sup> St North Bldg. 600  
Wichita, KS 67226

Re: Drilling Pit Application  
Hoover Lease Well No. 3-24  
NE/4 Sec. 24-26S-12W  
Pratt County, Kansas

Dear Sir or Madam:

District staff has inspected the above referenced location and has determined that the reserve pit shall be constructed **without slots**, the bottom shall be flat and reasonably level, and the free fluids must be removed. The fluids are to be removed from the reserve pit as soon as the Hutchinson Salt section has been drilled through and displacement of the fluids into the reserve pit has occurred. The fluids should be removed again within 96 hours after drilling operations have ceased.

**If production casing is set all completion fluids shall be removed from the working pits daily. NO completion fluids or non-exempt wastes shall be placed in the reserve pit.**

The fluids should be taken to an authorized disposal well. Please call the District Office at (620) 225-8888 when the fluids have been removed. Please file form CDP-5 (August 2008), Exploration and Production Waste Transfer, within 30 days of fluid removal. Conservation division forms are available through our office and on the KCC web site:  
[www.kcc.state.ks.us/conservation/forms](http://www.kcc.state.ks.us/conservation/forms).

**A copy of this letter should be posted in the doghouse along with the approved Intent to Drill. If you have any questions or concerns please feel free to contact the undersigned at the above address.**

Sincerely,

A handwritten signature in black ink, appearing to read "Kathy Haynes".

Kathy Haynes  
Environmental Protection and Remediation Department

cc: File