

OWWO

For KCC Use: 3-21-2011
Effective Date: 2
District # 2
SGA? Yes No

KANSAS CORPORATION COMMISSION
OIL & GAS CONSERVATION DIVISION

Form C-1
March 2010
Form must be Typed
Form must be Signed
All blanks must be Filled

NOTICE OF INTENT TO DRILL

Must be approved by KCC five (5) days prior to commencing well
Form KSONA-1, Certification of Compliance with the Kansas Surface Owner Notification Act, MUST be submitted with this form.

Expected Spud Date: April 2011
month day year

OPERATOR: License# 3942
Name: Orville Monroe dba Big O, L.L.C.
Address 1: 2820 Paseo Dr
Address 2: _____
City: Great Bend State: Ks Zip: 67530 + _____
Contact Person: Orville Monroe
Phone: 620-793-2134
CONTRACTOR: License# 6901
Name: DS&W Well Service, Inc.

Spot Description: _____
S2 S2 NW Sec. 20 Twp. 17 S. R. 10 E W
(Q/Q/Q) _____
2310 feet from N / S Line of Section
1320 feet from E / W Line of Section
Is SECTION: Regular Irregular?

(Note: Locate well on the Section Plat on reverse side)
County: Ellsworth
Lease Name: Schepmann Well #: 2
Field Name: West

Is this a Prorated / Spaced Field? Yes No
Target Formation(s): Lansing-KC

Nearest Lease or unit boundary line (in footage): 330'
Ground Surface Elevation: 1817 KB feet MSL
Water well within one-quarter mile: Yes No
Public water supply well within one mile: Yes No
Depth to bottom of fresh water: 160
Depth to bottom of usable water: 210
Surface Pipe by Alternate: I II
Length of Surface Pipe Planned to be set: 228' Already set
Length of Conductor Pipe (if any): None
Projected Total Depth: 3270
Formation at Total Depth: Top Arbuckle

Water Source for Drilling Operations:
 Well Farm Pond Other: Hauled in
DWR Permit #: _____

(Note: Apply for Permit with DWR)
Will Cores be taken? Yes No
If Yes, proposed zone: _____

Well Drilled For: Oil Gas
Well Class: Enh Rec Storage Disposal
Type Equipment: Infield Pool Ext. Wildcat Other
 Seismic: _____ # of Holes
 Other: _____

If OWWO: old well information as follows:
Operator: Jayhawk Oil Co
Well Name: Schepmann #1
Original Completion Date 7-18-76 Original Total Depth: 3340

Directional, Deviated or Horizontal wellbore? Yes No
If Yes, true vertical depth: _____
Bottom Hole Location: _____
KCC DKT #: _____

(Note: Apply for Permit with DWR)

AFFIDAVIT

The undersigned hereby affirms that the drilling, completion and eventual plugging of this well will comply with K.S.A. 55 et. seq.
It is agreed that the following minimum requirements will be met:

1. Notify the appropriate district office **prior** to spudding of well;
2. A copy of the approved notice of intent to drill **shall be** posted on each drilling rig;
3. The minimum amount of surface pipe as specified below **shall be set** by circulating cement to the top; in all cases surface pipe **shall be set** through all unconsolidated materials plus a minimum of 20 feet into the underlying formation.
4. If the well is dry hole, an agreement between the operator and the district office on plug length and placement is necessary **prior to plugging**;
5. The appropriate district office will be notified before well is either plugged or production casing is cemented in;
6. If an ALTERNATE II COMPLETION, production pipe shall be cemented from below any usable water to surface within **120 DAYS** of spud date. Or pursuant to Appendix "B" - Eastern Kansas surface casing order #133,891-C, which applies to the KCC District 3 area, alternate II cementing must be completed within 30 days of the spud date or the well shall be plugged. **In all cases, NOTIFY district office** prior to any cementing.

I hereby certify that the statements made herein are true and to the best of my knowledge and belief.

Date: 3-14-2011 Signature of Operator or Agent: _____ Title: Owner-Operator

For KCC Use ONLY

API # 15 - 053-20446-00-01
Conductor pipe required None feet
Minimum surface pipe required 228 feet per ALT. I II
Approved by: [Signature] 3-16-2011
This authorization expires: 3-16-2012
(This authorization void if drilling not started within 12 months of approval date.)
Spud date: _____ Agent: _____

Remember to:

- File Certification of Compliance with the Kansas Surface Owner Notification Act (KSONA-1) with Intent to Drill;
- File Drill Pit Application (form CDP-1) with Intent to Drill;
- File Completion Form ACO-1 within 120 days of spud date;
- File acreage attribution plat according to field proration orders;
- Notify appropriate district office 48 hours prior to workover or re-entry;
- Submit plugging report (CP-4) after plugging is completed (within 60 days);
- Obtain written approval before disposing or injecting salt water.
- If well will not be drilled or permit has expired (See: authorized expiration date) please check the box below and return to the address below.

Well will not be drilled or Permit Expired Date: _____
Signature of Operator or Agent: _____

Mail to: KCC - Conservation Division,
130 S. Market - Room 2078, Wichita, Kansas 67202

RECEIVED
MAR 16 2011
KCC WICHITA

20-17-10
 E W

For KCC Use ONLY
 API # 15 - _____

IN ALL CASES PLOT THE INTENDED WELL ON THE PLAT BELOW

In all cases, please fully complete this side of the form. Include items 1 through 5 at the bottom of this page.

Operator: Orville Monroe dba Big O, L.L.C.
 Lease: Schepmann
 Well Number: 2
 Field: West

Location of Well: County: Ellsworth
2310 feet from N / S Line of Section
1320 feet from E / W Line of Section
 Sec. 20 Twp. 17 S. R. 10 E W

Number of Acres attributable to well: 10
 QTR/QTR/QTR/QTR of acreage: C - SW - SE - NW

Is Section: Regular or Irregular

If Section is Irregular, locate well from nearest corner boundary.

Section corner used: NE NW SE SW

PLAT

Show location of the well. Show footage to the nearest lease or unit boundary line. Show the predicted locations of lease roads, tank batteries, pipelines and electrical lines, as required by the Kansas Surface Owner Notice Act (House Bill 2032). You may attach a separate plat if desired.

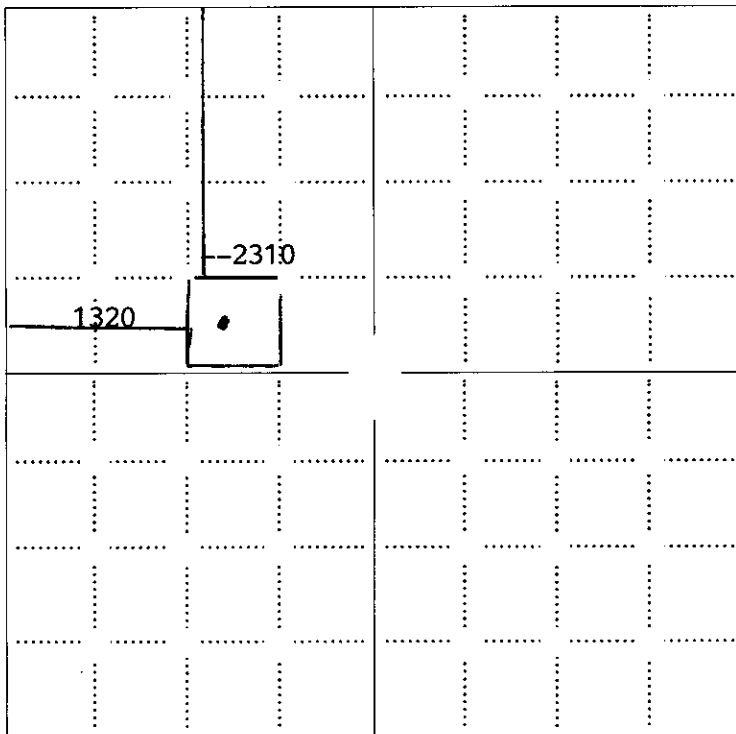

LEGEND

- Well Location
- Tank Battery Location
- Pipeline Location
- Electric Line Location
- Lease Road Location

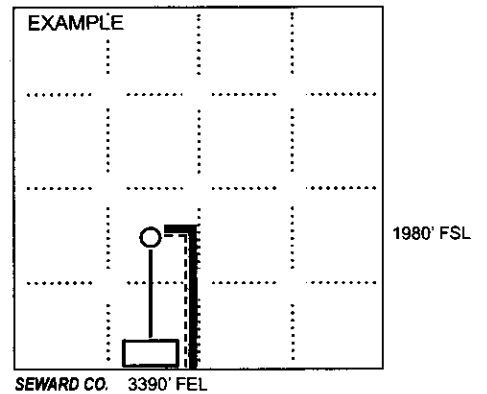

NOTE: In all cases locate the spot of the proposed drilling location.

In plotting the proposed location of the well, you must show:

1. The manner in which you are using the depicted plat by identifying section lines, i.e. 1 section, 1 section with 8 surrounding sections, 4 sections, etc.
2. The distance of the proposed drilling location from the south / north and east / west outside section lines.
3. The distance to the nearest lease or unit boundary line (in footage).
4. If proposed location is located within a prorated or spaced field a certificate of acreage attribution plat must be attached: (CO-7 for oil wells; CG-8 for gas wells).
5. The predicted locations of lease roads, tank batteries, pipelines, and electrical lines.

CENTRAL KANSAS SURVEYING & MAPPING

2344 Washington - Great Bend, Kansas 67530 • (316) 792-5754 or FAX (316) 792-2873

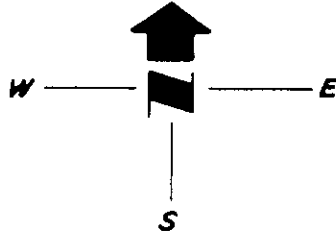

15-053-20446-0001

RECEIVED
MAR 16 2011
KCC WICHITA

330FWL 660FWL 990FWL 1320FWL 1650FWL 1980FWL 2310FWL 2640 2310FEL 1980FEL 1650FEL 1320FEL 990FEL 660FEL 330FEL

Schepmann Lse 20-17-10

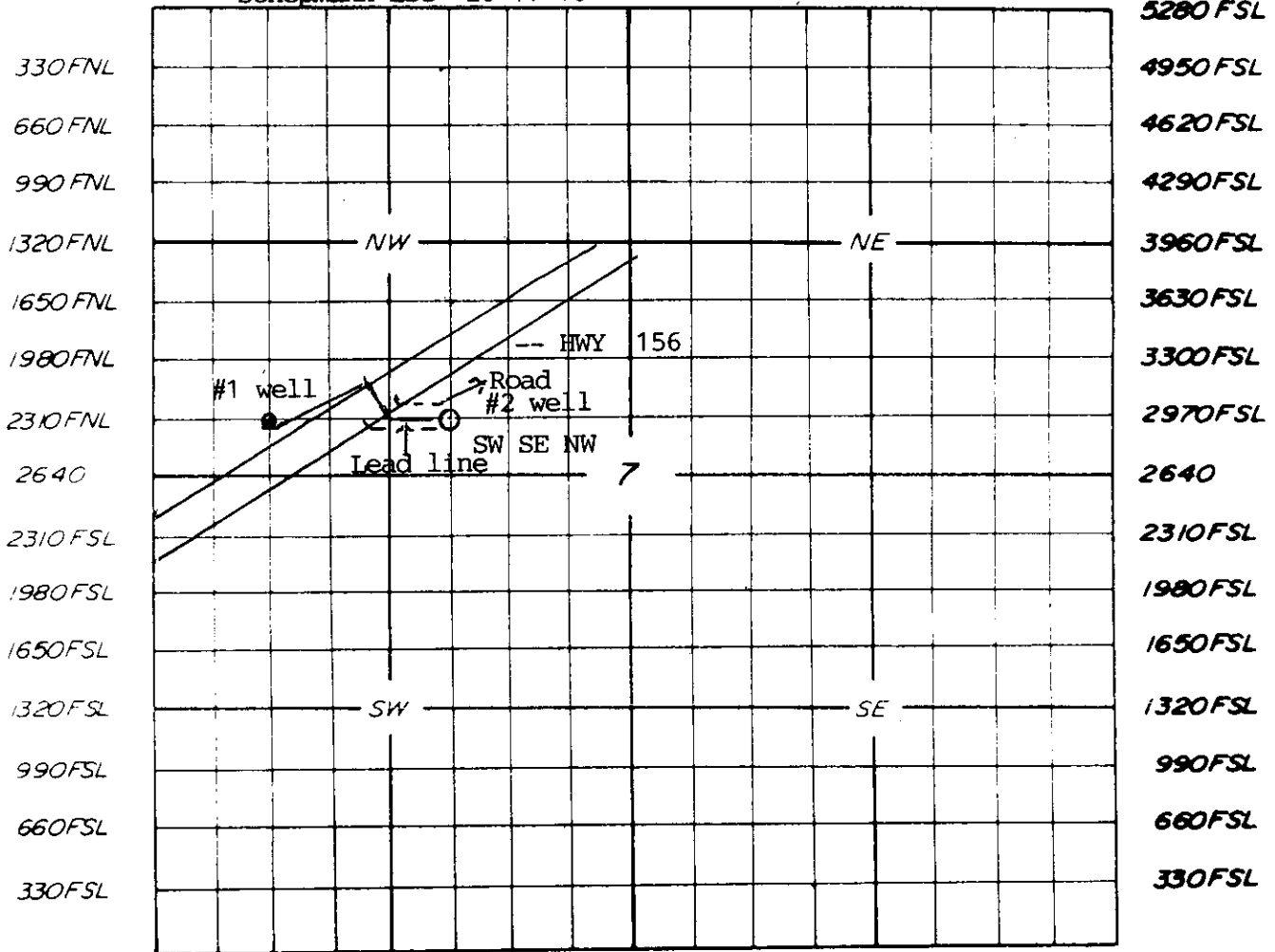

5280FEL 4950FEL 4620FEL 4290FEL 3960FEL 3630FEL 3300FEL 2970FEL 2640 2310FEL 1980FEL 1650FEL 1320FEL 990FEL 660FEL 330FEL

RECEIVED
MAR 10 2011
KCC WICHITA



15-053-20446-00-01
KANSAS CORPORATION COMMISSION
OIL & GAS CONSERVATION DIVISION

Form KSONA-1
July 2010
Form Must Be Typed
Form must be Signed
All blanks must be Filled

**CERTIFICATION OF COMPLIANCE WITH THE
KANSAS SURFACE OWNER NOTIFICATION ACT**

This form must be submitted with all Forms C-1 (Notice of Intent to Drill); CB-1 (Cathodic Protection Borehole Intent); T-1 (Request for Change of Operator Transfer of Injection or Surface Pit Permit); and CP-1 (Well Plugging Application). Any such form submitted without an accompanying Form KSONA-1 will be returned.

Select the corresponding form being filed: C-1 (Intent) CB-1 (Cathodic Protection Borehole Intent) T-1 (Transfer) CP-1 (Plugging Application)

OPERATOR: License # 3942
Name: Orville Monroe dba Big O, L.L.C.
Address 1: 2820 Paseo Dr
Address 2: _____
City: Great Bend State: Ks Zip: 67530 + _____
Contact Person: Orville Monroe
Phone: (620) 793-2134 Fax: (_____) _____
Email Address: _____

Well Location:
SW - SE NW Sec. 20 Twp. 17 S. R. 10 East West
County: Ellsworth
Lease Name: Schepmann Well #: 2

If filing a Form T-1 for multiple wells on a lease, enter the legal description of the lease below:

RECEIVED
MAR 16 2011

Surface Owner Information:

Name: Marlin Sittner
Address 1: 570 3RD Road
Address 2: _____
City: Ellinwood State: Ks Zip: 67526 + _____

When filing a Form T-1 involving multiple surface owners, attach an additional sheet listing all of the information to the left for each surface owner. Surface owner information can be found in the records of the register of deeds for the county, and in the real estate property tax records of the county treasurer.

KCC WICHITA

If this form is being submitted with a Form C-1 (Intent) or CB-1 (Cathodic Protection Borehole Intent), you must supply the surface owners and the KCC with a plat showing the predicted locations of lease roads, tank batteries, pipelines, and electrical lines. The locations shown on the plat are preliminary non-binding estimates. The locations may be entered on the Form C-1 plat, Form CB-1 plat, or a separate plat may be submitted.

Select one of the following:

I certify that, pursuant to the Kansas Surface Owner Notice Act (House Bill 2032), I have provided the following to the surface owner(s) of the land upon which the subject well is or will be located: 1) a copy of the Form C-1, Form CB-1, Form T-1, or Form CP-1 that I am filing in connection with this form; 2) if the form being filed is a Form C-1 or Form CB-1, the plat(s) required by this form; and 3) my operator name, address, phone number, fax, and email address.

I have not provided this information to the surface owner(s). I acknowledge that, because I have not provided this information, the KCC will be required to send this information to the surface owner(s). To mitigate the additional cost of the KCC performing this task, I acknowledge that I am being charged a \$30.00 handling fee, payable to the KCC, which is enclosed with this form.

If choosing the second option, submit payment of the \$30.00 handling fee with this form. If the fee is not received with this form, the KSONA-1 form and the associated Form C-1, Form CB-1, Form T-1, or Form CP-1 will be returned.

I hereby certify that the statements made herein are true and correct to the best of my knowledge and belief.

Date: 3-9-11 Signature of Operator or Agent: [Signature] Title: Owner-Operator

RECEIVED
MAR 10 2011

**KANSAS CORPORATION COMMISSION
OIL & GAS CONSERVATION DIVISION
APPLICATION FOR SURFACE PIT**

Form CDP-1
May 2010
Form must be Typed

Submit in Duplicate

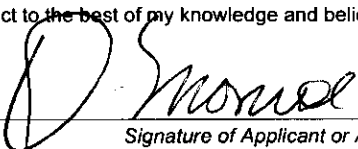
Operator Name: Orville Monroe d/b/a Big O, L.L.C.		License Number: 3942
Operator Address: 2820 Paseo Dr, Great Bend, Ks. 67530		
Contact Person: Orville Monroe		Phone Number: 620-793-2134
Lease Name & Well No.: Schepmann #2		Pit Location (QQQQ): C - SW - NE - NW
Type of Pit: <input type="checkbox"/> Emergency Pit <input type="checkbox"/> Burn Pit <input type="checkbox"/> Settling Pit <input checked="" type="checkbox"/> Drilling Pit <input type="checkbox"/> Workover Pit <input type="checkbox"/> Haul-Off Pit <small>(If WP Supply API No. or Year Drilled)</small>	Pit is: <input checked="" type="checkbox"/> Proposed <input type="checkbox"/> Existing If Existing, date constructed: _____ Pit capacity: 180 (bbls)	Sec. 20 Twp. 17 R. 10 <input type="checkbox"/> East <input checked="" type="checkbox"/> West 2310 Feet from <input checked="" type="checkbox"/> North / <input type="checkbox"/> South Line of Section 1320 Feet from <input type="checkbox"/> East / <input checked="" type="checkbox"/> West Line of Section Ellsworth County
Is the pit located in a Sensitive Ground Water Area? <input type="checkbox"/> Yes <input checked="" type="checkbox"/> No		Chloride concentration: _____ mg/l <small>(For Emergency Pits and Settling Pits only)</small>
Is the bottom below ground level? <input checked="" type="checkbox"/> Yes <input type="checkbox"/> No	Artificial Liner? <input checked="" type="checkbox"/> Yes <input type="checkbox"/> No	How is the pit lined if a plastic liner is not used?
Pit dimensions (all but working pits): 100 Length (feet) 16 Width (feet) <input type="checkbox"/> N/A: Steel Pits Depth from ground level to deepest point: 8 (feet) <input type="checkbox"/> No Pit		
If the pit is lined give a brief description of the liner material, thickness and installation procedure. 25 mil Plastic liner, laid in with sides overlapping and weighted down with native dirt.		Describe procedures for periodic maintenance and determining liner integrity, including any special monitoring. Checking water level each evening and if necessary empty pit each evening when work stop.
Distance to nearest water well within one-mile of pit: 1320 feet Depth of water well 160 feet		Depth to shallowest fresh water 160 ⁴⁰ feet. Source of information: JR-KGS <input type="checkbox"/> measured <input checked="" type="checkbox"/> well owner <input type="checkbox"/> electric log <input type="checkbox"/> KDWR
Emergency, Settling and Burn Pits ONLY: Producing Formation: _____ Number of producing wells on lease: _____ Barrels of fluid produced daily: _____ Does the slope from the tank battery allow all spilled fluids to flow into the pit? <input type="checkbox"/> Yes <input type="checkbox"/> No		Drilling, Workover and Haul-Off Pits ONLY: Type of material utilized in drilling/workover: Fresh water Number of working pits to be utilized: One Abandonment procedure: empty pits & let dry when dry fold in line sides & colse pit Drill pits must be closed within 365 days of spud date.
I hereby certify that the above statements are true and correct to the best of my knowledge and belief.		
3-14-2011 Date		 Signature of Applicant or Agent
KCC OFFICE USE ONLY		
Date Received: 3/16/11 Permit Number: _____ Permit Date: 3/16/11 Lease Inspection: <input type="checkbox"/> Yes <input checked="" type="checkbox"/> No <input checked="" type="checkbox"/> Liner <input type="checkbox"/> Steel Pit <input checked="" type="checkbox"/> RFAC <input type="checkbox"/> RFAS		

RECEIVED
MAR 16 2011

KCC WICHITA

1505320446-0001

15-053-20446-0000

STATE OF KANSAS
STATE CORPORATION COMMISSION
CONSERVATION DIVISION
P. O. BOX 17027
WICHITA, KANSAS 67217

FORM CP-4

WELL PLUGGING RECORD

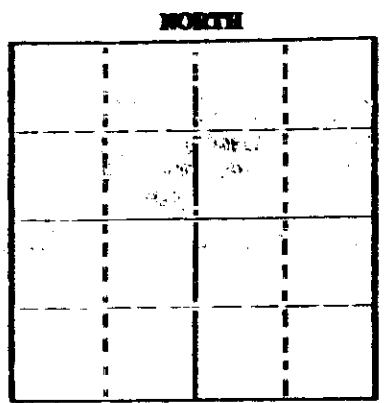

Locate well correctly on above Section Plat

Ellsworth County, Sec. 20 Twp. 17S Rge. (E) 10(W)
 Location as "NE/CNW/SW" or footage from lines SW SE NW
 Lease Owner Jayhawk Oil Co
 Lease Name Schepmann Well No. 1
 Office Address 240 Sutton Place Wichita Kansas 67202
 Character of Well (completed as Oil, Gas or Dry Hole) Dry hole
 Date well completed 7/21 1976
 Application for plugging filed 9/23 1976
 Application for plugging approved 9/27 1976
 Plugging commenced 9/27 1976
 Plugging completed 10/1 1976
 Reason for abandonment of well or producing formation Dry hole

If a producing well is abandoned, date of last production 19
 Was permission obtained from the Conservation Division or its agents before plugging was commenced? Yes

Name of Conservation Agent who supervised plugging of this well Gilbert Toman
 Producing formation Arb. Depth to top 3273 Bottom 3300 Total Depth of Well 3340
 Show depth and thickness of all water, oil and gas formations.

OIL, GAS OR WATER RECORDS

CASING RECORD

FORMATION	CONTENT	FROM	TO	SIZE	FEET IN	WELLFO DIST
	Surface	0	228	8 5/8		
		0	3274	5 1/2		216

RECEIVED
 MAR 16 2011
 KCC WICHITA

Describe in detail the manner in which the well was plugged, indicating where the mud fluid was placed and the method or methods used in introducing it into the hole. If cement or other plugs were used, state the character of same and depth placed, from feet to feet for each plug set.

filled with sand to 3250 and dumped 4 sx. cement
 Squeezed top with Allied Cementers, pumped in 5 sx hulls
 25 sx jell and 100 sx common cement under 600 lbs.

RECEIVED
 STATE CORPORATION COMMISSION

OCT 05 1976

Name of Plugging Contractor Nicholas Casing Pulling
 Address Box 273 Geneseo Kansas 67444
 CONSERVATION DIVISION
 Wichita, Kansas

STATE OF _____ COUNTY OF _____

(employee of owner) or (owner or operator) of the above-described well, being first duly sworn on oath, says: That I have knowledge of the facts, statements, and matters herein contained and the log of the above-described well as filed and that the same are true and correct. So help me God.

(Signature) George A. Nicholas



this 4th day of October 1976
 Glenn M. Stegman
 Notary Public.

My commission expires 7-6-77