

OWWO

For KCC Use: 3-27-2011
Effective Date: 3-27-2011
District #: 4
SGA? Yes No

KANSAS CORPORATION COMMISSION
OIL & GAS CONSERVATION DIVISION

Form C-1
March 2010

Form must be Typed
Form must be Signed
All blanks must be Filled

NOTICE OF INTENT TO DRILL

Must be approved by KCC five (5) days prior to commencing well
Form KSONA-1, Certification of Compliance with the Kansas Surface Owner Notification Act, MUST be submitted with this form.

Expected Spud Date: March 28, 2011
month day year

OPERATOR: License# 34515
Name: 6G Twister, Inc
Address 1: PO Box 1686
Address 2:
City: Gillette State: WY Zip: 82717 +
Contact Person: Tami Graf
Phone: (307) 682-7380

CONTRACTOR: License# 34514
Name: Greene Enterprises of Kansas, Inc

Well Drilled For: Oil Gas
 Enh Rec Storage Disposal
 Seismic; # of Holes
 Other

Well Class: Infield Pool Ext. Wildcat Other

Type Equipment: Mud Rotary Air Rotary Cable

If OWWO: old well information as follows:
Operator: Empire Drilling
Well Name: Madden-Davis 'B' 2
Original Completion Date: 4/14/1954 Original Total Depth: 3648

Directional, Deviated or Horizontal wellbore? Yes No
If Yes, true vertical depth:
Bottom Hole Location:
KCC DKT #:

Spot Description:
NW - NE - SE Sec. 17 Twp. 8 S. R. 25 E W
(a/a/a/a) 2,310 feet from N / S Line of Section
990 feet from E / W Line of Section

Is SECTION: Regular Irregular?
(Note: Locate well on the Section Plat on reverse side)

County: Graham
Lease Name: Madden-Davis 'B' Well #: 2
Field Name: Schmeid

Is this a Prorated / Spaced Field? Yes No
Target Formation(s): Lansing/Kansas City

Nearest Lease or unit boundary line (in footage): 990
Ground Surface Elevation: 2348 feet MSL

Water well within one-quarter mile: Yes No
Public water supply well within one mile: Yes No

Depth to bottom of fresh water: 150 100
Depth to bottom of usable water: 125 200

Surface Pipe by Alternate: I II
Length of Surface Pipe Planned to be set: 179' Set in 1954

Length of Conductor Pipe (if any):
Projected Total Depth: 3848'
Formation at Total Depth: Base/Kansas City

Water Source for Drilling Operations:
 Well Farm Pond Other:

DWR Permit #: (Note: Apply for Permit with DWR)

Will Cores be taken? Yes No
If Yes, proposed zone:

AFFIDAVIT

The undersigned hereby affirms that the drilling, completion and eventual plugging of this well will comply with K.S.A. 55 et. seq.
It is agreed that the following minimum requirements will be met:

- 1. Notify the appropriate district office prior to spudding of well;
- 2. A copy of the approved notice of intent to drill shall be posted on each drilling rig;
- 3. The minimum amount of surface pipe as specified below shall be set by circulating cement to the top; in all cases surface pipe shall be set through all unconsolidated materials plus a minimum of 20 feet into the underlying formation.
- 4. If the well is dry hole, an agreement between the operator and the district office on plug length and placement is necessary prior to plugging;
- 5. The appropriate district office will be notified before well is either plugged or production casing is cemented in;
- 6. If an ALTERNATE II COMPLETION, production pipe shall be cemented from below any usable water to surface within 120 DAYS of spud date. Or pursuant to Appendix "B" - Eastern Kansas surface casing order #133,891-C, which applies to the KCC District 3 area, alternate II cementing must be completed within 30 days of the spud date or the well shall be plugged. In all cases, NOTIFY district office prior to any cementing.

I hereby certify that the statements made herein are true and to the best of my knowledge and belief.

Date: March 15, 2011 Signature of Operator or Agent: Roger L. Mason Title: Agent

For KCC Use ONLY
API # 15 - 065-02853-00-01
Conductor pipe required None feet
Minimum surface pipe required 179 feet per ALT. I II
Approved by: [Signature] 3-22-2011
This authorization expires: 3-22-2012
(This authorization void if drilling not started within 12 months of approval date.)
Spud date: Agent:

Remember to:

- File Certification of Compliance with the Kansas Surface Owner Notification Act (KSONA-1) with Intent to Drill;
- File Drill Pit Application (form CDP-1) with Intent to Drill;
- File Completion Form ACO-1 within 120 days of spud date;
- File acreage attribution plat according to field proration orders;
- Notify appropriate district office 48 hours prior to workover or re-entry;
- Submit plugging report (CP-4) after plugging is completed (within 60 days);
- Obtain written approval before disposing or injecting salt water.
- If well will not be drilled or permit has expired (See: authorized expiration date) please check the box below and return to the address below.

Well will not be drilled or Permit Expired Date: Signature of Operator or Agent:

Mail to: KCC - Conservation Division,
130 S. Market - Room 2078, Wichita, Kansas 67202

RECEIVED

MAR 17 2011

KCC WICHITA

17 8 25 E W

For KCC Use ONLY

API # 15 -

065-02853-0001

IN ALL CASES PLOT THE INTENDED WELL ON THE PLAT BELOW

In all cases, please fully complete this side of the form. Include items 1 through 5 at the bottom of this page.

Operator: 6G Twister, Inc
 Lease: Madden-Davis 'B'
 Well Number: 2
 Field: Schmeid
 Number of Acres attributable to well: 10
 QTR/QTR/QTR/QTR of acreage: - NW - NE - SE

Location of Well: County: Graham
 2,310 feet from N / S Line of Section
 990 feet from E / W Line of Section
 Sec. 17 Twp. 8 S. R. 25 E W

Is Section: Regular or Irregular

If Section is Irregular, locate well from nearest corner boundary.

Section corner used: NE NW SE SW

PLAT

Show location of the well. Show footage to the nearest lease or unit boundary line. Show the predicted locations of lease roads, tank batteries, pipelines and electrical lines, as required by the Kansas Surface Owner Notice Act (House Bill 2032). You may attach a separate plat if desired.

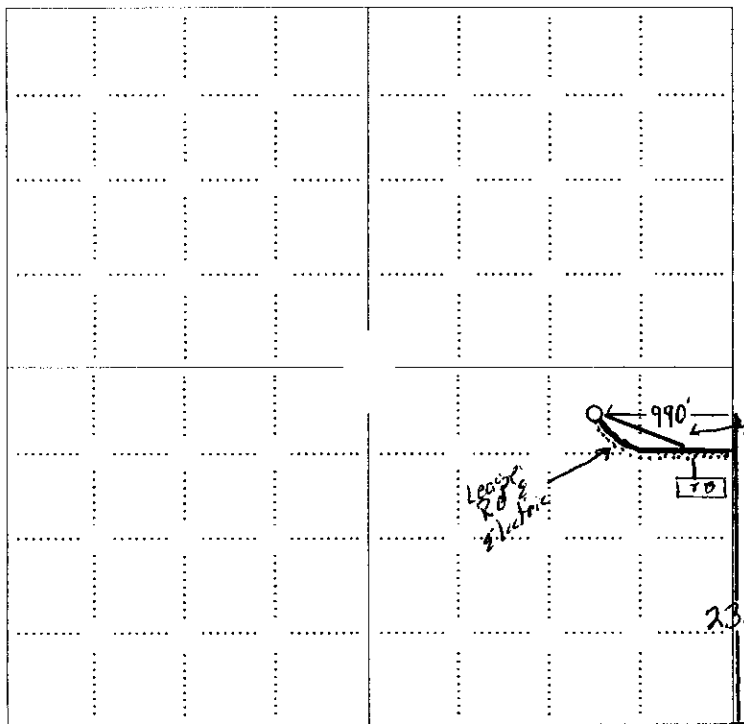

LEGEND

- Well Location
- Tank Battery Location
- Pipeline Location
- Electric Line Location
- Lease Road Location

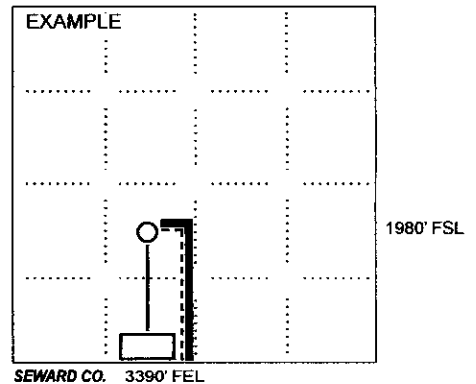

NOTE: In all cases locate the spot of the proposed drilling location.

In plotting the proposed location of the well, you must show:

1. The manner in which you are using the depicted plat by identifying section lines, i.e. 1 section, 1 section with 8 surrounding sections, 4 sections, etc.
2. The distance of the proposed drilling location from the south / north and east / west outside section lines.
3. The distance to the nearest lease or unit boundary line (in footage).
4. If proposed location is located within a prorated or spaced field a certificate of acreage attribution plat must be attached: (CO-7 for oil wells; CG-8 for gas wells).
5. The predicted locations of lease roads, tank batteries, pipelines, and electrical lines.

RECEIVED
 MAR 17 2011
 KCC WICHITA

KANSAS CORPORATION COMMISSION
OIL & GAS CONSERVATION DIVISION

Form CDP-1
May 2010
Form must be Typed

APPLICATION FOR SURFACE PIT

Submit in Duplicate

Operator Name: 6G Twister, Inc		License Number: 34515	
Operator Address: PO Box 1686		Gillette WY 82717	
Contact Person: Tami Graf		Phone Number: (307) 682-7380	
Lease Name & Well No.: Madden-Davis 'B' 2		Pit Location (QQQQ): _____ NW _____ NE _____ SE Sec. 17 Twp. 8 R. 25 <input type="checkbox"/> East <input checked="" type="checkbox"/> West 2,310 Feet from <input type="checkbox"/> North / <input checked="" type="checkbox"/> South Line of Section 990 Feet from <input checked="" type="checkbox"/> East / <input type="checkbox"/> West Line of Section Graham _____ County	
Type of Pit: <input type="checkbox"/> Emergency Pit <input type="checkbox"/> Burn Pit <input type="checkbox"/> Settling Pit <input checked="" type="checkbox"/> Drilling Pit <input type="checkbox"/> Workover Pit <input type="checkbox"/> Haul-Off Pit <small>(If WP Supply API No. or Year Drilled)</small>	Pit is: <input checked="" type="checkbox"/> Proposed <input type="checkbox"/> Existing If Existing, date constructed: _____ Pit capacity: 80 (bbls)		
Is the pit located in a Sensitive Ground Water Area? <input checked="" type="checkbox"/> Yes <input checked="" type="checkbox"/> No		Chloride concentration: _____ mg/l <small>(For Emergency Pits and Settling Pits only)</small>	
Is the bottom below ground level? <input checked="" type="checkbox"/> Yes <input type="checkbox"/> No	Artificial Liner? <input checked="" type="checkbox"/> Yes <input type="checkbox"/> No	How is the pit lined if a plastic liner is not used?	
Pit dimensions (all but working pits): 20 Length (feet) 8 Width (feet) <input type="checkbox"/> N/A: Steel Pits Depth from ground level to deepest point: 6 (feet) <input type="checkbox"/> No Pit			
If the pit is lined give a brief description of the liner material, thickness and installation procedure. 6 mil Plastic Liner		Describe procedures for periodic maintenance and determining liner integrity, including any special monitoring. Daily Visual Inspection	
Distance to nearest water well within one-mile of pit: <input checked="" type="checkbox"/> 3300 feet Depth of water well 46 feet		Depth to shallowest fresh water 8 feet. Source of information: <input type="checkbox"/> measured <input type="checkbox"/> well owner <input type="checkbox"/> electric log <input checked="" type="checkbox"/> KDWR	
Emergency, Settling and Burn Pits ONLY: Producing Formation: _____ Number of producing wells on lease: _____ Barrels of fluid produced daily: _____ Does the slope from the tank battery allow all spilled fluids to flow into the pit? <input type="checkbox"/> Yes <input type="checkbox"/> No		Drilling, Workover and Haul-Off Pits ONLY: Type of material utilized in drilling/workover: Water & Cement Number of working pits to be utilized: 1 Abandonment procedure: Remove fluids, allow to air dry and back-fill. Drill pits must be closed within 365 days of spud date.	
I hereby certify that the above statements are true and correct to the best of my knowledge and belief.			
March 15, 2011 Date		<i>Roger L. Moses</i> Signature of Applicant or Agent	

15-005-02853-0001

KCC OFFICE USE ONLY			
Date Received: 3/17/11		Permit Number: _____	
Permit Date: 3/18/11		Lease Inspection: <input checked="" type="checkbox"/> Yes <input type="checkbox"/> No	
<input checked="" type="checkbox"/> Liner <input type="checkbox"/> Steel Pit <input checked="" type="checkbox"/> RFAC <input type="checkbox"/> RFAS			

Mail to: KCC - Conservation Division, 130 S. Market - Room 2078, Wichita, Kansas 67202

RECEIVED

MAR 17 2011

KCC WICHITA

15-065-02853-00-00

Give All Information Completely
Make Required Affidavit
Mail or Deliver Report to:
Conservation Division
State Corporation Commission
212 No. Market
Wichita, Kansas

WELL PLUGGING RECORD

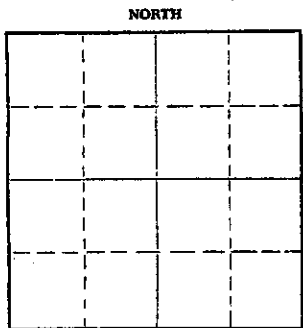

Locate well correctly on above Section Plat

Graham County. Sec. 17 Twp. B Rge. 25 (E) W. (W)
Location as "NE/CNW/SW" or footage from lines. NE NE SE
Lease Owner Empire Drilling Co. All
Lease Name Madden Davis Well No. B-2
Office Address Wichita, Kansas 650 4th Natl. Bank Bldg.
Character of Well (completed as Oil, Gas or Dry Hole) _____
Date well completed April 4 19 54
Application for plugging filed December 28 19 65
Application for plugging approved December 28 19 65
Plugging commenced Feb. 2 19 66
Plugging completed Feb. 3 19 66
Reason for abandonment of well or producing formation _____
Lack of oil
If a producing well is abandoned, date of last production January 4 19 66
Was permission obtained from the Conservation Division or its agents before plugging was commenced? Yes

Name of Conservation Agent who supervised plugging of this well Nichols
Producing formation Lansing Kansas City Depth to top 3629 Bottom 3848 Total Depth of Well 3848 Feet
Show depth and thickness of all water, oil and gas formations.

OIL, GAS OR WATER RECORDS				CASING RECORD		
FORMATION	CONTENT	FROM	TO	SIZE	PUT IN	PULLED OUT
	Surface	0	200	8 5/8"	179'	-0-
<u>Lansing Kansas City</u>	<u>Lime</u>			<u>5 1/2"</u>	<u>3847 1/2'</u>	<u>1156.80</u>

Describe in detail the manner in which the well was plugged, indicating where the mud fluid was placed and the method or methods used in introducing it into the hole. If cement or other plugs were used, state the character of same and depth placed, from 3848 feet to surface feet for each plug set.
Sanded up to 3690' dump 5 sacks of cement on bottom.
Pulled pipe out of hole pump 20 sacks of mud & 100 sacks of cement in hole.
Well completed.

RECEIVED
STATE CORPORATION COMMISSION
FEB 28 1966
2/28/66
CONSERVATION DIVISION
Wichita, Kansas

(If additional description is necessary, use BACK of this sheet)
Name of Plugging Contractor Barnes & Sons Pipe Pulling Co.
Address P.O. Box 313 Russell, Kansas

STATE OF Kansas COUNTY OF Sedgwick ss.
Theodore Gore (owner or operator) of the above-described well, being first duly sworn on oath, says: That I have knowledge of the facts, statements, and matters herein contained and the log of the above-described well as filed and that the same are true and correct. So help me God.

(Signature) Theodore Gore
Theodore Gore
650 4th Natl. Bank Bldg., Wichita, Kansas 67202
(Address)

SUBSCRIBED AND SWORN to before me this 23th day of February 19 66.
Sandra Kay Peer
Sandra Kay Peer Notary Public.
My commission expires September 14, 1968

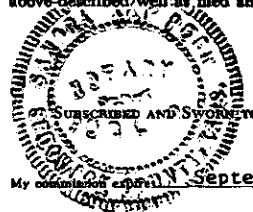

Conservation Division
Finney State Office Building
130 S. Market, Rm. 2078
Wichita, KS 67202-3802



phone: 316-337-6200
fax: 316-337-6211
<http://kcc.ks.gov/>

Thomas E. Wright, Chairman
Ward Loyd, Commissioner

Corporation Commission

Sam Brownback, Governor

March 18, 2011

Tami Graf
6G Twister, Inc.
PO Box 1686
Gillette WY 82717

Re: Drilling Pit Application
Madden-Davis B Lease Well No. 2
SE/4 17-8S-25W
Graham County, Kansas

Dear Ms Graf:

According to your surface pit application, the reserve pit will be lined with 6 mil plastic. Integrity of the liner must be maintained at all times. The reserve pit shall be **kept as far as possible from any creek, draw, waterway, stream, river or any other drainage**, constructed **without slots**, the bottom shall be flat and reasonably level and the free fluids must be removed. The fluids are to be removed from the reserve pit immediately upon completion of drilling operations.

If production casing is set all completion fluids shall be removed from the working pits daily. NO completion fluids or non-exempt wastes shall be placed in the reserve pit.

The fluids should be taken to an authorized disposal well. Please call the District Office at (785) 625-0550 when the fluids have been removed. Please file form CDP-5 (August 2008), Exploration and Production Waste Transfer, within 30 days of fluid removal. Conservation division forms are available through our office and on the KCC web site: <http://kcc.ks.gov/conservation/forms/>

Allow solids to dry out and close pits as soon as feasible.

A copy of this letter should be posted in the doghouse along with the approved Intent to Drill. If you have any questions or concerns please feel free to contact Jonelle Rains at the above address.