

EFFECTIVE DATE: 2-10-91

State of Kansas

15-051-24727-0000

NOTICE OF INTENTION TO DRILL

Must be approved by the K.C.C. five (5) days prior to commencing well

Expected Spud Date February 6 1991  
month day year

CW# 1 NW SE Sec 25 Twp 11 S, Rg 17 East X West ✓

OPERATOR: License # 5447 ✓  
Name: OXY USA INC.  
Address: 110 S. Main #800  
City/State/Zip: Wichita, Kansas 67202  
Contact Person: Michael D. Harrison  
Phone: (316) 265-5624

1980 feet from South line of Section ✓  
2310 feet from East line of Section ✓  
(Note: Locate well on Section Plat on Reverse Side)

CONTRACTOR: License #: 5929 ✓  
Name: Duke Drilling Company

County: Ellis ✓  
Lease Name: Colahan "B" Well #: 27 ✓  
Field Name: Bemis ✓

Well Drilled For: Well Class: Type Equipment:  
X Oil ... Inj X Infield X Mud Rotary ✓  
... Gas ... Storage ... Pool Ext. ... Air Rotary  
... OWO ... Disposal ... Wildcat ... Cable  
... Seismic; ... # of Holes

Is this a Prorated Field? ... yes X no ✓  
Target Formation(s): Arbuckle ✓  
Nearest lease or unit boundary: 1980' ✓  
Ground Surface Elevation: 1965 feet MSL ✓  
Domestic well within 330 feet: ... yes X no ✓  
Municipal well within one mile: ... yes X no ✓  
Depth to bottom of fresh water: 175' ✓  
Depth to bottom of usable water: 715' ✓  
Surface Pipe by Alternate: ... 1 X 2 ✓  
Length of Surface Pipe Planned to be set: 300' ✓  
Length of Conductor pipe required: None ✓  
Projected Total Depth: 3500' ✓  
Formation at Total Depth: Arbuckle ✓  
Water Source for Drilling Operations:  
... well ... farm pond X other ✓

If OWM: old well information as follows:  
Operator: \_\_\_\_\_  
Well Name: \_\_\_\_\_  
Comp. Date: \_\_\_\_\_ Old Total Depth \_\_\_\_\_

DWR Permit #: \_\_\_\_\_  
Will Cores Be Taken?: ... yes X no ✓  
If yes, proposed zone: \_\_\_\_\_

Directional, Deviated or Horizontal wellbore? ... yes X no ✓  
If yes, total depth location: \_\_\_\_\_

AFFIDAVIT

The undersigned hereby affirms that the drilling, completion and eventual plugging of this well will comply with K.S.A. 55-101, et. seq.

It is agreed that the following minimum requirements will be met:

1. The appropriate district office shall be notified before setting surface pipe;
2. The minimum amount of surface pipe as specified above shall be set by circulating cement to the top; in all cases surface pipe shall be set through all unconsolidated materials plus a minimum of 20 feet into the underlying formation;
3. If the well is dry, a plugging proposal shall be submitted to the district office. An agreement between the operator and the district office on plug length and placement is necessary prior to plugging;
4. The appropriate district office will be notified before well is either plugged or production casing is cemented in;
5. If an Alternate II completion, production pipe shall be cemented from below any usable water to surface within 120 days of spud date. In all cases, notify district office prior to any cementing.

I hereby certify that the statements made herein are true and to the best of my knowledge and belief.

Date: 2-4-91 Signature of Operator or Agent: Michael D. Harrison Title: Operations Manager

FOR KCC USE:

API # 15- 051-24727  
 Conductor pipe required None feet  
 Minimum surface pipe required 300 feet per Alt. ●②  
 Approved by: MDH 2-5-91  
 EFFECTIVE DATE: 2-10-91  
 This authorization expires: 8-5-91  
 (This authorization void if drilling not started within 6 months of effective date.)  
 Spud date: \_\_\_\_\_ Agent: \_\_\_\_\_

WAL  
K  
N

25

RECEIVED

FEB 4 1991  
02-04-91  
CONSERVATION DIVISION  
Wichita, Kansas  
17W

REMEMBER TO:

- File Drill Pit Application (form CDP-1) with Intent to Drill;
- File Completion Form ACO-1 within 120 days of spud date;
- File acreage attribution plat according to field proration orders;
- Notify appropriate district office 48 hours prior to workover or re-entry;
- Submit plugging report (CP-4) after plugging is completed;
- Obtain written approval before disposing or injecting salt water.

PLAT OF ACREAGE ATTRIBUTABLE TO A WELL

State Corporation Commission, Conservation Division
200 Colorado Derby Bldg. Wichita, Kansas 67202

OPERATOR OXY USA INC. LOCATION OF WELL:
LEASE Colahan "B" 1980 feet north of SE corner
WELL NUMBER 27 2310 feet west of SE corner
FIELD Bemis CW-NW-SE Sec. 25 T 11S R 17W E/W
COUNTY Ellis
NO. OF ACRES ATTRIBUTABLE TO WELL 10 IS SECTION X REGULAR IRREGULAR?
DESCRIPTION OF ACREAGE Pasture IF IRREGULAR, LOCATE WELL FROM NEAREST CORNER BOUNDARY.

NOTE: If plat depicted is insufficient for your circumstances, you may attach your own scaled or surveyed plat.

PLAT

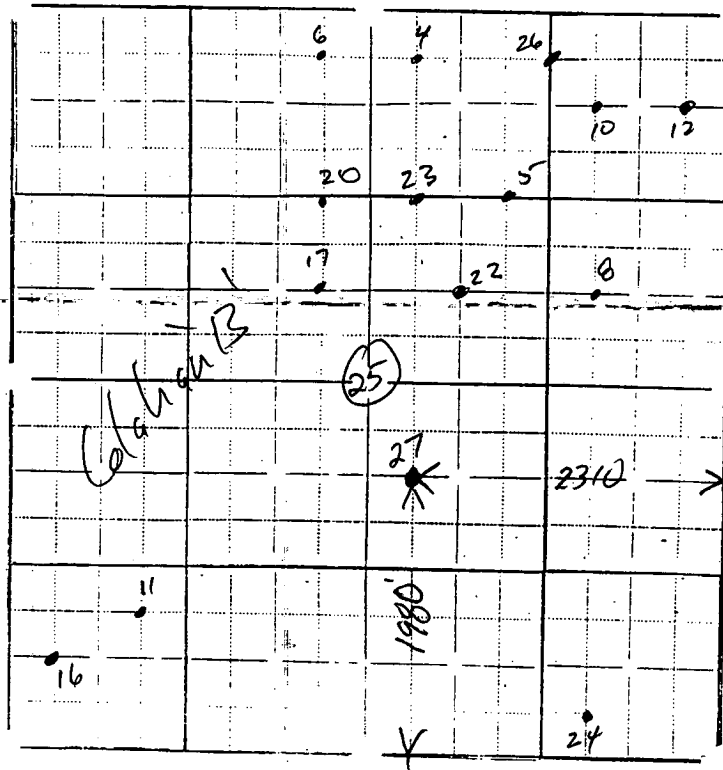

In plotting the proposed location of the well, you must show:

- 1) The manner in which you are using the depicted plat by identifying section lines, i.e. 1 section, section with 8 surrounding partial sections, 4 sections, 16 sections, etc.;
2) the well's location relative to the location of other wells producing from the same common source supply in adjoining drilling units, pursuant to K.A.R. 82-3-108, 82-3-207, 82-3-312, or special orders of the Commission;
3) the distance of the proposed drilling location from the section's east and south lines; and the distance to the nearest lease or unit boundary line.

I hereby certify that the statements made herein are true and to the best of my knowledge and belief.

Signature of Operator or Agent Michael D. Harrison

Date 2-4-91 Title Operations Manager

Handwritten initials and a stamp.