

For KCC Use: 4-11-2011
 Effective Date: _____
 District #: 2
 SGA? Yes No

KANSAS CORPORATION COMMISSION
 OIL & GAS CONSERVATION DIVISION

Form C-1
 March 2010
 Form must be Typed
 Form must be Signed
 All blanks must be Filled

NOTICE OF INTENT TO DRILL

Must be approved by KCC five (5) days prior to commencing well
Form KSONA-1, Certification of Compliance with the Kansas Surface Owner Notification Act, MUST be submitted with this form.

Expected Spud Date: 04-12-2011
 month day year

OPERATOR: License# 34439
 Name: BOP West, LLC
 Address 1: P.O. Box 129
 Address 2: _____
 City: Wooster State: OH Zip: 44691 + _____
 Contact Person: Steve Sigler
 Phone: 330-264-8847

CONTRACTOR: License# 32701
 Name: C & G Drilling, Inc.

Well Drilled For: Oil Gas
 Enh Rec Storage Disposal
 Seismic; # of Holes _____
 Other: _____
 If OWWO: old well information as follows:

Well Class: Infield Pool Ext. Wildcat Other
 Type Equipment: Mud Rotary Air Rotary Cable

Operator: _____
 Well Name: _____
 Original Completion Date: _____ Original Total Depth: _____

Directional, Deviated or Horizontal wellbore? Yes No
 If Yes, true vertical depth: _____
 Bottom Hole Location: _____
 KCC DKT #: _____

Spot Description: 20' S. 160' W. W/2 - W/2 Sec. 6 Twp. 17 S. R. 1 E W
2,620 feet from N / S Line of Section
500 feet from E / W Line of Section

Is SECTION: Regular Irregular?
 (Note: Locate well on the Section Plat on reverse side)

County: Marion
 Lease Name: Everhart-Base Unit Well #: 1
 Field Name: Fanska

Is this a Prorated / Spaced Field? Yes No
 Target Formation(s): Mississippi

Nearest Lease or unit boundary line (in footage): 330'
 Ground Surface Elevation: 1371' per survey feet MSL.

Water well within one-quarter mile: Yes No
 Public water supply well within one mile: Yes No

Depth to bottom of fresh water: 100
 Depth to bottom of usable water: 180

Surface Pipe by Alternate: I II
 Length of Surface Pipe Planned to be set: 200

Length of Conductor Pipe (if any): _____
 Projected Total Depth: 2800

Formation at Total Depth: Mississippi
 Water Source for Drilling Operations:
 Well Farm Pond Other: Haul

DWR Permit #: _____
 (Note: Apply for Permit with DWR)

Will Cores be taken? Yes No
 If Yes, proposed zone: _____

Oil & Gas Leases w/ pooling clauses submitted

AFFIDAVIT

The undersigned hereby affirms that the drilling, completion and eventual plugging of this well will comply with K.S.A. 55 et. seq.
 It is agreed that the following minimum requirements will be met:

1. Notify the appropriate district office **prior** to spudding of well;
2. A copy of the approved notice of intent to drill **shall be** posted on each drilling rig;
3. The minimum amount of surface pipe as specified below **shall be set** by circulating cement to the top; in all cases surface pipe **shall be set** through all unconsolidated materials plus a minimum of 20 feet into the underlying formation.
4. If the well is dry hole, an agreement between the operator and the district office on plug length and placement is necessary **prior to plugging**;
5. The appropriate district office will be notified before well is either plugged or production casing is cemented in;
6. If an ALTERNATE II COMPLETION, production pipe shall be cemented from below any usable water to surface within **120 DAYS** of spud date. Or pursuant to Appendix "B" - Eastern Kansas surface casing order #133,891-C, which applies to the KCC District 3 area, alternate II cementing must be completed within 30 days of the spud date or the well shall be plugged. **In all cases, NOTIFY district office** prior to any cementing.

I hereby certify that the statements made herein are true and to the best of my knowledge and belief.

Date: 3-31-2011 Signature of Operator or Agent: Gary Freed Title: Consulting Engineer

For KCC Use ONLY
 API # 15 - 115-21421-00-00
 Conductor pipe required None feet
 Minimum surface pipe required 200 feet per ALT. I II
 Approved by: [Signature] 4-6-2011
 This authorization expires: 4-6-2012
 (This authorization void if drilling not started within 12 months of approval date.)
 Spud date: _____ Agent: _____

Remember to:

- File Certification of Compliance with the Kansas Surface Owner Notification Act (KSONA-1) with Intent to Drill;
- File Drill Pit Application (form CDP-1) with Intent to Drill;
- File Completion Form ACO-1 within 120 days of spud date;
- File acreage attribution plat according to field proration orders;
- Notify appropriate district office 48 hours prior to workover or re-entry;
- Submit plugging report (CP-4) after plugging is completed (within 60 days);
- Obtain written approval before disposing or injecting salt water.
- If well will not be drilled or permit has expired (See: authorized expiration date) please check the box below and return to the address below.

Well will not be drilled or Permit Expired Date: _____
 Signature of Operator or Agent: _____

Mail to: KCC - Conservation Division,
 130 S. Market - Room 2078, Wichita, Kansas 67202

RECEIVED
 APR 01 2011
 KCC WICHITA

6
17
1
 E
 W

For KCC Use ONLY

API # 15 - 115-21421-0000

IN ALL CASES PLOT THE INTENDED WELL ON THE PLAT BELOW

In all cases, please fully complete this side of the form. Include items 1 through 5 at the bottom of this page.

Operator: BOP West, LLC
 Lease: Everhart-Base Unit
 Well Number: 1
 Field: Fanska

Location of Well: County: Marion
2,620 feet from N / S Line of Section
500 feet from E / W Line of Section
 Sec. 6 Twp. 17 S. R. 1 E W

Number of Acres attributable to well: _____
 QTR/QTR/QTR/QTR of acreage: 20' S - 160' W - W/2 - W/2

Is Section: Regular or Irregular

If Section is Irregular, locate well from nearest corner boundary.

Section corner used: NE NW SE SW

PLAT

Show location of the well. Show footage to the nearest lease or unit boundary line. Show the predicted locations of lease roads, tank batteries, pipelines and electrical lines, as required by the Kansas Surface Owner Notice Act (House Bill 2032). You may attach a separate plat if desired.

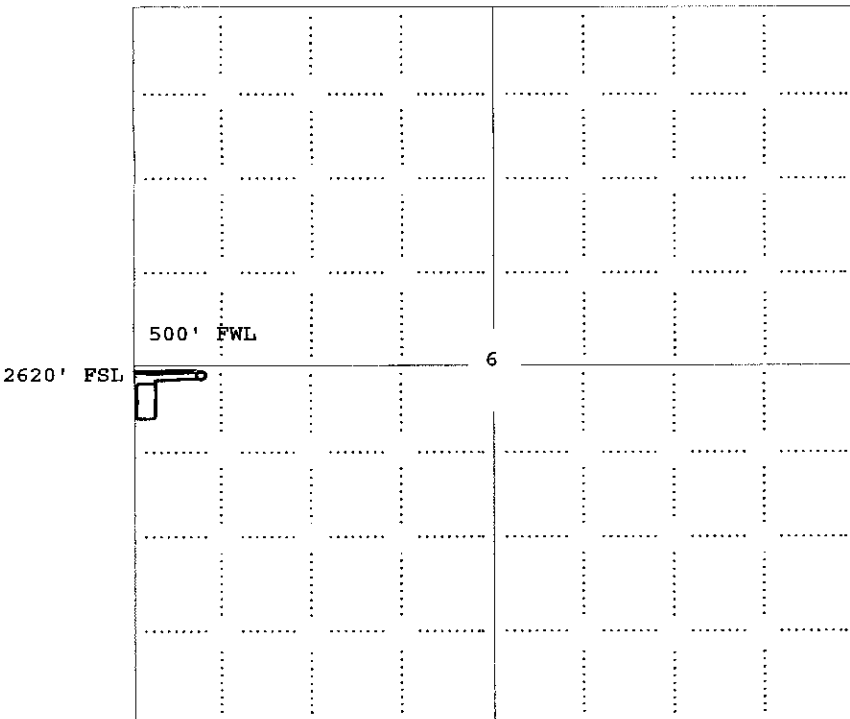

LEGEND

- Well Location
- Tank Battery Location
- Pipeline Location
- Electric Line Location
- Lease Road Location

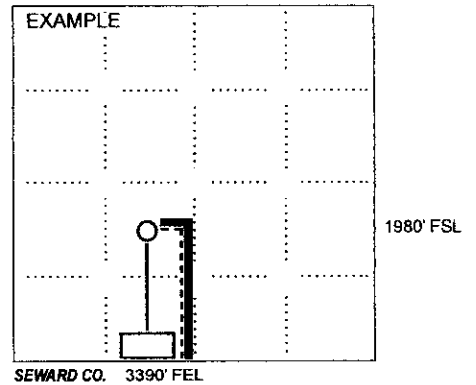

NOTE: In all cases locate the spot of the proposed drilling locaton.

In plotting the proposed location of the well, you must show:

1. The manner in which you are using the depicted plat by identifying section lines, i.e. 1 section, 1 section with 8 surrounding sections, 4 sections, etc.
2. The distance of the proposed drilling location from the south / north and east / west outside section lines.
3. The distance to the nearest lease or unit boundary line (in footage).
4. If proposed location is located within a prorated or spaced field a certificate of acreage attribution plat must be attached: (CO-7 for oil wells; CG-8 for gas wells).
5. The predicted locations of lease roads, tank batteries, pipelines, and electrical lines.

RECEIVED
 APR 01 2011
 KCC WICHITA

CERTIFICATION OF COMPLIANCE WITH THE KANSAS SURFACE OWNER NOTIFICATION ACT

This form must be submitted with all Forms C-1 (Notice of Intent to Drill); CB-1 (Cathodic Protection Borehole Intent); T-1 (Request for Change of Operator Transfer of Injection or Surface Pit Permit); and CP-1 (Well Plugging Application). Any such form submitted without an accompanying Form KSONA-1 will be returned.

Select the corresponding form being filed: C-1 (Intent) CB-1 (Cathodic Protection Borehole Intent) T-1 (Transfer) CP-1 (Plugging Application)

OPERATOR: License # 34439
Name: BOP West, LLC
Address 1: P.O. Box 129
Address 2: _____
City: Wooster State: OH Zip: 44691 + _____
Contact Person: Steve Sigler
Phone: (330) 264-8847 Fax: (330) 263-4222
Email Address: steve@buckeyeoilinc.com

Well Location:
20' S 100' W W/2 W/2 Sec. 6 Twp. 17 S. R. 1 East West
County: Marion
Lease Name: Everhart-Base Unit Well #: 1

If filing a Form T-1 for multiple wells on a lease, enter the legal description of the lease below:

Surface Owner Information:

Name: Jay Everhart
Address 1: 9940 S. Amos Rd
Address 2: _____
City: Gypsum State: KS Zip: 67448 + _____

When filing a Form T-1 involving multiple surface owners, attach an additional sheet listing all of the information to the left for each surface owner. Surface owner information can be found in the records of the register of deeds for the county, and in the real estate property tax records of the county treasurer.

If this form is being submitted with a Form C-1 (Intent) or CB-1 (Cathodic Protection Borehole Intent), you must supply the surface owners and the KCC with a plat showing the predicted locations of lease roads, tank batteries, pipelines, and electrical lines. The locations shown on the plat are preliminary non-binding estimates. The locations may be entered on the Form C-1 plat, Form CB-1 plat, or a separate plat may be submitted.

Select one of the following:

I certify that, pursuant to the Kansas Surface Owner Notice Act (House Bill 2032), I have provided the following to the surface owner(s) of the land upon which the subject well is or will be located: 1) a copy of the Form C-1, Form CB-1, Form T-1, or Form CP-1 that I am filing in connection with this form; 2) if the form being filed is a Form C-1 or Form CB-1, the plat(s) required by this form; and 3) my operator name, address, phone number, fax, and email address.

I have not provided this information to the surface owner(s). I acknowledge that, because I have not provided this information, the KCC will be required to send this information to the surface owner(s). To mitigate the additional cost of the KCC performing this task, I acknowledge that I am being charged a \$30.00 handling fee, payable to the KCC, which is enclosed with this form.

If choosing the second option, submit payment of the \$30.00 handling fee with this form. If the fee is not received with this form, the KSONA-1 form and the associated Form C-1, Form CB-1, Form T-1, or Form CP-1 will be returned.

I hereby certify that the statements made herein are true and correct to the best of my knowledge and belief.

Date: 3-31-2011 Signature of Operator or Agent: Doug J Reed Title: Consulting Engineer

ARKAN PETROLEUM, INC.

15-115-21421-0000

Gary L. Reed, President
P.E. License #7168

14200 Brookline Ct. * Wichita, Kansas 67230
Phone 316-733-4798 Fax 316-733-6398
Cell 316-655-8775

March 31, 2011

Mr. Jay Everhart
9440 S. Amos Rd.
Gypsum, Ks 67448

Dear Mr. Everhart:

BOP West, LLC is proposing to drill an oil well at the location shown on the attached Notice of Intent to Drill which is being filed this date with the Kansas Corporation Commission.

Records indicate that the drilling of this well will impact lands on which you are the surface owner. In compliance with the Kansas Surface Owner Notification Act, I am supplying you with said Notice of Intent to Drill and the non binding plat of the proposed location showing potential tank battery, road, and flow line locations. These are our best estimates of locations and may be changed after the well is drilled and completed.

Thank you for your attention to this matter. If you have any questions, please contact Mr. Steve Sigler at BOP West, LLC at 330-264-8847.

Very truly yours;

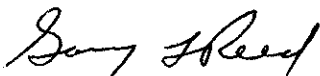

Gary L. Reed
Arkan Petroleum, Inc.

RECEIVED
APR 01 2011
KCC WICHITA

CERTIFICATION OF COMPLIANCE WITH THE KANSAS SURFACE OWNER NOTIFICATION ACT

This form must be submitted with all Forms C-1 (Notice of Intent to Drill); CB-1 (Cathodic Protection Borehole Intent); T-1 (Request for Change of Operator Transfer of Injection or Surface Pit Permit); and CP-1 (Well Plugging Application). Any such form submitted without an accompanying Form KSONA-1 will be returned.

Select the corresponding form being filed: C-1 (Intent) CB-1 (Cathodic Protection Borehole Intent) T-1 (Transfer) CP-1 (Plugging Application)

OPERATOR: License # 34439
Name: BOP West, LLC
Address 1: P.O. Box 129
Address 2: _____
City: Wooster State: OH Zip: 44691 + _____
Contact Person: Steve Sigler
Phone: (330) 264-8847 Fax: (330) 263-4222
Email Address: steve@buckeyeoilinc.com

Well Location:
20° S 100° W W/2 - W/2 Sec. 6 Twp. 17 S. R. 1 East West
County: Marion
Lease Name: Everhart-Base Unit Well #: 1

If filing a Form T-1 for multiple wells on a lease, enter the legal description of the lease below:

Surface owner on the Linda Base Lease
Surface Owner Information:
Name: Rachel A. Imthurn Trust
Address 1: Rachel A. Imthurn, Trustee
Address 2: 15288 Warren Road
City: Maple Hill State: KS Zip: 66507 + _____

When filing a Form T-1 involving multiple surface owners, attach an additional sheet listing all of the information to the left for each surface owner. Surface owner information can be found in the records of the register of deeds for the county, and in the real estate property tax records of the county treasurer.

If this form is being submitted with a Form C-1 (Intent) or CB-1 (Cathodic Protection Borehole Intent), you must supply the surface owners and the KCC with a plat showing the predicted locations of lease roads, tank batteries, pipelines, and electrical lines. The locations shown on the plat are preliminary non-binding estimates. The locations may be entered on the Form C-1 plat, Form CB-1 plat, or a separate plat may be submitted.

Select one of the following:

- I certify that, pursuant to the Kansas Surface Owner Notice Act (House Bill 2032), I have provided the following to the surface owner(s) of the land upon which the subject well is or will be located: 1) a copy of the Form C-1, Form CB-1, Form T-1, or Form CP-1 that I am filing in connection with this form; 2) if the form being filed is a Form C-1 or Form CB-1, the plat(s) required by this form; and 3) my operator name, address, phone number, fax, and email address.
- I have not provided this information to the surface owner(s). I acknowledge that, because I have not provided this information, the KCC will be required to send this information to the surface owner(s). To mitigate the additional cost of the KCC performing this task, I acknowledge that I am being charged a \$30.00 handling fee, payable to the KCC, which is enclosed with this form.

If choosing the second option, submit payment of the \$30.00 handling fee with this form. If the fee is not received with this form, the KSONA-1 form and the associated Form C-1, Form CB-1, Form T-1, or Form CP-1 will be returned.

I hereby certify that the statements made herein are true and correct to the best of my knowledge and belief.

Date: 3-31-2011 Signature of Operator or Agent: Bony Reed Title: Consulting Engineer

RECEIVED
APR 01 2011
KCC WICHITA

15-115-21421-0000

ARKAN PETROLEUM, INC.

Gary L. Reed, President
P.E. License #7168

14200 Brookline Ct. * Wichita, Kansas 67230
Phone 316-733-4798 Fax 316-733-6398
Cell 316-655-8775

March 31, 2011

Rachel A. Imthurn Trust
Rachel A. Imthurn, Trustee
15288 Warren Road
Maple Hill, Ks 67448

Dear Ms. Imthurn:

BOP West, LLC is proposing to drill an oil well at the location shown on the attached Notice of Intent to Drill which is being filed this date with the Kansas Corporation Commission.

Records indicate that the drilling of this well could impact lands on which you are the surface owner. While the well will not be drilled on your property, it is close enough that some of the operations may affect the surface of your property. In compliance with the Kansas Surface Owner Notification Act, I am supplying you with said Notice of Intent to Drill and the non binding plat of the proposed location showing potential tank battery, road, and flow line locations. These are our best estimates of locations and may be changed after the well is drilled and completed.

Thank you for your attention to this matter. If you have any questions, please contact Mr. Steve Sigler at BOP West, LLC at 330-264-8847.

Very truly yours;

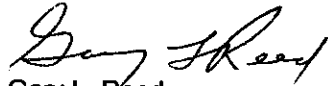

Gary L. Reed
Arkan Petroleum, Inc.

RECEIVED
APR 01 2011
KCC WICHITA

**KANSAS CORPORATION COMMISSION
OIL & GAS CONSERVATION DIVISION
APPLICATION FOR SURFACE PIT**

Form CDP-1
May 2010
Form must be Typed

Submit in Duplicate

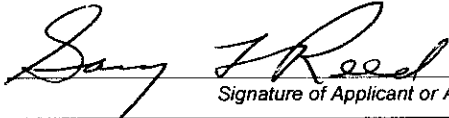
Operator Name: BOP West, LLC		License Number: 34439
Operator Address: P.O. Box 129		Wooster OH 44691
Contact Person: Steve Sigler		Phone Number: 330-264-8847
Lease Name & Well No.: Everhart-Base Unit 1		Pit Location (QQQQ): 20' S 160' W W/2 W/2
Type of Pit: <input type="checkbox"/> Emergency Pit <input type="checkbox"/> Burn Pit <input type="checkbox"/> Settling Pit <input checked="" type="checkbox"/> Drilling Pit <input type="checkbox"/> Workover Pit <input type="checkbox"/> Haul-Off Pit <small>(If WP Supply API No. or Year Drilled)</small>	Pit is: <input checked="" type="checkbox"/> Proposed <input type="checkbox"/> Existing If Existing, date constructed: _____ Pit capacity: 400 (bbls)	Sec. 6 Twp. 17 R. 1 <input checked="" type="checkbox"/> East <input type="checkbox"/> West 2,620 Feet from <input type="checkbox"/> North / <input checked="" type="checkbox"/> South Line of Section 500 Feet from <input type="checkbox"/> East / <input checked="" type="checkbox"/> West Line of Section Marion County
Is the pit located in a Sensitive Ground Water Area? <input type="checkbox"/> Yes <input checked="" type="checkbox"/> No		Chloride concentration: _____ mg/l <small>(For Emergency Pits and Settling Pits only)</small>
Is the bottom below ground level? <input checked="" type="checkbox"/> Yes <input type="checkbox"/> No	Artificial Liner? <input type="checkbox"/> Yes <input checked="" type="checkbox"/> No	How is the pit lined if a plastic liner is not used? Lined with bentonite
Pit dimensions (all but working pits): <u>75</u> Length (feet) <u>75</u> Width (feet) <input type="checkbox"/> N/A: Steel Pits Depth from ground level to deepest point: <u>3</u> (feet) <input type="checkbox"/> No Pit		
If the pit is lined give a brief description of the liner material, thickness and installation procedure.		Describe procedures for periodic maintenance and determining liner integrity, including any special monitoring.
Distance to nearest water well within one-mile of pit: <input checked="" type="checkbox"/> None feet Depth of water well _____ feet	Depth to shallowest fresh water _____ feet. Source of information: <input type="checkbox"/> measured <input type="checkbox"/> well owner <input type="checkbox"/> electric log <input type="checkbox"/> KDWR	
Emergency, Settling and Burn Pits ONLY: Producing Formation: _____ Number of producing wells on lease: _____ Barrels of fluid produced daily: _____ Does the slope from the tank battery allow all spilled fluids to flow into the pit? <input type="checkbox"/> Yes <input type="checkbox"/> No	Drilling, Workover and Haul-Off Pits ONLY: Type of material utilized in drilling/workover: <u>Drilling Mud</u> Number of working pits to be utilized: <u>4</u> Abandonment procedure: Remove free liquids and backfill Drill pits must be closed within 365 days of spud date.	
I hereby certify that the above statements are true and correct to the best of my knowledge and belief.		
<u>3-31-2011</u> Date	 Signature of Applicant or Agent	
KCC OFFICE USE ONLY		
Date Received: <u>4-1-11</u>	Permit Number: _____	Permit Date: <u>4-1-11</u> Lease Inspection: <input type="checkbox"/> Yes <input checked="" type="checkbox"/> No

15-115-21421-00-00

Mail to: KCC - Conservation Division, 130 S. Market - Room 2078, Wichita, Kansas 67202

**RECEIVED
APR 01 2011
KCC WICHITA**