

WELL PLUGGING RECORD

Give All Information Completely
Make Required Affidavit
Mail or Deliver Report to:
Conservation Division
State Corporation Commission
211 No. Broadway
Wichita, Kansas

PRATT County. Sec. 18 Twp. 27 Rge. 12 (X) W (W)

Location as "NE/CNW%SW%" or footage from lines SE NE SE
Lease Owner PETROLEUM, INC.
Lease Name SEIDEL Well No. 1
Office Address ROUTE 2, GREAT BEND, KANSAS
Character of Well (completed as Oil, Gas or Dry Hole) DRY HOLE
Date well completed December 5, 19 57
Application for plugging filed December 5, 19 57
Application for plugging approved December 5, 19 57
Plugging commenced December 5, 19 57
Plugging completed December 5, 19 57
Reason for abandonment of well or producing formation No Producing Zones

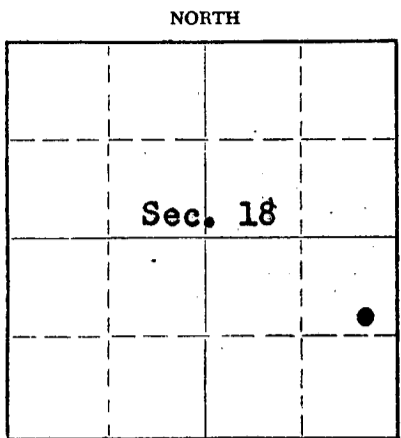

Locate well correctly on above
Section Plat

If a producing well is abandoned, date of last production None 19
Was permission obtained from the Conservation Division or its agents before plugging was commenced? Yes

Name of Conservation Agent who supervised plugging of this well M.A. Rives Pratt, Kansas
Producing formation ----- Depth to top ---- Bottom ----- Total Depth of Well 4490' Feet
Show depth and thickness of all water, oil and gas formations.

OIL, GAS OR WATER RECORDS

CASING RECORD

FORMATION	CONTENT	FROM	TO	SIZE	PUT IN	PULLED OUT
				8-5/8"	337'	None

Describe in detail the manner in which the well was plugged, indicating where the mud fluid was placed and the method or methods used in introducing it into the hole. If cement or other plugs were used, state the character of same and depth placed, from _____ feet to _____ feet for each plug set.

Mud up with heavy mud to 300' and placed wooden plug at 300', Placed 20 sacks cement through drill pipe on to plug. Mud up to 30' and placed wooden plug at 30' followed by 10 sacks cement to base of well cellar.

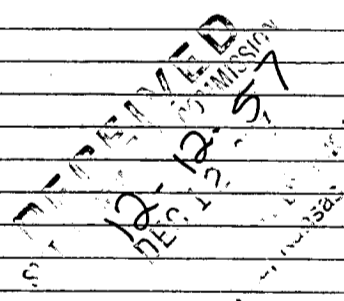

(If additional description is necessary, use BACK of this sheet)

Name of Plugging Contractor Garvey Drilling Company
Address Route 2, Great Bend, Kansas

STATE OF KANSAS, COUNTY OF BARTON, ss.
Don Searle (employee of owner) or (~~owner~~) of the above-described well, being first duly sworn on oath, says: That I have knowledge of the facts, statements, and matters herein contained and the log of the above-described well as filed and that the same are true and correct. So help me Gpd.

(Signature) Don Searle
Route 2, Great Bend, Kansas
(Address)

SUBSCRIBED AND SWORN TO before me this 11th day of December, 19 57

My commission expires July 11, 1960

Ed T. Brown
Notary Public.

PLUGGING
FILE NO. SEC 18 T 27 R 12 W
BOOK PAGE 67 LINE 23

WELL LOG

15-151-10247-00-00

COMPANY PETROLEUM, INCORPORATED

SEC. 18 T. 27S R. 12W

FARM SEIDEL

NO. 1

LOG. SE, NE, SE

TOTAL DEPTH 4490'

COUNTY Pratt Co., Kansas

COMM. November 20, 1957 COMP. December 5, 1957

CONTRACTOR GARVEY DRILLING COMPANY

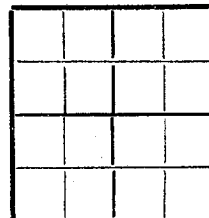

CASING 8 5/8" @ 337' W/250 sax.

ELEVATION 1855' DF

PRODUCTION D & A

FIGURES INDICATE BOTTOM OF FORMATIONS

120	Sand & gravel
185	Sand & clay
220	Sand
875	Red bed
1065	Shale
2655	Shale & lime
3130	Shale
3547	Lime & shale
3660	Sand, lime & shale
3760	Lime & shale
4020	Lime
4072	Lime & shale
4134	Lime
4157	Shale & lime
4186	Chert
4204	Mississippi
4222	Kinderhook
4332	Chert & lime
4361	Chert
4398	Sand
4419	Sand & shale
4490	Shale & lime
4490	T. D.

RECEIVED
STATE COMMISSION
DEC 12 1957
DIVISION

PLUGGING
FILE SEC. 18 T. 27 R. 12W
BOOK PAGE 67 LINE 23

State of KANSAS

County of BARTON

I, WERNE A. MORRIS of GARVEY DRILLING COMPANY

upon oath state that the above and foregoing is a true and correct copy of the log of the #1 Seidel well

Werne A. Morris

Subscribed and sworn to before me this 9th day of December 19 57

My Commission Expires: July 11, 1960

John L. Brown
NOTARY PUBLIC