

STATE CORPORATION COMMISSION OF KANSAS
OIL & GAS CONSERVATION DIVISION
WELL COMPLETION OR RECOMPLETION FORM
ACO-1 WELL HISTORY
DESCRIPTION OF WELL AND LEASE

API NO. 15-051-24,574-00-00
County... Ellis
NW... NE... SW... Sec. 33 Twp. 13S Rge. 20... East West

Operator: License # 04959
Name ZPC Petroleum, Inc.
Address 9319 E. Harry #122
Wichita, Ks. 67207
City/State/Zip

2310' Ft North from Southeast Corner of Section
3630' Ft West from Southeast Corner of Section
(Note: Locate well in section plat below)

Purchaser

Lease Name Rankin Well #. 1-33
Field Name Wildcat
Producing Formation none

Operator Contact Person Jon R. (Zeb) Stewart
Phone (316)683-8838

Elevation: Ground 2311' KB 2321'

Contractor: License # 3300
Name Lloyd Drilling Co.

Wellsite Geologist Jon R. (Zeb) Stewart
Phone (316)688-1784

Designate Type of Completion
New Well Re-Entry Workover
Oil SWD Temp Abd
Gas Inj Delayed Comp.
x Dry Other (Core, Water Supply etc.)

RECEIVED
STATE CORPORATION COMMISSION
JAN 30 1989
CONSERVATION DIVISION
Wichita, Kansas

If ONWO: old well info as follows:
Operator
Well Name
Comp. Date Old Total Depth

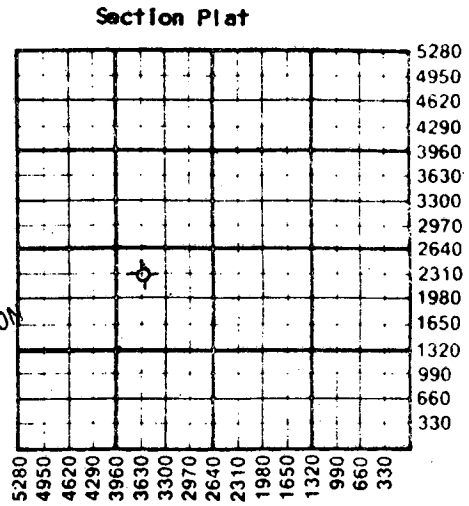

WATER SUPPLY INFORMATION
Disposition of Produced Water: Disposal
Docket # Repressuring

WELL HISTORY
Drilling Method:
x Mud Rotary Air Rotary Cable

12-01-88 12-07-88 12-07-88
Spud Date Date Reached TD Completion Date

3950' Total Depth PBDT

Amount of Surface Pipe Set and Cemented at 250 feet
Multiple Stage Cementing Collar Used? Yes x No
If yes, show depth set feet
If alternate 2 completion, cement circulated from 270 feet depth to surface 150 SX cmt
Cement Company Name Allied Cementing
Invoice #

Questions on this portion of the ACO-1 call:
Water Resources Board (913) 296-3717
Source of Water:
Division of Water Resources Permit #
Groundwater Ft North from Southeast Corner (Well) Ft West from Southeast Corner of Sec Twp Rge East West
Surface Water Ft North from Southeast Corner (Stream, pond etc) Ft West from Southeast Corner Sec Twp Rge East West
Other (explain) supplied by Lloyd Drilling Co. (purchased from city, R.W.D. #)

INSTRUCTIONS: This form shall be completed in triplicate and filed with the Kansas Corporation Commission, 200 Colorado Derby Building, Wichita, Kansas 67202, within 120 days of the spud date of any well. Rule 82-3-130, 82-3-107 and 82-3-106 apply. Information on side two of this form will be held confidential for a period of 12 months if requested in writing and submitted with the form. See rule 82-3-107 for confidentiality in excess of 12 months. One copy of all wireline logs and drillers time log shall be attached with this form. Submit CP-4 form with all plugged wells. Submit CP-111 form with all temporarily abandoned wells.

All requirements of the statutes, rules and regulations promulgated to regulate the oil and gas industry have been fully complied with and the statements herein are complete and correct to the best of my knowledge.

Signature Jon R. Stewart
Title President Date 01-26-89

Subscribed and sworn to before me this 26th day of January 1989
Notary Public Vickie Warkentin
Date Commission Expires 10/19/91

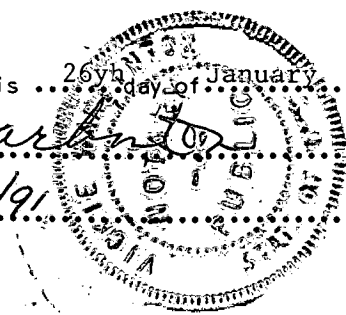

K.C.C. OFFICE USE ONLY
F Letter of Confidentiality Attached
C Wireline Log Received
C Drillers Timelog Received
Distribution
x KCC SWD/Rep NGPA
x KGS Plug Other (Specify)

Sec 33 Twp 13 Rge 20

SIDE TWO

Operator Name ZPC Petroleum, Inc Lease Name Rankin Well # 1-33

Sec. 33 Twp. 13S Rge. 20 East West County Ellis

WELL LOG

INSTRUCTIONS: Show important tops and base of formations penetrated. Detail all cores. Report all drill stem tests giving interval tested, time tool open and closed, flowing and shut-in pressures, whether shut-in pressure reached static level, hydrostatic pressures, bottom hole temperature, fluid recovery, and flow rates if gas to surface during test. Attach extra sheet if more space is needed. Attach copy of log.

Drill Stem Tests Taken Yes No
 Samples Sent to Geological Survey Yes No
 Cores Taken Yes No

Formation Description
 Log Sample

Name	Top	Bottom
Anhydrite	1629	1677
Heebner	3555	3575
Toronto	3581	3601
Lansing	3598	3628
B/KC	3875	3881
Arbuckle	Not Penetrated	
RTD		3950

CASING RECORD New Used
 Report all strings set-conductor, surface, intermediate, production, etc.

Purpose of String	Size Hole Drilled	Size Casing Set (in O.D.)	Weight Lbs/Ft.	Setting Depth	Type of Cement	#Sacks Used	Type and Percent Additives
Surface	12 1/4	8 5/8	24#	270'	common	150	2%gel, 3%CaCl

PERFORATION RECORD		Acid, Fracture, Shot, Cement Squeeze Record	
Shots Per Foot	Specify Footage of Each Interval Perforated	(Amount and Kind of Material Used)	Depth

TUBING RECORD Size Set At Packer at Liner Run Yes No

Date of First Production Producing Method
 Flowing Pumping Gas Lift Other (explain).....

Estimated Production Per 24 Hours	Oil Bbls	Gas MCF	Water Bbls	Gas-Oil Ratio	Gravity

METHOD OF COMPLETION Production Interval

Disposition of gas: Vented Sold Used on Lease

Open Hole Perforation
 Other (Specify).....
 Dualy Completed
 Commingled

