

STATE OF KANSAS  
STATE CORPORATION COMMISSION

15-051-30320-00-00 Form CP-4  
15-051-30320-00-00  
WELL PLUGGING RECORD

Give All Information Completely  
Make Required Affidavit  
Mail or Deliver Report to:  
Conservation Division  
State Corporation Commission  
212 No. Market  
Wichita, Kansas

Ellis County, Sec. 8 Twp. 13 Rge. 18 (E) (W) X

NORTH

Locate well correctly on above  
Section Plat

Location as "NE/CNW/SE/SW" or footage from lines NW NW SE  
Lease Owner John O. Farmer, Inc.  
Lease Name Polifka Well No. 1  
Office Address 370 West Wichita Russell, Kansas 67665  
Character of Well (completed as Oil, Gas or Dry Hole) \_\_\_\_\_  
Date well completed \_\_\_\_\_  
Application for plugging filed 1-21-70 \_\_\_\_\_  
Application for plugging approved 1-22-70 \_\_\_\_\_  
Plugging commenced 1-27-70 \_\_\_\_\_  
Plugging completed 2-10-70 \_\_\_\_\_  
Reason for abandonment of well or producing formation \_\_\_\_\_

If a producing well is abandoned, date of last production \_\_\_\_\_  
Was permission obtained from the Conservation Division or its agents before plugging was commenced? Yes

Name of Conservation Agent who supervised plugging of this well Leo Massey  
Producing formation \_\_\_\_\_ Depth to top \_\_\_\_\_ Bottom \_\_\_\_\_ Total Depth of Well 3812 Feet  
Show depth and thickness of all water, oil and gas formations.

OIL, GAS OR WATER RECORDS

CASING RECORD

FORMATION	CONTENT	FROM	TO	SIZE	PUT IN	PULLED OUT
				8 5/8	168	None
				4 1/2	None	3021'.77

Describe in detail the manner in which the well was plugged, indicating where the mud fluid was placed and the method or methods used in introducing it into the hole. If cement or other plugs were used, state the character of same and depth placed, from \_\_\_\_\_ feet to \_\_\_\_\_ feet for each plug set.

OVER

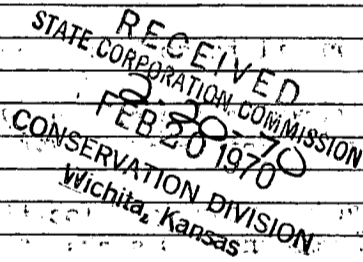

(If additional description is necessary, use BACK of this sheet)  
Name of Plugging Contractor Forbes Casing Pulling Company, Inc.  
Address P. O. Box 221 Great Bend, Kansas 67530

STATE OF Kansas COUNTY OF Barton ss.  
James W. Rockhold (employee of owner) or (owner or operator) of the above-described well, being first duly sworn on oath, says: That I have knowledge of the facts, statements, and matters herein contained and the log of the above-described well as filed and that the same are true and correct. So help me God.

(Signature) James W. Rockhold  
P. O. Box 221 Great Bend, Kansas  
(Address)

SUBSCRIBED AND SWORN to before me this 13 day of February, 19 70

My commission expires May 27, 1973

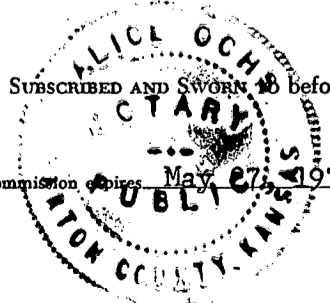

Glenn Ochs  
Notary Public.

20000 20000 20000 20000 20000

Moved in and rigged up C-33 Walker-Neer rig with 60' double pole mast. Pushed a plug to 3,400' and dumped 10 gals of sand in the hole.

Found the casing bridged with sand at 2,800'. Knocked out the bridge and dumped 10 gals of sand and 4 sacks of cement on the plug at 3400'. Strung up two-sheave blocks, dug out the braden head and had 4" of tension in the 4 1/2" casing with 60,000 lbs on the weight indicator.

Worked 5" of tension in the casing with 70,000 lbs. Checked top of cement at 3390'. Loaded the hole with 30 BW and shot the pipe at 3106'. Worked the pipe at 75,000 lbs but couldn't gain any tension. Allied broke circulation with 800 psi and spotted 75 bbls of oil with 500 psi. The plug was pumped to 3,000'.

Waiting on oil to soak.

Worked the casing at 70,000 lbs. and had 14" tension.

Waiting on oil to soak.

Waiting on oil to soak.

Worked pipe but couldn't gain any tension. Waiting on hydraulic jacks.

No increase in tension. Set in hydraulic jacks and worked 22" of tension.

Shot the casing at 3017'. Worked it loose and pulled 2 joints with the jacks. Set out the jacks and pulled 25 joints of wrapped pipe with the blocks.

Found the pipe stuck and could get only 8" of tension with the blocks. Allied broke circulation with water and spotted 50 bbls of oil behind the casing. Couldn't get casing loose while circulating.

Waiting on oil to soak and working pipe.

Waiting on oil to soak and working pipe.

Set in hydraulic jacks. Had 9" tension with 100,000 lbs. Worked the casing loose. Laid down 65 joints of 4 1/2" casing.

Tore down and moved off location. Squeezed down 8 5/8" with 5 sacks of hulls, 30 sacks of gel and 150 sacks of cement.

0000 0000 0000 0000 0000



KANSAS GEOLOGICAL SOCIETY  
 KANSAS WELL LOG BUREAU - KANSAS WELL SAMPLE BUREAU  
 KANSAS GEOLOGICAL SOCIETY BUILDING  
 508 EAST MURDOCK - WICHITA, KANSAS

COPY

COMPANY JOHN O. FARMER, INC.

SEC. 8 T. 13 R. 18W  
 LOC. NW NW SE

FARM Polifka

NO. 1

COUNTY Ellis

KANSAS

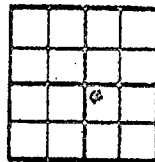

TOTAL DEPTH 3812

COMM. 8-22-66

COMP. 9-2-66

SHOT OR TREATED

CONTRACTOR J. O. Farmer

ISSUED 11-26-66

CASING

20 10  
 15 8 5/8" @ 168' w/125 SX  
 12 6  
 13 4 1/2" @ 3796' w/150 SX

ELEVATION 2169' KB

PRODUCTION ST TST: PMP 25 BO

Plus 25 BWPD GR 31 (Lans 3475-352)

FIGURES INDICATE BOTTOM OF FORMATIONS  
 15-051-30320-00-00  
 15-051-30320-00-00

FORMATION RECORD

Give detailed description and thickness of all formation drilled through, contents of sand, whether dry, water, oil or gas.

Formation	Top	Bottom	Formation	Top	Bottom
Surface		-0-	170'		
Shale		170'	900'		
Shale & Sand		900'	1470'		
Anhydrite		1470'	1510'		
Shale & Shells		1510'	2140'		
Shale & Lime		2140'	2335'		
Lime & Shale		2335'	2550'		
Shale & Lime		2550'	3185'		
Lime & Shale		3185'	3430'		
Lime		3430'	3810'		
Rotary T.D.		3810'			
Log Tops					
				3430'	
				3448'	
				3477'	
				3708'	
				3750'	
				3776'	
				3812'	

RECEIVED  
 STATE CORPORATION COMMISSION  
 JAN 22 1970  
 CONSERVATION DIVISION  
 Wichita, Kansas

I, the undersigned, being first duly sworn upon oath, state that this well record is true, correct and complete according to the records of this office and to the best of my knowledge and belief.

*John O. Farmer*  
 Name and title of representative of company  
 President

Subscribed and sworn to before me this 9th day of September, 1966

My Commission expires 2/15/67

*Helen Carlson*  
 Notary Public

Helen Carlson

FARM NAME Polifka WELL NO. 1 COUNTY Ellis SEC. 8 TWP. 13s RGE. 18w

OPERATOR JOHN O. FARMER, INC.  
 ADDRESS P.O. Box 352, Russell, Ks.

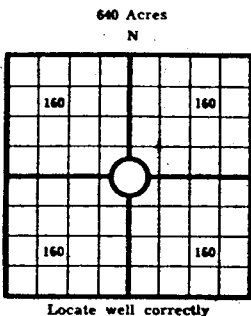

COUNTY Ellis, SEC. 8, TWP. 13s, RGE. 18w  
 COMPANY OPERATING John O. Farmer, Inc.  
 OFFICE ADDRESS Box 352, Russell, Kan.  
 DRILLING STARTED 8/22, 1966, DRILLING FINISHED 9/2, 1966  
 DATE OF FIRST PRODUCTION \_\_\_\_\_ COMPLETED \_\_\_\_\_  
 WELL LOCATED NW 1/4 NW 1/4 SE 1/4, North of South  
 Line and \_\_\_\_\_ ft. East of West Line of Quarter Section  
 Elevation (Relative to sea level) DERRICK FLOOR 2167' GROUND, 2164'  
 CHARACTER OF WELL (Oil, gas or dryhole) oil

OIL OR GAS SANDS OR ZONES

Name	From	To	Name	From	To
1 Lansing KC	3478	3524			
2 Conglomerate	3732	3736			
3					

Perforating Record If Any

Shot Record

Formation	From	To	No. of Shots	Formation	From	To	Size of Shot

CASING RECORD

Amount Set						Amount Pulled		Packer Record	
Size	Wt.	Thds.	Make	Ft.	In.	Size	Length	Depth Set	Make

Liner Record: Amount \_\_\_\_\_ Kind \_\_\_\_\_ Top \_\_\_\_\_ Bottom \_\_\_\_\_

CEMENTING AND MUDDING

Size	Amount Set		Socks Cement	Chemical		Method of Cementing	Amount	Mudding Method	Results (See Note)
	Ft.	In.		Gal.	Make				
8 5/8"	168'	125	sx.						
4 1/2"	3796'	150	sx.						

Note: What method was used to protect sands if outer strings were pulled? \_\_\_\_\_

NOTE: Were bottom hole plugs used? \_\_\_\_\_ If so, state kind, depth set and results obtained \_\_\_\_\_

TOOLS USED

Rotary Tools were used from 0 feet to R.T.D. Cable tools were used from \_\_\_\_\_ feet to \_\_\_\_\_ feet, and from \_\_\_\_\_ feet to \_\_\_\_\_ feet, and from \_\_\_\_\_ feet to \_\_\_\_\_ feet to \_\_\_\_\_

Type Rig Rotary

INITIAL PRODUCTION TEST

Describe initial test: whether by flow through tubing or casing or by pumping \_\_\_\_\_

Amount of Oil Production \_\_\_\_\_ bbls. Size of choke, if any \_\_\_\_\_ Length of test \_\_\_\_\_ Water

Production \_\_\_\_\_ bbls. Gravity of oil \_\_\_\_\_ Type of Pump if pump is used, describe \_\_\_\_\_

FORMATION RECORD

Give detailed description and thickness of all formation drilled through, contents of sand, whether dry, water, oil or gas.

Formation	Top	Bottom	Formation	Top	Bottom
Surface			-0-	170'	
Shale			170'	900'	
Shale & Sand			900'	1470'	
Anhydrite			1470'	1510'	
Shale & Shells			1510'	2140'	
Shale & Lime			2140'	2335'	
Lime & Shale			2335'	2550'	
Shale & Lime			2550'	3185'	
Lime & Shale			3185'	3430'	
Lime			3430'	3810'	
Rotary T.D.			3810'		

15-051-30320-20-00  
 15-051-30320-00-00

Log Tops

Heebner	3430'
Toronto	3448'
Lansing	3477'
B/Kansas City	3708'
Conglomerate	3750'
Arbuckle	3776'
Log T.D.	3812'

RECEIVED  
 STATE CORPORATION COMMISSION  
 FEB 24 1970  
 CONSERVATION DIVISION  
 Wichita, Kansas

I, the undersigned, being duly sworn upon oath, state that this well record is true, correct and complete according to the records of this office and to the best of my knowledge and belief.

\_\_\_\_\_  
 Name and title of representative of company  
 \_\_\_\_\_  
 President  
 \_\_\_\_\_  
 Subscribed and sworn to before me this 9th day of September, 1966  
 \_\_\_\_\_  
 My Commission expires: 2/15/67  
 \_\_\_\_\_  
 Notary Public

Helen Carlson