

RECEIVED *OWWO*

Form C-1
March 2010

MAY 13 2011

Form must be Typed
Form must be Signed
blanks must be Filled

For KCC Use: 5-31-2011
Effective Date: _____
District # 1
SGA? Yes No

KANSAS CORPORATION COMMISSION
OIL & GAS CONSERVATION DIVISION

NOTICE OF INTENT TO DRILL

KCC WICHITA

Must be approved by KCC five (5) days prior to commencing well
Form KSONA-1, Certification of Compliance with the Kansas Surface Owner Notification Act, MUST be submitted with this form.

Expected Spud Date: May 20 2011
month day year

OPERATOR: License# 31514
Name: Thoroughbred Associates, LLC
Address 1: 8100 E. 22nd St. No.
Address 2: Bldg. 600, Suite F
City: Wichita State: KS Zip: 67226 + _____
Contact Person: Robert C. Patton, Managing Partner
Phone: 316-685-1512

CONTRACTOR: License# 33784
Name: Trinidad Drilling, L.P.

Spot Description: _____
C - SE - SE - _____ Sec. 21 Twp. 21 S. R. 34 E W
(Q/Q/Q) 660 _____ feet from N / S Line of Section
660 _____ feet from E / W Line of Section

Is SECTION: Regular Irregular?
(Note: Locate well on the Section Plat on reverse side)
County: Finney

Lease Name: Crist OWWO Well #: 1
Field Name: Nunn Ext

Is this a Prorated / Spaced Field? Yes No
Target Formation(s): Chase Winfield

Nearest Lease or unit boundary line (in footage): 660
Ground Surface Elevation: 2966 feet MSL

Water well within one-quarter mile: Yes No
Public water supply well within one mile: Yes No

Depth to bottom of fresh water: 180
Depth to bottom of usable water: 1050

Surface Pipe by Alternate: I II
Length of Surface Pipe ~~planned to be set:~~ 321

Length of Conductor Pipe (if any): _____
Projected Total Depth: 3000
Formation at Total Depth: Council Grove

Water Source for Drilling Operations:
 Well Farm Pond Other: _____
DWR Permit #: _____

(Note: Apply for Permit with DWR)
Will Cores be taken? Yes No

If Yes, proposed zone: _____

Well Drilled For: Oil Gas Enh Rec Storage Disposal Seismic; _____ # of Holes Other: _____
Well Class: Infield Pool Ext. Wildcat Other
Type Equipment: Mud Rotary Air Rotary Cable

If OWWO: old well information as follows:
Operator: Kimbark Operating Co.
Well Name: Crist #1
Original Completion Date: 9/6/1980 Original Total Depth: 4900

Directional, Deviated or Horizontal wellbore? Yes No
If Yes, true vertical depth: _____
Bottom Hole Location: _____
KCC DKT #: _____

PRORATED & SPACED: Hugoton-Panama

AFFIDAVIT

The undersigned hereby affirms that the drilling, completion and eventual plugging of this well will comply with K.S.A. 55 et. seq.
It is agreed that the following minimum requirements will be met:

1. Notify the appropriate district office **prior** to spudding of well;
2. A copy of the approved notice of intent to drill **shall be** posted on each drilling rig;
3. The minimum amount of surface pipe as specified below **shall be set** by circulating cement to the top; in all cases surface pipe **shall be set** through all unconsolidated materials plus a minimum of 20 feet into the underlying formation.
4. If the well is dry hole, an agreement between the operator and the district office on plug length and placement is necessary **prior to plugging**;
5. The appropriate district office will be notified before well is either plugged or production casing is cemented in;
6. If an ALTERNATE II COMPLETION, production pipe shall be cemented from below any usable water to surface within **120 DAYS** of spud date. Or pursuant to Appendix "B" - Eastern Kansas surface casing order #133,891-C, which applies to the KCC District 3 area, alternate II cementing must be completed within 30 days of the spud date or the well shall be plugged. **In all cases, NOTIFY district office** prior to any cementing.

I hereby certify that the statements made herein are true and to the best of my knowledge and belief.

Date: 05/12/11 Signature of Operator or Agent: [Signature] Title: Partner

For KCC Use ONLY
API # 15 - 15-055-20422-00-01
Conductor pipe required None feet
Minimum surface pipe required 321 feet per ALT. I II
Approved by: [Signature] 5-26-2011
This authorization expires: 5-26-2012
(This authorization void if drilling not started within 12 months of approval date.)
Spud date: _____ Agent: _____

Remember to:

- File Certification of Compliance with the Kansas Surface Owner Notification Act (KSONA-1) with Intent to Drill;
- File Drill Pit Application (form CDP-1) with Intent to Drill;
- File Completion Form ACO-1 within 120 days of spud date;
- File acreage attribution plat according to field proration orders;
- Notify appropriate district office 48 hours prior to workover or re-entry;
- Submit plugging report (CP-4) after plugging is completed (within 60 days);
- Obtain written approval before disposing or injecting salt water.
- If well will not be drilled or permit has expired (See: authorized expiration date) please check the box below and return to the address below.

Well will not be drilled or Permit Expired Date: _____
Signature of Operator or Agent: _____

Mail to: KCC - Conservation Division,
130 S. Market - Room 2078, Wichita, Kansas 67202

RECEIVED

MAY 26 2011

KCC WICHITA

21
21
34
 E
 W

For KCC Use ONLY

API # 15 - 15-055-20422-00-01

RECEIVED

MAY 13 2011

KCC WICHITA

IN ALL CASES PLOT THE INTENDED WELL ON THE PLAT BELOW

In all cases, please fully complete this side of the form. Include items 1 through 5 at the bottom of this page.

Operator: Thoroughbred Associates, LLC
Lease: Crist OWWO
Well Number: 1
Field: Nunn Ext

Location of Well: County: Finney
660 feet from N / S Line of Section
660 feet from E / W Line of Section
Sec. 21 Twp. 21 S. R. 34 E W

Number of Acres attributable to well: 640 Acre unit
QTR/QTR/QTR/QTR of acreage: C - SE - SE -

Is Section: Regular or Irregular

If Section is Irregular, locate well from nearest corner boundary.

Section corner used: NE NW SE SW

PLAT

Show location of the well. Show footage to the nearest lease or unit boundary line. Show the predicted locations of lease roads, tank batteries, pipelines and electrical lines, as required by the Kansas Surface Owner Notice Act (House Bill 2032). You may attach a separate plat if desired.

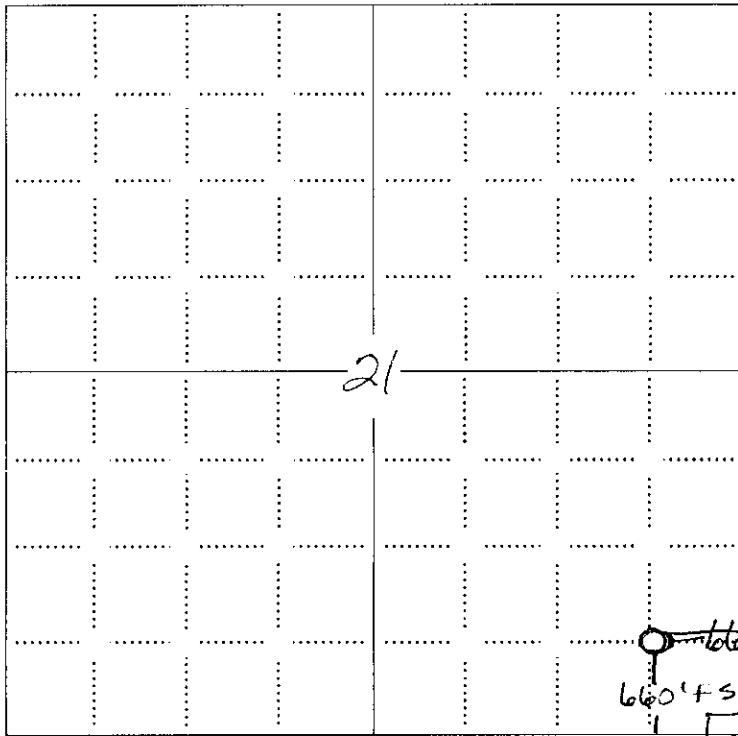

LEGEND

- Well Location (circle)
Tank Battery Location (rectangle)
Pipeline Location (solid line)
Electric Line Location (dashed line)
Lease Road Location (thick solid line)

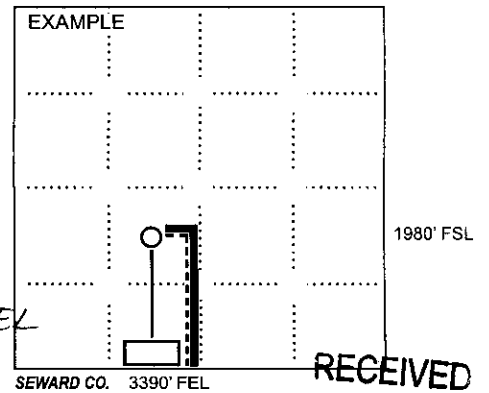

NOTE: In all cases locate the spot of the proposed drilling location.

In plotting the proposed location of the well, you must show:

- 1. The manner in which you are using the depicted plat by identifying section lines, i.e. 1 section, 1 section with 8 surrounding sections, 4 sections, etc.
2. The distance of the proposed drilling location from the south / north and east / west outside section lines.
3. The distance to the nearest lease or unit boundary line (in footage).
4. If proposed location is located within a prorated or spaced field a certificate of acreage attribution plat must be attached: (CO-7 for oil wells; CG-8 for gas wells).
5. The predicted locations of lease roads, tank batteries, pipelines, and electrical lines.

RECEIVED

MAY 26 2011

KCC WICHITA

**CERTIFICATION OF COMPLIANCE WITH THE
KANSAS SURFACE OWNER NOTIFICATION ACT**

KCC WICHITA

This form must be submitted with all Forms C-1 (Notice of Intent to Drill); CB-1 (Cathodic Protection Borehole Intent); T-1 (Request for Change of Operator Transfer of Injection or Surface Pit Permit); and CP-1 (Well Plugging Application). Any such form submitted without an accompanying Form KSONA-1 will be returned.

Select the corresponding form being filed: C-1 (Intent) CB-1 (Cathodic Protection Borehole Intent) T-1 (Transfer) CP-1 (Plugging Application)

OPERATOR: License # 31514
Name: Thoroughbred Associates, LLC
Address 1: 8100 E. 22nd St. No.
Address 2: Bldg. 600, Suite F
City: Wichita State: KS Zip: 67226 + _____
Contact Person: Robert C. Patton, Managing Partner
Phone: (316) 685-1512 Fax: (316) 685-4821
Email Address: karri@lipizzancompanies.com

Well Location:
C SE SE Sec. 21 Twp. 21 S. R. 34 East West
County: Finney
Lease Name: Crist OWWO Well #: 1

If filing a Form T-1 for multiple wells on a lease, enter the legal description of the lease below:

Surface Owner Information:

Name: Raymond & Cledith Crist
Address 1: 18560 Big Lowe Road
Address 2: _____
City: Holcomb State: KS Zip: 67851 + _____

When filing a Form T-1 involving multiple surface owners, attach an additional sheet listing all of the information to the left for each surface owner. Surface owner information can be found in the records of the register of deeds for the county, and in the real estate property tax records of the county treasurer.

If this form is being submitted with a Form C-1 (Intent) or CB-1 (Cathodic Protection Borehole Intent), you must supply the surface owners and the KCC with a plat showing the predicted locations of lease roads, tank batteries, pipelines, and electrical lines. The locations shown on the plat are preliminary non-binding estimates. The locations may be entered on the Form C-1 plat, Form CB-1 plat, or a separate plat may be submitted.

Select one of the following:

- I certify that, pursuant to the Kansas Surface Owner Notice Act (House Bill 2032), I have provided the following to the surface owner(s) of the land upon which the subject well is or will be located: 1) a copy of the Form C-1, Form CB-1, Form T-1, or Form CP-1 that I am filing in connection with this form; 2) if the form being filed is a Form C-1 or Form CB-1, the plat(s) required by this form; and 3) my operator name, address, phone number, fax, and email address.
- I have not provided this information to the surface owner(s). I acknowledge that, because I have not provided this information, the KCC will be required to send this information to the surface owner(s). To mitigate the additional cost of the KCC performing this task, I acknowledge that I am being charged a \$30.00 handling fee, payable to the KCC, which is enclosed with this form.

If choosing the second option, submit payment of the \$30.00 handling fee with this form. If the fee is not received with this form, the KSONA-1 form and the associated Form C-1, Form CB-1, Form T-1, or Form CP-1 will be returned.

I hereby certify that the statements made herein are true and correct to the best of my knowledge and belief.

Date: 05/12/11 Signature of Operator or Agent: [Signature] Title: Partner

RECEIVED
MAY 26 2011
KCC WICHITA

15-055-20422-00-01

Karri

From: "Pro-Stake LLC" <burt@pro-stakellc.kscoxmail.com>
To: "Karri" <Karri@lipizzancompanies.com>
Sent: Monday, May 09, 2011 9:16 AM
Subject: RE: Finney Co owwo
Karri,

Sorry about that, yes we have already staked it.

It was basically where the KGS records said it was.

Crist OWWO #1 (relocated abandoned well casing)
Approx. SE SE (per KGS records)
SE/4 of Section 21-21s-34w
2966' = gr. elev. (per KGS records)
Finney County, KS
Staked relocated abandoned well casing with:
"T" post and 7' wood stake, painted Orange and Blue
Location is in wheat
Location is very flat with 1 ft. bumps in all direction

Call me if you need anything else.

Thanks,
Burt

From: Karri [mailto:Karri@lipizzancompanies.com]
Sent: Monday, May 09, 2011 8:46 AM
To: Burt West
Subject: Finney Co owwo

Hi Burt,
Need to intent Finney Co owwo, has it been staked? Thx, Karri

RECEIVED
MAY 26 2011

KCC WICHITA

RECEIVED
MAY 13 2011
KCC WICHITA

STATE OF KANSAS
STATE CORPORATION COMMISSION

WELL PLUGGING RECORD

Give All Information Completely
Make Required Affidavit
Mail or Deliver Report to
Conservation Division
State Corporation Comm.
245 North Water
Wichita, KS 67202

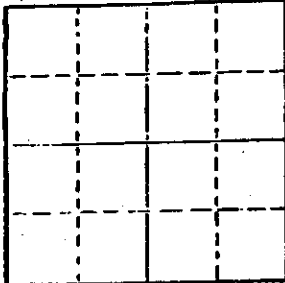

Locate well correctly on above Section Plat

Finney County, Sec. 21 Twp. 21S Rge. 34W E/W
Location as "NE/CNW/SW" or footage from lines _____
C SE SE
Lease Owner Kimbark Operating Company
Lease Name Crist Well No. 1
Office Address 1580 Lincoln St, Suite 700, Denver, Col 80203
Character of Well (Completed as Oil, Gas or Dry Hole) _____
Dry
Date Well completed Sept. 16, 1980
Application for plugging filed Sept. 15, 1980
Application for plugging approved Sept. 15, 1980
Plugging commenced Sept. 16, 1980
Plugging completed Sept. 16, 1980
Reason for abandonment of well or producing formation _____
Dry

If a producing well is abandoned, date of last production _____ 19

Was permission obtained from the Conservation Division or its agents before plugging was commenced? Yes _____

Name of Conservation Agent who supervised plugging of this well Clarence Thomas
Producing formation _____ Depth to top _____ Bottom _____ Total Depth of Well 4900
Show depth and thickness of all water, oil and gas formations.

OIL, GAS OR WATER RECORDS

CASING RECORD

FORMATION	CONTENT	FROM	TO	SIZE	PUT IN	PULLED OUT
		0	321	8 5/8		

Describe in detail the manner in which the well was plugged, indicating where the mud fluid was placed and the method or methods used in introducing it into the hold. If cement or other plugs were used, state the character of same and depth placed, from _____ feet to _____ feet for each plug set.

Plugged:
60 sacks @ 600
35 sacks @ 300
10 sacks 40' - 0'
5 sacks in rathole, 5 sacks in mousehole
Completed 2:30AM on 9-16-80
Sun Cementing

RECEIVED
STATE CORPORATION COMMISSION

SEP 29 1980

CONSERVATION DIVISION
Wichita, Kansas

(If additional description is necessary, use BACK of this sheet)

Name of Plugging Contractor DaMac Drilling Inc
Box 1164, Great Bend, Ks. 67530

STATE OF Kansas COUNTY OF Barton
(employee of owner) or (owner or operator) of the above-described well, being first duly sworn on oath, says: That I have knowledge of the facts, statements, and matters herein contained and the log of the above-described well as filed and that the same are true and correct. So help me God.

(Signature) *Matthew J. McKinnon*
Box 1164, Great Bend, Ks. 67530
(Address)

Subscribed and Sworn to before me this 17th day of Sept. 1980

My commission expires _____

Notary Public
Barton County, Kansas
My Appt. Exp. 2-28-84

RECEIVED

MAY 26 2011

KCC WICHITA

RECEIVED

KANSAS CORPORATION COMMISSION
OIL & GAS CONSERVATION DIVISION

MAY 13 2011

Form CDP-1
May 2010
Form must be Typed

APPLICATION FOR SURFACE PIT **KCC WICHITA**

Submit in Duplicate

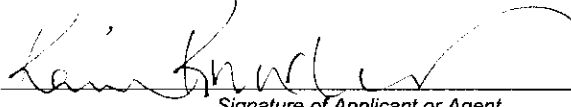
Operator Name: Thoroughbred Associates, LLC		License Number: 31514
Operator Address: 8100 E. 22nd St. No.		Bldg. 600, Suite F Wichita KS 67226
Contact Person: Robert C. Patton, Managing Partner		Phone Number: 316-685-1512
Lease Name & Well No.: Crist OWWO 1		Pit Location (QQQQ): C SE SE Sec. 21 Twp. 21 R. 34 <input type="checkbox"/> East <input checked="" type="checkbox"/> West 660 Feet from <input type="checkbox"/> North / <input checked="" type="checkbox"/> South Line of Section 660 Feet from <input checked="" type="checkbox"/> East / <input type="checkbox"/> West Line of Section Finney County
Type of Pit: <input type="checkbox"/> Emergency Pit <input type="checkbox"/> Burn Pit <input type="checkbox"/> Settling Pit <input checked="" type="checkbox"/> Drilling Pit <input type="checkbox"/> Workover Pit <input type="checkbox"/> Haul-Off Pit <small>(If WP Supply API No. or Year Drilled)</small>	Pit is: <input checked="" type="checkbox"/> Proposed <input type="checkbox"/> Existing If Existing, date constructed: _____ Pit capacity: 6,800 (bbls)	
Is the pit located in a Sensitive Ground Water Area? <input type="checkbox"/> Yes <input checked="" type="checkbox"/> No		Chloride concentration: _____ mg/l <small>(For Emergency Pits and Settling Pits only)</small>
Is the bottom below ground level? <input checked="" type="checkbox"/> Yes <input type="checkbox"/> No	Artificial Liner? <input checked="" type="checkbox"/> Yes <input type="checkbox"/> No	How is the pit lined if a plastic liner is not used?
Pit dimensions (all but working pits): 80 Length (feet) 80 Width (feet) <input type="checkbox"/> N/A: Steel Pits Depth from ground level to deepest point: 3 (feet) <input type="checkbox"/> No Pit		
If the pit is lined give a brief description of the liner material, thickness and installation procedure.		Describe procedures for periodic maintenance and determining liner integrity, including any special monitoring. <p style="text-align: right;">RECEIVED MAY 26 2011 KCC WICHITA</p>
Distance to nearest water well within one-mile of pit: 4403 feet Depth of water well 160 feet		Depth to shallowest fresh water 85 feet. Source of information: <input type="checkbox"/> measured <input type="checkbox"/> well owner <input type="checkbox"/> electric log <input checked="" type="checkbox"/> KDWR
Emergency, Settling and Burn Pits ONLY: Producing Formation: _____ Number of producing wells on lease: _____ Barrels of fluid produced daily: _____ Does the slope from the tank battery allow all spilled fluids to flow into the pit? <input type="checkbox"/> Yes <input type="checkbox"/> No		Drilling, Workover and Haul-Off Pits ONLY: Type of material utilized in drilling/workover: fresh Number of working pits to be utilized: 2 Abandonment procedure: evaporate and backfill Drill pits must be closed within 365 days of spud date.
I hereby certify that the above statements are true and correct to the best of my knowledge and belief. 05/12/11 Date  Signature of Applicant or Agent		

15055-20422-0001

KCC OFFICE USE ONLY			
Date Received: 5-26-11	Permit Number: _____	Permit Date: 5-26-11	Lease Inspection: <input type="checkbox"/> Yes <input checked="" type="checkbox"/> No
<input type="checkbox"/> Liner	<input type="checkbox"/> Steel Pit	<input type="checkbox"/> RFAC	<input type="checkbox"/> RFAS

Mail to: KCC - Conservation Division, 130 S. Market - Room 2078, Wichita, Kansas 67202