

For KCC Use: 6-7-2011
Effective Date: 6-7-2011
District # _____
SGA? Yes No

KANSAS CORPORATION COMMISSION
OIL & GAS CONSERVATION DIVISION

OWWO

Form C-1
March 2010

Form must be Typed
Form must be Signed
All blanks must be Filled

NOTICE OF INTENT TO DRILL

Must be approved by KCC five (5) days prior to commencing well
Form KSONA-1, Certification of Compliance with the Kansas Surface Owner Notification Act, MUST be submitted with this form.

Expected Spud Date: JUNE 5 2011
month day year

OPERATOR: License# 3077
Name: JOHNSON OIL
Address 1: 258 east highway 36
Address 2: _____
City: PHILLIPSBURG State: KS Zip: 67661 + _____
Contact Person: KEVIN JOHNSON
Phone: 785 543 6171
CONTRACTOR: License# 3077
Name: JOHNSON OIL- COMPANY EQUIPMENT

Spot Description: NW SW NW
nw sw nw Sec. 22 Twp. 8 S. R. 19 E W
(a/a/a/a) 3,630 feet from N / S Line of Section
4,950 feet from E / W Line of Section

Is SECTION: Regular Irregular?
(Note: Locate well on the Section Plat on reverse side)
County: ROOKS COUNTY KANSAS
Lease Name: PETERSON Well #: 1
Field Name: WEBSTER

Is this a Prorated / Spaced Field? Yes No
Target Formation(s): ARBUCKLE
Nearest Lease or unit boundary line (in footage): 3763

Ground Surface Elevation: 2004 feet MSL
Water well within one-quarter mile: Yes No
Public water supply well within one mile: Yes No
Depth to bottom of fresh water: 100
Depth to bottom of usable water: 840
Surface Pipe by Alternate: I II
Length of Surface Pipe ~~Planned to be set:~~ 187 already in place
Length of Conductor Pipe (if any): 0
Projected Total Depth: 3458
Formation at Total Depth: arbuclle

Water Source for Drilling Operations:
 Well Farm Pond Other: _____
DWR Permit #: _____
(Note: Apply for Permit with DWR
Will Cores be taken? Yes No
If Yes, proposed zone: _____

Well Drilled For: Oil Gas Enh Rec Storage Disposal Seismic; # of Holes _____ Other: _____
Well Class: Infield Pool Ext. Wildcat Other _____
Type Equipment: Mud Rotary Air Rotary Cable
 If OWWO: old well information as follows:
Operator: KAISER FRANCIS
Well Name: PETERSON 1 API 15-163-01400-00-00
Original Completion Date: 12-17-47 Original Total Depth: 3458

Directional, Deviated or Horizontal wellbore? Yes No
If Yes, true vertical depth: _____
Bottom Hole Location: _____
KCC DKT #: _____

AFFIDAVIT

The undersigned hereby affirms that the drilling, completion and eventual plugging of this well will comply with K.S.A. 55 et. seq.
It is agreed that the following minimum requirements will be met:

1. Notify the appropriate district office **prior** to spudding of well;
2. A copy of the approved notice of intent to drill **shall be** posted on each drilling rig;
3. The minimum amount of surface pipe as specified below **shall be set** by circulating cement to the top; in all cases surface pipe **shall be set** through all unconsolidated materials plus a minimum of 20 feet into the underlying formation.
4. If the well is dry hole, an agreement between the operator and the district office on plug length and placement is necessary **prior to plugging**;
5. The appropriate district office will be notified before well is either plugged or production casing is cemented in;
6. If an ALTERNATE II COMPLETION, production pipe shall be cemented from below any usable water to surface within **120 DAYS** of spud date. Or pursuant to Appendix "B" - Eastern Kansas surface casing order #133,891-C, which applies to the KCC District 3 area, alternate II cementing must be completed within 30 days of the spud date or the well shall be plugged. **In all cases, NOTIFY district office** prior to any cementing.

I hereby certify that the statements made herein are true and to the best of my knowledge and belief.

Date: JUNE 30 2011 Signature of Operator or Agent: [Signature] Title: OPERATOR

For KCC Use ONLY
API # 15 - 163-01400-00-02
Conductor pipe required None feet
Minimum surface pipe required 187 feet per ALT. I II
Approved by: [Signature]
This authorization expires: 6-2-2012
(This authorization void if drilling not started within 12 months of approval date.)
Spud date: _____ Agent: _____

Remember to:
- File Certification of Compliance with the Kansas Surface Owner Notification Act (KSONA-1) with Intent to Drill;
- File Drill Pit Application (form CDP-1) with Intent to Drill;
- File Completion Form ACO-1 within 120 days of spud date;
- File acreage attribution plat according to field proration orders;
- Notify appropriate district office 48 hours prior to workover or re-entry;
- Submit plugging report (CP-4) after plugging is completed (within 60 days);
- Obtain written approval before disposing or injecting salt water.
- If well will not be drilled or permit has expired (See: authorized expiration date) please check the box below and return to the address below.
 Well will not be drilled or Permit Expired Date: _____
Signature of Operator or Agent: _____

Mail to: KCC - Conservation Division,
130 S. Market - Room 2078, Wichita, Kansas 67202

RECEIVED
JUN 01 2011
KCC WICHITA

22
8
19
 E
 W

For KCC Use ONLY

API # 15 - 163-01400-00-02

IN ALL CASES PLOT THE INTENDED WELL ON THE PLAT BELOW

In all cases, please fully complete this side of the form. Include items 1 through 5 at the bottom of this page.

Operator: JOHNSON OIL
 Lease: PETERSON
 Well Number: 1
 Field: WEBSTER
 Number of Acres attributable to well: _____
 QTR/QTR/QTR/QTR of acreage: _____ - nw - sw - nw

Location of Well: County: ROOKS COUNTY KANSAS
 3,630 feet from N / S Line of Section
 4,950 feet from E / W Line of Section
 Sec. 22 Twp. 8 S. R. 19 E W

Is Section: Regular or Irregular

If Section is Irregular, locate well from nearest corner boundary.
 Section corner used: NE NW SE SW

PLAT

Show location of the well. Show footage to the nearest lease or unit boundary line. Show the predicted locations of lease roads, tank batteries, pipelines and electrical lines, as required by the Kansas Surface Owner Notice Act (House Bill 2032).
 You may attach a separate plat if desired.

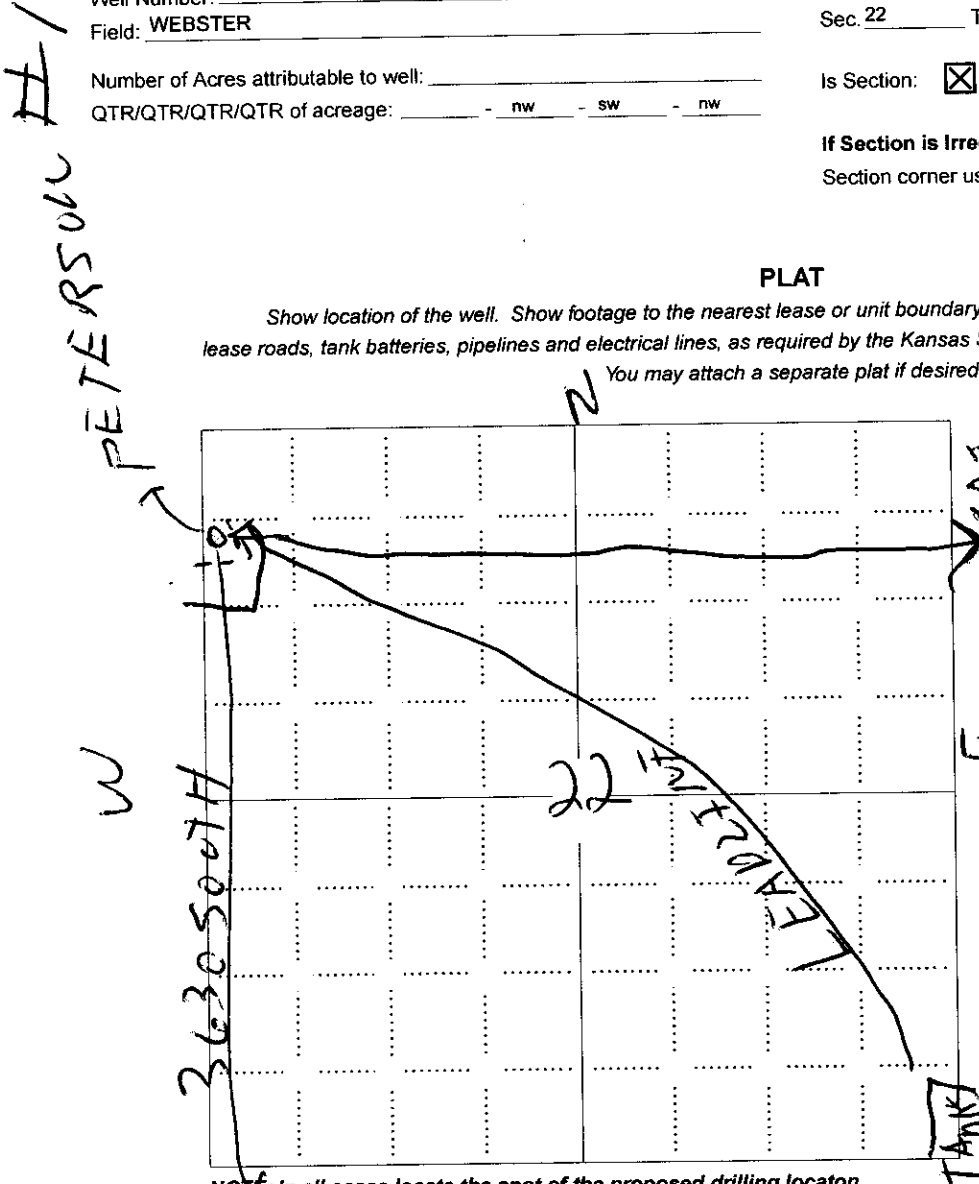

LEGEND

- Well Location
- Tank Battery Location
- Pipeline Location
- Electric Line Location
- Lease Road Location

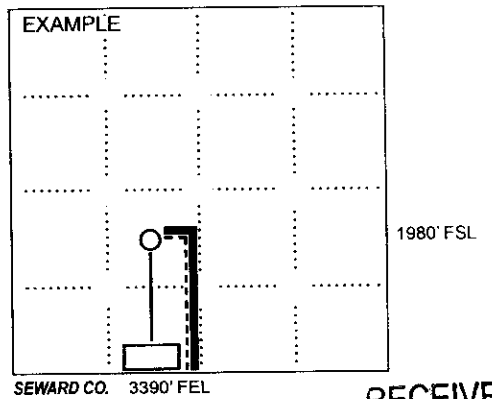

NOTE: In all cases locate the spot of the proposed drilling location.

In plotting the proposed location of the well, you must show:

1. The manner in which you are using the depicted plat by identifying section lines, i.e. 1 section, 1 section with 8 surrounding sections, 4 sections, etc.
2. The distance of the proposed drilling location from the south / north and east / west outside section lines.
3. The distance to the nearest lease or unit boundary line (in footage).
4. If proposed location is located within a prorated or spaced field a certificate of acreage attribution plat must be attached: (CO-7 for oil wells; CG-8 for gas wells).
5. The predicted locations of lease roads, tank batteries, pipelines, and electrical lines.

RECEIVED
JUN 01 2011

KCC WICHITA

15-163-01400-0000

WELL LOG BUREAU KANSAS GEOLOGICAL SOCIETY
412 Union National Bldg. Wichita, Kansas

15-163-01400

Company W. L. HARTMAN
Farm Peterson No. 1

SEC. 22 T. 8 R19W
NW SW NW

Total Depth. 3458'
Comm. 11-21-47 Comp. 12-17-47
Shot or Treated.
Contractor.
Issued. 2-7-48

County. Rooks

KANSAS

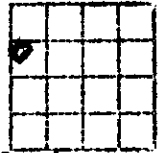

Elevation. 2004' *2nd.*

Production. 168 BO Pot. *4*

CASING

8 5/8" 185'
7" 3452'

Figures Indicate Bottom of Formations.

shale & shells	186
shale	320
shale & sand	1170
shale & red bed	1370
red bed & shale	1425
anhydrite	1455
shale	1640
shale, shells & salt	1865
shale & lime	2265
lime	2360
shale	2460
lime & shale	2630
shale	2680
shale & shells	2800
shale	3005
lime & shale	3085
lime	3458
Total Depth	3458'
Tops: (DF)	
Topeka	2968
Heebner	3158
Lans. K. C.	3183
Base K. C.	3407
Top Cong.	3430
Arbuckle	3449

Set 12 hours Fillup 2300' oil, 150'
wtr. Rigging up will run tubing & rods.
Ran bailer at 7:00 a.m. 2300' of fluid
in hole. 12 hrs. ran bailer 100' off
bottom full bailer of wtr. Ran bailer
150' off bottom about 1/3 of a bailer
of wtr. ran bailer to bottom of hole -
clean.

RECEIVED
JUN 8 2011
KCC WICHITA

PETERSON WLF PLUGGED

6 070530

NOV 20 1986
API NUMBER 15-163-01400-00-00

To: STATE CORPORATION COMMISSION
CONSERVATION DIVISION - PLUGGING SECTION
200 COLORADO DERBY BUILDING
WICHITA, KANSAS 67202

NW-SW-NW SEC. 22, T. 8 S. R. 19

_____ feet from S section line
_____ feet from E section line

TECHNICIAN'S PLUGGING REPORT

Operator License # 6568
Operator: Kaiser-Francis Oil Co.
Name & Address: 70. Box 21468
Tulsa, OK. 74121-1468
Glenn Jackson

Lease Name Peterson Well # 1
County Rooks 112.39
Well Total Depth 3458 feet
Conductor Pipe: Size 0 feet
Surface Casing: Size 10 3/4 feet 185'

Abandoned Oil Well Gas Well _____ Input Well _____ SWD Well _____ D&A _____

Other well as hereinafter indicated _____

Plugging Contractor B.V. Titzen License Number _____
Address Box 69 Hays, Kans 67601

RECEIVED
JUN 01 2011

Company to plug at: Hour: 3:30 PM Day: 20th Month: Nov. Year: 86

Plugging proposal received from John Glenn - & Glenn Jackson

(company name) Kaiser-Francis Oil Co (phone 916-564-8214)

were: 10 3/4" 185' cml #150, 7" csg set @ 3450' #150 cml, 5 1/2" lines
to 3449' #150, open hole, No pipe recovery, Sakote Cement / U.K.
Proposal - Order 275 #65 Formix Gel - 2% additive - 2" cello slake,
and 6" shells. With pump truck load and pressure 10' + 7" annulus,
7" csg and 5 1/2" csg annulus with cement, and then load + pressure 5 1/2" csg
with cement.

Plugging Proposal Received by Marion Schmidt (TECHNICIAN)
Raymond Arbychute @ 1475' and 870'

Plugging Operations attended by Agent?: All Part _____ None _____

Operations Completed: Hour: 3:30 PM Day: 20th Month: Nov. Year: 1986

ACTUAL PLUGGING REPORT 10 3/4" cml @ 185' cml #150 cml, 7" csg set @ 3450' #150 cml

5 1/2" csg set @ 3449' #150, open hole 7 ft. No pipe recovery. Pumped
at 1475' and 870'. Ordered 275 #65 Formix Gel - Additive, 2" slake + 6" shells.
with pump truck pumped in 10' + 7" annulus 125' cml #12" shells, 200 Psi.g.
Pumped in 7' + 5 1/2" annulus - No Cement, 1000 Psi.g.
Pumped in 5 1/2" csg #150 cml #12" cello slake + #13" shells (Max 600 - 151.300)

Remarks: Cemented by B.V. Titzen, Hays
(If additional description is necessary, use BACK of this form.)

INVOICED

DATE 12-9-86

INV. NO. 15520

JAN 08 1987

Signed Marion Schmidt (TECHNICIAN)

FORM CP-2/3
Rev. 01-84

12/8/86

15-163-01400-0001

JOHNSON OIL
PHILLIPSBURG KS 67661

22-08S-19W
NW SW NW

#1 PETERSON OWWO

site: 7-3/4 N OF ZURICH KS
contr: JOHNSON OIL
gas:

city: ROCKS
field: WEBSTER

API 15-163-01400

date 08/21/2001 spd date 08/28/2001 chg date 09/07/2001 card date 12/03/2001 last date 12/03/2001

ELV: 2004 GL SMP	
tops.....	depth/datum
ANH.....	1405 +599
B/ANH.....	1455 +549
TOP.....	2968 -964
HEEB.....	3158 -1154
LANS.....	3183 -1179
BKC.....	3407 -1403
PBTD.....	3420 -1416
CONG.....	3430 -1426
ARB.....	3449 -1446
RTD GLD.....	3458 -1454
NO LOG	

IP status:
 OIL, P 3 BO & 40 BWPD, LKC 3202-3244 OA, 10/18/2001
 OLD INFO: OPERATOR WAS W L HARTMAN, 1
 PETERSON, SPD 11/21/1947, 12/06/1947 10-3/4" 187 (ALT 2),
 5-1/2" 3449, OIL, P 168 BOPD, NW, ARB 3449-3458 ,
 12/17/1947(CARD ISSUED 01/09/1948)
 CONTR: UNKNOWN
 COMMENT: WAS TEMP API 15-JOG-29086
 DRLR SD ZNS: 320-1170 (SH & SD)
 SALT ZN: 1640-1865 (SH, SHELLS & SALT)
 NO CORES OR TSTS

COPYRIGHT 2001
INDEPENDENT OIL & GAS SERVICE, INC.
WICHITA, KANSAS

(over)

RECEIVED
JUN 01 2011
KCC WICHITA

RECEIVED

NOV 26 2001

KCC WICHITA

KANSAS CORPORATION COMMISSION
OIL & GAS CONSERVATION DIVISION

Form ACO-1
September 1999
Form Must Be Typed

WELL COMPLETION FORM
WELL HISTORY - DESCRIPTION OF WELL & LEASE

ORIGINAL

Operator: License # 3077
Name: JOHNSON OIL
Address: 258 east highway 36
City/State/Zip: PHILLIPSBURG KANSAS 67661
Purchaser: EOTT
Operator Contact Person: KEVIN JOHNSON
Phone: () 785 543 6171
Contractor: Name: n/a COMPANY EQUIPMENT
License: n/a
Wellsite Geologist: N/A

Designate Type of Completion:
X New Well X Re-Entry Workover
 Oil SWD SIOW Temp. Abd.
 Gas ENHR SIGW
 Dry Other (Core, WSW, Expl., Cathodic, etc)

If Workover/Re-entrv: Old Well Info as follows:
Operator: Francis Kaiser
Well Name: PETERSON 1
Original Comp. Date: 12-17-47 Original Total Depth: 3458
 Deepening Re-perf. Conv. to Enhr./SWD
 Plug Back 3420 Plug Back Total Depth
 Commingled Docket No.
 Dual Completion Docket No.
 Other (SWD or Enhr.?) Docket No.
8-26-01 9-25-2001 10-18-2001
Spud Date or Date Reached TD Completion Date or
Recompletion Date Recompletion Date

API No. 15 - 163-01400-00-01
County: ROOKS COUNTY KANSAS
NW SW NW Sec. 22 Twp. 8 S. R. 19 W East West
3630 south feet from S / N (circle one) Line of Section
4950 east feet from E / W (circle one) Line of Section
Footages Calculated from Nearest Outside Section Corner:
(circle one) NE SE NW SW
Lease Name: PETERSON Well # 1
Field Name: webster
Producing Formation: lansing k/c
Elevation: Ground: 2004 Kelly Bushing: 2FT
Total Depth: 3458 Plug Back Total Depth: 3420
Amount of Surface Pipe Set and Cemented at 187 feet Feet
Multiple Stage Cementing Collar Used? Yes No
If yes, show depth set Feet
If Alternate II completion, cement circulated from 3448
feet depth to SURFACE w/ 300 sx cm.
BETWEEN 7inch and 5 1/2 casing
Drilling Fluid Management Plan P+A RGR 7/25/07
(Data must be collected from the Reserve Pit)
Chloride content N/A ppm Fluid volume bbls
Dewatering method used
Location of fluid disposal if hauled offsite:
Operator Name:
Lease Name: License No.:
Quarter Sec. Twp. S. R. East West
County: Docket No.:

INSTRUCTIONS: An original and two copies of this form shall be filed with the Kansas Corporation Commission, 130 S. Market - Room 2078, Wichita, Kansas 67202, within 120 days of the spud date, recompletion, workover or conversion of a well. Rule 82-3-130, 82-3-106 and 82-3-107 apply. Information of side two of this form will be held confidential for a period of 12 months if requested in writing and submitted with the form (see rule 82-3-107 for confidentiality in excess of 12 months). One copy of all wireline logs and geologist well report shall be attached with this form. ALL CEMENTING TICKETS MUST BE ATTACHED. Submit CP-4 form with all plugged wells. Submit CP-111 form with all temporarily abandoned wells.

All requirements of the statutes, rules and regulations promulgated to regulate the oil and gas industry have been fully complied with and the statements herein are complete and correct to the best of my knowledge.

Signature: Kevin Johnson JOHNSON OIL
Title: OPERATOR Date:
Subscribed and sworn to before me this 20th day of NOVEMBER
10 2001.
Notary Public: Waneta Fae Gower
Date Commission Expires: 12-05-2003

KCC Office Use ONLY
 Letter of Confidentiality Attached
If Denied, Yes Date:
 Wireline Log Received
 Geologist Report Received
 UIC Distribution
RECEIVED
JUN 01 2011

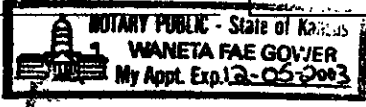

KCC WICHITA

X

Operator Name: JOHNSON OIL Lease Name: PETERSON 1 Well #: 1
Sec. 22 Twp. 8 S. R. 19 West East West County: ROOKS COUNTY KANSAS

INSTRUCTIONS: Show important tops and base of formations penetrated. Detail all cores. Report all final copies of drill stems tests giving interval tested, time tool open and closed, flowing and shut-in pressures, whether shut-in pressure reached static level, hydrostatic pressures, bottom hole temperature, fluid recovery, and flow rates if gas to surface test, along with final chart(s). Attach extra sheet if more space is needed. Attach copy of all Electric Wireline Logs surveyed. Attach final geological well site report.

Drill Stem Tests Taken (Attach Additional Sheets) [] Yes [X] No
Samples Sent to Geological Survey [] Yes [X] No
Cores Taken [] Yes [X] No
Electric Log Run (Submit Copy) [] Yes [X] No
List All E. Logs Run: NONE
RECEIVED NOV 26 2001 KCC WICHITA

CASING RECORD [] New [X] Used
Report all strings set-conductor, surface, intermediate, production, etc.

Purpose of String	Size Hole Drilled	Size Casing Set (In O.D.)	Weight Lbs./Ft.	Setting Depth	Type of Cement	# Sacks Used	Type and Percent Additives
SURFACE	12 1/4	10 "		187 1/2 feet		200 sacks	
production	10 1/4	7 1/8		3449		200 sacks	
production	7:	5 1/2	171 lbs	3448	common	250	circulated to surface

ADDITIONAL CEMENTING / SQUEEZE RECORD

Purpose:	Depth Top Bottom	Type of Cement	#Sacks Used	Type and Percent Additives
<input type="checkbox"/> Perforate <input type="checkbox"/> Protect Casing <input type="checkbox"/> Plug Back TD <input checked="" type="checkbox"/> Plug Off Zone				125 sack cement was pumped
		WELL was plugged in NOV 20 1986		between 7" and 10 then pressured.
		IT was perforated at 870 and 1475		at that time 425 sacks of
		65-35 pozmix and gel was used to plug well.		

PERFORATION RECORD - Bridge Plugs Set/Type Specify Footage of Each Interval Perforated

Shots Per Foot	Acid, Fracture, Shot, Cement Squeeze Record (Amount and Kind of Material Used)	Depth
3420 WIRELINE PLUG SET OVER ARBUCLE		
LANSING K/C perforated at 3202-3206	16 shots	
perforated at 3238-3244	16 shots	
	no acid set	

TUBING RECORD Size 2 7/8 Set At 3400 Packer At none Liner Run [] Yes [] No

Date of First, Resumed Production, SWD or Enhr. Producing Method [] Flowing [X] Pumping [] Gas Lift [] Other (Explain)

Estimated Production Per 24 Hours	Oil Bbls.	Gas Mcf	Water Bbls.	Gas-Oil Ratio	Gravity
	3		40		32

Disposition of Gas [] Vented [] Sold [] Used on Lease (If vented, Submit ACO-18.)

METHOD OF COMPLETION [] Open Hole [X] Part. [] Dualty Comp. [] Commingled [] Other (Specify)

Production Interval

RECEIVED JUN 01 2011 KCC WICHITA

PETERSON
 NEW PLUGGING RECORD
 K.A.R.-82-3-117

15-163-01400-00-01

RECEIVED
 JAN 23 2003
 KCC WICHITA

TYPE OR PRINT
 NOTICE: Fill out completely and return
 to Cons. Div. office within 30 days.

API NUMBER 1516301400
 LEASE NAME peterson 1
 WELL NUMBER 1
3620 from S/N Line of Section (circle one)
4950e Ft. from E/W Line of Section (circle one)

EASE OPERATOR JOHNSON OIL
 ADDRESS 258 east highway 36
 CITY, STATE, ZIP phillipsburg kansas 67661
 PHONE#() 785 540 OPERATOR'S LICENSE NO. 3077
 Character of Well oil
 (Oil, Gas, D&A, SWD, Input, Water Supply Well)

SPOT LOCATION NW SW RW
 SEC. 22 TWP. 8 S. RGE 19W (E) or (W)
 COUNTY rooks county kansas
 Date Well Completed 12 17 1947
 Date Plugging Commenced december 30 2002
 Date Plugging Completed december 30 2002

The plugging proposal was approved on DECEMBER 23 2002 (date)
 by DENNIS HAMEL (KCC District Agent's Name)

Is ACO-1 filed? YES If not, is well log attached?
 Producing Formation(s) arbuckle kansas city Depth to Top 3205 Bottom 3457 T.D. 3459

How depth and thickness of all water, oil and gas formations.

OIL, GAS OR WATER RECORDS

CASING RECORD

FORMATION	CONTENT	FROM	TO	SIZE	PUT IN	PULL OUT
arbuckle	oil	3449-57		7 inch 5 1/2	liner 3449	none
					cemented liner all the way to top	

Describe in detail the manner in which the well was plugged, indicating where the mud fluid was placed and the method or methods used in introducing it into the hole. If cement or other plugs were used, state the character of same and depth placed, from _____ feet to _____ feet each set.

annulus pressured to 400 psi. 5 1/2 casing 75 sacks
with 250lbs of huls followed by 15 gel with 250 more huls then
100 sacks cement at 500lbs Shut in at 1000lbs max pressure
1200lbs.

(If additional description is necessary, use BACK of this form.)

Name of Plugging Contractor allied cementing
 License No. N/A
 Address RUSSELL KANSAS
 NAME OF PARTY RESPONSIBLE FOR PLUGGING FEES: KEVIN JOHNSON
 STATE OF kansas COUNTY OF rooks, ss.
KEVIN JOHNSON (Employee of Operator or (Operator) of above-described well, being first

RECEIVED
 JUN 01 2011
 KCC WICHITA

sworn on oath, says: That I have knowledge of the facts, statements, and matters herein contained and the log of the above-described well as filed that the same are true and correct, so help me God.

(Signature) Kevin Johnson
 (Address) 258 EAST HIGHWAY 36 PHILLIPSBURG KANSAS 67661

SUBSCRIBED AND SWORN TO before me this 21st day of January, 19 2003
Waneta Joe Bower
 Notary Public

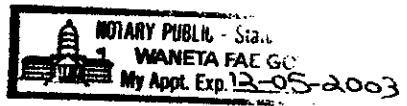

My Commission Expires: 12-05-2003

Handwritten initials 'cl'

TO:
STATE CORPORATION COMMISSION
CONSERVATION DIVISION - PLUGGING
130 SOUTH MARKET, SUITE 2078
WICHITA, KANSAS 67202

API Well Number: 15-163-01400-00-01
Spot: NWSWNW Sec/Twnshp/Rge: 22-8S-19W
3630 feet from S Section Line, 4950 feet from E Section Line
Lease/Unit Name: PETERSON OWWO Well Number: 1
County: ROOKS Total Vertical Depth: 3458 feet

Operator License No.: 3077
Op Name: JOHNSON OIL
Address: 258 HWY 36
PHILLIPSBURG, KS 67661

Conductor Pipe: Size _____ feet: \$112.39
Surface Casing: Size 10.75 feet: 187
Production: Size 7 feet: 3449
Liner: Size 5.5 feet: 1467

Well Type: OIL UIC Docket No: _____ Date/Time to Plug: 12/30/2002 12:30 PM
Plug Co. License No.: 3077 Plug Co. Name: JOHNSON OIL
Proposal Rcvd. from: KEVIN JOHNSON Company: JOHNSON OIL Phone: (785) 543-6171

Proposed Plugging Method: Ordered out 225 sxs 60/40 pozmix - 10% gel - 500# hulls - 15 sxs gel.
7" at 3449'. 5 1/2" liner set at 1467' cwc.
PBTB 3394'. Fluid Level 1100'.
Perfs 3077' - 3208'.

Plugging Proposal Received By: DENNIS HAMEL WitnessType: Plugging Operations 100% Witnessed (Complete)
Date/Time Plugging Completed: 12/30/2002 1:25 PM KCC Agent: RICHARD WILLIAMS

Actual Plugging Report:

Allied pumped 75 sxs 60/40 pozmix - 10% gel with 250# hulls,
followed with 15 sxs gel spacer with 250# hulls, followed with 100 sxs cement.
Max. P.S.I. 1200#. S.I.P. 1000#.
Hooked up to backside - instant pressure 400#.
Note: 5 1/2" liner to 1467' cwc.

RECEIVED
JAN 06 2003
KCC WICHITA
1/6/03

Remarks: ALLIED CEMENTING COMPANY.

Plugged through: CSG

District: 04

Signed _____

Richard Williams

(TECHNICIAN)

INVOICED

Form CP-2/3

DATE 1-7-03

vv. NO. 2003061042

JAN 02 2003

ALLIED CEMENTING CO., INC. 11316

ORIGINAL

REMIT-TO, P.O. BOX 31
RUSSELL, KANSAS 67665

SERVICE POINT: D

DATE <u>12/30/10</u>	SEC.	TWP.	RANGE	CALLED OUT	ON LOCATION <u>12:45 p.m.</u>	JOB START	JOB FINISH <u>1:30 p.m.</u>
LEASE <u>Peterson</u>	WELL # <u>1</u>	LOCATION <u>2 3/4 N E 10 1/2</u>		COUNTY <u>Woods</u>	STATE <u>KS</u>		

OLD OR NEW (Circle one)

CONTRACTOR _____ OWNER _____

TYPE OF JOB W.P.

HOLE SIZE _____ T.D. _____

CASING SIZE 5 1/2 DEPTH _____

TUBING SIZE _____ DEPTH _____

DRILL PIPE _____ DEPTH _____

TOOL _____ DEPTH _____

PRES. MAX _____ MINIMUM _____

MEAS. LINE _____ SHOE JOINT _____

CEMENT LEFT IN CSG. _____

PERFS. _____

DISPLACEMENT _____

CEMENT AMOUNT ORDERED 2500 1000 601

USED 225 gal 5 Halls 15 gal

COMMON @ _____

POZMIX @ _____

GEL @ _____

CHLORIDE @ _____

RECEIVED

FEB 18 2003

KCC@WICHITA

EQUIPMENT

PUMP TRUCK CEMENTER Paul

122 HELPER Glen

BULK TRUCK

3102 DRIVER Shane

BULK TRUCK

_____ DRIVER _____

HANDLING @ _____

MILEAGE @ _____

TOTAL _____

REMARKS:

Annular seal 1100 psi

225 gal - 2500 ft 200 Halls 15 gal W.P.

250 Halls followed by 100 SPT 300 ps

shut in Quinpsi. Max 100 psi

SERVICE

DEPTH OF JOB _____

PUMP TRUCK CHARGE _____

EXTRA FOOTAGE @ _____

MILEAGE @ _____

PLUG @ _____

1136

1-25-03

TOTAL _____

CHARGE TO: Johnson Oil

STREET _____

CITY _____ STATE _____ ZIP _____

FLOAT EQUIPMENT

@ _____

@ _____

@ _____

@ _____

@ _____

To Allied Cementing Co., Inc.
You are hereby requested to rent cementing equipment and furnish cementer and helper to assist owner or contractor to do work as is listed. The above work was done to satisfaction and supervision of owner agent or contractor. I have read & understand the "TERMS AND CONDITIONS" listed on the reverse side.

TOTAL RECEIVED

JUN 01 2011

TAX _____

TOTAL CHARGE _____

DISCOUNT _____ IF PAID IN 30 DAYS

KCC WICHITA

SIGNATURE [Signature]

PRINTED NAME

cb-100 cbt-1 cb-11+ cb 4001 B O L H cb1+ cba

**KANSAS CORPORATION COMMISSION
OIL & GAS CONSERVATION DIVISION
APPLICATION FOR SURFACE PIT**

Form CDP-1
May 2010
Form must be Typed

Submit in Duplicate

Operator Name: JOHNSON OIL		License Number: 3077
Operator Address: 258 east highway 36		PHILLIPSBURG KS 67661
Contact Person: KEVIN JOHNSON		Phone Number: 785 543 6171
Lease Name & Well No.: PETERSON 1		Pit Location (QQQQ): _____ nw _____ sw _____ nw Sec. 22 Twp. 8 R. 19 <input type="checkbox"/> East <input checked="" type="checkbox"/> West 3,630 Feet from <input type="checkbox"/> North / <input checked="" type="checkbox"/> South Line of Section 4,950 Feet from <input checked="" type="checkbox"/> East / <input type="checkbox"/> West Line of Section ROOKS COUNTY KANSAS County
Type of Pit: <input type="checkbox"/> Emergency Pit <input type="checkbox"/> Burn Pit <input type="checkbox"/> Settling Pit <input type="checkbox"/> Drilling Pit <input checked="" type="checkbox"/> Workover Pit <input type="checkbox"/> Haul-Off Pit <small>(If WP Supply API No. or Year Drilled)</small> 15-163-01400	Pit is: <input checked="" type="checkbox"/> Proposed <input type="checkbox"/> Existing If Existing, date constructed: _____ Pit capacity: 200 (bbls)	
Is the pit located in a Sensitive Ground Water Area? <input checked="" type="checkbox"/> Yes <input type="checkbox"/> No		Chloride concentration: _____ mg/l <small>(For Emergency Pits and Settling Pits only)</small>
Is the bottom below ground level? <input checked="" type="checkbox"/> Yes <input type="checkbox"/> No	Artificial Liner? <input checked="" type="checkbox"/> Yes <input type="checkbox"/> No	How is the pit lined if a plastic liner is not used? 6ml plastic
Pit dimensions (all but working pits): 30 Length (feet) 8 Width (feet) <input type="checkbox"/> N/A: Steel Pits Depth from ground level to deepest point: 4 (feet) <input type="checkbox"/> No Pit		
If the pit is lined give a brief description of the liner material, thickness and installation procedure. 6ml plastic liner laid down flat, water put in then lay dirt down on sides to protect plastic against wind and puncture.		Describe procedures for periodic maintenance and determining liner integrity, including any special monitoring. make sure liner doesn't leak use common sense while in operation.
Distance to nearest water well within one-mile of pit: 1 mile Depth of water well 30 feet		Depth to shallowest fresh water 30 feet. Source of information: <input type="checkbox"/> measured <input checked="" type="checkbox"/> well owner <input type="checkbox"/> electric log <input type="checkbox"/> KDWR
Emergency, Settling and Burn Pits ONLY: Producing Formation: _____ Number of producing wells on lease: _____ Barrels of fluid produced daily: _____ Does the slope from the tank battery allow all spilled fluids to flow into the pit? <input type="checkbox"/> Yes <input type="checkbox"/> No		Drilling, Workover and Haul-Off Pits ONLY: Type of material utilized in drilling/workover: fresh water/ drilling cement plug Number of working pits to be utilized: 1 Abandonment procedure: allow fluids to evaporate scoop up any solids, use on lease road at site or on tank dike, then remove plastic, level earth. Drill pits must be closed within 365 days of spud date.
I hereby certify that the above statements are true and correct to the best of my knowledge and belief. _____ may 30 2011 _____ Date		RECEIVED JUN 01 2011 KCC WICHITA
KCC OFFICE USE ONLY		
Date Received: 6-1-11 Permit Number: _____ Permit Date: 6-2-11 Lease Inspection: <input checked="" type="checkbox"/> Yes <input type="checkbox"/> No	<input type="checkbox"/> Liner <input type="checkbox"/> Steel Pit <input checked="" type="checkbox"/> RFAC <input type="checkbox"/> RFAS	

15-163-01400-00-02

June 2, 2011

Johnson Oil
258 East Highway 36
Phillipsburg, KS 67661

RE: Drilling Pit Application
Peterson Lease Well No. 1
NW/4 Sec. 22-08S-19W
Rooks County, Kansas

Dear Sir or Madam:

District staff has inspected the above referenced location and has determined that the reserve pit shall be constructed **without slots**, the bottom shall be flat and reasonably level, and the free fluids must be removed. The fluids are to be removed from the reserve pit within 8 hours after drilling operations have ceased. **Keep pits away from any drainage.**

If production casing is set all completion fluids shall be removed from the working pits daily. NO completion fluids or non-exempt wastes shall be placed in the reserve pit.

The fluids should be taken to an authorized disposal well. Please call the District Office at (785) 625-0550 when the fluids have been removed. Please file form CDP-5 (August 2004), Exploration and Production Waste Transfer, within 30 days of fluid removal. Conservation division forms are available through our office and on the KCC web site:
www.kcc.state.ks.us/conservation/forms.

A copy of this letter should be posted in the doghouse along with the approved Intent to Drill. If you have any questions or concerns please feel free to contact the undersigned at the above address.

Sincerely,

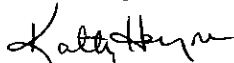

Kathy Haynes
Environmental Protection and Remediation Department

cc: district