

15-195-20448-00-00

STATE OF KANSAS  
STATE CORPORATION COMMISSION

WELL PLUGGING RECORD

Give All Information Completely  
Make Required Affidavit  
Mail or Deliver Report to  
Conservation Division  
State Corporation Comm.  
245 North Water  
Wichita, KS 67202

TREGO County. Sec. 24 Twp. 13S Rge. 22 ~~XX~~W  
Location as "NE/CNW $\frac{1}{4}$ SW $\frac{1}{4}$ " or footage from lines  
SE NE SE  
Lease Owner C-G DRILLING CO  
Lease Name PETTY Well No. 1  
Office Address 1107 DOUGLAS BLDG, WICHITA, KS 67202  
Character of Well (Completed as Oil, Gas or Dry Hole)  
DRY HOLE

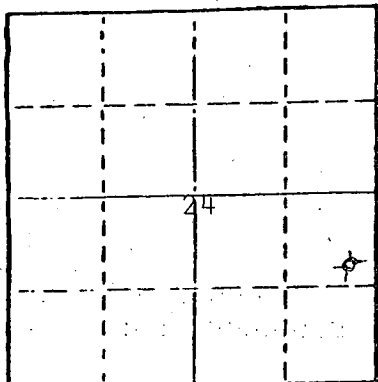

Locate well correctly on above  
Section Plat

Date Well completed 12/31/77 19  
Application for plugging filed 12/31/77 19  
Application for plugging approved 12/31/77 19  
Plugging commenced 12/31/77 19  
Plugging completed 12/31/77 19  
Reason for abandonment of well or producing formation  
TOO LOW STRUCTURALLY

If a producing well is abandoned, date of last production  
19

Was permission obtained from the Conservation Division or  
its agents before plugging was commenced? YES

Name of Conservation Agent who supervised plugging of this well GILBERT BALTHAZOR  
Producing formation Depth to top Bottom Total Depth of Well 4075  
Show depth and thickness of all water, oil and gas formations.

OIL, GAS OR WATER RECORDS

CASING RECORD

FORMATION	CONTENT	FROM	TO	SIZE	PUT IN	PULLED OUT
				8 5/8"	251'	NONE

Describe in detail the manner in which the well was plugged, indicating where the mud fluid  
was placed and the method or methods used in introducing it into the hold. If cement or other  
plugs were used, state the character of same and depth placed, from feet to  
feet for each plug set.

FILLED WITH HEAVY MUD TO 800'. SET  
PLUG. PUT IN 70 SACKS CEMENT. FILLED WITH HEAVY  
MUD TO 240' SET PLUG. PUT IN 20 SACKS  
CEMENT. FILLED WITH HEAVY MUD TO 40'.  
SET PLUG. FILLED TO TOP WITH 10 SACKS  
50-50-POZMIX 2% GEL.

RECEIVED  
STATE CORPORATION COMMISSION

JAN 17 1978

CONSERVATION DIVISION  
Wichita, Kansas

(If additional description is necessary, use BACK of this  
Name of Plugging Contractor C-G DRILLING CO  
1107 DOUGLAS BLDG, WICHITA, KS 67202

STATE OF KANSAS COUNTY OF SEDGWICK ss.  
G F GALLOWAY

(employee of owner) or (owner or operator) of the above-described  
well, being first duly sworn on oath, says: That I have knowledge of the facts, statements, and matters herein contained and the log of the  
above-described well as filed and that the same are true and correct. So help me God.

(Signature) G F GALLOWAY

(Address)

SUBSCRIBED AND SWORN TO before me this 5TH day of JANUARY 1978

My commission expires MARCH 3, 1980

Debra L Heersche  
DEBRA L HEERSCHÉ Notary Public.

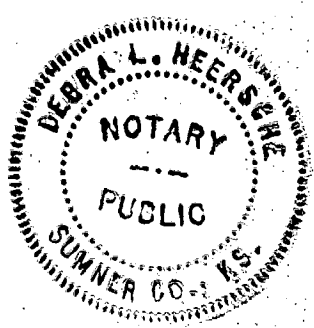

**IMPORTANT**  
 Kans. Geo. Survey request  
 samples on this well.

15-195-20448-00-00

**KANSAS DRILLERS LOG**

S. 24 T. 13 R. 22 <sup>N</sup>/<sub>W</sub>

API No. 15 — 195 — 20,448  
                                     County                                    Number

Loc. SE NE SE

Operator  
C-G Drilling Co.

County Trego

Address  
1107 Douglas Bldg. Wichita, Kansas 67202

640 Acres  
 N

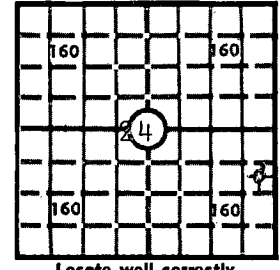

Well No. # 1      Lease Name Petty

Footage Location  
1650 feet from ~~XX~~ (S) line      330 feet from (E) ~~XX~~ line

Principal Contractor C-G DRILLING CO      Geologist J E JESPERSEN

Spud Date 12/17/77      Total Depth 4075      P.B.T.D.

Elev.: Gr. \_\_\_\_\_

Date Completed 12/31/77      Oil Purchaser \_\_\_\_\_

DF \_\_\_\_\_      KB 2282'

**CASING RECORD**

Report of all strings set — surface, intermediate, production, etc.

Purpose of string	Size hole drilled	Size casing set (in O.D.)	Weight lbs/ft.	Setting depth	Type cement	Sacks	Type and percent additives
SURFACE	12 3/4"	8 5/8"	28#	251.54	Common	160	2% Gel 3% CC

**LINER RECORD**

**PERFORATION RECORD**

Top, ft.	Bottom, ft.	Sacks cement	Shots per ft.	Size & type	Depth interval

**TUBING RECORD**

Size	Setting depth	Packer set at

**ACID, FRACTURE, SHOT, CEMENT SQUEEZE RECORD**

Amount and kind of material used	Depth interval treated
RECEIVED STATE CORPORATION COMMISSION  JAN 26 1978  CONSERVATION DIVISION Wichita, Kansas	

**INITIAL PRODUCTION**

Date of first production		Producing method (flowing, pumping, gas lift, etc.)			
<b>RATE OF PRODUCTION PER 24 HOURS</b>	Oil	Gas	Water	Gas-oil ratio	
	bbls.	MCF	bbls.	CFPB	
Disposition of gas (vented, used on lease or sold)			Producing interval (s)		

**INSTRUCTIONS:** As provided in KCC Rule 82-2-125, within 90 days after completion of a well, one completed copy of this Drillers Log shall be transmitted to the State Geological Survey of Kansas, 4150 Monroe Street, Wichita, Kansas 67209. Copies of this form are available from the Conservation Division, State Corporation Commission, 3830 So. Meridian (P.O. Box 17027), Wichita, Kansas 66217. Phone AC 316-522-2206. If confidential custody is desired, please note Rule 82-2-125. Drillers Logs will be on open file in the Oil and Gas Division, State Geological Survey of Kansas, Lawrence, Kansas 66044.

Operator  
C-G DRILLING CO

DESIGNATE TYPE OF COMP.: OIL, GAS,  
DRY HOLE, SWDW, ETC.:  
DRY HOLE

Well No. 1 Lease Name PETTY

S 24 T 13S R 22W E W

WELL LOG

Show all important zones of porosity and contents thereof; cored intervals, and all drill-stem tests, including depth interval tested, cushion used, time tool open, flowing and shut-in pressures, and recoveries.

SHOW GEOLOGICAL MARKERS, LOGS RUN, OR OTHER DESCRIPTIVE INFORMATION.

FORMATION DESCRIPTION, CONTENTS, ETC.	TOP	BOTTOM	NAME	DEPTH
POST ROCK & SAND	0	261		
SHALE	261	1180		
SAND	1180	1415		
RED BED	1415	1625		
SHALE	1625	1850		
ANHYDRITE	1696	1741		
SHALE & SHELLS	1850	2350		
SHALE	2350	2470		
LIME & SHALE	2470	3635		
LIME & RTD	3635	4075		
DST #1: 3616-3640 30-30-30-30. REC 10' MUD IBHP 183#, FBHP 137# IFP 45#, FFP 45#				
DST #2: 3644-3670' 30-30-60-60 REC 245' SLIGHTLY OILY GAS CUT WTRY MUD IBHP 493#, FBHP 481#, IFP 45#, FFP 149#				
DST #3: 3985-4086 30-30-30-30. REC 15' MUD IBHP 321#, FBHP 208#, IEP 57#, FFP 68#.				

USE ADDITIONAL SHEETS, IF NECESSARY, TO COMPLETE WELL RECORD.

Date Received:

C-G DRILLING CO

*Debra L Heersche*  
Signature

DEBRA L HEERSCHE, OFFICE MGR

Title

1/10/78

Date