

WELL PLUGGING RECORD

Give All Information Completely
Make Required Affidavit
Mail or Deliver Report to:
Conservation Division
State Corporation Commission
800 Bittling Building
Wichita, Kansas

Trego County. Sec. 29. Twp. 13S. Rge. 22 (E) W (W)
Location as "NE/CNW $\frac{1}{4}$ SW $\frac{1}{4}$ " or footage from lines C SW SW SW
Lease Owner Deep Rock Oil Corporation
Lease Name Winona A. Nicholson Well No. 1
Office Address Box #1051, Tulsa, Oklahoma
Character of Well (completed as Oil, Gas or Dry Hole) Dry Hole
Date well completed April 24 19 52
Application for plugging filed April 29 19 52
Application for plugging approved April 28 19 52
Plugging commenced April 24 19 52
Plugging completed April 24 19 52
Reason for abandonment of well or producing formation Dry Hole

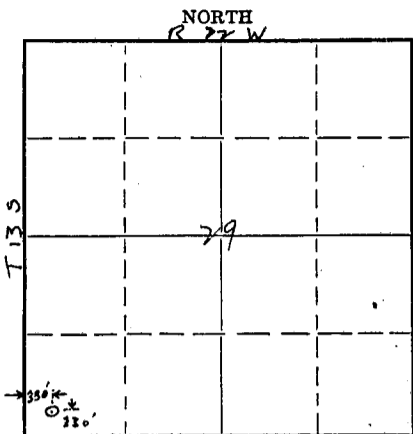

Locate well correctly on above Section Plat

If a producing well is abandoned, date of last production 19...
Was permission obtained from the Conservation Division or its agents before plugging was commenced? Yes

Name of Conservation Agent who supervised plugging of this well Mr. Eldon Petty
Producing formation Depth to top Bottom Total Depth of Well 4535' Feet
Show depth and thickness of all water, oil and gas formations.

OIL, GAS OR WATER RECORDS

CASING RECORD

Formation	Content	From	To	Size	Put In	Pulled Out
				10-3/4"	251'	0

Describe in detail the manner in which the well was plugged, indicating where the mud fluid was placed and the method or methods used in introducing it into the hole. If cement or other plugs were used, state the character of same and depth placed, from feet to feet for each plug set.

Filled hole with mud to 245'. Set Halliburton Wood Plug, mixed 1 sack hulls and 20 sacks Atlas cement and pumped in hole. Filled up to 35' with mud. Set Halliburton wood plug, pumped in 1/5 sack hulls and 15 sacks Atlas cement to top of hole.

RECEIVED
STATE CORPORATION COMMISSION
MAY - 6 1952
OS-OL-52
CONSERVATION DIVISION
Wichita, Kansas

(If additional description is necessary, use BACK of this sheet)
Name of Plugging Contractor Creekmore Drilling Company
Address Thompson Building, Tulsa, Oklahoma

STATE OF Kansas COUNTY OF Reno ss.
Jack Smith (employee of owner) or (owner or operator) of the above-described well,
being first duly sworn on oath, says: That I have knowledge of the facts, statements, and matters herein contained and the log of the above-described well as filed and that the same are true and correct. So help me God.

(Signature) Jack Smith
Box #1146, Hutchinson, Kansas
(Address)

SUBSCRIBED AND SWORN to before me this 5th day of May, 19 52
Alice L. Walker
Notary Public.

My commission expires

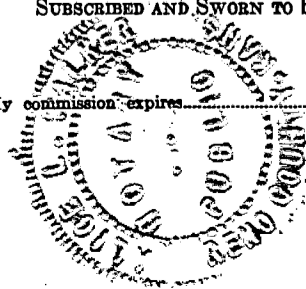

PLUGGING 6-51-20M
FILE SEC 29T 13 R 22W
BOOK PAGE 12 LINE 13

15-195-00006-00-00



DEEP ROCK OIL CORPORATION

ATLAS LIFE BUILDING
TULSA 2, OKLAHOMA

Deep Rock Oil Corporation
Winona A. Nicholson # 1
SW SW SW
Section 29-13S-22W
Trego County, Kansas

Surface pipe - 10 3/4" 251' Cement circulated top to bottom.

Surface clay and brown lime	0- 70
Sand	70- 85
Brown lime	85- 150
Blue shale	150- 255
Sand and shale	255- 870
Sand	870- 915
Sand and shale	915-1065
Sand, shale and pryrite	1065-1115
Shale and shells	1115-1180
Sand and shale	1180-1600
Sand shale and red bed	1600-1876
Sandy shale	1876-1882
Anhydrite	1882-1927
Shale and brown lime	1927-2045
Shale and lime	2045-2555
Lime and shale	2555-2765
Shale and lime	2765-2820
Lime and shale	2820-3127
Shale and lime	3127-3286
Lime and shale	3286-3354
Shale and lime	3354-3607
Lime and shale	3607-3665
Lime	3665-4135
Shale and lime	4135-4225
Lime and shale	4225-4325
Shale	4325-4343
Shale and lime	4343-4348
Chert and conglomerate	4348-4383
Cherty conglomerate	4383-4451
Cherty dolomite	4451-4483
Lime	4483-4535
Rotary Total Depth	4535

RECEIVED
STATE CORPORATION COMMISSION

MAY - 6 1952

CONSERVATION DIVISION
Wichita, Kansas

PLUGGING
FILE SEC 29 T 13 R 22W
BOOK PAGE 12 LINE 3