

see

15-195-00277-00-00

STATE OF KANSAS  
STATE CORPORATION COMMISSION

Give All Information Completely  
Make Required Affidavit  
Mail or Deliver Report to:  
Conservation Division  
State Corporation Commission  
211 No. Broadway  
Wichita, Kansas

WELL PLUGGING RECORD

Trego County, Sec. 25 Twp. 13S Rge. (E) 22(W)

Location as "NE/CNW%SW%" or footage from lines NW/4 NE/4 SW/4

Lease Owner Skelly Oil Company

Lease Name John Pearson Well No. 1

Office Address Box 1650, Tulsa, Oklahoma

Character of Well (completed as Oil, Gas or Dry Hole) Dry Hole

Date well completed May 26, 1957

Application for plugging filed May 27, 1957

Application for plugging approved May 28, 1957

Plugging commenced May 28, 1957

Plugging completed May 26, 1957

Reason for abandonment of well or producing formation Dry Hole

If a producing well is abandoned, date of last production \_\_\_\_\_ 19\_\_\_\_

Was permission obtained from the Conservation Division or its agents before plugging was commenced? Yes

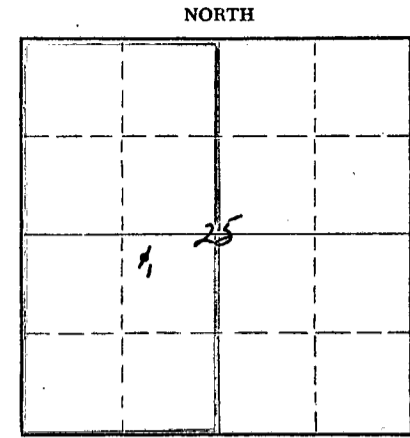

Locate well correctly on above  
Section Plat

Name of Conservation Agent who supervised plugging of this well Mr. Eldon Petty

Producing formation \_\_\_\_\_ Depth to top \_\_\_\_\_ Bottom \_\_\_\_\_ Total Depth of Well 4245 Feet

Show depth and thickness of all water, oil and gas formations.

OIL, GAS OR WATER RECORDS

CASING RECORD

FORMATION	CONTENT	FROM	TO	OD SIZE	PUT IN	PULLED OUT
Arbuckle Lime	Dry	4166'	4245'	8-5/8"	1268'	None

Describe in detail the manner in which the well was plugged, indicating where the mud fluid was placed and the method or methods used in introducing it into the hole. If cement or other plugs were used, state the character of same and depth placed, from \_\_\_\_\_ feet to \_\_\_\_\_ feet for each plug set.

- 25 sacks of cement 4245' to 4150'
- Mud laden fluid 4150' to 750'
- Wood plug 750' to 748'
- 35 sacks of cement 748' to 645'
- Mud laden fluid 645' to 50'
- Wood plug and hulls 50' to 45'
- 15 sacks of cement 45' to 6'
- Surface soil 6' to 0'

RECEIVED  
STATE CORPORATION COMMISSION  
06-20-57  
JUN 20 1957

(If additional description is necessary, use BACK of this sheet)  
Name of Plugging Contractor Claude Wentworth Drilling Co., Inc. Kansas  
Address 2701 East 15th, Tulsa, Oklahoma

STATE OF Kansas, COUNTY OF Reno, ss.  
H. E. Wamsley (employee of owner) of the above-described

well, being first duly sworn on oath, says: That I have knowledge of the facts, statements, and matters herein contained and the log of the above-described well as filed and that the same are true and correct. So help me God.

(Signature) \_\_\_\_\_  
Box 391, Hutchinson, Kansas  
(Address)

SUBSCRIBED AND SWORN to before me this 19th day of June, 1957

My commission expires April 7, 1959

Josephine L. Johnson  
Notary Public.

PLUGGING  
FILE SEC 25 T 13 R 22W  
BOOK PAGE 15 LI 38

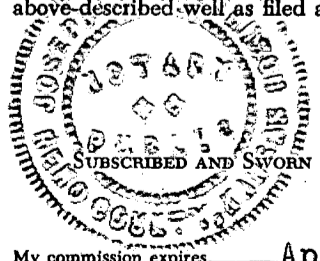

# SKELLY OIL COMPANY

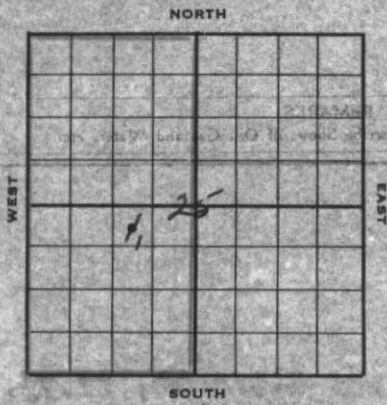

## Well Record

Lease Name and No. John Pearson Well No. 1 Elev. 2342'  
 Lease Description 1/2 Section 25-15-22,  
Irego County, Kansas (370 Acres)

Location made May 2, 19 57 by R. J. Cussen  
330 feet from North line 390 feet from East line  
5/4 feet from South line 280 feet from West line of 280

Work com'd. 5/4 19 57 Rig comp'd 5/1 19 57 Drlg. com'd 5/1 19 57 Drlg. comp'd 5/25 19 57  
 Rig Contractor Claude Wentworth Drilling Co., Inc.  
 Drilling Contractor Claude Wentworth Drilling Co., Inc., Tulsa, Oklahoma  
 Rotary Drilling from 0' to 4245' Cable Tool Drilling from \_\_\_\_\_ to \_\_\_\_\_

Commenced Producing DRY HOLE 19 \_\_\_\_\_  
 Initial Prod. before shot or acid \_\_\_\_\_ Bbls.  
 Initial Prod. after shot or acid \_\_\_\_\_ Bbls.  
 Dry Gas Well Press \_\_\_\_\_ Volume \_\_\_\_\_ Cu. ft.  
 Casing Head Gas Pressure \_\_\_\_\_ Volume \_\_\_\_\_ Cu. ft.  
 Braden Head ( \_\_\_\_\_ Size ) Gas Pressure \_\_\_\_\_ Volume \_\_\_\_\_ Cu. ft.  
 Braden Head ( \_\_\_\_\_ Size ) Gas Pressure \_\_\_\_\_ Volume \_\_\_\_\_ Cu. ft.

PRODUCING FORMATION DRY HOLE (Name) Top \_\_\_\_\_ Bottom \_\_\_\_\_ TOTAL DEPTH 4245'

### CASING RECORD

OD Size	Wt.	Thds.	Where Set	PULLED OUT			LEFT IN			KIND	Cond'n	CEMENTING	
				Jts.	Feet	In.	Jts.	Feet	In.			Sacks Used	Method Employed
8-5/8"	22.7	33	1275'				32	1268	0	ARCO	4	500	Halliburton

Liner Set at \_\_\_\_\_ Length \_\_\_\_\_ Perforated at \_\_\_\_\_  
 Liner Set at \_\_\_\_\_ Length \_\_\_\_\_ Perforated at \_\_\_\_\_  
 Packer Set at \_\_\_\_\_ Size and Kind \_\_\_\_\_  
 Packer Set at \_\_\_\_\_ Size and Kind \_\_\_\_\_

### SHOT OR ACID TREATMENT RECORD

	FIRST		SECOND		THIRD		FOURTH	
Date								
Acid Used Size Shot	Gals.	Qts.	Gals.	Qts.	Gals.	Qts.	Gals.	Qts.
Shot Between	Ft. and	Ft.	Ft. and	Ft.	Ft. and	Ft.	Ft. and	Ft.

### SIGNIFICANT GEOLOGICAL FORMATIONS

NAME	Top	Bottom	GAS		OIL		REMARKS
			From	To	From	To	
Topeka Lime	3411'						
Neaber shale	3658'						
Toronto Lime	3674'						
Lansing Lime	3691'						
Harmaton Lime	4039'						
Cherokee Sand	4094'						
Conglomerate	4125'						
Arbuckle Lime	4160'						

### CLEANING OUT RECORDS

	DATE COMMENCED	DATE COMPLETED	PROD. BEFORE	PROD. AFTER	REMARKS
1st					See Reverse for other details.
2nd					" " " " "
3rd					" " " " "
4th					" " " " "

### PLUGGING BACK AND DEEPENING RECORDS

	Date Commenced	Date Completed	No. Feet Plugged Back or Deepened	Prod. Before	Prod. After	REMARKS
1st						See Reverse for other details.
2nd						" " " " "
3rd						" " " " "
4th						" " " " "

(See Reverse for Record of Formation)



# RECORD OF FORMATIONS

FORMATION	TOP	BOTTOM	REMARKS
Sand and shale	0	250	
Shale and shells	250	500	
Shells and rock	500	1050	
Reamed 9" hole to 12-1/4"			
Shale	1050	1275	Set and cemented 3-5/8" OD, 22.75, Amco S.W., S.J. steel casing (A cond.) at 1275' w/ 600 sacks of Pozmix cement. Cement circulated
Shale and shells	1275	1300	
Shale, shells, and red bed	1300	1723	
Anhydrite	1723	1765	<u>TOP ANHYDRITE 1748'</u>
Shale, shells	1765	2140	<u>BASE ANHYDRITE 1794'</u>
Shale, lime	2140	2655	
Lime, shale	2655	2935	
Shale, shells	2935	3175	
Shale, lime	3175	3773	<u>TOP TOPSAY LIME 3111'</u> <u>TOP HANCOCK SHALE 3658'</u> <u>TOP TORONTO LIME 3674'</u> <u>TOP LANSING LIME 3691'</u>
Green, fine crystalline lime w/ streaks of gray to light tan lime	3773	3780	Fair porosity, trace of saturation, wet samples showed specks of free oil with good odor.
Lime	3780	3781	Ran Halliburton drill stem test No. 1, packer set at 3782', used 19' anchor, open 1 hour, good blow, recovered 170' of muddy salt water, no oil, IFF-07, IFF-95, IFF-1210.
Lime	3781	3849	
Light gray, dense fine crystalline lime	3849	3852	Trace of light spotted stain, poor porosity
Lime	3852	3884	
Light gray to brown, fine crystalline, fossiliferous lime, cherty	3884	3885	Poor porosity, spotted light stain
Lime and shale	3885	4096	<u>BASE KANSAS CITY LIME 3940'</u> <u>TOP HANCOCK SHALE 4039'</u> <u>TOP CHEMOKEE SAND 4094'</u>
White to gray, sub-angular, sub-rounded, fine to coarse grained sand	4096	4101	Tight porosity w/ brown to black stain, few specks of live oil in wet samples.
Sand	4101	4115	Ran Halliburton drill stem test No. 2, packer set at 4094', used 25' anchor, open 1 hour, weak blow for 22 minutes, recovered 18' of mud, no oil, IFF-50, no flow pressure.
			Ran Halliburton drill stem test No. 3 with two packers, top packer set at 3844' and bottom packer set at 3900', used 215' anchor, open 1 hour, weak blow for 16 minutes, recovered 5' of mud, no oil, all pressures 0.
Cherty lime and shale	4115	4125	<u>CONGLOMERATE CHERT 4125'</u>
Shale and lime	4125	4173	<u>TOP ARBUCKLE LIME 4166'</u>
Gray to tan, fine crystalline dolomite	4173	4202	Fair to good spotted vugular porosity, cherty with some oolitic chert, trace of very light stain and dead oil staining.
			Ran Halliburton drill stem test No. 4 and packer plugged, no recovery, reran test with packer set at 4165', used 40' anchor, open 1 hour, strong blow, recovered 2090' of salt water, no oil, IFF-1070 in 20 mins., IFF-80, IFF-880.



Dolomite 4202 4205  
 White to gray, medium  
 coarsely crystalline  
 dolomite 4205 4245

Fair porosity, light staining  
 San Schlumberger Survey.

San Halliburton drill stem test  
 No. 5, packer set at 4204', used  
 41' anchor, open 1 hour, good  
 blow, recovered 1215' of water,  
 no oil, SWP-1265, in 30 mins.,  
 LFP-110, FFP-570.

San Halliburton drill stem test  
 No. 6 with two packers, top  
 packer set at 4122', bottom  
 packer at 4150', used 95' anchor,  
 open 1 hour, weak blow for 15  
 mins., recovered 6' of mud, no  
 oil, SWP-235, no flow pressures.

TOTAL DEPTH 4245'

Since no oil or gas in commercial quantity was encountered in  
 drilling to the total depth of 4245', regular authority was granted to  
 plug and abandon the well.

The well was plugged as follows:

25 sacks of cement	4245'	to	4150'
Mud laden fluid	4150'	to	750'
Wood plug	750'	to	748'
35 sacks of cement	748'	to	645'
Mud laden fluid	645'	to	50'
Wood plug and hulls	50'	to	45'
15 sacks of cement	45'	to	6'
Surface soil	6'	to	0'

Plugged and abandoned May 26, 1957.

SLOPE TEST DATA: Tests were taken at 250', 500', 750', 1000', 1500',  
 2000', 2500', 3000', and 3500' with no deviation from vertical noted.

RECEIVED  
 MAY 18 1957  
 ENGINEERING