

15-190-30146-00-00

195

STATE OF KANSAS
STATE CORPORATION COMMISSION

Form CP-4

Give All Information Completely
Make Required Affidavit
Mail or Deliver Report to:
Conservation Division
State Corporation Commission
212 No. Market
Wichita, Kansas

WELL PLUGGING RECORD

TREGO County. Sec. 32 Twp. 13S Rge. 25 (R) (W)
Location as "NE/CNW/SW" or footage from lines C NW SE
Lease Owner PETROLEUM, INC.,
Lease Name PURINTON Well No. 1
Office Address R.R. #2, GREAT BEND, KANSAS
Character of Well (completed as Oil, Gas or Dry Hole) DRY HOLE
Date well completed SEPTEMBER 29 19 66
Application for plugging filed SEPTEMBER 29 19 66
Application for plugging approved SEPTEMBER 29 19 66
Plugging commenced SEPTEMBER 29 19 66
Plugging completed SEPTEMBER 29 19 66
Reason for abandonment of well or producing formation NO PRODUCIBLE ZONE

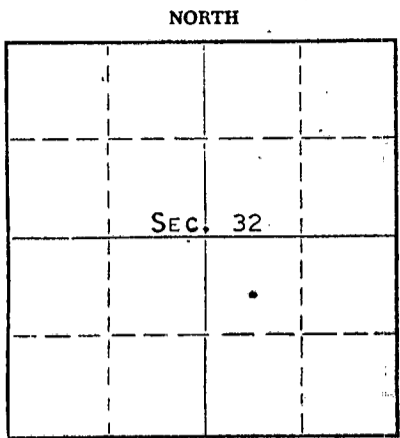

Locate well correctly on above
Section Plat

If a producing well is abandoned, date of last production NONE 19
Was permission obtained from the Conservation Division or its agents before plugging was commenced? YES

Name of Conservation Agent who supervised plugging of this well W. L. NICHOLS
Producing formation _____ Depth to top _____ Bottom _____ Total Depth of Well 4320 Feet
Show depth and thickness of all water, oil and gas formations.

OIL, GAS OR WATER RECORDS				CASING RECORD		
FORMATION	CONTENT	FROM	TO	SIZE	PUT IN	PULLED OUT
				8-5/8"	214	NONE

Describe in detail the manner in which the well was plugged, indicating where the mud fluid was placed and the method or methods used in introducing it into the hole. If cement or other plugs were used, state the character of same and depth placed, from _____ feet to _____ feet for each plug set.

MUD TO 540', FOLLOWED BY WOODEN PLUG, PLACED 25 SACKS CEMENT ON TOP OF PLUG.
MUD TO 210', FOLLOWED BY WOODEN PLUG, PLACED 20 SACKS CEMENT ON TOP OF PLUG.
MUD TO 40', FOLLOWED BY WOODEN PLUG, PLACED 10 SACKS CEMENT ON TOP OF PLUG TO
BASE OF WELL CELLAR.

RECEIVED
STATE CORPORATION COMMISSION
OCT 13 1966
10-13-1966
CONSERVATION DIVISION
Wichita, Kansas

(If additional description is necessary, use BACK of this sheet)
Name of Plugging Contractor GARVEY DRILLING CO.
Address R.R. #2, GREAT BEND, KANSAS

STATE OF KANSAS COUNTY OF BARTON, ss.
MONTE CHADD (employee of owner) or (XXXXXX XXXXXX) of the above-described well, being first duly sworn on oath, says: That I have knowledge of the facts, statements, and matters herein contained and the log of the above-described well as filed and that the same are true and correct. So help me God. MONTE CHADD, DIST. PROD. SUPT.

(Signature) Monte Chadd
R.R. #2, GREAT BEND, KANSAS
(Address)

SUBSCRIBED AND SWORN to before me this 10 day of OCTOBER, 19 66
Richard A. Dumble
Notary Public.

My commission expires MAY 28, 1969

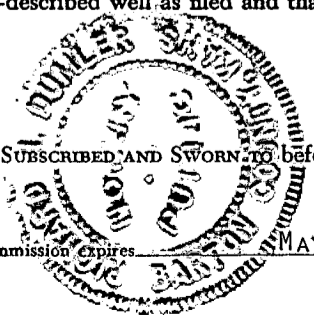

15-195-30146-00-00

WELL LOG

COMPANY **Petroleum, Inc.**

SEC. 32 T.13S R. 25W

FARM **Purinton** NO. **1**

LOC. **C NW SE**

TOTAL DEPTH **4320'**

COUNTY **Trego**

COMM. **9-20-66** COMP. **9-29-66**

CONTRACTOR **Garvey Drilling Company**

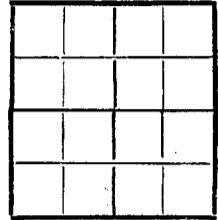

CASING **8 5/8" @ 214' w/165 sx**

ELEVATION **2377* KB**

PRODUCTION **D & A**

FIGURES INDICATE BOTTOM OF FORMATIONS

- 35' Sand
- 214' Post Rock and Blue Shale
- 980' Shale
- 1400' Shale and Shells
- 1600' Sand
- 1870' Shale and Shells
- 1910' Anhydrite
- 2100' Shale
- 2710' Shale with Lime
- 2865' Lime and Shale
- 2900' Lime
- 2995' Shale with Lime
- 3660' Lime and Shale
- 4290' Lime
- 4320' Mississippi Chert
- 4320' RTD

RECEIVED
 STATE CORPORATION COMMISSION
 OCT 18 1966
 10-13-1966
 CONSERVATION DIVISION
 Wichita, Kansas

State of Kansas }
 County of Barton } SS

I, Sam N. Stephens of Garvey Drilling Company

upon oath state the above and foregoing is a true and correct copy of the log of the Purinton No. 1 well.

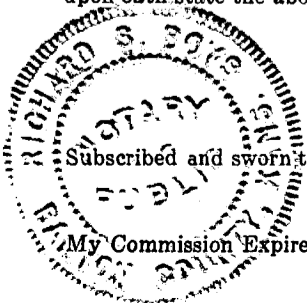

Sam N. Stephens

Subscribed and sworn to before me this 7th day of October 19 66

My Commission Expires: November 5, 1969

Richard S. Boyd
 NOTARY PUBLIC