

FOR KCC USE:

15-051-24896-0000  
FORM C-1 7/91

EFFECTIVE DATE: 5-28-95

State of Kansas

FORM MUST BE TYPED

DISTRICT # 4

NOTICE OF INTENTION TO DRILL

FORM MUST BE SIGNED

SGA? Yes  No

Must be approved by the K.C.C. five (5) days prior to commencing well

ALL BLANKS MUST BE FILLED

Expected Spud Date June 10 1995  
month day year

Spot W/2 - SE - NW Sec 4 Twp 13 S, Rg 16 XX East West

OPERATOR: License # 5252 ✓

Name: R.P. Nixon Operations, Inc.

Address: 207 West 12th Street

City/State/Zip: Hays, KS 67601

Contact Person: Dan Nixon

Phone: 913-628-3834

CONTRACTOR: License #: 5655 5184 ✓

Name: Shields Drlg.

Well Drilled For:	Well Class:	Type Equipment:
<input checked="" type="checkbox"/> Oil	<input type="checkbox"/> Enh Rec	<input checked="" type="checkbox"/> Infield
<input type="checkbox"/> Gas	<input type="checkbox"/> Storage	<input checked="" type="checkbox"/> Mud Rotary
<input type="checkbox"/> OWWO	<input type="checkbox"/> Disposal	<input type="checkbox"/> Pool Ext.
<input type="checkbox"/> Seismic;	<input type="checkbox"/> # of Holes	<input type="checkbox"/> Wildcat
<input type="checkbox"/> Other	<input type="checkbox"/> Other	<input type="checkbox"/> Air Rotary
		<input type="checkbox"/> Cable

If **OWWO**: old well information as follows:

Operator: \_\_\_\_\_

Well Name: \_\_\_\_\_

Comp. Date: \_\_\_\_\_ Old Total Depth \_\_\_\_\_

Directional, Deviated or Horizontal wellbore?  yes  no

If yes, true vertical depth: \_\_\_\_\_

Bottom Hole Location \_\_\_\_\_

✓ 3300 feet from South / North line of Section

✓ 3630 feet from East / West line of Section

IS SECTION  REGULAR  IRREGULAR?

(NOTE: Locate well on the Section Plat on Reverse Side)

County: Ellis

Lease Name: Pfeifer Well #: 1

Field Name: Emmeram

Is this a Prorated/Spaced Field?  yes  no

Target Formation(s): LKC, Arbuckle

Nearest lease or unit boundary: 330'

Ground Surface Elevation: 1980 ~~550~~ feet MSL

Water well within one-quarter mile:  yes  no

Public water supply well within one mile:  yes  no

Depth to bottom of fresh water: 180'

Depth to bottom of usable water: 650' 730'

Surface Pipe by Alternate:  1  2

Length of Surface Pipe Planned to be set: 200'

Length of Conductor pipe required: none

Projected Total Depth: 3500'

Formation at Total Depth: Arbuckle

Water Source for Drilling Operations: \_\_\_\_\_

well  farm pond  other

DWR Permit #: \_\_\_\_\_

Will Cores Be Taken?  yes  no

If yes, proposed zone: \_\_\_\_\_

AFFIDAVIT

The undersigned hereby affirms that the drilling, completion and eventual plugging of this well will comply with K.S.A. 55-101, et. seq.

It is agreed that the following minimum requirements will be met:

1. Notify the appropriate district office prior to spudding of well;
2. A copy of the approved notice of intent to drill shall be posted on each drilling rig;
3. The minimum amount of surface pipe as specified below shall be set by circulating cement to the top; in all cases surface pipe shall be set through all unconsolidated materials plus a minimum of 20 feet into the underlying formation;
4. If the well is dry hole, an agreement between the operator and the district office on plug length and placement is necessary prior to plugging;
5. The appropriate district office will be notified before well is either plugged or production casing is cemented in;
6. IF AN ALTERNATE II COMPLETION, PRODUCTION PIPE SHALL BE CEMENTED FROM BELOW ANY USABLE WATER TO SURFACE WITHIN 120 DAYS OF SPUD DATE. IN ALL CASES, NOTIFY DISTRICT OFFICE PRIOR TO ANY CEMENTING.

I hereby certify that the statements made herein are true and to the best of my knowledge and belief.

Date: May 22, 1995 Signature of Operator or Agent: [Signature] Title President

FOR KCC USE:  
 API # 15- 051-248960000  
 Conductor pipe required NONE feet  
 Minimum surface pipe required 200 feet per Alt.  ②  
 Approved by: JK 5-23-95

This authorization expires: 11-23-95  
 (This authorization void if drilling not started within 6 months of effective date.)  
 Spud date: \_\_\_\_\_ Agent: \_\_\_\_\_

RECEIVED  
STATE CORPORATION COMMISSION

MAY 23 1995

05-23-95  
OFFICE OF THE SECRETARY OF REVENUE  
WICHITA, KANSAS

REMEMBER TO:

- File Drill Pit Application (form CDP-1) with Intent to Drill;
- File Completion Form ACO-1 within 120 days of spud date;
- File acreage attribution plat according to field proration orders;
- Notify appropriate district office 48 hours prior to workover or re-entry;
- Submit plugging report (CP-4) after plugging is completed;
- Obtain written approval before disposing or injecting salt water.

Mail to: Conservation Division, 200 Colorado Derby Building, 202 W. First St., Wichita, Kansas 67202-1286.

13  
16W

**IN ALL CASES PLOT THE INTENDED WELL ON THE PLAT BELOW**

**PLAT OF ACREAGE ATTRIBUTABLE TO A WELL IN A PRORATED OR SPACED FIELD**

If the intended well is in a prorated or spaced field, please fully complete this side of the form. If the intended well is in a prorated or spaced field complete the plat below showing that the well will be properly located in relationship to other wells producing from the common source of supply. Please show all the wells within 1 mile of the boundaries of the proposed acreage attribution unit for gas wells and within 1/2 mile of the boundaries of the proposed acreage attribution unit for oil wells.

API NO. 15- \_\_\_\_\_  
 OPERATOR \_\_\_\_\_ LOCATION OF WELL: COUNTY \_\_\_\_\_  
 LEASE \_\_\_\_\_ feet from south/north line of section  
 WELL NUMBER \_\_\_\_\_ feet from east/west line of section  
 FIELD \_\_\_\_\_ SECTION \_\_\_\_\_ TWP \_\_\_\_\_ RG \_\_\_\_\_

NUMBER OF ACRES ATTRIBUTABLE TO WELL \_\_\_\_\_ IS SECTION \_\_\_\_\_ REGULAR or \_\_\_\_\_ IRREGULAR  
 QTR/QTR/QTR OF ACREAGE \_\_\_\_\_ - \_\_\_\_\_ - \_\_\_\_\_ IF SECTION IS IRREGULAR, LOCATE WELL FROM NEAREST  
CORNER BOUNDARY.  
 Section corner used: \_\_\_\_\_ NE \_\_\_\_\_ NW \_\_\_\_\_ SE \_\_\_\_\_ SW

**PLAT**

(Show location of the well and shade attributable acreage for prorated or spaced wells.)  
 (Show footage to the nearest lease or unit boundary line.)

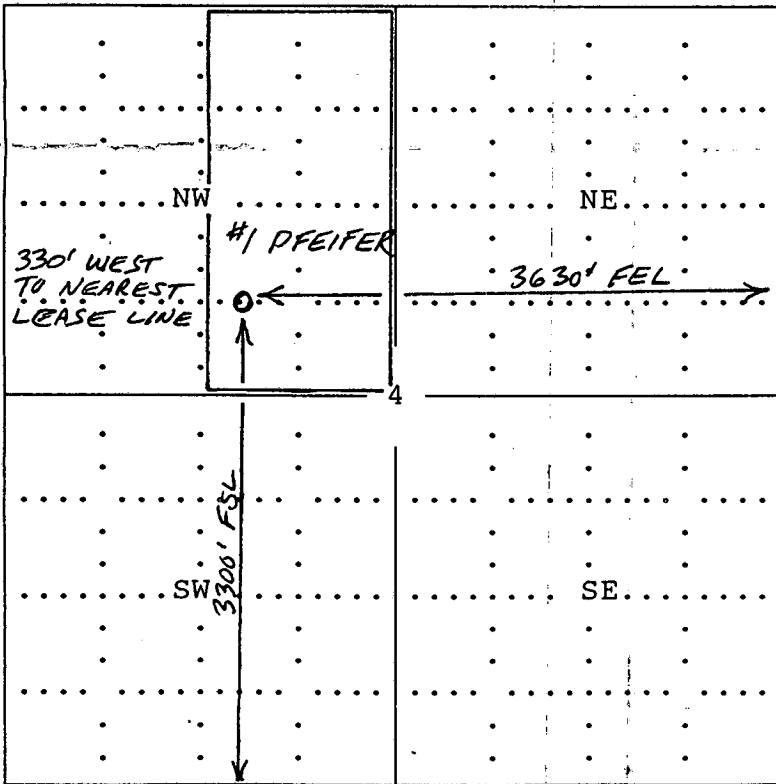

RECEIVED  
 STATE CORPORATION COMMISSION  
 MAY 2 1995

GUY WICKET & COMPANY

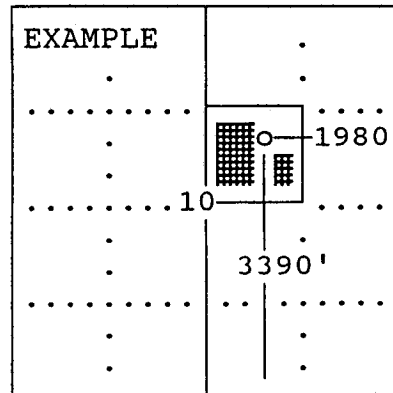

SEWARD CO.

In plotting the proposed location of the well, you must show:

- 1) The manner in which you are using the depicted plat by identifying section lines, i.e.. 1 section, 1 section with 8 surrounding sections, 4 sections, etc.;
- 2) the distance of the proposed drilling location from the section's south/north and east/west; and
- 3) the distance to the nearest lease or unit boundary line.